

F.A.U. RTE.	SECTION	COUNTY	TOTAL SHEETS	SHEET NO.
1219	22-00244-00-RS	LAKE	23	1
2736		ILLINOIS	CONTRACT NO. 61J64	

08-04-2023 LETTING ITEM 006

FOR INDEX OF SHEETS, SEE SHEET NO. 2

FOR INDEX OF HIGHWAY STANDARDS, SEE SHEET NO. 2

STATE OF ILLINOIS

DEPARTMENT OF TRANSPORTATION

PLANS FOR PROPOSED FEDERAL AID HIGHWAY

FAU 1219 GLEN FLORA AVE FROM McAREE RD TO LEWIS AVE
 FAU 2736 SHERIDAN RD FROM GLEN FLORA AVE TO GREENWOOD AVE
 SECTION NO: 22-00244-00-RS
 RESURFACING
 PROJECT: RDIP(681)
 CITY OF WAUKEGAN
 LAKE COUNTY
 C-91-145-23

TRAFFIC DATA

GLEN FLORA AVE
 MAJOR COLLECTOR
 POSTED SPEED: 30 MPH
 2020 ADT: 6350

SHERIDAN RD
 MINOR ARTERIAL
 POSTED SPEED: 30 MPH
 2020 ADT: 9950



BEGIN RESURFACING
 GLEN FLORA AVENUE
 STA 103+47

END RESURFACING
 SHERIDAN ROAD
 STA 326+90

BEGIN RESURFACING
 SHERIDAN ROAD
 STA 301+62

END RESURFACING
 GLEN FLORA AVENUE
 STA 129+09

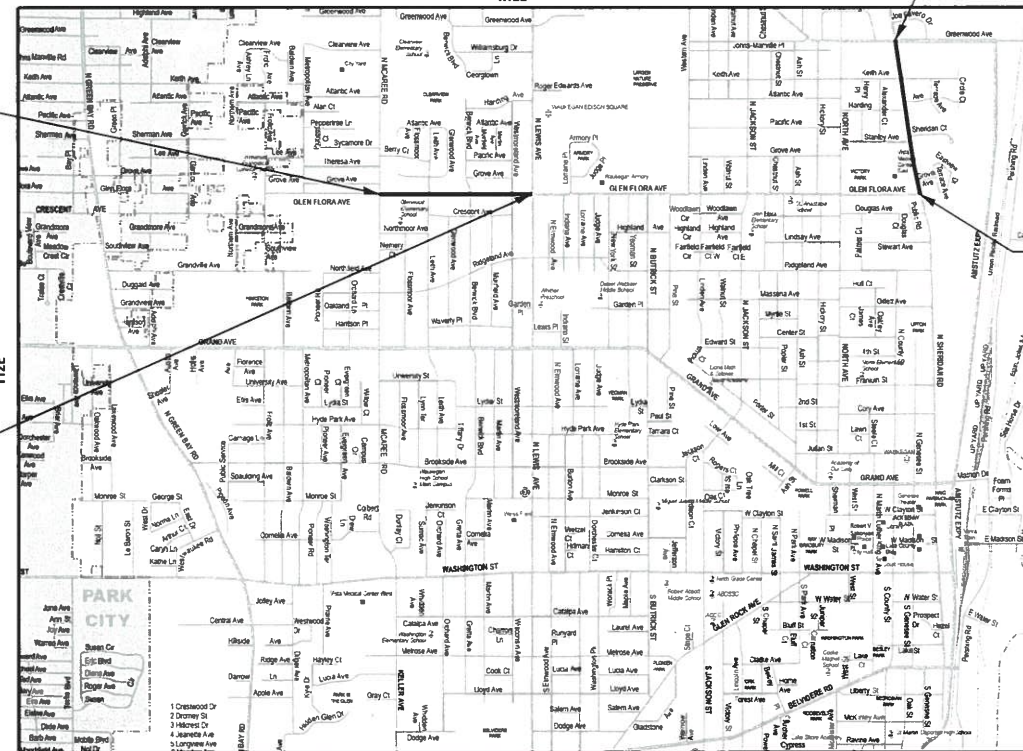

LOCATION MAP
 NOT TO SCALE
 GROSS LENGTH = 5,090 FT. = 0.96 MILE
 NET LENGTH = 5,090 FT. = 0.96 MILE

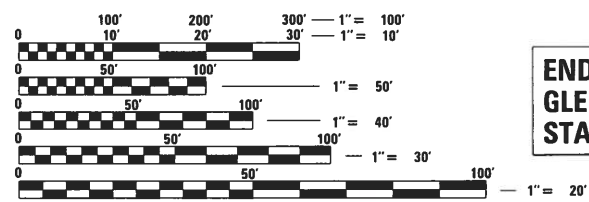

FULL SIZE PLANS HAVE BEEN PREPARED USING STANDARD ENGINEERING SCALES. REDUCED SIZED PLANS WILL NOT CONFORM TO STANDARD SCALES. IN MAKING MEASUREMENTS ON REDUCED PLANS, THE ABOVE SCALES MAY BE USED.

J.U.L.I.E. DESIGN STAGE REQUEST
 DIG. NO. A223611052, A223611055



CONTACT JULIE AT 811 OR 800-892-0123 WITH THE FOLLOWING:
 COUNTY = LAKE
 CITY-TWNSHP. = WAUKEGAN - ZION
 SEC. & 1/4 SEC. NO. = 9, 16, 17
 48 HOURS (2 working days) BEFORE YOU DIG

CONTRACT NO. 61J64

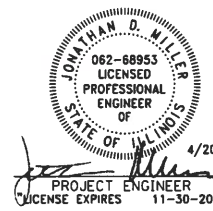

STATE OF ILLINOIS DEPARTMENT OF TRANSPORTATION DIVISION OF HIGHWAYS	
APPROVED	Jesus Alquicira, P.E. 4/20/23 CITY ENGINEER, CITY OF WAUKEGAN
PASSED	MAY 31, 2023 DISTRICT 1 ENGINEER OF LOCAL ROADS AND STREETS
RELEASING FOR BID BASED ON LIMITED REVIEW	MAY 31, 2023 REGIONAL ENGINEER

PRINTED BY THE AUTHORITY OF THE STATE OF ILLINOIS



FEDERAL AID PROGRAM ENGINEER: CARMEN E. RAMOS, P.E., SCHAUMBURG, IL

INDEX OF SHEETS

1	COVER
2	INDEX OF SHEETS, HIGHWAY STANDARDS AND GENERAL NOTES
3 - 6	SUMMARY OF QUANTITIES
7	TYPICAL SECTIONS
8 - 13	ROADWAY PLAN
14	MISCELLANEOUS DETAILS
15 - 23	DISTRICT ONE DETAILS

HIGHWAY STANDARDS

000001-08	STANDARD SYMBOLS, ABBREVIATIONS AND PATTERNS
424001-11	PERPENDICULAR CURB RAMPS FOR SIDEWALKS
442201-03	CLASS C AND D PATCHES
606001-08	CONCRETE CURB TYPE B AND COMBINATION CONCRETE CURB AND GUTTER
606306-04	CORRUGATED PC CONCRETE MEDIANS
701006-05	OFF-RD OPERATIONS, 2L, 2W, 15' (4.5 m) TO 24" (600 mm) FROM PAVEMENT EDGE
701101-05	OFF-RD OPERATIONS, MULTILANE, 15' (4.5 m) TO 24" (600 mm) FROM PAVEMENT EDGE
701301-04	LANE CLOSURE, 2L, 2W, SHORT TIME OPERATIONS
701311-03	LANE CLOSURE 2L, 2W MOVING OPERATIONS - DAY ONLY
701427-05	LANE CLOSURE, MULTILANE, INTERMITTENT OR MOVING OPER., FOR SPEEDS ≤ 40 MPH
701501-06	URBAN LANE CLOSURE, 2L, 2W, UNDIVIDED
701606-10	URBAN SINGLE LANE CLOSURE, MULTILANE, 2W WITH MOUNTABLE MEDIAN
701701-10	URBAN LANE CLOSURE, MULTILANE INTERSECTION
701801-06	SIDEWALK, CORNER OR CROSSWALK CLOSURE
701901-08	TRAFFIC CONTROL DEVICES
780001-05	TYPICAL PAVEMENT MARKINGS
886001-01	DETECTOR LOOP INSTALLATIONS
886006-01	TYPICAL LAYOUTS FOR DETECTION LOOPS

DISTRICT ONE DETAILS

BD-08	DETAILS FOR FRAMES AND LIDS ADJUSTMENT WITH MILLING
BD-22	PAVEMENT PATCHING FOR HMA SURFACED PAVEMENT
BD-24	CURB OR CURB AND GUTTER REMOVAL AND REPLACEMENT
BD-32	BUTT JOINT AND HMA TAPER DETAILS
TC-10	TRAFFIC CONTROL AND PROTECTION FOR SIDE ROADS, INTERSECTIONS, AND DRIVEWAYS
TC-13	DISTRICT ONE TYPICAL PAVEMENT MARKINGS
TC-16	SHORT TERM PAVEMENT MARKING LETTERS AND SYMBOLS
TC-22	ARTERIAL ROAD INFORMATION SIGN
TS-07	DISTRICT 1 - DETECTOR LOOP INSTALLATION DETAILS FOR ROADWAY RESURFACING

GENERAL NOTES

- ALL CONSTRUCTION SHALL BE DONE IN ACCORDANCE WITH THE DETAILS IN THE PLANS, THE SPECIAL PROVISIONS INCLUDED IN THE CONTRACT DOCUMENTS, AND THE FOLLOWING STATE OF ILLINOIS SPECIFICATIONS: "THE STANDARD SPECIFICATIONS FOR ROAD AND BRIDGE CONSTRUCTION" (REFERRED TO AS THE "STANDARD SPECIFICATIONS"), THE "SUPPLEMENTAL SPECIFICATIONS AND RECURRING SPECIAL PROVISIONS", THE "MANUAL ON UNIFORM TRAFFIC CONTROL DEVICES FOR STREETS AND HIGHWAYS", THE "MANUAL OF TEST PROCEDURES FOR MATERIALS" AND THE "STANDARD SPECIFICATIONS FOR WATER AND SEWER MAIN CONSTRUCTION IN ILLINOIS".
- UTILITY LOCATIONS HAVE NOT BEEN SHOWN ON THESE PLANS. THE CONTRACTOR SHALL BE RESPONSIBLE FOR THE PROTECTION OF ALL UNDERGROUND OR SURFACE UTILITIES, INCLUDING SPRINKLER SYSTEMS, EVEN THOUGH THEY MAY NOT BE SHOWN ON THE PLANS
- THE CONTRACTOR SHALL NOTIFY THE CITY PUBLIC WORKS ADMINISTRATOR (847-360-0944) AT LEAST 48 HOURS IN ADVANCE OF BEGINNING WORK TO OBTAIN CITY UTILITY LOCATIONS.
- THE CONTRACTOR MAY OBTAIN MUNICIPAL WATER IN BULK, AT NO CHARGE, AS LONG AS THERE IS NOT A "WATERING BAN" IN EFFECT. THE INDISCRIMINATE USE OF FIRE HYDRANTS IS STRICTLY PROHIBITED. WATER FOR CONSTRUCTION SHALL BE METERED OR OTHERWISE ACCOUNTED FOR AND A DAILY LOG MAINTAINED. THE CONTRACTOR SHALL PROVIDE THE WATER TRUCK AND DRIVER REQUIRED TO OBTAIN AND TRANSPORT THIS WATER. THE CITY RESERVES THE RIGHT TO RESTRICT OR REFUSE THE USE OF CITY WATER IF DEEMED NECESSARY.
- ACCESS TO PRIVATE DRIVEWAYS SHALL BE PROVIDED AT ALL TIMES EXCEPT DURING ACTUAL CONSTRUCTION ADJACENT THERE TO.
- IT WILL BE THE CONTRACTOR'S RESPONSIBILITY TO NOTIFY THE ENGINEER, RESIDENTS AND THE CITY WHEN ACCESS TO DRIVEWAYS WILL BE TEMPORARILY CLOSED DUE TO CURB AND GUTTER AND/OR DRIVEWAY REPLACEMENT. THE CONTRACTOR SHALL DISTRIBUTE NOTICES PROVIDED BY THE CITY TO RESIDENTS AT LEAST 24 HOURS PRIOR TO PLANNED CLOSURE. EVERY EFFORT SHALL BE MADE TO ACCOMMODATE ACCESS TO THESE PROPERTIES INCLUDING KNOCKING ON DOORS WHEN DRIVEWAYS ARE ABOUT TO BE CLOSED.
- THE DAYS PAVING OPERATION SHOULD RESULT IN A SINGLE TRANSVERSE JOINT. ANY COLD LONGITUDINAL JOINTS WILL NOT BE ACCEPTED. PROVIDING A SINGLE TRANSVERSE JOINT SHALL BE ACCOMPLISHED BY PAVING ONE LANE OF SUFFICIENT LENGTH THAT WILL ALLOW FOR THE PAVING OF THE ADJACENT LANE IN THE SAME DAY.
- DURING CONSTRUCTION, THE CONTRACTOR WILL BE PERMITTED TO LIMIT ON-STREET PARKING IN ORDER TO COMPLETE CONSTRUCTION OPERATIONS. THE CONTRACTOR WILL BE REQUIRED TO COORDINATE WITH THE MUNICIPALITY A MINIMUM OF 48 HOURS IN ADVANCE. IT WILL BE THE RESPONSIBILITY OF THE CONTRACTOR TO PLACE ADVANCE SIGNS TO ALERT RESIDENTS AND COMMUTERS OF THE CONSTRUCTION WORK. THE PLACEMENT OF THESE SIGNS SHALL TAKE PLACE 48 HOURS IN ADVANCE IN ORDER TO ALLOW SUFFICIENT TIME FOR RESIDENTS AND GENERAL PUBLIC TO REVISE THEIR PARKING PATTERNS.
- WHEN MILLED PAVEMENT IS OPEN TO TRAFFIC, THE MAXIMUM GRADE DIFFERENTIAL BETWEEN PASSES OF THE MILLING MACHINE SHALL NOT EXCEED 1 1/2 INCHES WHERE THE SPEED LIMIT IS 45 MPH OR LESS, AND SHALL NOT EXCEED 1 INCH WHERE THE SPEED LIMIT IS OVER 45 MPH. A MAXIMUM GRADE DIFFERENCE OF 3 INCHES MAY BE ALLOWED IF THE EDGE OF THE MILLING IS SLOPED A MINIMUM OF 1:3 (V:H), AS DETERMINED BY THE ENGINEER.
- CONTRACTOR SHALL TAKE PRECAUTION BY PRESERVING EXISTING TREES WITHIN THE RIGHT OF WAY. IF ANY DAMAGE OCCURS, TREES SHALL BE REPLACED IN KIND PER ARTICLE 201.07 REPAIR OR REPLACEMENT OF EXISTING PLANT MATERIAL REQUIREMENTS STATED HEREIN.
- ALL NITROGEN, PHOSPHOROUS AND POTASSIUM FERTILIZER NUTRIENTS HAVE BEEN INTENTIONALLY OMITTED FROM THE CONTRACT ON THE SODDING APPLICATION.
- THE CONTRACTOR SHALL CONTACT KALPANA KANNAN-HOSADURGA, THE DISTRICT ONE TRAFFIC CONTROL SUPERVISOR, AT KALPANA.KANNAN-HOSADURGA@ILLINOIS.GOV A MINIMUM OF 72 HOURS IN ADVANCE OF BEGINNING WORK.

COMMITMENTS

NONE

STATE OF ILLINOIS - PROFESSIONAL DESIGN FIRM
 LICENSE NO. - 184-001121 - EXPIRES 4/30/2024
 jmiller 5/17/2023 5:53:30 PM
 FILE NAME: P:\WAUKC\220047-2022_STP_Project\CAD\Sheets_Phase 0\220047_SHT-GenNotes.dgn

	USER NAME = jmiller	DESIGNED - CG	REVISED -
		DRAWN - KAR	REVISED -
	PLOT SCALE = 20.0000 ' / in.	CHECKED - JDM	REVISED -
	PLOT DATE = 5/17/2023	DATE - 04-19-2023	FILE - 220047_SHT-GenNotes.dgn

STATE OF ILLINOIS
 DEPARTMENT OF TRANSPORTATION

INDEX OF SHEETS, HIGHWAY STANDARDS AND GENERAL NOTES			
SCALE:	NONE	SHEET 1 OF 1 SHEETS	STA. TO STA.

F.A.U. RTE.	SECTION	COUNTY	TOTAL SHEETS	SHEET NO.
1219	22-00244-00-R5	LAKE	23	2
2736		ILLINOIS	CONTRACT NO. 61164	

SUMMARY OF QUANTITIES

CODE NO.	ITEM	UNIT	TOTAL QUANTITY	CONSTRUCTION CODE	
				GLEN FLORA AVE 80% FED 20% LOCAL	SHERIDAN RD 100% FED
				ROADWAY	ROADWAY
				0005 URBAN	0005 URBAN
20200100	EARTH EXCAVATION	CU YD	226	115	111
20201200	REMOVAL AND DISPOSAL OF UNSUITABLE MATERIAL	CU YD	1,153	777	376
21001000	GEOTECHNICAL FABRIC FOR GROUND STABILIZATION	SQ YD	552	344	208
21101615	TOPSOIL FURNISH AND PLACE, 4"	SQ YD	1,075	620	455
25200110	SODDING, SALT TOLERANT	SQ YD	1,075	620	455
25200200	SUPPLEMENTAL WATERING	UNIT	54	31	23
28000510	INLET FILTERS	EACH	46	22	24
30300001	AGGREGATE SUBGRADE IMPROVEMENT	CU YD	1,033	708	325
35101600	AGGREGATE BASE COURSE, TYPE B 4"	SQ YD	1,877	1,008	869
35102000	AGGREGATE BASE COURSE, TYPE B 8"	SQ YD	75	10	65
40600290	BITUMINOUS MATERIALS (TACK COAT)	POUND	17,780	9,560	8,220
40600370	LONGITUDINAL JOINT SEALANT	FOOT	10,180	5,124	5,056
40600400	MIXTURE FOR CRACKS, JOINTS, AND FLANGEWAYS	TON	35	19	16
40600982	HOT-MIX ASPHALT SURFACE REMOVAL - BUTT JOINT	SQ YD	304	163	141
40603200	POLYMERIZED HOT-MIX ASPHALT BINDER COURSE, IL-4.75, N50	TON	1,107	595	512

* INDICATES SPECIALTY ITEM

STATE OF ILLINOIS - PROFESSIONAL DESIGN FIRM
 LICENSE NO. - 184-001121 - EXPIRES 4/30/2024
 jtmiller 5/17/2023 3:35:34 PM
 FILE NAME: P:\WAUKKC220047-2023 STP Projects\CAD\Sheets Phase 03220047_SHT-SOQ.dgn



USER NAME = jtmiller	DESIGNED - CG	REVISED -
	DRAWN - KAR	REVISED -
PLOT SCALE = 20.0000' / in.	CHECKED - JDM	REVISED -
PLOT DATE = 5/17/2023	DATE - 04-19-2023	FILE - 220047_SHT-SOQ.dgn

STATE OF ILLINOIS
DEPARTMENT OF TRANSPORTATION

SUMMARY OF QUANTITIES

SCALE: NONE SHEET 1 OF 4 SHEETS STA. TO STA.

F.A.U. RTE.	SECTION	COUNTY	TOTAL SHEETS	SHEET NO.
1219	22-00244-00-R5	LAKE	23	3
2736			CONTRACT NO. 61164	
		ILLINOIS		

SUMMARY OF QUANTITIES

CODE NO.	ITEM	UNIT	TOTAL QUANTITY	CONSTRUCTION CODE	
				GLEN FLORA AVE 80% FED 20% LOCAL	SHERIDAN RD 100% FED
				ROADWAY	ROADWAY
				0005 URBAN	0005 URBAN
40604060	HOT-MIX ASPHALT SURFACE COURSE, IL-9.5, MIX "D", N50	TON	2,580	1,387	1,193
42300200	PORTLAND CEMENT CONCRETE DRIVEWAY PAVEMENT, 6 INCH	SQ YD	256	96	160
42300400	PORTLAND CEMENT CONCRETE DRIVEWAY PAVEMENT, 8 INCH	SQ YD	56	16	40
42400200	PORTLAND CEMENT CONCRETE SIDEWALK 5 INCH	SQ FT	7,229	3,825	3,404
42400800	DETECTABLE WARNINGS	SQ FT	240	120	120
44000158	HOT-MIX ASPHALT SURFACE REMOVAL, 2 1/4"	SQ YD	26,319	14,150	12,169
44000200	DRIVEWAY PAVEMENT REMOVAL	SQ YD	331	106	225
44000500	COMBINATION CURB AND GUTTER REMOVAL	FOOT	2,652	1,640	1,012
44000600	SIDEWALK REMOVAL	SQ FT	7,229	3,825	3,404
44201717	CLASS D PATCHES, TYPE II, 6 INCH	SQ YD	489	269	220
44201721	CLASS D PATCHES, TYPE III, 6 INCH	SQ YD	761	383	378
44201723	CLASS D PATCHES, TYPE IV, 6 INCH	SQ YD	954	722	232
60603800	COMBINATION CONCRETE CURB AND GUTTER, TYPE B-6.12	FOOT	2,652	1,640	1,012
* 66900200	NON-SPECIAL WASTE DISPOSAL	CU YD	30	20	10
* 66900530	SOIL DISPOSAL ANALYSIS	EACH	4	2	2

* INDICATES SPECIALTY ITEM

STATE OF ILLINOIS - PROFESSIONAL DESIGN FIRM
 LICENSE NO. - 184-001121 - EXPIRES 4/30/2024
 jtmiller - 5/17/2023 3:35:35 PM
 FILE NAME: P:\WAUKKC220047-2023 STP Projects\CAD\Sheets_Phase III\220047_SHT-SOQ.dgn



USER NAME = jtmiller	DESIGNED - CG	REVISED -
	DRAWN - KAR	REVISED -
PLOT SCALE = 20.0000' / in.	CHECKED - JDM	REVISED -
PLOT DATE = 5/17/2023	DATE - 04-19-2023	FILE - 220047_SHT-SOQ.dgn

STATE OF ILLINOIS
DEPARTMENT OF TRANSPORTATION

SUMMARY OF QUANTITIES

SCALE: NONE SHEET 2 OF 4 SHEETS STA. TO STA.

F.A.U. RTE.	SECTION	COUNTY	TOTAL SHEETS	SHEET NO.
1219	22-00244-00-R5	LAKE	23	4
2736			CONTRACT NO. 61164	
		ILLINOIS		

SUMMARY OF QUANTITIES

CODE NO.	ITEM	UNIT	TOTAL QUANTITY	CONSTRUCTION CODE	
				GLEN FLORA AVE 80% FED 20% LOCAL	SHERIDAN RD 100% FED
				ROADWAY	ROADWAY
				0005	0005
URBAN	URBAN				
* 66901001	REGULATED SUBSTANCES PRE-CONSTRUCTION PLAN	L SUM	1	0.54	0.46
* 66901003	REGULATED SUBSTANCES FINAL CONSTRUCTION REPORT	L SUM	1	0.54	0.46
* 66901006	REGULATED SUBSTANCES MONITORING	CAL DA	30	15	15
67100100	MOBILIZATION	L SUM	1	0.54	0.46
70102620	TRAFFIC CONTROL AND PROTECTION, STANDARD 701501	L SUM	1	0.54	0.46
70102625	TRAFFIC CONTROL AND PROTECTION, STANDARD 701606	L SUM	1		1
70102635	TRAFFIC CONTROL AND PROTECTION, STANDARD 701701	L SUM	1	0.54	0.46
70102640	TRAFFIC CONTROL AND PROTECTION, STANDARD 701801	L SUM	1	0.54	0.46
70300100	SHORT TERM PAVEMENT MARKING	FOOT	11,310	5,740	5,570
70300150	SHORT TERM PAVEMENT MARKING REMOVAL	SQ FT	3,950	2,090	1,860
* 78000100	THERMOPLASTIC PAVEMENT MARKING - LETTERS AND SYMBOLS	SQ FT	110	73	37
* 78000200	THERMOPLASTIC PAVEMENT MARKING - LINE 4"	FOOT	5,156	1,894	3,262
* 78000400	THERMOPLASTIC PAVEMENT MARKING - LINE 6"	FOOT	781	320	461
* 78000600	THERMOPLASTIC PAVEMENT MARKING - LINE 12"	FOOT	476	400	76
* 78000650	THERMOPLASTIC PAVEMENT MARKING - LINE 24"	FOOT	93	93	

* INDICATES SPECIALTY ITEM

STATE OF ILLINOIS - PROFESSIONAL DESIGN FIRM
 LICENSE NO. - 184-001121 - EXPIRES 4/30/2024
 jmiller 5/17/2023 3:53:37 PM
 FILE NAME: P:\WAUKKC220047-2023 STP Projects\CAD\Sheets Phase 03220047_SHT-SOQ.dgn



USER NAME = jmiller	DESIGNED - CG	REVISED -
	DRAWN - KAR	REVISED -
PLOT SCALE = 20.0000' / in.	CHECKED - JDM	REVISED -
PLOT DATE = 5/17/2023	DATE - 04-19-2023	FILE - 220047_SHT-SOQ.dgn

STATE OF ILLINOIS
DEPARTMENT OF TRANSPORTATION

SUMMARY OF QUANTITIES

SCALE: NONE SHEET 3 OF 4 SHEETS STA. TO STA.

F.A.U. RTE.	SECTION	COUNTY	TOTAL SHEETS	SHEET NO.
1219	22-00244-00-R5	LAKE	23	5
2736				CONTRACT NO. 61164
		ILLINOIS		

SUMMARY OF QUANTITIES

CODE NO.	ITEM	UNIT	TOTAL QUANTITY	CONSTRUCTION CODE	
				GLEN FLORA AVE 80% FED 20% LOCAL	SHERIDAN RD 100% FED
				ROADWAY	ROADWAY
				0005 URBAN	0005 URBAN
* 8B600600	DETECTOR LOOP REPLACEMENT	FOOT	268	201	67
Z0004510	HOT-MIX ASPHALT DRIVEWAY PAVEMENT, 3"	SQ YD	44	10	34
Z0004522	HOT-MIX ASPHALT DRIVEWAY PAVEMENT, 6"	SQ YD	31		31
Z0012750	CONCRETE MEDIAN REPAIR	SQ FT	518		518
Z0017400	DRAINAGE & UTILITY STRUCTURES TO BE ADJUSTED	EACH	16	8	8
Z0017700	DRAINAGE & UTILITY STRUCTURES TO BE RECONSTRUCTED	EACH	6	3	3
Z0030850	TEMPORARY INFORMATION SIGNING	SQ FT	104	52	52
X4021000	TEMPORARY ACCESS (PRIVATE ENTRANCE)	EACH	15	5	10
X4022000	TEMPORARY ACCESS (COMMERCIAL ENTRANCE)	EACH	3	1	2
X6026050	SANITARY MANHOLES TO BE ADJUSTED	EACH	12	2	10
X6026051	SANITARY MANHOLES TO BE RECONSTRUCTED	EACH	1		1
X6030310	FRAMES AND LIDS TO BE ADJUSTED (SPECIAL)	EACH	33	10	23

* INDICATES SPECIALTY ITEM

STATE OF ILLINOIS - PROFESSIONAL DESIGN FIRM
 LICENSE NO. - 184-001121 - EXPIRES 4/30/2024
 jmiller 5/17/2023 3:35:38 PM
 MODEL: Default
 FILE NAME: P:\WAUKIC\220047-2022 STP Projects\CAD\Sheets Phase II\220047_SHT-SOQ.dgn



USER NAME = jmiller	DESIGNED - CG	REVISED -
PLOT SCALE = 20,0000' / in.	DRAWN - KAR	REVISED -
PLOT DATE = 5/17/2023	CHECKED - JDM	REVISED -
	DATE - 04-19-2023	FILE - 220047_SHT-SOQ.dgn

STATE OF ILLINOIS
DEPARTMENT OF TRANSPORTATION

SUMMARY OF QUANTITIES

SCALE: NONE SHEET 4 OF 4 SHEETS STA. TO STA.

F.A.U. RTE.	SECTION	COUNTY	TOTAL SHEETS	SHEET NO.
1219	22-00244-00-RS	LAKE	23	6
2736				
	ILLINOIS			CONTRACT NO. 61J64

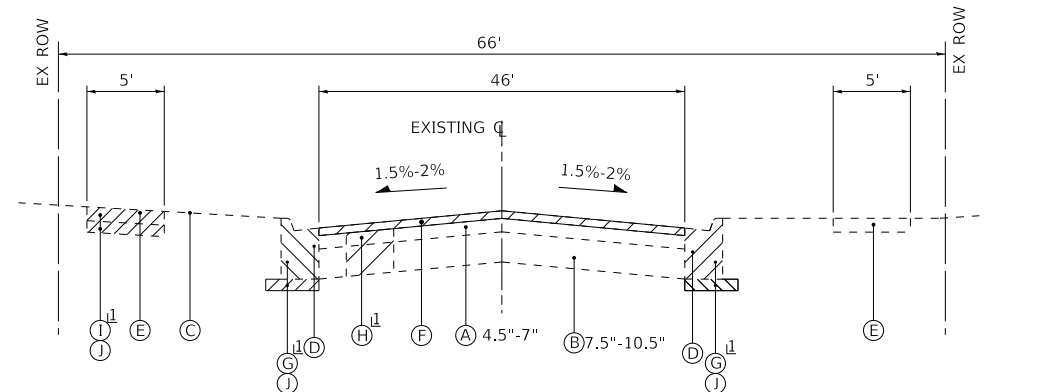

EXISTING TYPICAL SECTION
GLEN FLORA AVE
┆ LOCATIONS DETERMINED BY ENGINEER

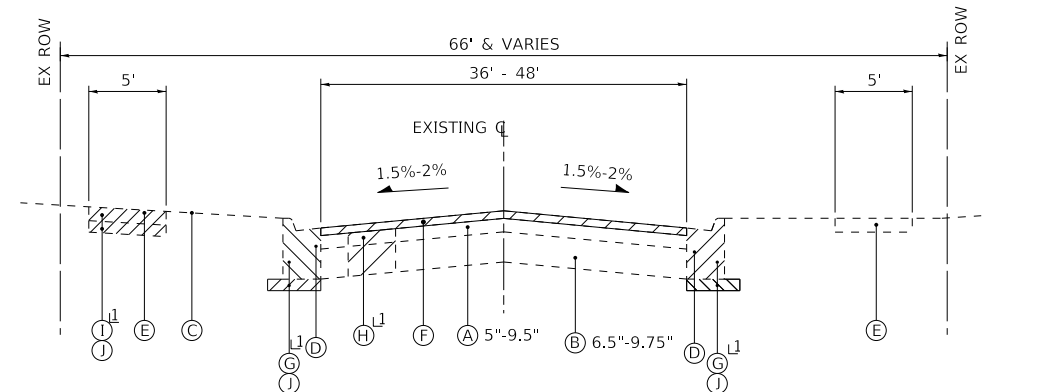

EXISTING TYPICAL SECTION
SHERIDAN ROAD
┆ LOCATIONS DETERMINED BY ENGINEER

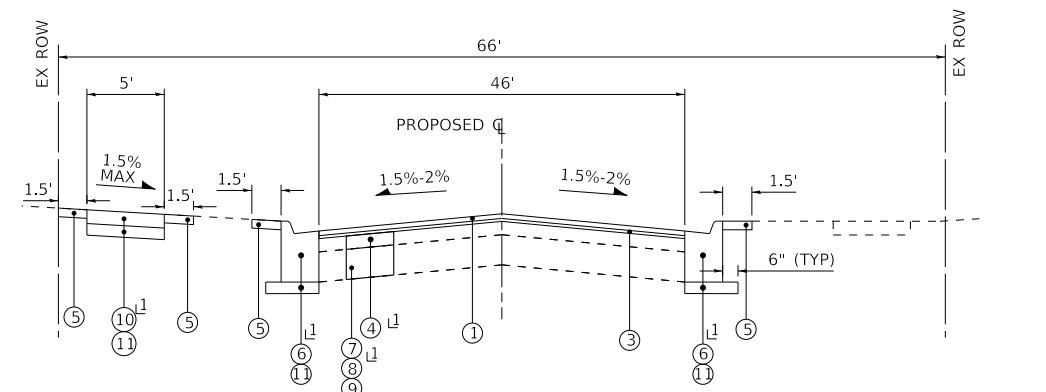

PROPOSED TYPICAL SECTION
GLEN FLORA AVE
┆ LOCATIONS DETERMINED BY ENGINEER

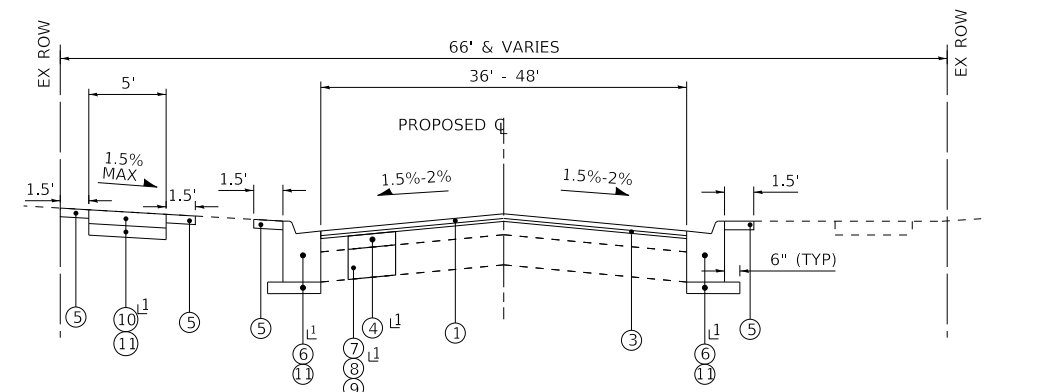

PROPOSED TYPICAL SECTION
SHERIDAN ROAD
┆ LOCATIONS DETERMINED BY ENGINEER

LONGITUDINAL JOINT SEALANT SHALL BE PLACED OVER THE POLYMERIZED HOT-MIX ASPHALT BINDER COURSE, IL-4.75, N50.

NOTE:
GEOTECHNICAL FABRIC FOR GROUND STABILIZATION AND/OR AGGREGATE SUBGRADE IMPROVEMENT (CU YD) HAVE BEEN PROVIDED FOR USE AT THE LOCATIONS INDICATED FOR SOILS THAT TEND TO BE UNSTABLE AND/OR UNSUITABLE. THE ACTUAL NEED FOR REMOVAL AND REPLACEMENT WITH ABOVE ITEM WILL BE DETERMINED IN THE FIELD AT THE TIME OF CONSTRUCTION BY THE GEOTECHNICAL ENGINEER. ALL POTENTIALLY UNSTABLE SOILS SHOULD BE TESTED WITH A STATIC OR DYNAMIC CONE PENETROMETER AND TREATED IN ACCORDANCE WITH ARTICLE 301.04 OF THE STANDARD SPECIFICATIONS AND IDOT SUBGRADE STABILITY MANUAL. IF UNSTABLE AND/OR UNSUITABLE SOILS ARE NOT ENCOUNTERED, THEN THE QUANTITY SHALL BE DEDUCTED AND NO ADDITIONAL COMPENSATION WILL BE DUE TO THE CONTRACTOR.

ANY AGGREGATE SUBGRADE IMPROVEMENT CONTAMINATED AND/OR DAMAGED BY THE CONTRACTOR'S VEHICLES AND/OR EQUIPMENT IS TO BE REMOVED AND REPLACED AS DIRECTED BY THE ENGINEER AT CONTRACTOR EXPENSE.

CONTRACTOR SHALL MILL BEFORE PATCHING.

EXISTING LEGEND

- (A) EXISTING HMA BINDER & SURFACE COURSE
- (B) EXISTING AGGREGATE BASE COURSE
- (C) GROUND SURFACE
- (D) EXISTING COMBINATION CURB AND GUTTER
- (E) EXISTING SIDEWALK
- (F) HOT-MIX ASPHALT SURFACE REMOVAL - 2 1/4"
- (G) REMOVE EXISTING COMBINATION CURB & GUTTER
- (H) REMOVAL FOR CLASS D PATCH
- (I) SIDEWALK REMOVAL
- (J) EARTH EXCAVATION
- ☒ REMOVAL ITEM

PROPOSED LEGEND

- (1) HOT-MIX ASPHALT SURFACE COURSE, IL-9.5, MIX "D", N50 - 1 3/4"
- (2) NOT USED
- (3) POLYMERIZED HOT-MIX ASPHALT BINDER COURSE, IL-4.75, N50 - 3/4"
- (4) CLASS D PATCHES 6"
- (5) SODDING, SALT TOLERANT TOPSOIL FURNISH AND PLACE, 4"
- (6) COMBINATION CONCRETE CURB AND GUTTER, TYPE B-6.12
- (7) AGGREGATE SUBGRADE IMPROVEMENT
- (8) REMOVAL AND DISPOSAL OF UNSUITABLE MATERIALS
- (9) GEOTECHNICAL FABRIC FOR GROUND STABILIZATION
- (10) PORTLAND CEMENT CONCRETE SIDEWALK 5 INCH
- (11) AGGREGATE BASE COURSE, TYPE B 4"

HOT-MIX ASPHALT MIXTURE REQUIREMENTS

MIXTURE TYPE	AIR VOIDS @ Ndes	QMP
PAVEMENT RESURFACING		
HOT-MIX ASPHALT SURFACE COURSE, IL-9.5, MIX "D", N50; 1 3/4"	4% @ 50 Gyr.	LR1030-2
POLYMERIZED HOT-MIX ASPHALT BINDER COURSE, IL-4.75, N50; 3/4"	3.5% @ 50 Gyr.	LR1030-2
HOT-MIX ASPHALT DRIVEWAY PAVEMENT, 3"		
HOT-MIX ASPHALT SURFACE COURSE, IL-9.5, MIX "D", N50; 3" (IN 2 LIFTS)	4% @ 50 Gyr.	LR1030-2
HOT-MIX ASPHALT DRIVEWAY PAVEMENT, 6"		
HOT-MIX ASPHALT SURFACE COURSE, IL-9.5, MIX "D", N50; 2"	4% @ 50 Gyr.	LR1030-2
HOT-MIX ASPHALT BINDER COURSE, IL-19.0, N50; 4"	4% @ 50 Gyr.	LR1030-2
PATCHING		
CLASS D PATCHES (HMA BINDER IL-19.0mm); 6"	4% @ 70 Gyr.	LR1030-2
QMP designation: Quality Control/Quality Assurance (QC/QA) PER LR1030-2		

NOTES:
1. THE UNIT WEIGHT USED TO CALCULATE ALL HMA SURFACE MIXTURE QUANTITIES IS 112 LBS/SQ YD/IN.
2. THE "AC TYPE" FOR POLYMERIZED HMA MIXES SHALL BE "SBS/SBR PG 76 -22" AND FOR NON-POLYMERIZED HMA THE "AC TYPE" SHALL BE "PG 64 -22" UNLESS MODIFIED BY RECLAIMED MATERIALS SPECIFICATIONS.

STATE OF ILLINOIS - PROFESSIONAL DESIGN FIRM
 LICENSE NO. - 184-001121 - EXPIRES 4/30/2024
 jtmiller 5/17/2023 3:35:41 PM
 FILE NAME: P:\WAKK\220047-2022_STP_Project\CAD\Sheets_Phase 03\220047_SHT-TypSec.dgn
 ...:\old\drv\pdf\BW_Default.plt
 ...:\CAD\PIPs\220047_Per.rtd
 P:\WAKK\220047-2022_STP_Project\CAD\Sheets_Phase 03\220047_SHT-TypSec.dgn



USER NAME = jtmiller	DESIGNED - CG	REVISED -
PLOT SCALE = 20.0000' / in.	DRAWN - KAR	REVISED -
PLOT DATE = 5/17/2023	CHECKED - JDM	REVISED -
	DATE - 04-19-2023	FILE - 220047_SHT-TypSec.dgn

STATE OF ILLINOIS
DEPARTMENT OF TRANSPORTATION

TYPICAL SECTIONS AND HOT-MIX ASPHALT REQUIREMENTS

SCALE: NONE SHEET 1 OF 1 SHEETS STA. TO STA.

F.A.U. RTE.	SECTION	COUNTY	TOTAL SHEETS	SHEET NO.
1219	22-00244-00-R5	LAKE	23	7
2736			CONTRACT NO. 61164	
	ILLINOIS			

STATE OF ILLINOIS - PROFESSIONAL DESIGN FIRM
 LICENSE NO. - 184-001121 - EXPIRES 4/30/2024
 jrmiller - 5/17/2023 3:55:44 PM
 FILE NAME: P:\WAUKC\220047-2022_STP_Project\CAD\Sheets_Phase II\220047_SHT-Plan1_GlenFlora.dgn

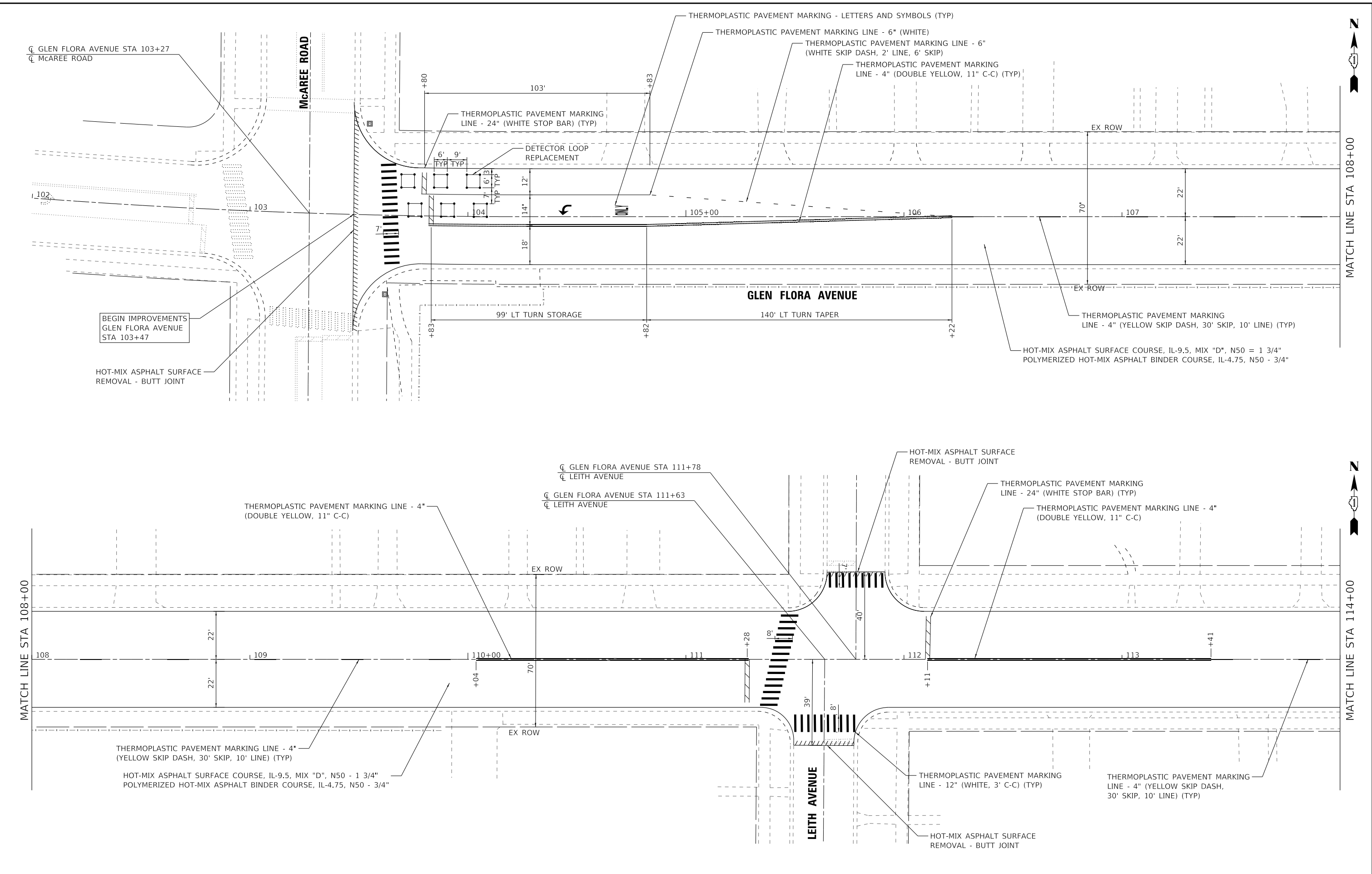

	USER NAME = jrmiller	DESIGNED - CG	REVISED -
		DRAWN - KAR	REVISED -
	PLOT SCALE = 20.0000' / in.	CHECKED - JDM	REVISED -
	PLOT DATE = 5/17/2023	DATE - 04-19-2023	FILE - 220047_SHT-Plan1_GlenFlora.dgn

STATE OF ILLINOIS
DEPARTMENT OF TRANSPORTATION

ROADWAY PLAN GLEN FLORA AVENUE		
SCALE: 1" = 20'	SHEET 1 OF 3 SHEETS	STA. 102+00 TO STA. 114+00

F.A.U. RTE.	SECTION	COUNTY	TOTAL SHEETS	SHEET NO.
1219	22-00244-00-R5	LAKE	23	8
CONTRACT NO. 61164			ILLINOIS	

STATE OF ILLINOIS - PROFESSIONAL DESIGN FIRM
 LICENSE NO. - 184-001121 - EXPIRES 4/30/2024
 jtmiller
 5/17/2023 3:53:45 PM
 FILE NAME: P:\WAUKC\220047-2022_STP_Project\CAD\Sheets_Phase II\220047_SHT-Plan2_GlenFlora.dgn

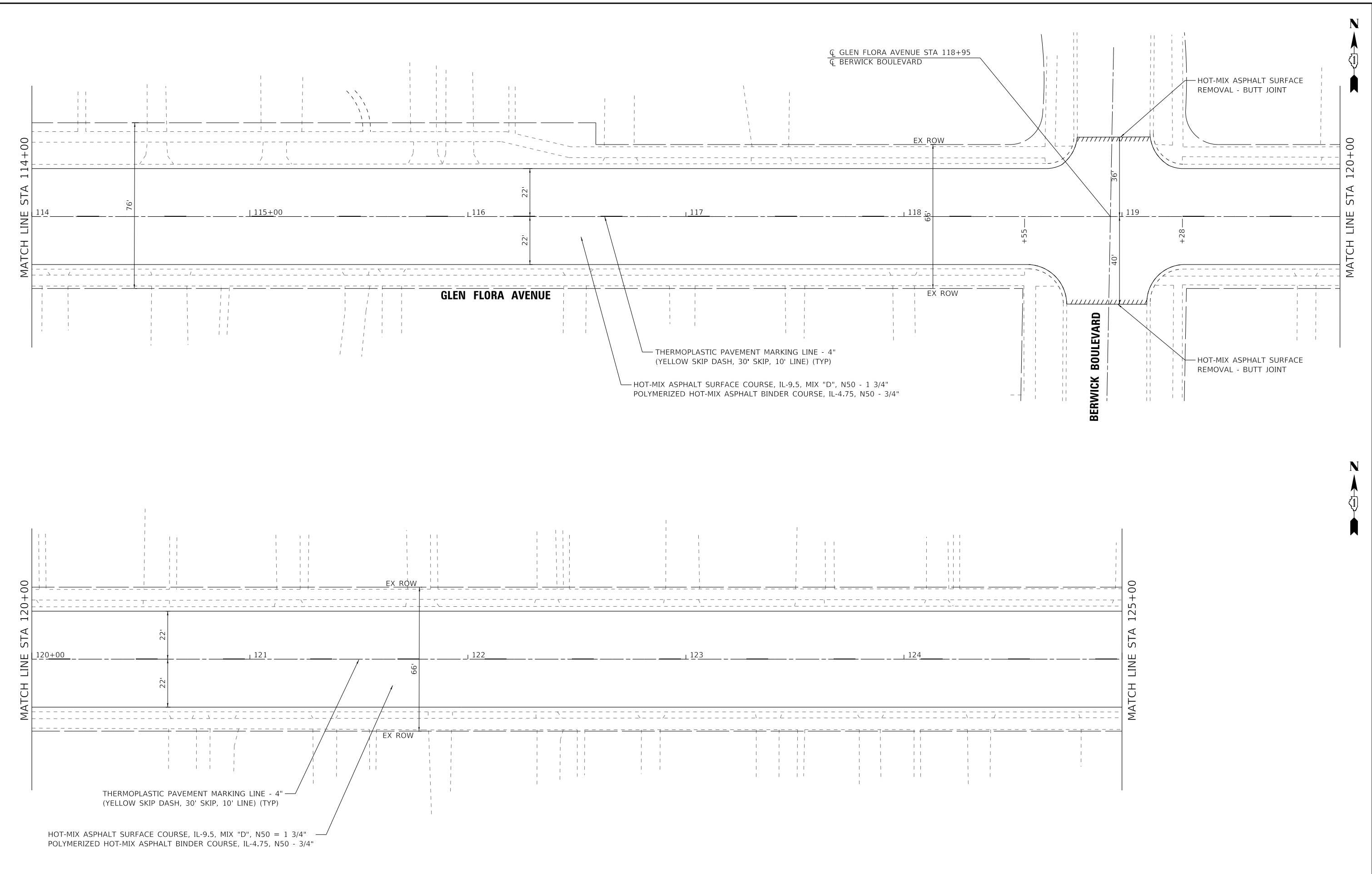

BAXTER & WOODMAN Consulting Engineers	USER NAME = jtmiller	DESIGNED - CG	REVISED -
	PLOT SCALE = 20.0000' / in.	DRAWN - KAR	REVISED -
	PLOT DATE = 5/17/2023	CHECKED - JDM	REVISED -
		DATE - 04-19-2023	FILE - 220047_SHT-Plan2_GlenFlora.dgn

STATE OF ILLINOIS
 DEPARTMENT OF TRANSPORTATION

ROADWAY PLAN
GLEN FLORA AVENUE

SCALE: 1" = 20' SHEET 2 OF 3 SHEETS STA. 114+00 TO STA. 125+00

F.A.U. RTE.	SECTION	COUNTY	TOTAL SHEETS	SHEET NO.
1219	22-00244-00-R5	LAKE	23	9
CONTRACT NO. 61164			ILLINOIS	

STATE OF ILLINOIS - PROFESSIONAL DESIGN FIRM
 LICENSE NO. - 184-001121 - EXPIRES 4/30/2024
 jtmiller
 5/17/2023 3:53:45 PM
 FILE NAME: P:\WAKK\220047-2022_STP_Project\CAD\Sheets_Phase 03\220047_SHT-Plan3_GlenFlora.dgn

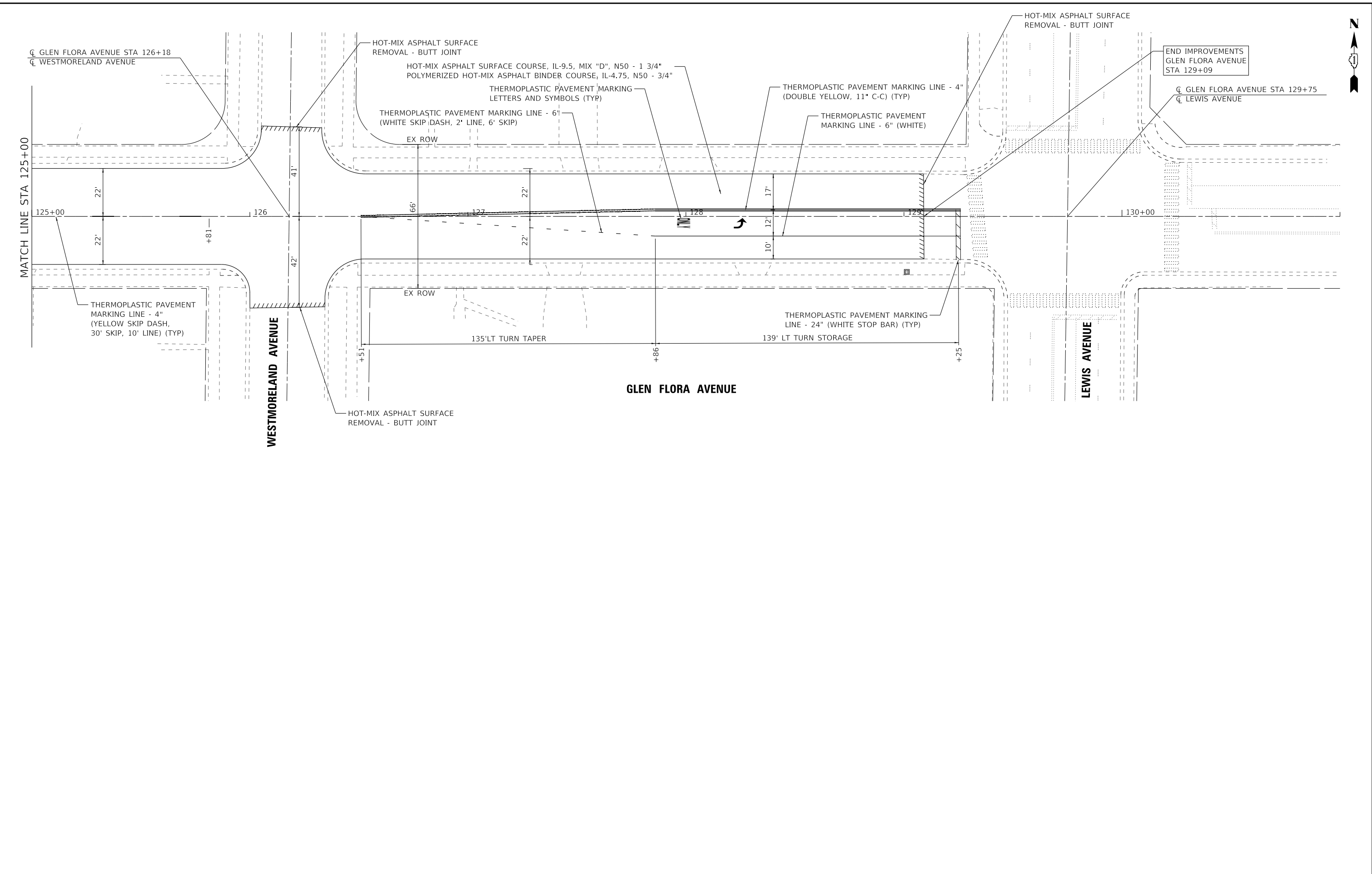

	USER NAME = jtmiller	DESIGNED - CG	REVISED -
	PLOT SCALE = 20.0000' / in.	DRAWN - KAR	REVISED -
	PLOT DATE = 5/17/2023	CHECKED - JDM	REVISED -
		DATE - 04-19-2023	FILE - 220047_SHT-Plan3_GlenFlora.dgn

STATE OF ILLINOIS
 DEPARTMENT OF TRANSPORTATION

ROADWAY PLAN
 GLEN FLORA AVENUE

SCALE: 1" = 20' SHEET 3 OF 3 SHEETS STA. 125+00 TO STA. 131+00

F.A.U. RTE.	SECTION	COUNTY	TOTAL SHEETS	SHEET NO.
1219	22-00244-00-R5	LAKE	23	10
ILLINOIS			CONTRACT NO. 61164	

STATE OF ILLINOIS - PROFESSIONAL DESIGN FIRM
 LICENSE NO. - 184-001121 - EXPIRES 4/30/2024
 jtmiller
 5/17/2023 5:35:46 PM
 FILE NAME: P:\WAUKC\220047-2022_STP_Project\CAD\Sheets_Phase II\220047_SHT-Plan8_SheridanNorth.dgn

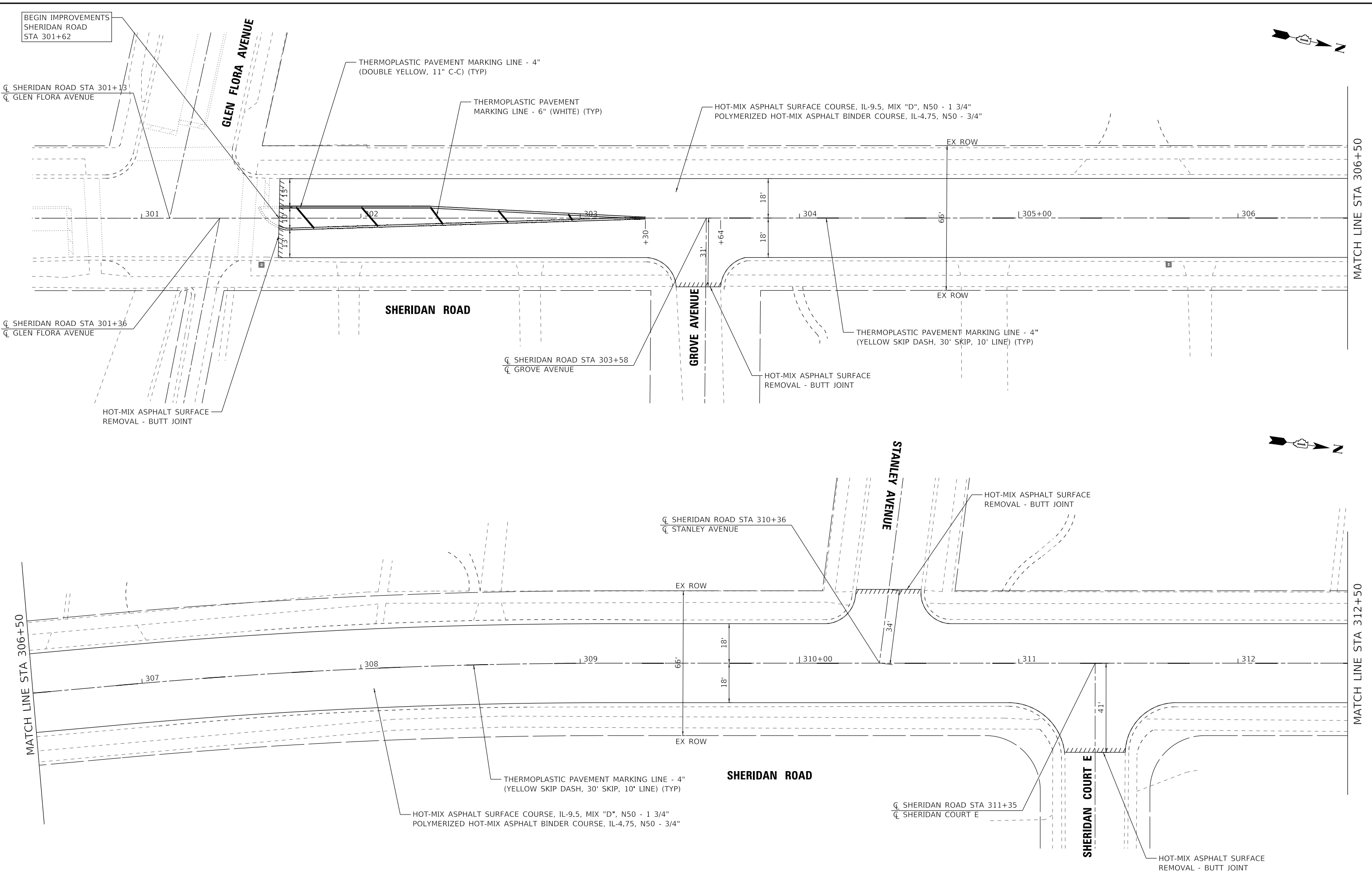

BAXTER & WOODMAN
 Consulting Engineers

USER NAME = jtmiller	DESIGNED - CG	REVISED -
DRAWN - KAR	REVISOR -	
PLOT SCALE = 20.0000' / in.	CHECKED - JDM	REVISOR -
PLOT DATE = 5/17/2023	DATE - 04-19-2023	FILE - 220047_SHT-Plan8_SheridanNorth.dgn

STATE OF ILLINOIS
 DEPARTMENT OF TRANSPORTATION

ROADWAY PLAN
SHERIDAN ROAD

SCALE: 1" = 20' SHEET 1 OF 3 SHEETS STA. 300+50 TO STA. 312+50

F.A.U. RTE.	SECTION	COUNTY	TOTAL SHEETS	SHEET NO.
2736	22-00244-00-R5	LAKE	23	11
CONTRACT NO. 61164			ILLINOIS	

STATE OF ILLINOIS - PROFESSIONAL DESIGN FIRM
 LICENSE NO. - 184-001121 - EXPIRES 4/30/2024
 jtmiller - 5/17/2023 3:53:47 PM
 FILE NAME: P:\WAUKC\220047-2022_STP_Project\CAD\Sheets_Phase II\220047_SHT-Plan9_SheridanNorth.dgn

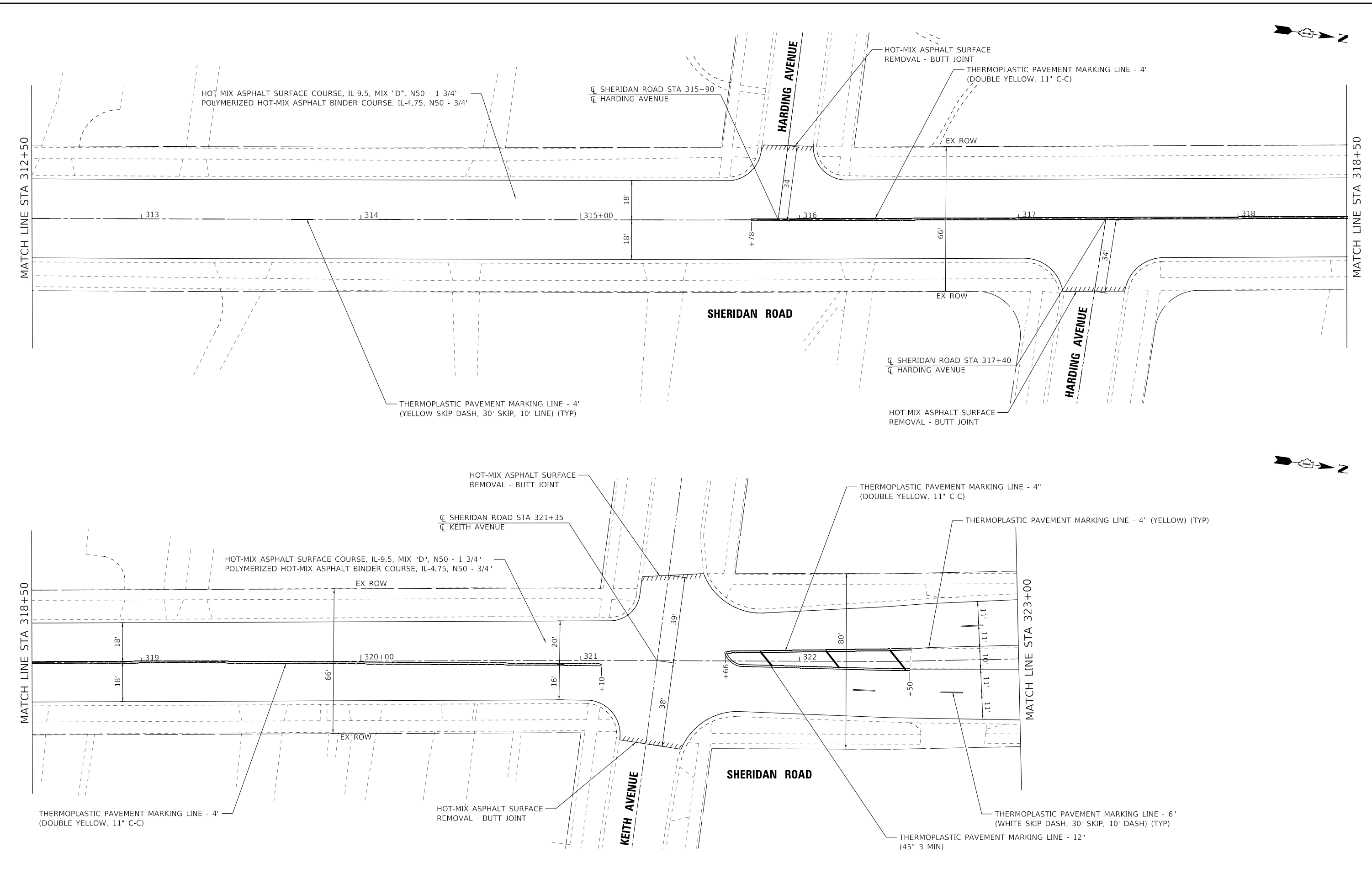

	USER NAME = jtmiller	DESIGNED - CG	REVISED -	STATE OF ILLINOIS DEPARTMENT OF TRANSPORTATION	ROADWAY PLAN SHERIDAN ROAD			F.A.U. RTE. = 2736	SECTION = 22-00244-00-R5	COUNTY = LAKE	TOTAL SHEETS = 23	SHEET NO. = 12
	PLOT SCALE = 20.0000' / in.	CHECKED - JDM	REVISED -					SCALE: 1" = 20'	SHEET 2 OF 3 SHEETS	STA. 312+50 TO STA. 323+00	CONTRACT NO. 61164	
	PLOT DATE = 5/17/2023	DATE = 04-19-2023	FILE = 220047_SHT-Plan9_SheridanNorth.dgn							ILLINOIS		

STATE OF ILLINOIS - PROFESSIONAL DESIGN FIRM
 LICENSE NO. - 184-001121 - EXPIRES 4/30/2024
 jmiller
 5/17/2023 3:53:48 PM
 FILE NAME: P:\WAKK\220047-2022_STP_Project\CAD\Sheets_Phase 10\SheridanNorth.dgn

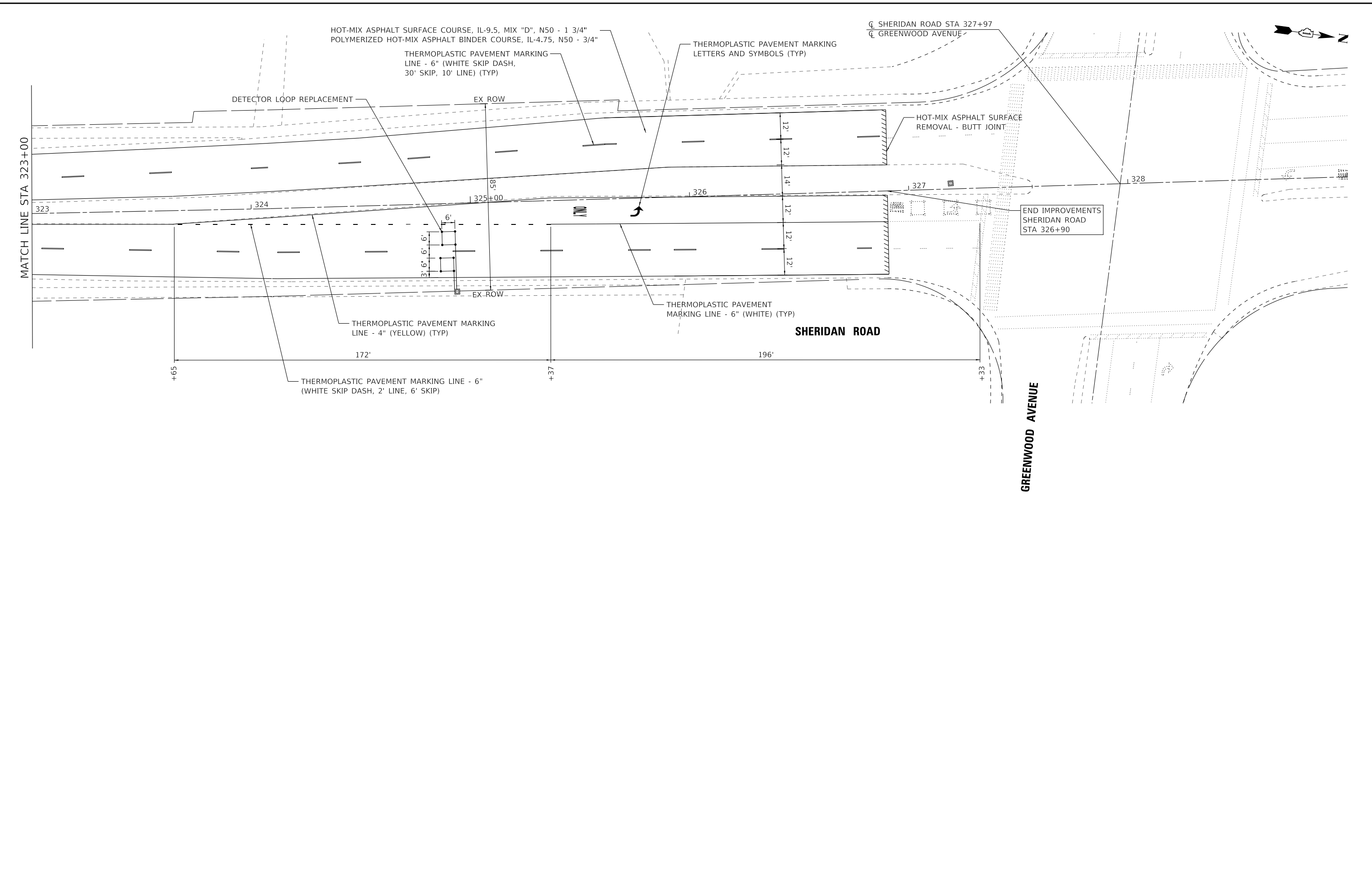

	USER NAME = jmiller	DESIGNED - CG	REVISED -
		DRAWN - KAR	REVISED -
	PLOT SCALE = 20.0000 ' / in.	CHECKED - JDM	REVISED -
	PLOT DATE = 5/17/2023	DATE - 04-19-2023	FILE - 220047_SHT-Plan10 SheridanNorth.dgn

STATE OF ILLINOIS
 DEPARTMENT OF TRANSPORTATION

ROADWAY PLAN			
SHERIDAN ROAD			
SCALE: 1" = 20'	SHEET 3	OF 3 SHEETS	STA. 323+00 TO STA. 329+00

F.A.U. RTE.	SECTION	COUNTY	TOTAL SHEETS	SHEET NO.
2736	22-00244-00-R5	LAKE	23	13
CONTRACT NO. 61164				

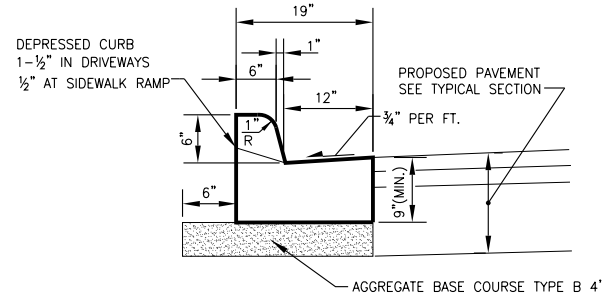

COMBINATION CONCRETE CURB & GUTTER TYPE B-6.12
NO SCALE

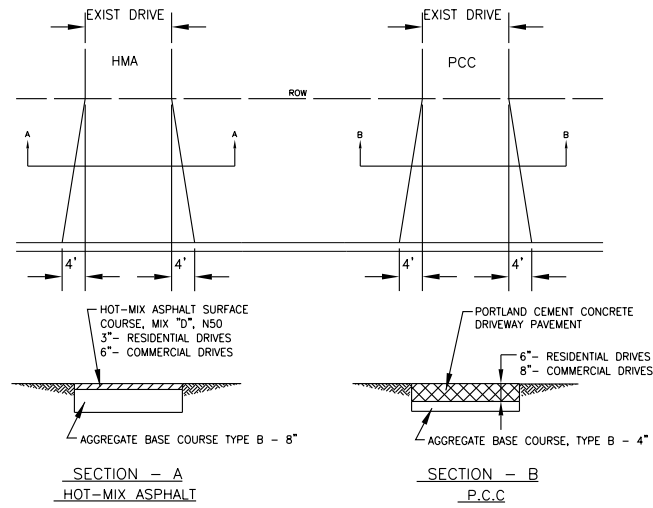

DRIVEWAY PAVEMENT DETAIL
NO SCALE

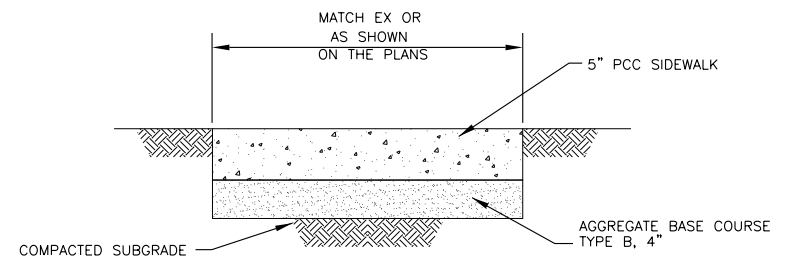

NOTE: PROVIDE FIBER 3/4" EXPANSION JOINTS WHERE NEW SIDEWALK MEETS EXISTING AND AT 50' O.C. MAX. AND PROVIDE CONTROL JOINTS AT 5' O.C.

PORTLAND CEMENT CONCRETE (P.C.C.) SIDEWALK, 5-INCH
NO SCALE

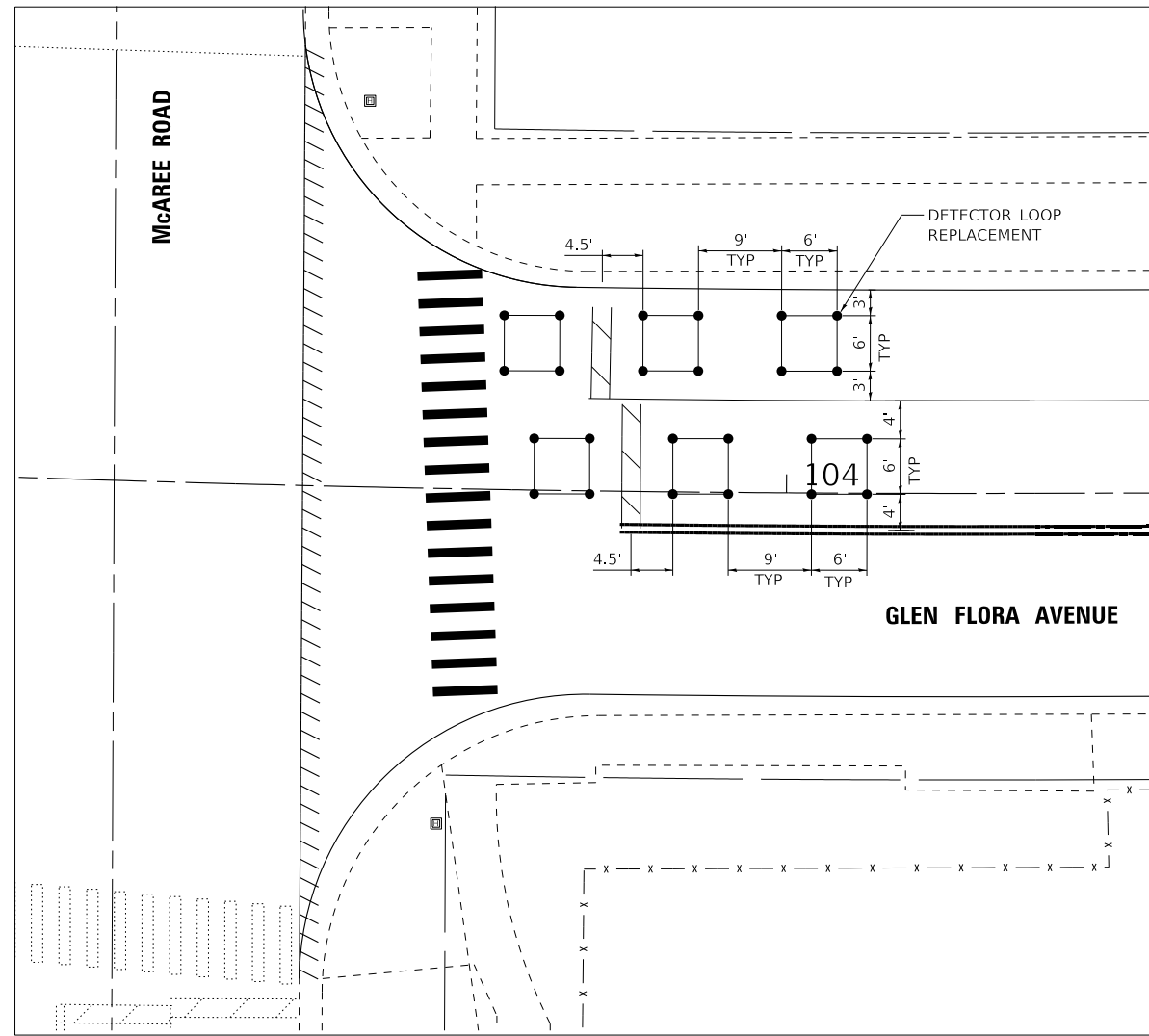

DETECTOR LOOP DETAIL
1"=10'

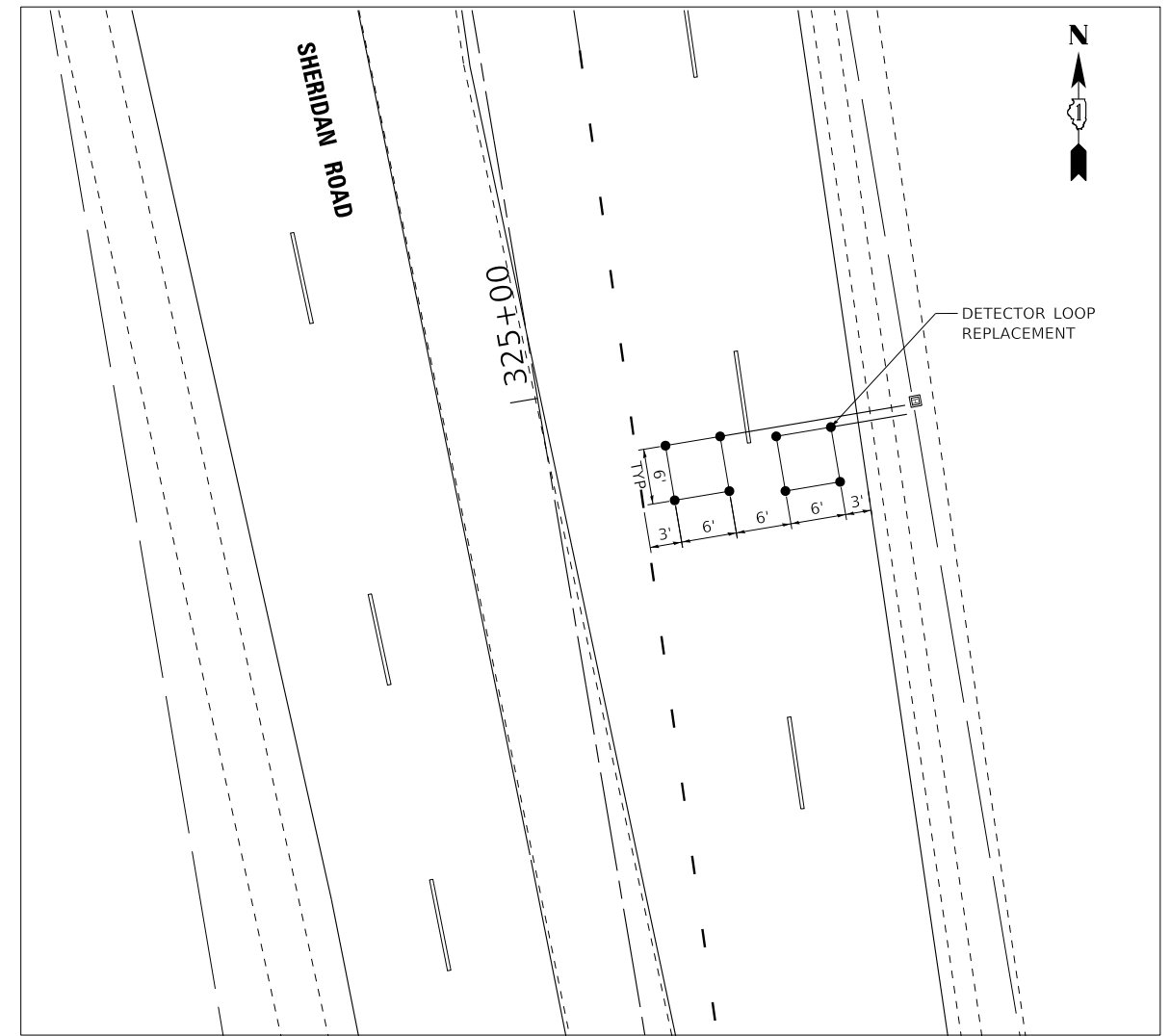

DETECTOR LOOP DETAIL
1"=10'

STATE OF ILLINOIS - PROFESSIONAL DESIGN FIRM
LICENSE NO. - 184-001121 - EXPIRES 4/30/2024
jmiller
5/17/2023 5:35:49 PM
FILE NAME: P:\WAUKC\220047-2022_STP_Project\CAD\Sheets_Phase 1\220047_SHT-MiscDetails.dgn



USER NAME = jmiller	DESIGNED - CG	REVISED -
PLOT SCALE = 20.0000' / in.	DRAWN - KAR	REVISED -
PLOT DATE = 5/17/2023	CHECKED - JDM	REVISED -
	DATE - 04-19-2023	FILE - 220047_SHT-MiscDetails.dgn

STATE OF ILLINOIS
DEPARTMENT OF TRANSPORTATION

MISCELLANEOUS DETAILS

SCALE: NONE SHEET 1 OF 1 SHEETS STA. TO STA.

F.A.U. RTE.	SECTION	COUNTY	TOTAL SHEETS	SHEET NO.
1219	22-00244-00-R5	LAKE	23	14
2736			CONTRACT NO. 61164	
		ILLINOIS		

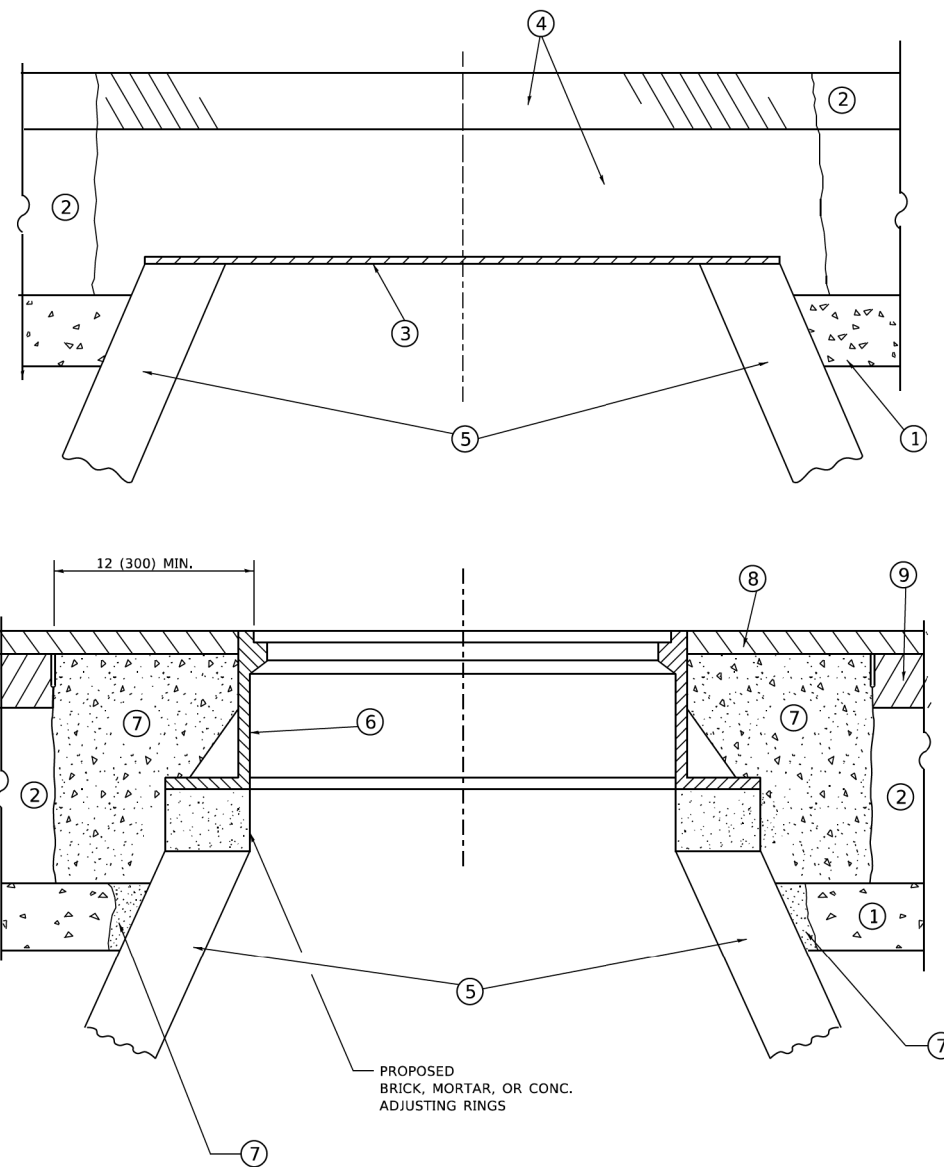

**DETAILS FOR FRAMES AND LIDS ADJUSTMENT
WITH MILLING**

CONSTRUCTION PROCEDURES

STAGE 1 (BEFORE PAVEMENT MILLING)

- A) REMOVE A MINIMUM OF 12 (300) OF THE PAVEMENT FROM AROUND THE STRUCTURE.
- B) REMOVE THE EXISTING FRAME AND LID FROM THE STRUCTURE.
- C) COVER THE STRUCTURE OPENING WITH A 36 (900) DIAMETER METAL PLATE.
- D) BACKFILL WITH CRUSHED STONE AND HMA SURFACE MIX APPROVED BY THE ENGINEER. (MIN. 1 1/2 (40) HMA TO REMAIN AFTER MILLING).

STAGE 2 (AFTER PAVEMENT MILLING)

- A) REMOVE THE HMA SURFACE MIX AND CRUSHED STONE.
- B) INSTALL THE FRAME AND LID; ADJUST THE FRAME TO ITS FINAL SURFACE ELEVATION.
- C) THE SURROUNDING SPACE SHALL BE FILLED WITH CLASS*PP-1 CONCRETE TO THE ELEVATION OF THE SURFACE OF THE EXISTING BASE COURSE OR THE BINDER COURSE.

* UNLESS OTHERWISE SPECIFIED IN THE PLANS.

THE PROCEDURE EXPLAINED ABOVE SHALL CONFORM TO THE APPLICABLE PORTIONS OF SECTIONS 353, 406, 602, AND 603 OF THE STANDARD SPECIFICATIONS EXCEPT THAT "THE CONTRACTOR SHALL ADJUST THE STRUCTURES TO THE FINISHED PAVEMENT ELEVATION NO MORE THAN 5 CALENDAR DAYS PRIOR TO PLACEMENT OF THE FINAL LIFT OF SURFACE UNLESS APPROVED BY THE ENGINEER."

LEGEND

- | | |
|--|-------------------------------|
| ① SUB-BASE GRANULAR MATERIAL | ⑥ FRAME AND LID (SEE NOTES) |
| ② EXISTING PAVEMENT | ⑦ CLASS*PP-1 CONCRETE |
| ③ 36 (900) DIAMETER METAL PLATE | ⑧ PROPOSED HMA SURFACE COURSE |
| ④ PROPOSED CRUSHED STONE AND HMA SURFACE MIX | ⑨ PROPOSED HMA BINDER COURSE |
| ⑤ EXISTING STRUCTURE | |

LOCATION OF STRUCTURES

THE CONTRACTOR WILL BE REQUIRED TO KEEP A RECORD OF THE LOCATIONS OF THE BURIED STRUCTURES ACCORDING TO THE STATION AND DISTANCE LEFT OR RIGHT OF THE CENTERLINE OF PAVEMENT. UPON COMPLETION OF THE WORK, THE CONTRACTOR WILL DELIVER THE RECORD TO THE ENGINEER.

BASIS OF PAYMENT

- 1. REMOVING FRAMES AND LIDS ON DRAINAGE AND UTILITY STRUCTURES IN THE PAVEMENT PRIOR TO MILLING, AND ADJUSTING TO FINAL GRADE PRIOR TO PLACING THE SURFACE COURSE, WILL BE PAID FOR AT THE CONTRACT UNIT PRICE EACH FOR "FRAMES AND LIDS TO BE ADJUSTED (SPECIAL)."
- 2. THIS WORK WILL NOT BE PAID FOR WHEN DRAINAGE AND UTILITY STRUCTURES ARE SPECIFIED FOR PAYMENT AS STRUCTURE RECONSTRUCTION.
- 3. NEW FRAMES AND LIDS, WHEN SPECIFIED, WILL BE PAID FOR SEPARATELY.
- 4. WHEN STRUCTURES ARE TO BE ADJUSTED OR RECONSTRUCTED, THE LOWERING AND RAISING OF THE FRAMES AND LIDS WILL NOT BE PAID FOR SEPARATELY BUT WILL BE INCLUDED IN THE COST OF THE CORRESPONDING PAY ITEM.

ALL DIMENSIONS ARE IN INCHES (MILLIMETERS) UNLESS OTHERWISE SHOWN

NOTES

- 1. EXISTING BROKEN FRAMES AND LIDS SHALL BE REMOVED AND DISPOSED OF BY THE CONTRACTOR AND SHALL BE REPLACED AS DIRECTED BY THE ENGINEER. REPLACEMENT FRAMES AND LIDS WILL BE PAID FOR IN ACCORDANCE WITH ARTICLE 109.04 OF THE STANDARD SPECIFICATIONS UNLESS A SEPARATE PAY ITEM HAS BEEN PROVIDED.
- 2. IF THE EXISTING LIDS ARE OPEN, THE FRAME WILL BE ADJUSTED TO THE ELEVATION OF THE MILLED PAVEMENT SURFACE PRIOR TO THE MILLING OPERATION. THE FRAME WILL NOT BE REMOVED AND COVERED BY THE METAL PLATE.
- 3. CITY OF CHICAGO CASTINGS ARE THE PROPERTY OF THE CITY AND THE CONTRACTOR SHALL NOTIFY THE CITY FOR REMOVAL AND DISPOSITION OF THE CASTINGS.
- 4. THE METAL PLATE USED TO COVER THE STRUCTURE SHALL REMAIN THE PROPERTY OF THE CONTRACTOR.

**STATE OF ILLINOIS
DEPARTMENT OF TRANSPORTATION**

**DETAILS FOR
FRAMES AND LIDS ADJUSTMENT WITH MILLING**

USER NAME = Lawrence,DeManche	DESIGNED - R. SHAH	REVISED - R. BORO 01-01-07
	DRAWN -	REVISED - R. BORO 03-09-11
PLOT SCALE = 100,0000' / in.	CHECKED -	REVISED - R. BORO 12-06-11
PLOT DATE = 11/18/2022	DATE - 10-25-94	REVISED - K. SMITH 11-18-22

SCALE: NONE	SHEET 1 OF 1 SHEETS	STA. TO STA.	F.A. RTE.	SECTION	COUNTY	TOTAL SHEETS	SHEET NO.
			1219	22-00244-00-R5	LAKE	23	15
			2736	BD600-03 (BD-08)			CONTRACT NO. 61164
					ILLINOIS	FED. AID PROJECT	

METHOD OF MEASUREMENT

REFER TO SECTION 442 OF THE STANDARD SPECIFICATIONS FOR ROAD AND BRIDGE CONSTRUCTION AND THE RECURRING SPECIAL PROVISION "PATCHING WITH HOT-MIX ASPHALT OVERLAY REMOVAL."

BASIS OF PAYMENT

1. REFER TO SECTION 442 OF THE STANDARD SPECIFICATIONS FOR ROAD AND BRIDGE CONSTRUCTION AND THE RECURRING SPECIAL PROVISION "PATCHING WITH HOT-MIX ASPHALT OVERLAY REMOVAL."
2. SAW CUT/SCORING OF EXISTING HMA OVERLAY IS INCLUDED IN THE COST OF PAVEMENT PATCHING.
3. SAW CUT/SCORING OF EXISTING PAVEMENT IS INCLUDED IN THE COST OF PAVEMENT PATCHING.

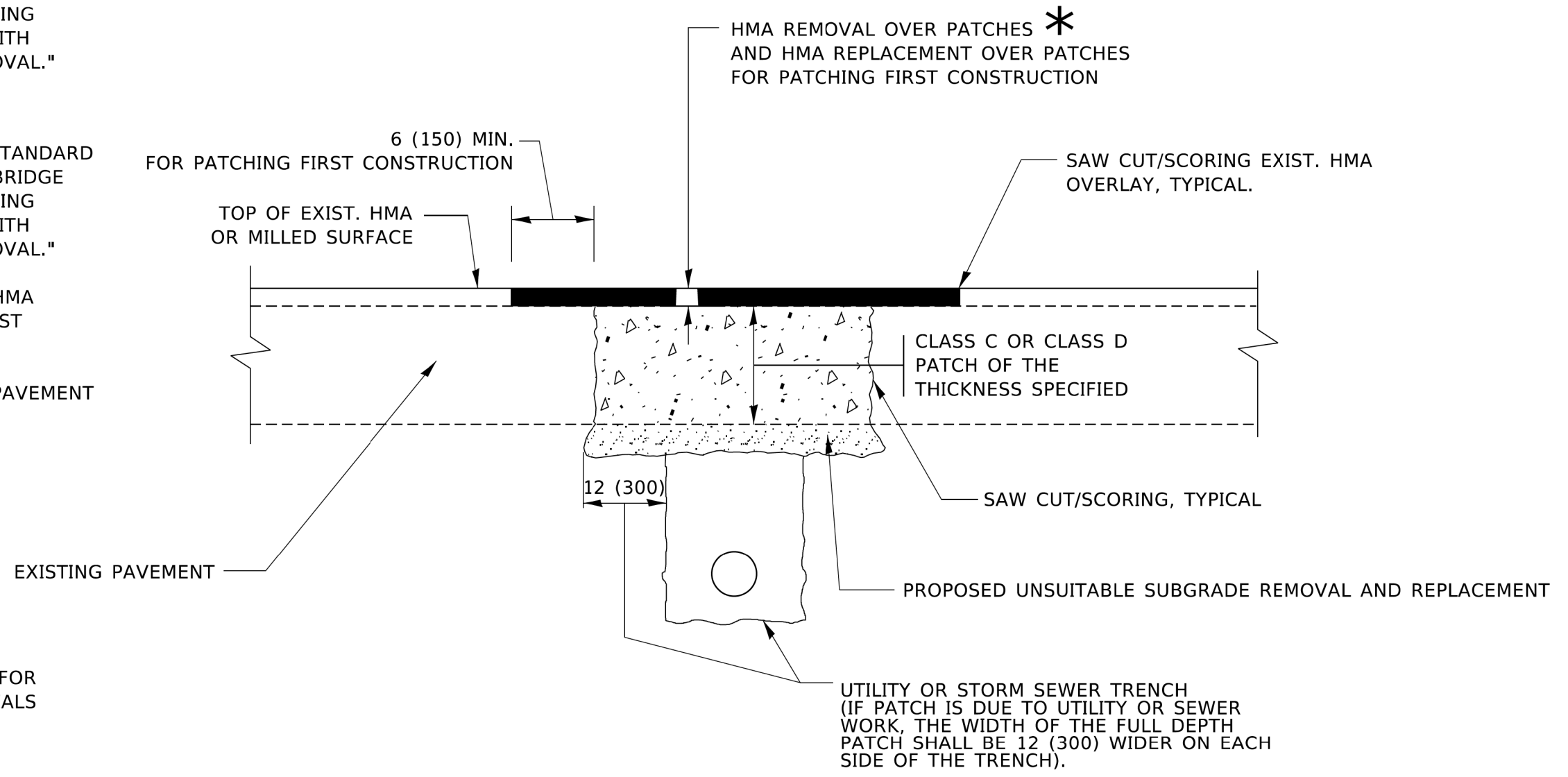

* SEE TYPICAL SECTIONS FOR THICKNESS AND MATERIALS

SEQUENCE OF CONSTRUCTION (PATCHING FIRST)

1. REMOVE THE EXISTING HMA MATERIAL OVER THE AREA TO BE PATCHED.
2. REMOVE AND REPLACE WITH CLASS C OR D PATCH.
3. REPLACE HMA MATERIAL OVER THE AREA TO BE PATCHED.

SEQUENCE OF CONSTRUCTION (MILLING FIRST)

1. MILL HMA FIRST IF THERE IS AT LEAST 4½ INCHES OR MORE OF HMA MATERIAL ON TOP OF THE EXISTING PAVEMENT OR IF THE PAVEMENT IS FULL DEPTH HMA. A MINIMUM OF 2 INCHES OF HMA MATERIAL SHALL BE IN PLACE AFTER MILLING.
2. REMOVE AND REPLACE WITH FULL DEPTH CLASS D PATCHES TO TOP OF MILLED SURFACE.

ALL DIMENSIONS ARE IN INCHES (MILLIMETERS) UNLESS OTHERWISE SHOWN.

MODEL: Default
FILE: N:\miller_p\asphalt\pavement\DOT_Offices\District_1\Projects\Dist5\223\2\CAD\Drawn\CAD\Drawn\223\223.dgn

USER NAME = Lawrence,DeManche	DESIGNED - R. SHAH	REVISED - R. BORO 01-01-07
	DRAWN -	REVISED - R. BORO 09-04-07
PLOT SCALE = 100,0000 ' / in.	CHECKED -	REVISED - K. ENG 10-27-08
PLOT DATE = 11/18/2022	DATE - 10-25-94	REVISED - K. SMITH 11-18-22

**STATE OF ILLINOIS
DEPARTMENT OF TRANSPORTATION**

PAVEMENT PATCHING FOR HMA SURFACED PAVEMENT	
SCALE: NONE	SHEET 1 OF 1 SHEETS STA. TO STA.

F.A. RTE.	SECTION	COUNTY	TOTAL SHEETS	SHEET NO.
1219	22-00244-00-R5	LAKE	23	16
2736	BD400-04 (BD-22)	CONTRACT NO.	61164	
ILLINOIS FED. AID PROJECT				

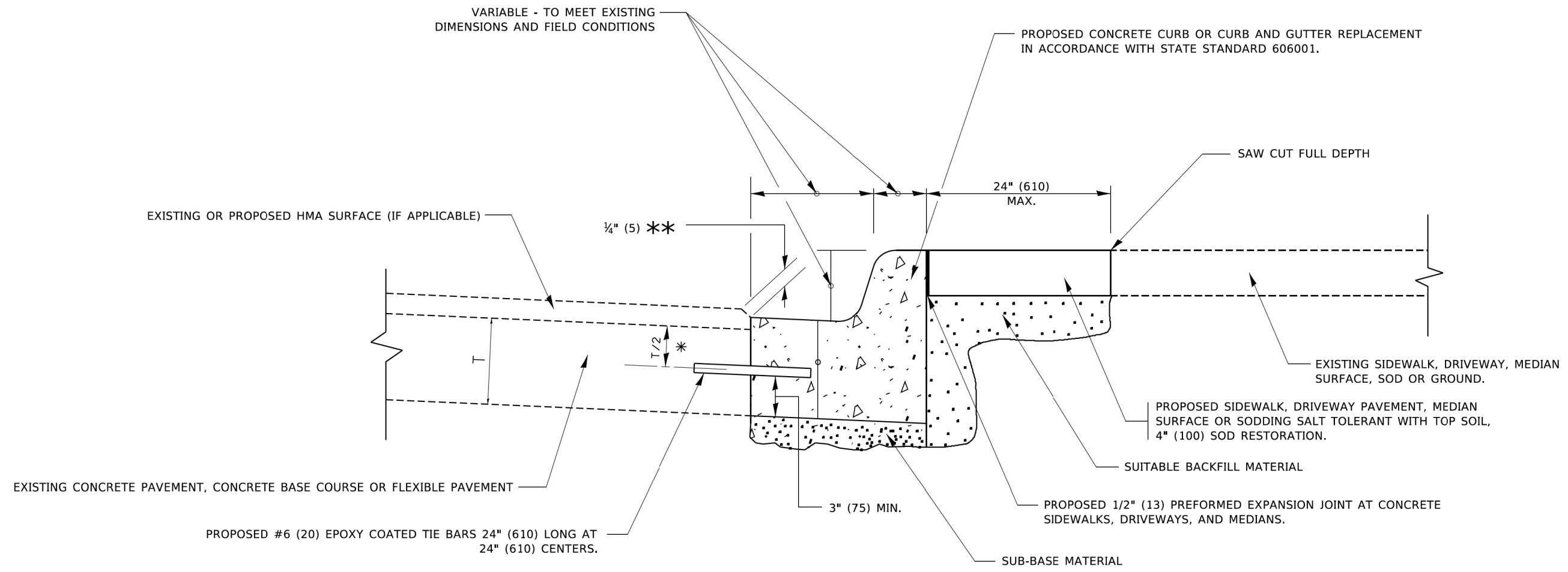

- * 3" (75) MINIMUM FROM TOP AND BOTTOM OF THE CONCRETE PAVEMENT OR BASE COURSE.
- ** IF THE FINAL SURFACE OF THE PAVEMENT IS CONCRETE, THE GUTTER IS TO BE FLUSH WITH THE PAVEMENT.

CURB OR CURB AND GUTTER REMOVAL AND REPLACEMENT

ALL DIMENSIONS ARE IN INCHES (MILLIMETERS) UNLESS OTHERWISE SHOWN.

MODEL: Default FILE: \\millec-prod\planroom\com.edu_illinois.gov\PIV\DOT\Documents\DOT_Offices\District_1\Projects\DH\5272-21\CADD\ba\CurbSheet\ba24.dgn	USER NAME = footemj DESIGNED - A. HOUSEH DRAWN - PLOT SCALE = 50,0000 ' / ft. PLOT DATE = 7/11/2019	DESIGNED - A. HOUSEH DRAWN - CHECKED - DATE - 03-11-94	REVISED - A. ABBAS 03-21-97 REVISED - M. GOMEZ 01-22-01 REVISED - R. BORO 12-15-09 REVISED - K. SMITH 07-11-19	STATE OF ILLINOIS DEPARTMENT OF TRANSPORTATION	CURB OR CURB AND GUTTER REMOVAL AND REPLACEMENT	SCALE: NONE SHEET 1 OF 1 SHEETS STA. TO STA.	<table border="1" style="width: 100%; border-collapse: collapse;"> <tr> <th>F.A. RTE.</th> <th>SECTION</th> <th>COUNTY</th> <th>TOTAL SHEETS</th> <th>SHEET NO.</th> </tr> <tr> <td>1219</td> <td>22-00244-00-R5</td> <td>LAKE</td> <td>23</td> <td>17</td> </tr> <tr> <td>2736</td> <td>BD600-06 (BD-24)</td> <td colspan="3">CONTRACT NO. 6164</td> </tr> <tr> <td colspan="5" style="text-align: center;">ILLINOIS FED. AID PROJECT</td> </tr> </table>	F.A. RTE.	SECTION	COUNTY	TOTAL SHEETS	SHEET NO.	1219	22-00244-00-R5	LAKE	23	17	2736	BD600-06 (BD-24)	CONTRACT NO. 6164			ILLINOIS FED. AID PROJECT				
F.A. RTE.	SECTION	COUNTY	TOTAL SHEETS	SHEET NO.																							
1219	22-00244-00-R5	LAKE	23	17																							
2736	BD600-06 (BD-24)	CONTRACT NO. 6164																									
ILLINOIS FED. AID PROJECT																											

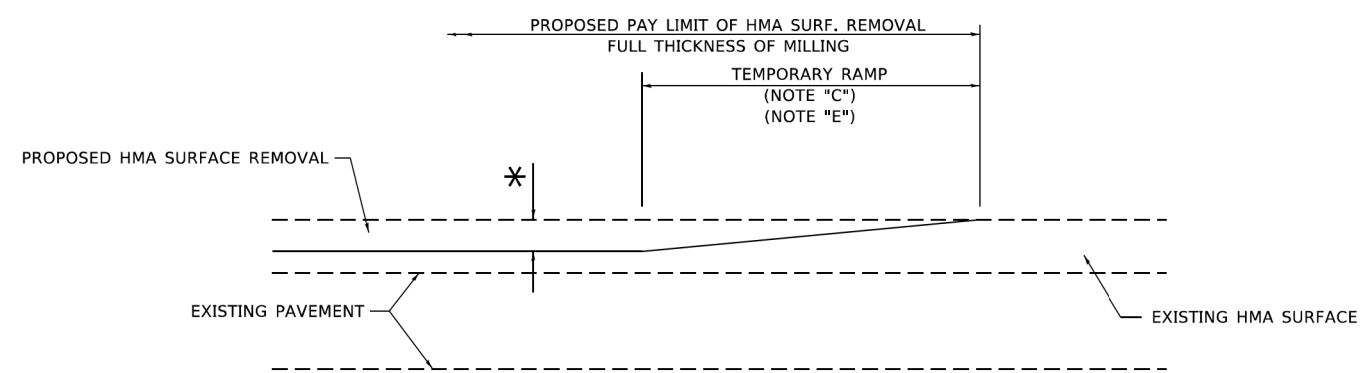

MILLED TEMPORARY RAMP
(FOR BUTT JOINT AND HMA TAPER SEE DETAIL BELOW)

OPTION 1

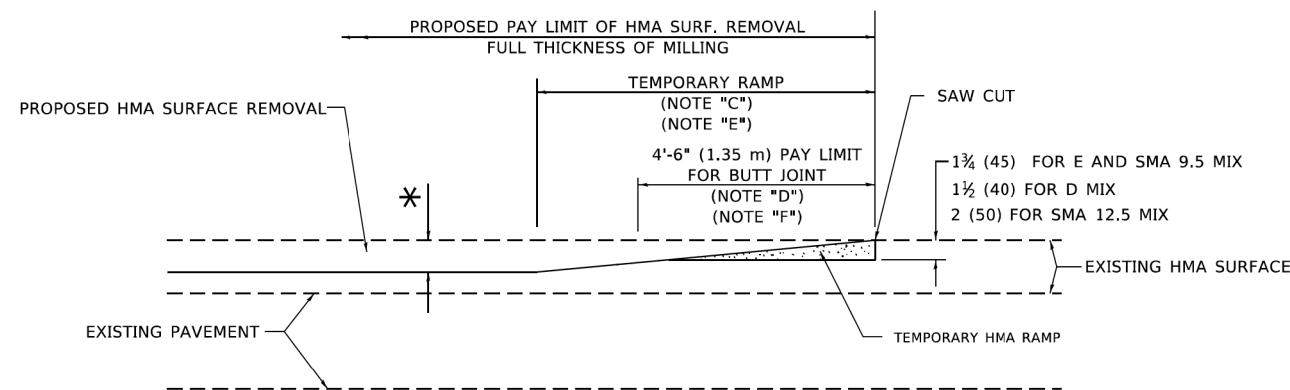

HMA CONSTRUCTED TEMPORARY RAMP
(FOR BUTT JOINT AND HMA TAPER SEE DETAIL BELOW)

OPTION 2

TYPICAL TEMPORARY RAMP

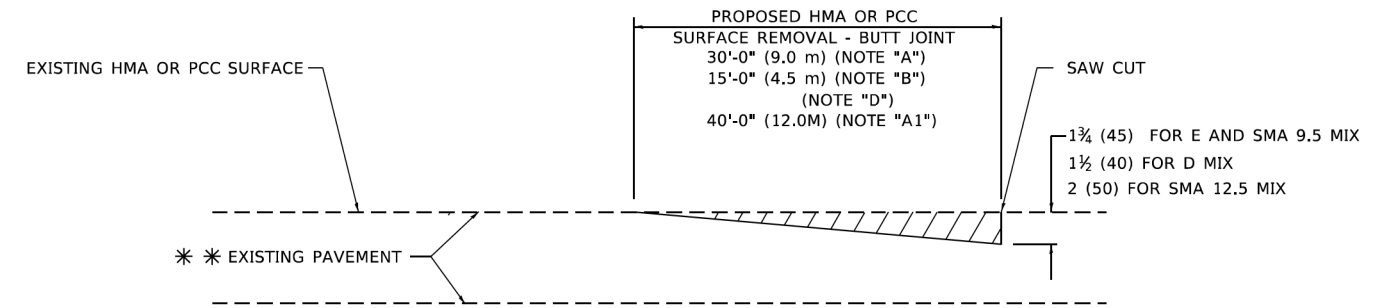

BUTT JOINT DETAIL

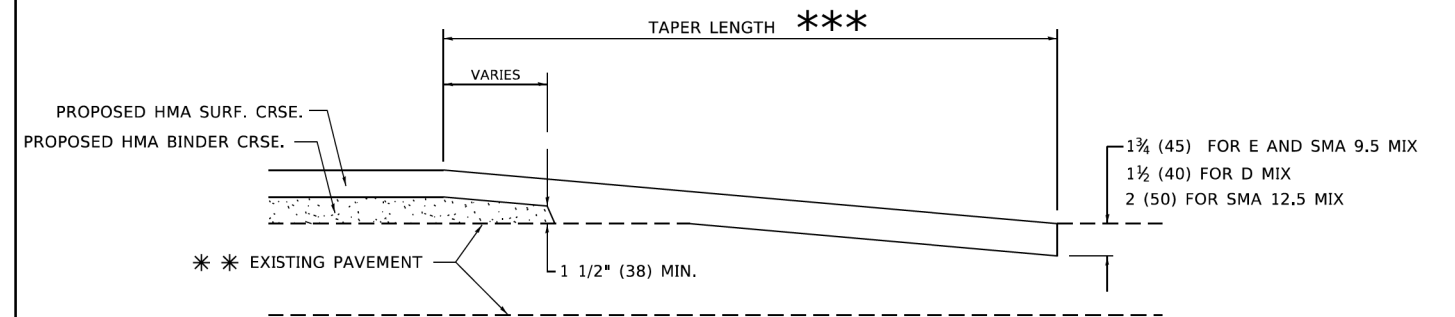

HMA TAPER DETAIL

TYPICAL BUTT JOINT AND HMA TAPER FOR RESURFACING ONLY

*** PC CONCRETE, HMA OR HMA RESURFACED PAVEMENT.

GENERAL NOTES

- A. MAINLINE ARTERIAL ROADWAYS AND MAJOR SIDE ROADS.
- A1. INTERSTATES
- B. MINOR SIDE ROADS.
- C. THE TEMP. RAMP SHALL BE CONSTRUCTED IMMEDIATELY UPON REMOVAL OF THE EXISTING HMA SURFACE.
- D. THE BUTT JOINT SHALL BE CONSTRUCTED IMMEDIATELY PRIOR TO PLACING THE PROPOSED HMA COURSES.
- E. TAPER THE TEMP. RAMP AT A RATE OF 3' - 4" (1.02m) PER 1 INCH (25 mm) OF MILLING THICKNESS.
* SEE TYPICAL SECTIONS FOR MILLING THICKNESS.
- F. SEE ARTICLE 406.08 AND 406.14 OF THE STANDARD SPECIFICATIONS FOR "HMA AND/OR PCC SURFACE REMOVAL, BUTT JOINT".
*** 20'-0" (6.1 m) PER 1 (25) RESURFACING (NOTE "A")
10'-0" (3.0 m) PER 1 (25) RESURFACING (NOTE "B")

BASIS OF PAYMENT

- 1. THE BUTT JOINT WILL BE PAID FOR AT THE CONTRACT UNIT PRICE PER SQUARE YARD (SQUARE METER) FOR "HOT-MIX ASPHALT SURFACE REMOVAL - BUTT JOINT" OR FOR "PORTLAND CEMENT CONCRETE SURFACE REMOVAL- BUTT JOINT".
- 2. THE TEMPORARY RAMP AND SAW CUT SHALL BE INCLUDED IN THE UNIT COST FOR HMA OR PCC SURFACE REMOVAL-BUTT JOINT.

ALL DIMENSIONS ARE IN INCHES (MILLIMETERS) UNLESS OTHERWISE SHOWN.

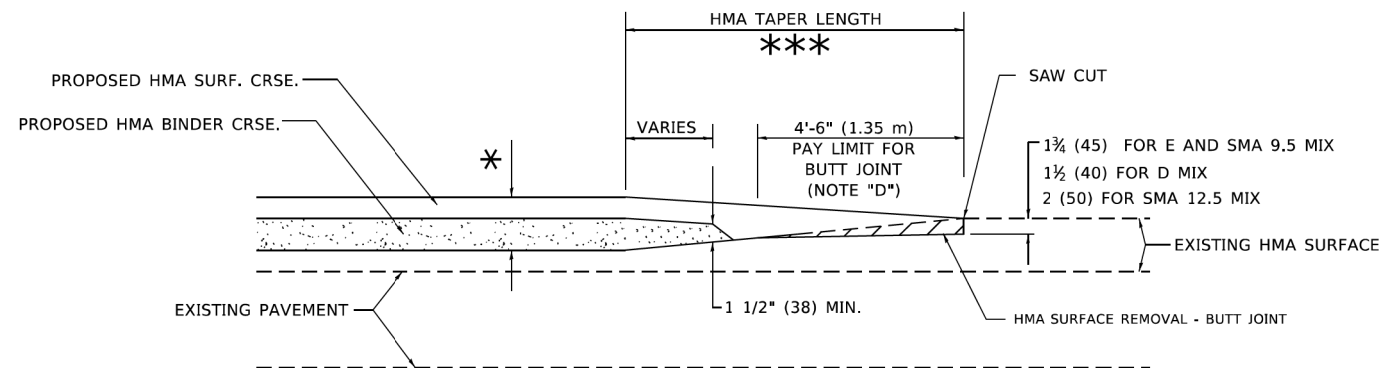

BUTT JOINT AND HMA TAPER

TYPICAL BUTT JOINT AND HMA TAPER FOR MILLING AND RESURFACING

MODEL: Default
FILE: \\nwr1101\pww\dw_bentley.com\PROJECTS\DOT Documents\DOT_Offices\District 1\Projects\Dist1\27323\CAD\Drawn\CAD\Sheets\1822.dgn

USER NAME = Lawrence.DeManche	DESIGNED - M. DE YONG	REVISED - A. ABBAS 03-21-97
	DRAWN -	REVISED - M. GOMEZ 04-06-01
PLOT SCALE = 100,0000' / in.	CHECKED -	REVISED - R. BORO 01-01-07
PLOT DATE = 11/18/2022	DATE - 06-13-90	REVISED - K. SMITH 11-18-22

STATE OF ILLINOIS
DEPARTMENT OF TRANSPORTATION

BUTT JOINT AND
HMA TAPER DETAILS

SCALE: NONE SHEET 1 OF 1 SHEETS STA. TO STA.

F.A. RTE.	SECTION	COUNTY	TOTAL SHEETS	SHEET NO.
1219	22-00244-00-R5	LAKE	23	18
2736	BD400-05 BD-32	CONTRACT NO. 61J64		
ILLINOIS FED. AID PROJECT				

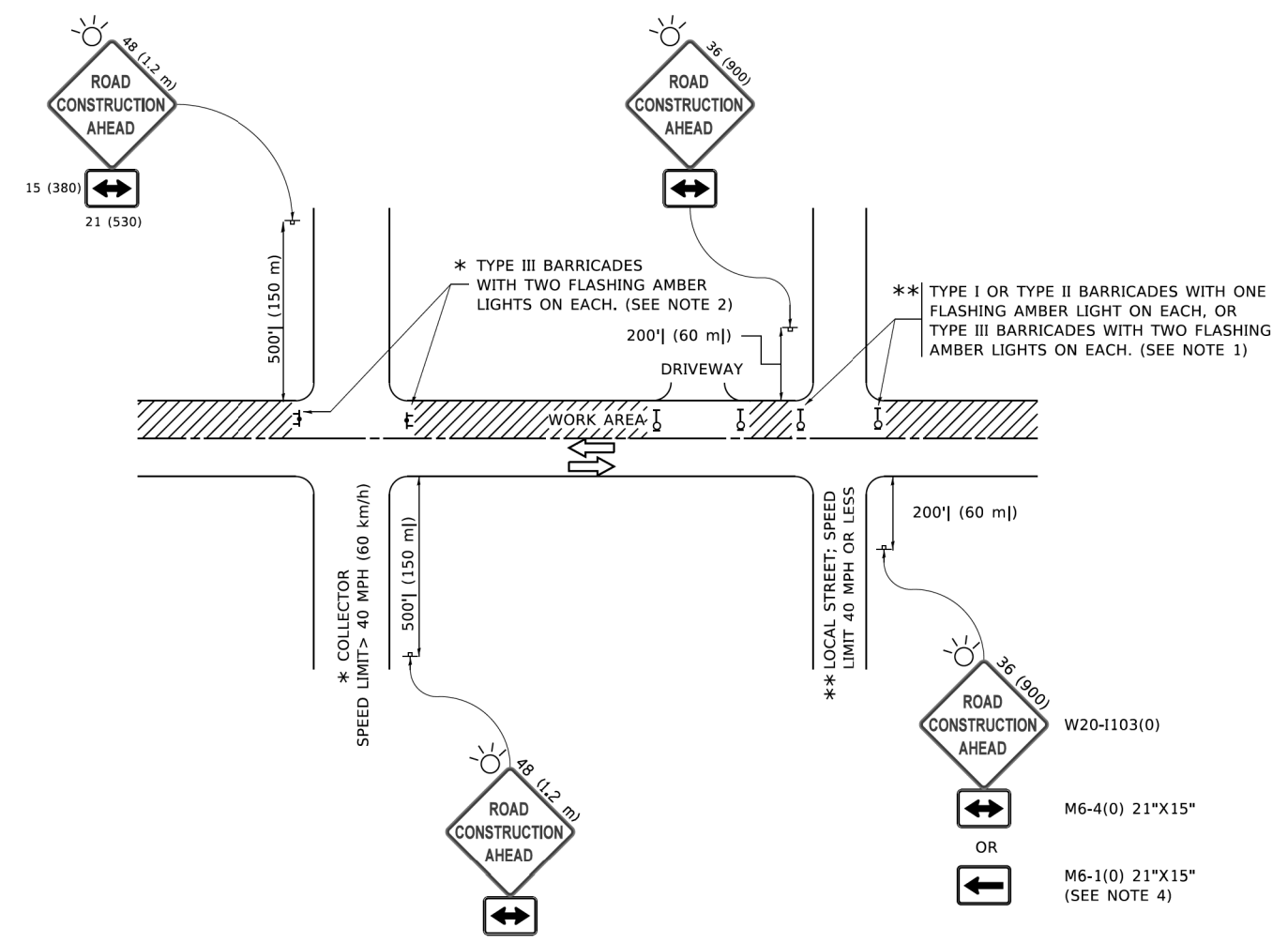

NOTES:

- SIDE ROAD WITH A SPEED LIMIT OF 40 MPH (60 km/h) OR LESS AS SHOWN ON THE DRAWING AND AS DIRECTED BY THE ENGINEER:
 - ONE "ROAD CONSTRUCTION AHEAD" SIGN 36 x 36 (900x900) WITH A FLASHER MOUNTED ON IT APPROXIMATELY 200' (60 m) IN ADVANCE OF THE MAIN ROUTE.
 - THE CLOSED PORTION OF THE MAIN ROUTE SHALL BE PROTECTED BY BLOCKING WITH TYPE I, TYPE II OR TYPE III BARRICADES, 1/3 OF THE CROSS SECTION OF THE CLOSED PORTION.
- SIDE ROAD WITH A SPEED LIMIT GREATER THAN 40 MPH (60 km/h) AS SHOWN ON THE DRAWING AND AS DIRECTED BY THE ENGINEER:
 - ONE "ROAD CONSTRUCTION AHEAD" SIGN 48 x 48 (1.2 m x 1.2 m) WITH A FLASHER MOUNTED ON IT APPROXIMATELY 500' (150 m) IN ADVANCE OF THE MAIN ROUTE.
 - THE CLOSED PORTION OF THE MAIN ROUTE SHALL BE PROTECTED BY BLOCKING WITH TYPE III BARRICADES, 1/2 OF THE CROSS SECTION OF THE CLOSED PORTION.
- CONES MAY BE SUBSTITUTED FOR BARRICADES OR DRUMS AT HALF THE SPACING DURING DAY OPERATIONS. CONES SHALL BE A MINIMUM OF 28 (710) IN HEIGHT.
- WHEN THE SIDE ROAD LIES BETWEEN THE BEGINNING OF THE MAINLINE AND THE WORK ZONE, A SINGLE HEADED ARROW (M6-1) SHALL BE USED IN LIEU OF THE DOUBLE HEADED ARROW (M6-4).
- WHEN WORK IS BEING PERFORMED ON A SIDE ROAD OR DRIVEWAY, FOLLOW THE APPLICABLE STANDARD(S). THE DIRECTIONAL ARROW (M6-1 OR M6-4) SHALL BE COVERED OR REMOVED WHEN NO LONGER CONSISTENT WITH THE TRAFFIC CONTROL SET-UP.
- ADVANCE WARNING SIGNS ARE TO BE OMITTED ON DRIVEWAYS UNLESS OTHERWISE SPECIFIED IN THE PLANS OR BY THE ENGINEER.
- THE TRAFFIC CONTROL AND PROTECTION FOR SIDE ROADS, INTERSECTIONS, AND DRIVEWAYS SHALL BE INCLUDED IN THE COST OF SPECIFIED TRAFFIC CONTROL STANDARDS OR ITEMS.

All dimensions are in inches (millimeters) unless otherwise shown.

MODEL: Definit...
 FILE NAME: pww\110818\BENTEC\Illinois\pww\110818\BENTEC\Documents\DOT Offices\District 1\Projects\Sub\52723\atCAD\atCAD\Sheet\10.dgn

USER NAME = footemj	DESIGNED - L.H.A.	REVISED - A. HOUSEH 10-15-96
	DRAWN -	REVISED - T. RAMMACHER 01-06-00
PLOT SCALE = 50.0000' / in.	CHECKED -	REVISED - A. SCHUETZE 07-01-13
PLOT DATE = 3/4/2019	DATE - 06-89	REVISED - A. SCHUETZE 09-15-16

**STATE OF ILLINOIS
DEPARTMENT OF TRANSPORTATION**

**TRAFFIC CONTROL AND PROTECTION FOR
SIDE ROADS, INTERSECTIONS, AND DRIVEWAYS**

SCALE: NONE SHEET 1 OF 1 SHEETS STA. TO STA.

F.A. RTE.	SECTION	COUNTY	TOTAL SHEETS	SHEET NO.
1219	22-00244-00-RS	LAKE	23	19
2736	TC-10		CONTRACT NO. 61164	
ILLINOIS FED. AID PROJECT				

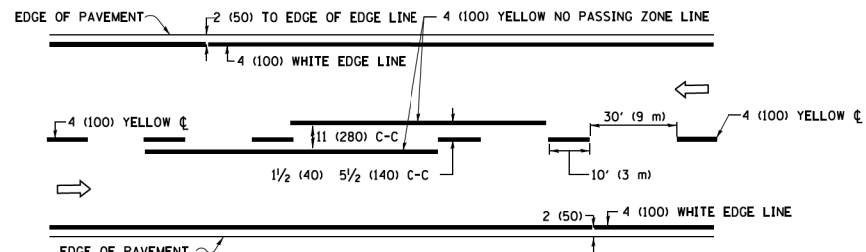

2-LANE ROADWAY

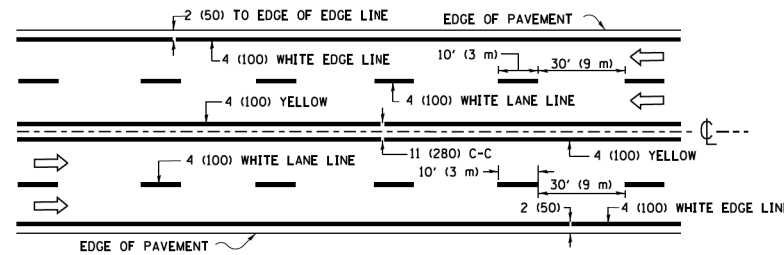

MULTI-LANE UNDIVIDED

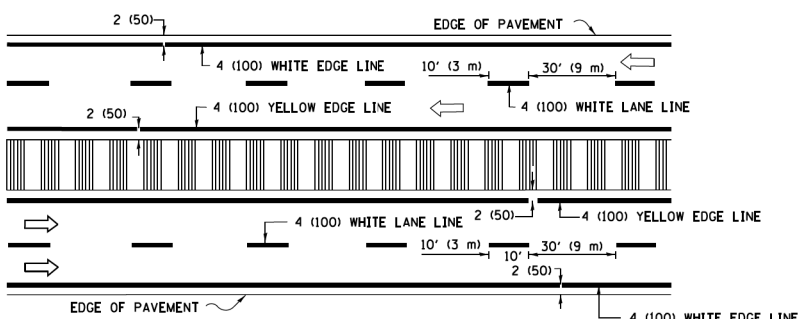

MULTI-LANE DIVIDED WITH MEDIAN

TYPICAL LANE AND EDGE LINE MARKING

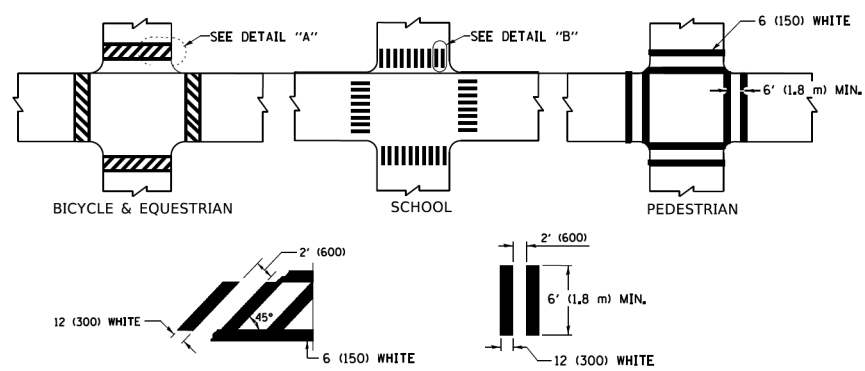

DETAIL "A" **DETAIL "B"**

TYPICAL CROSSWALK MARKING

* MARKINGS SHALL BE INSTALLED PARALLEL TO THE CENTERLINE OF THE ROAD WHICH IT CROSSES

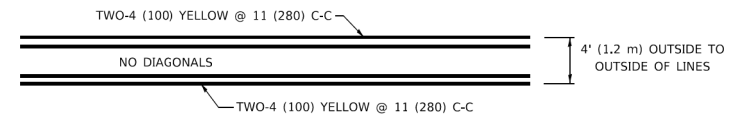

4' (1.2 m) WIDE MEDIANS ONLY

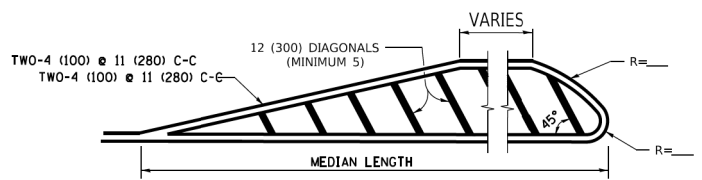

MEDIANS OVER 4' (1.2 m) WIDE

DIAGONAL LINE SPACING: 50' (15 m) C-C (LESS THAN 30MPH (50 km/h))
75' (25 m) C-C 30MPH (50 km/h) TO 45MPH (70 km/h)
150' (45 m) C-C (MORE THAN 45MPH (70 km/h))

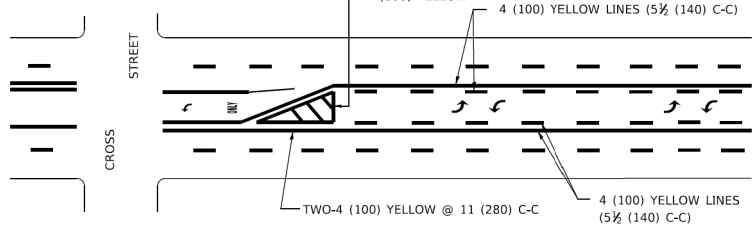

MEDIAN WITH TWO-WAY LEFT TURN LANE
TYPICAL PAINTED MEDIAN MARKING

A MINIMUM OF TWO PAIRS OF TURN ARROWS SHALL BE USED, WHITE IN COLOR. ADDITIONAL PAIRS SHALL BE PLACED AT 200' (60 m) TO 300' (90 m) INTERVALS.

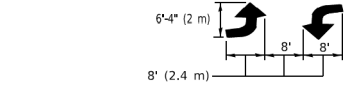

TYPICAL LEFT (OR RIGHT) TURN LANE

TYPICAL TURN LANE MARKING

FULL SIZE LETTERS 8' (2.4 m) AND ARROWS SHALL BE USED.
AREA = 15.6 SQ. FT. (1.5 m²) ONLY AREA = 20.8 SQ. FT. (1.9 m²)
* TURN LANES IN EXCESS OF 400' (120 m) IN LENGTH MAY HAVE AN ADDITIONAL SET OF ARROW - "ONLY" INSTALLED MIDWAY BETWEEN THE OTHER TWO SETS OF ARROW - "ONLY".

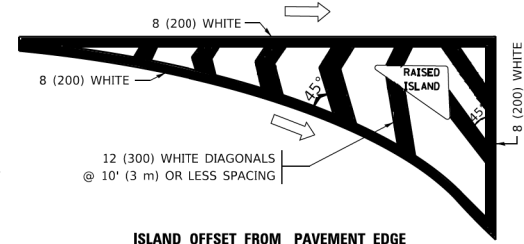

ISLAND OFFSET FROM PAVEMENT EDGE

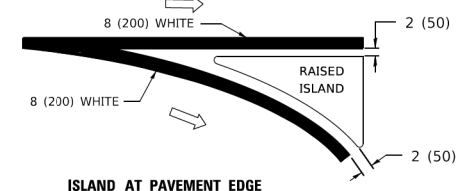

ISLAND AT PAVEMENT EDGE

TYPICAL ISLAND MARKING

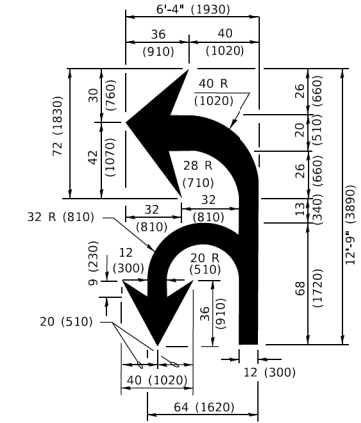

COMBINATION LEFT AND U-TURN

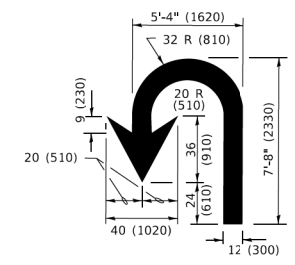

U-TURN

LANE REDUCTION TRANSITION
* LANE REDUCTION ARROWS REQUIRED AT SPEEDS OF 45 MPH OR GREATER OR WHEN SPECIFIED IN PLANS.

D(FT)	SPEED LIMIT
345	30
425	35
500	40
580	45
665	50
750	55

TYPE OF MARKING	WIDTH OF LINE	PATTERN	COLOR	SPACING / REMARKS
CENTERLINE ON 2 LANE PAVEMENT	4 (100)	SKIP-DASH	YELLOW	10' (3 m) LINE WITH 30' (9 m) SPACE
CENTERLINE ON MULTI-LANE UNDIVIDED PAVEMENT	2 @ 4 (100)	SOLID	YELLOW	11 (280) C-C
NO PASSING ZONE LINES: FOR ONE DIRECTION FOR BOTH DIRECTIONS	4 (100) 2 @ 4 (100)	SOLID SOLID	YELLOW YELLOW	5 1/2 (140) C-C FROM SKIP-DASH CENTERLINE 11 (280) C-C OMIT SKIP-DASH CENTERLINE BETWEEN
LANE LINES	4 (100) 5 (125) ON FREEWAYS	SKIP-DASH SKIP-DASH	WHITE WHITE	10' (3 m) LINE WITH 30' (9 m) SPACE
DOTTED LINES (EXTENSIONS OF CENTER, LANE OR TURN LANE MARKINGS)	SAME AS LINE BEING EXTENDED	SKIP-DASH	SAME AS LINE BEING EXTENDED	2' (600) LINE WITH 6' (1.8 m) SPACE
EDGE LINES	4 (100)	SOLID	YELLOW-LEFT WHITE-RIGHT	OUTLINE MEDIANS IN YELLOW
TURN LANE MARKINGS	6 (150) LINE; FULL SIZE LETTERS & SYMBOLS (8' (2.4m))	SOLID	WHITE	SEE TYPICAL TURN LANE MARKING DETAIL
TWO WAY LEFT TURN MARKING	2 @ 4 (100) EACH DIRECTION 8' (2.4m) LEFT ARROW	SKIP-DASH AND SOLID IN PAIRS	YELLOW WHITE	10' (3 m) LINE WITH 30' (9 m) SPACE FOR SKIP-DASH; 5 1/2 (140) C-C BETWEEN SOLID LINE AND SKIP-DASH LINE SEE TYPICAL TWO-WAY LEFT TURN MARKING DETAIL
CROSSWALK LINES (PEDESTRIAN) A. DIAGONALS (BIKE & EQUESTRIAN) B. LONGITUDINAL BARS (SCHOOL)	2 @ 6 (150) 2' (600) APART 12 (300) @ 45° 12 (300) @ 90°	SOLID SOLID SOLID	WHITE WHITE WHITE	NOT LESS THAN 6' (1.8 m) APART 2' (600) APART SEE TYPICAL CROSSWALK MARKING DETAILS.
STOP LINES	24 (600)	SOLID	WHITE	PLACE 4' (1.2 m) IN ADVANCE OF AND PARALLEL TO CROSSWALK, IF PRESENT. OTHERWISE, PLACE AT DESIRED STOPPING POINT. PARALLEL TO CROSSROAD CENTERLINE, WHERE POSSIBLE
PAINTED MEDIANS	2 @ 4 (100) WITH 12 (300) DIAGONALS @ 45° NO DIAGONALS USED FOR 4' (1.2 m) WIDE MEDIANS	SOLID	YELLOW: TWO WAY TRAFFIC WHITE: ONE WAY TRAFFIC	11 (280) C-C FOR THE DOUBLE LINE SEE TYPICAL PAINTED MEDIAN MARKING.
GORE MARKING AND CHANNELIZING LINES	8 (200) WITH 12 (300) DIAGONALS @ 45°	SOLID	WHITE	DIAGONALS: 15' (4.5 m) C-C (LESS THAN 30MPH (50 km/h)) 20' (6 m) C-C 30MPH (50 km/h) TO 45MPH (70 km/h) 30' (9 m) C-C (OVER 45MPH (70 km/h))
RAILROAD CROSSING	24 (600) TRANSVERSE LINES: "RR" 15' 6" (1.8 m) LETTERS; 16 (400) LINE FOR "X"	SOLID	WHITE	SEE STATE STANDARD 780001 AREA OF: "R"=3.6 SQ. FT. (0.33 m ²) EACH "X"=54.0 SQ. FT. (5.0 m ²)
SHOULDER DIAGONALS (REQUIRED FOR SHOULDERS ≥ 8')	12 (300) @ 45°	SOLID	WHITE - RIGHT YELLOW - LEFT	50' (15 m) C-C (LESS THAN 30MPH (50 km/h)) 75' (25 m) C-C (30 MPH (50 km/h) TO 45MPH (70 km/h)) 150' (45 m) C-C (OVER 45MPH (70 km/h))
U TURN ARROW	SEE DETAIL	SOLID	WHITE	16.3 SF
2 ARROW COMBINATION LEFT AND U TURN	SEE DETAIL	SOLID	WHITE	30.4 SF

FOR FURTHER DETAILS ON PAVEMENT MARKING REFER TO STANDARD SPECIFICATIONS FOR ROAD AND BRIDGE CONSTRUCTION AND STATE STANDARD 780001.

All dimensions are in inches (millimeters) unless otherwise shown.

MODEL: Default
FILE: M:\0484\BENTON\TEC\Illinois\gov\WIDOT\Documents\DOT Offices\Bentn\1\Projects\Bentn\273-24\CADD\04\CAD\Sheet\13.dwg

USER NAME = footemj	DESIGNED - EVERS	REVISED - C. JUCIUS 09-09-09
	DRAWN -	REVISED - C. JUCIUS 07-01-13
PLOT SCALE = 50.00000 ' / ft.	CHECKED -	REVISED - C. JUCIUS 12-21-15
PLOT DATE = 3/4/2019	DATE - 03-19-90	REVISED - C. JUCIUS 04-12-16

STATE OF ILLINOIS
DEPARTMENT OF TRANSPORTATION

DISTRICT ONE		F.A. RTE.	SECTION	COUNTY	TOTAL SHEETS	SHEET NO.
TYPICAL PAVEMENT MARKINGS		1219	22-00244-00-R5	LAKE	23	20
SCALE: NONE	SHEET 1 OF 1 SHEETS	STA. 2736	TC-13	CONTRACT NO. 61J64		
		ILLINOIS		FED. AID PROJECT		

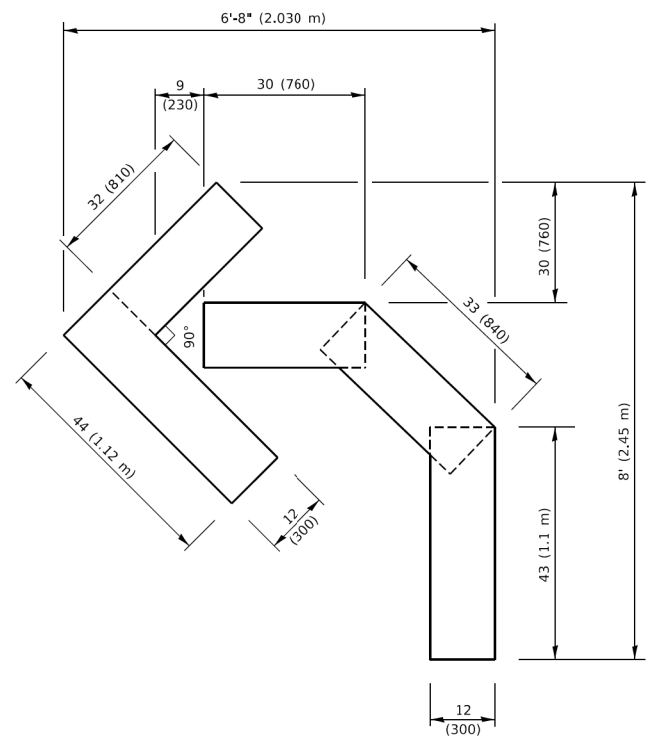

QUANTITY
 4 (100) LINE = 45.5 ft. (13.9 m)
 15.2 sq. ft. (1.41 sq. m)

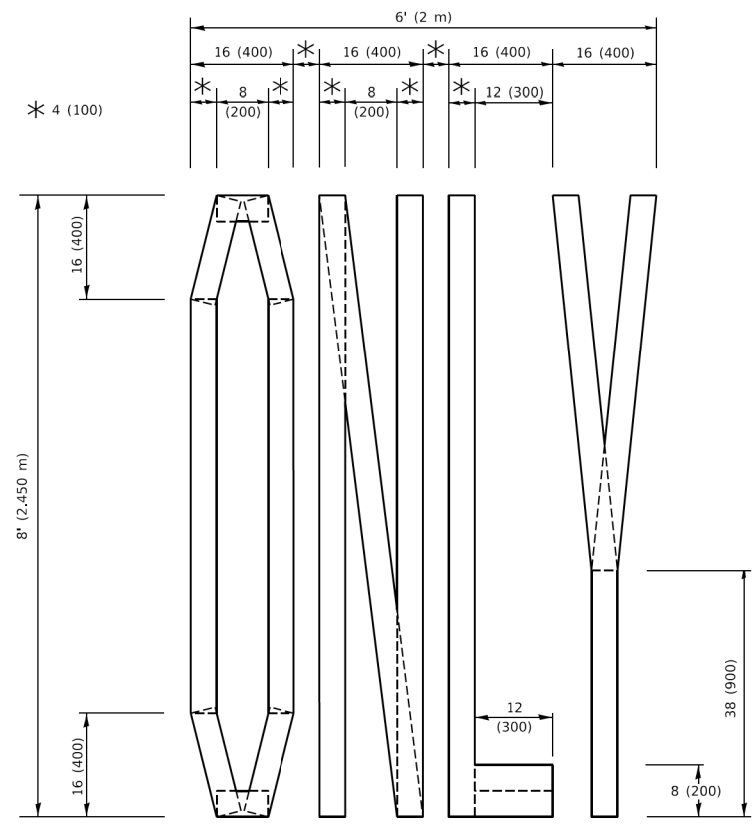

QUANTITY
 4 (100) LINE = 64.1 ft. (19.5 m)
 21.4 sq. ft. (1.99 sq. m)

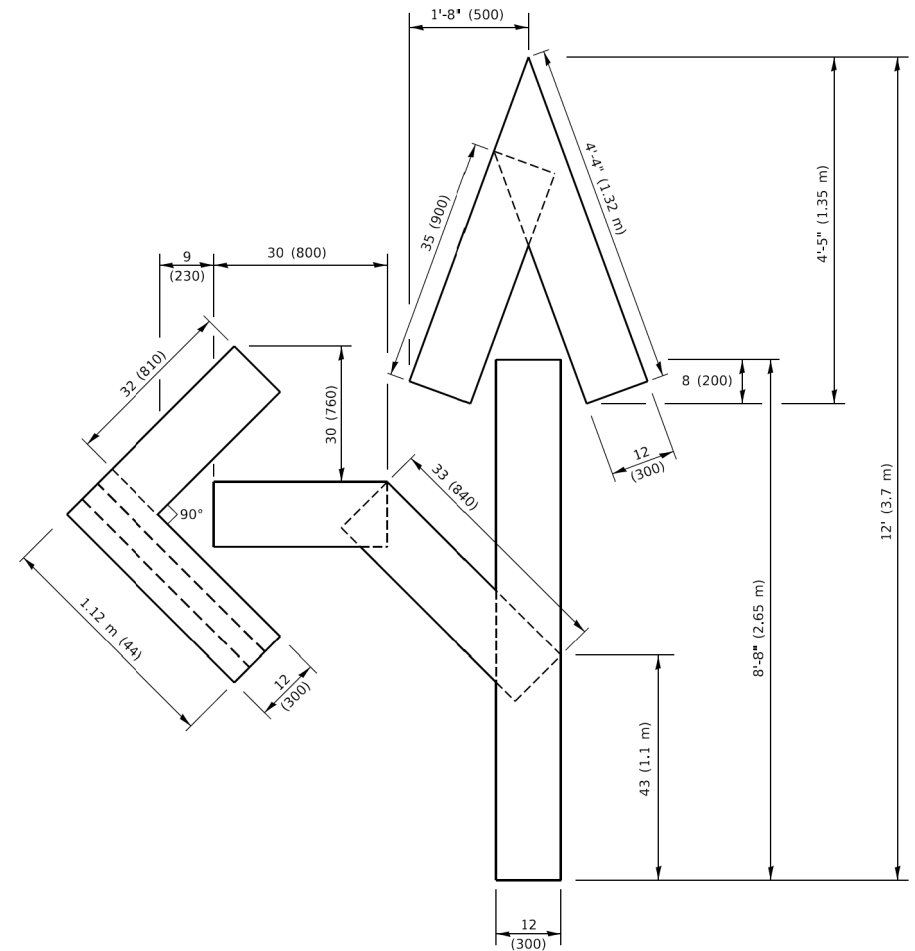

QUANTITY
 4 (100) LINE = 82.5 ft. (25.1 m)
 27.5 sq. ft. (2.53 sq. m)

NOTE:
 ALL QUANTITIES OF PLACEMENT ARE REPRESENTED IN LINEAR FEET OF 4" LINES TO MATCH THE 4" TEMPORARY TAPE PAY ITEM AND REPRESENTS THE TOTAL QUANTITY OF 4" TAPE REQUIRED.

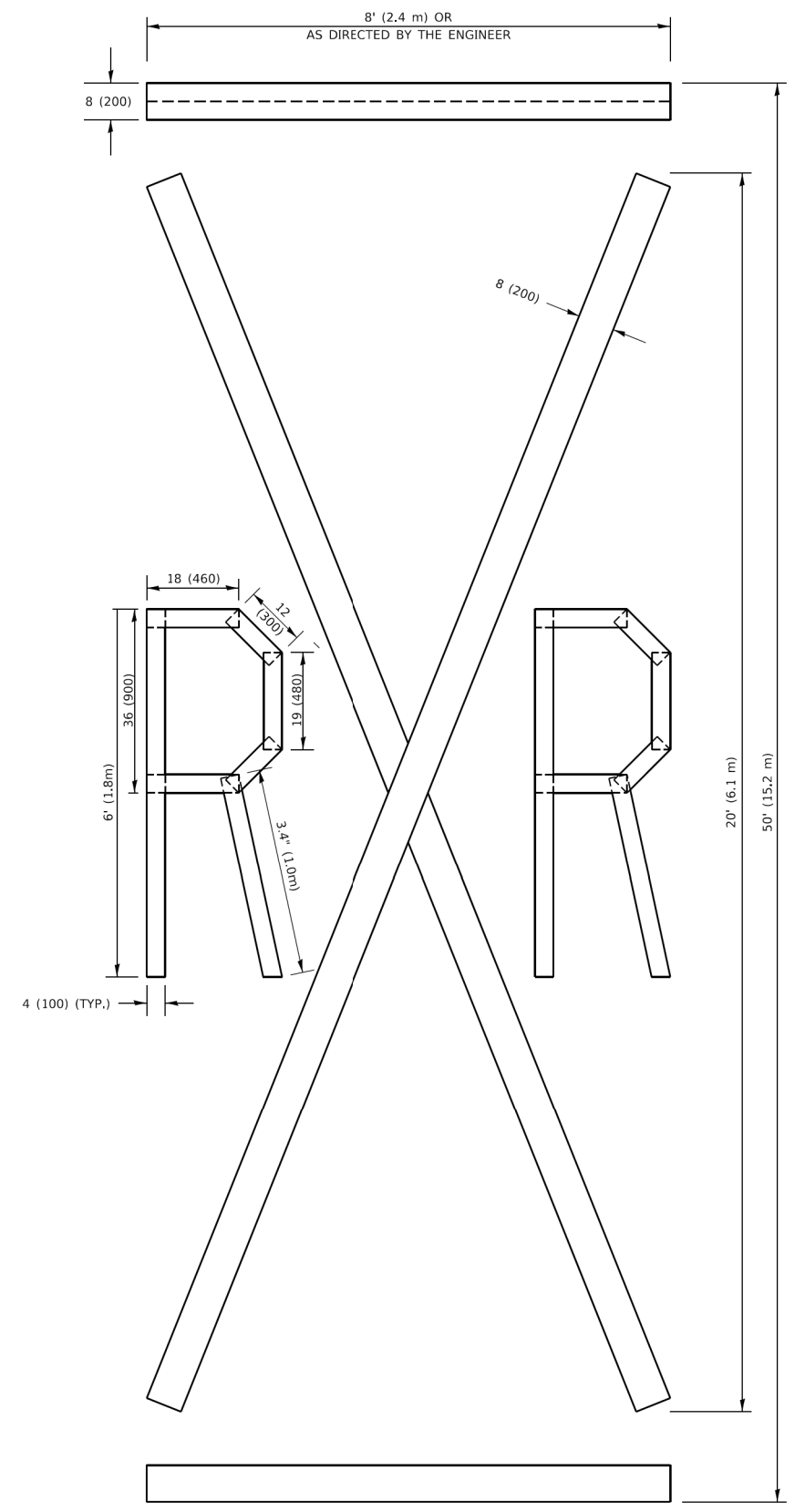

QUANTITY
 4 (100) LINE = 225.9 ft. (68.9 m)
 75.3 sq. ft. (6.99 sq. m)

All dimensions are in inches (millimeters) unless otherwise shown.

MODEL: Default
 FILE NAME: P:\ILLINOIS\BID\NTEG\Illinois.gov\PWIDOT\Documents\DOT_Offices\Berket_1\Projects\IDS\S22\24\CAD\Bnal\CAD\sheet1c16.dgn

USER NAME = footemj	DESIGNED -	REVISED - T. RAMMACHER 03-02-98
	DRAWN -	REVISED - E. GOMEZ 08-28-00
PLOT SCALE = 50.0068" / in.	CHECKED -	REVISED - E. GOMEZ 08-28-00
PLOT DATE = 3/4/2019	DATE - 09-18-94	REVISED - A. SCHUETZE 09-15-16

**STATE OF ILLINOIS
 DEPARTMENT OF TRANSPORTATION**

SHORT TERM PAVEMENT MARKING LETTERS AND SYMBOLS

SCALE: NONE SHEET 1 OF 1 SHEETS STA. TO STA.

F.A. RTE.	SECTION	COUNTY	TOTAL SHEETS	SHEET NO.
1219	22-00244-00-RS	LAKE	23	21
2736	TC-16	CONTRACT NO.	61164	
		ILLINOIS	FED. AID PROJECT	

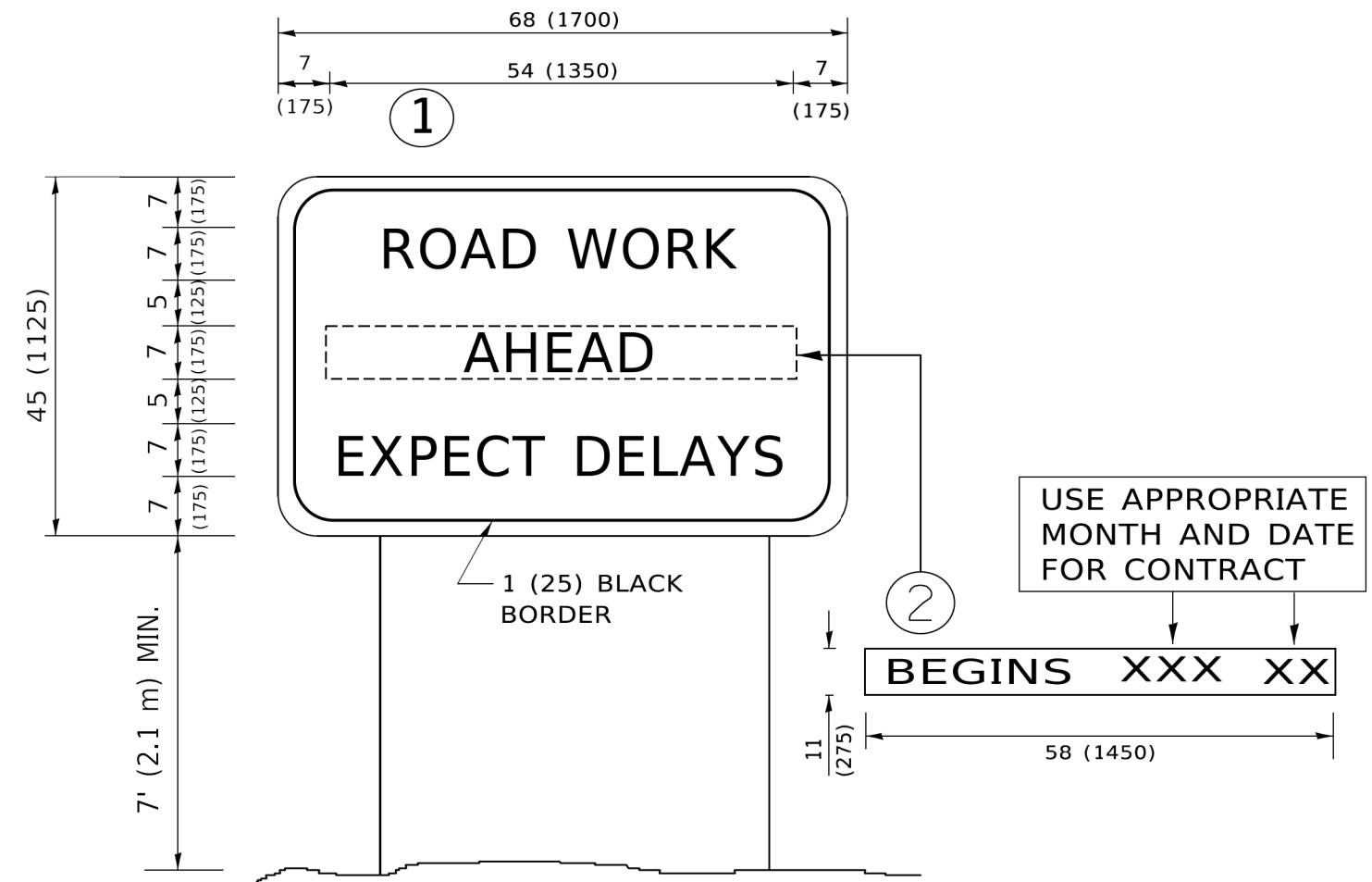

NOTES:

1. USE BLACK LETTERING ON ORANGE BACKGROUND.
2. ERECT SIGNS IN ADVANCE OF THE LOCATION FOR THE "ROAD CONSTRUCTION AHEAD" SIGN AT LOCATIONS AS DIRECTED BY THE ENGINEER.
3. ERECT SIGN ① WITH INSTALLED PANEL ② ONE WEEK PRIOR TO THE START OF CONSTRUCTION.
4. REMOVE PANEL ② SOON AFTER THE START OF CONSTRUCTION.
5. SEE SPECIAL PROVISION FOR "TEMPORARY INFORMATION SIGNING" FOR ADDITIONAL INFORMATION.
6. ONE SIGN ASSEMBLY EQUALS 25.70 SQ. FT. (2.3 SQ. M.)
7. SHALL BE PAID FOR AS TEMPORARY INFORMATION SIGNING.

ALL DIMENSIONS ARE IN INCHES (MILLIMETERS) UNLESS OTHERWISE SHOWN.

MODEL: Default
FILE NAME: P:\01108481\BID\ITEG\Illinois.gov\PIWDOT\Documents\DOT_Offices\District_1\Projects\Dist1\5273-21\CADD\Info\CAD\Sheet1322.dgn

USER NAME = footemj	DESIGNED -	REVISED - R. MIRS 09-15-97
	DRAWN -	REVISED - R. MIRS 12-11-97
PLOT SCALE = 50,0000 ' / ft.	CHECKED -	REVISED - T. RAMMACHER 02-02-99
PLOT DATE = 3/4/2019	DATE -	REVISED - C. JUCIUS 01-31-07

**STATE OF ILLINOIS
DEPARTMENT OF TRANSPORTATION**

**ARTERIAL ROAD
INFORMATION SIGN**

SCALE: NONE SHEET 1 OF 1 SHEETS STA. TO STA.

F.A. RTE.	SECTION	COUNTY	TOTAL SHEETS	SHEET NO.
1219	22-00244-00-R5	LAKE	23	22
2736	TC-22	CONTRACT NO. 61164		
ILLINOIS FED. AID PROJECT				

LOOPS NEXT TO SHOULDERS

PROVIDE A PAVEMENT REPLACEMENT NOTE WHICH SHOULD EQUAL 3' (900 mm) X WIDTH OF PAVED SHOULDER.

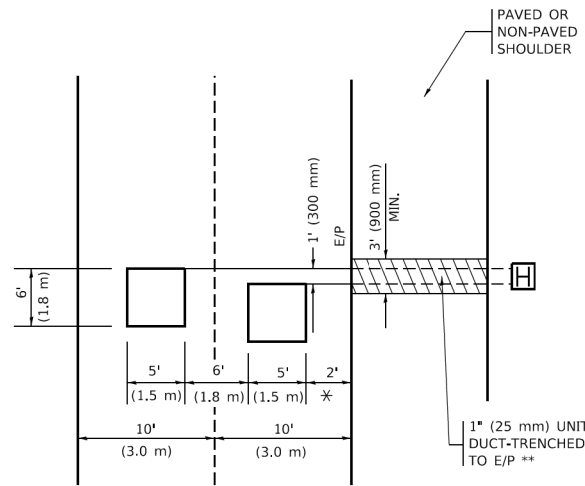

* = (600 mm)

** UNIT DUCT IS TO BE SHOWN ON PLAN SHEETS BUT SHALL NOT BE INCLUDED IN THE PAY ITEMS.

LEFT TURN LANES WITH MEDIANS
VOLUME DENSITY ("FAR OUT" DETECTION)
ON SAME APPROACH
(PROTECTED / PERMITTED LEFT TURN PHASING)

HANDHOLE LOCATION MAY VARY DEPENDING ON GEOMETRICS AND DESIGN OF TRAFFIC SIGNALS. HEAVY-DUTY HANDHOLES TO BE USED WHEN THE MEDIAN IS MOUNTABLE. REFER TO STANDARD 814001 TO ENSURE THAT HANDHOLE FITS IN MEDIAN.

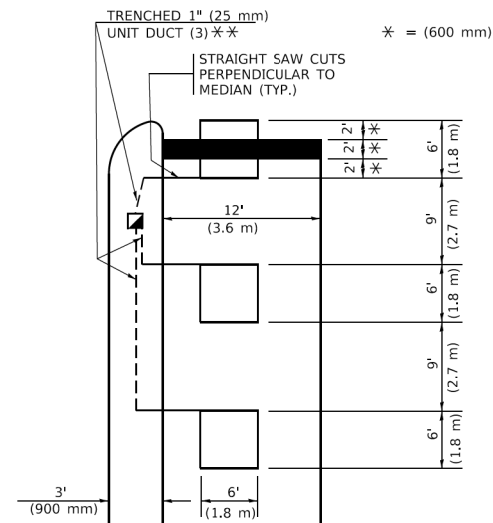

* = (600 mm)

** UNIT DUCT IS TO BE SHOWN ON PLAN SHEETS BUT SHALL NOT BE INCLUDED IN THE PAY ITEMS.

NOTE: DUAL LEFT TURNS NOT SHOWN REFER TO PLAN SHEET FOR DETECTOR LOOP REPLACEMENT

LEFT TURN LANES WITHOUT MEDIANS
VOLUME DENSITY ("FAR OUT" DETECTION)
ON SAME APPROACH
(PROTECTED / PERMITTED LEFT TURN PHASING)

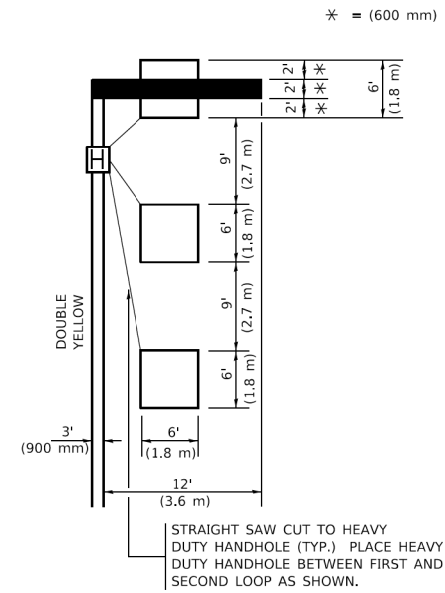

* = (600 mm)

NOTE: DUAL LEFT TURNS NOT SHOWN REFER TO PLAN SHEET FOR DETECTOR LOOP REPLACEMENT

NOTES:

VEHICLES LOOP DETECTORS

- * ALL LEAD IN CABLE SHALL BE TWO CONDUCTOR NO. 14 TWISTED, SHIELDED.
- * EACH DETECTOR LOOP SHALL HAVE ITS OWN SAW CUT FROM THE LOOP TO THE EDGE OF PAVEMENT OR TO A HANDHOLE IN THE PAVEMENT.
- * EACH DETECTOR LOOP SHALL HAVE ITS OWN ONE INCH (25 mm) UNIT DUCT BETWEEN THE EDGE OF PAVEMENT AND THE FIRST HANDHOLE OR JUNCTION BOX. EACH UNIT DUCT RUN SHALL BE SHOWN ON THE PLANS BY THE DESIGNER, BUT SHALL NOT BE PAID FOR SEPARATLY. THIS ITEM IS INCIDENTAL TO THE PAY ITEM FOR DETECTOR LOOPS.
- * ONE DIMENSION OF ALL DETECTOR LOOPS SHALL BE SIX FEET (1.8 m)
- * EACH LANE OF NON-LOCKING, PRESENCE DETECTION AND EACH LANE OF A DOUBLE LEFT TURN LANE REQUIRES A SEPARATE INDUCTIVE LOOP DETECTOR AND LEAD IN CABLE.
- * WHEN NON-LOCKING, PRESENCE DETECTION IS USED, MORE THAN ONE LOOP PER LANE IS REQUIRED BEHIND THE STOP BAR (i.e. 1-1/2, 1-3/4, 2).
- * WHEN SYSTEM LOOPS ARE REQUIRED ON AN APPROACH OF AN INTERSECTION, THE LOOPS USED FOR VOLUME DENSITY AND INTERSECTION TIMING SHALL ALSO BE USED AS SYSTEM DETECTORS. EACH ONE OF THESE TYPE OF LOOPS REQUIRES A SEPARATE TWO CONDUCTOR NO. 14 TWISTED SHIELDED CABLE AND A SEPARATE INDUCTIVE LOOP DETECTOR WHEN NEW CONTROLLERS ARE UTILIZED. THE DESIGNER SHALL LABEL THESE TYPES OF LOOPS AS "INTERSECTION AND SAMPLING (SYSTEM) DETECTORS" ON THE SIGNAL LAYOUT, THE INTERCONNECT PLAN AND THE SYSTEM CABLE PLAN. WHEN AN EXISTING CONTROLLER IS UTILIZED FOR THIS TYPE OF DETECTION, THE PAY ITEM "INDUCTIVE LOOP DETECTOR WITH SYSTEM OUTPUT" SHOULD BE USED.

PLACEMENT OF DETECTORS

THE FOLLOWING FIGURES REPRESENT THE MOST COMMON DETECTOR LOOP LOCATIONS AND SIZES. ADJUSTMENTS WILL BE NECESSARY FOR SPECIFIC GEOMETRIC CONSIDERATIONS.

LOCATIONS AND DEMENSIONS OF DETECTOR LOOPS ARE REQUIRED ON ALL SIGNAL LAYOUT PLAN SHEETS.

"FAR OUT" DETECTION REFERS TO LOCKING, PRESENCE TYPE DETECTION LOCATED IN THRU LANES, RIGHT TURN LANES, AND RIGHT TURN LANE TAPER AREAS (IF APPLICABLE), USUALLY 250' (75 m) IN ADVANCE OF STOP BARS. "UPTIGHT" DETECTION REFERS TO NON-LOCKING PRESENCE TYPE DETECTION LOCATED IN ALL LANES AND 10'-15' (3.0 m-4.5 m) BEHIND THE CROSSING STREET'S EDGE OF PAVEMENT EXTENDED.

NOTE:

ALL DETAILS AND NOTES SHOWN ARE FROM THE I.D.O.T. DISTRICT 1 TRAFFIC SIGNAL DESIGN GUIDELINES DATED JANUARY 1995

THIS DRAWING HAS BEEN PREPARED TO ASSIST THE RESIDENT ENGINEER FOR ALL ROADWAY RESURFACING OR S.M.A.R.T. PROJECTS WHERE THE DIMENSIONS ARE NOT SHOWN ON THE PLANS AND THE FINAL LOCATIONS FOR CROSSWALKS OR STOP BARS ARE NOT DETERMINED.

ARTERIAL-VOLUME DENSITY ("FAR OUT" DETECTION)
CROSS STREET-NON VOLUME DENSITY ("FAR OUT" DETECTION)

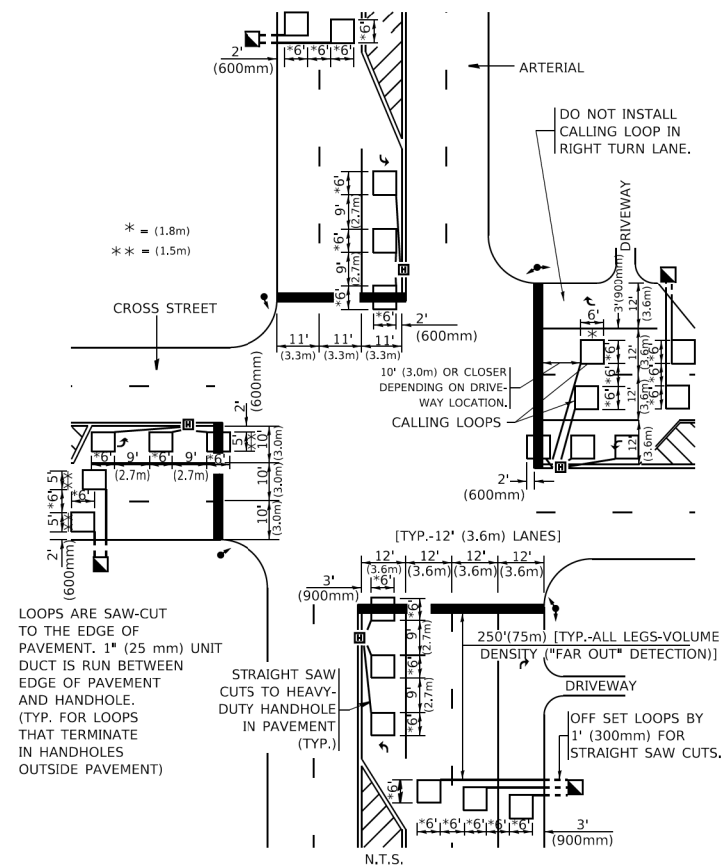

* = (1.8m)
 ** = (1.5m)

LOOPS ARE SAW-CUT TO THE EDGE OF PAVEMENT. 1" (25 mm) UNIT DUCT IS RUN BETWEEN EDGE OF PAVEMENT AND HANDHOLE. (TYP. FOR LOOPS THAT TERMINATE IN HANDHOLES OUTSIDE PAVEMENT)

STRAIGHT SAW CUTS TO HEAVY-DUTY HANDHOLE IN PAVEMENT (TYP.)

DETAIL 1
 N.T.S.

ARTERIAL-VOLUME DENSITY ("FAR OUT" DETECTION)
CROSS STREET-NON VOLUME DENSITY ("UPTIGHT" PRESENCE DETECTION)

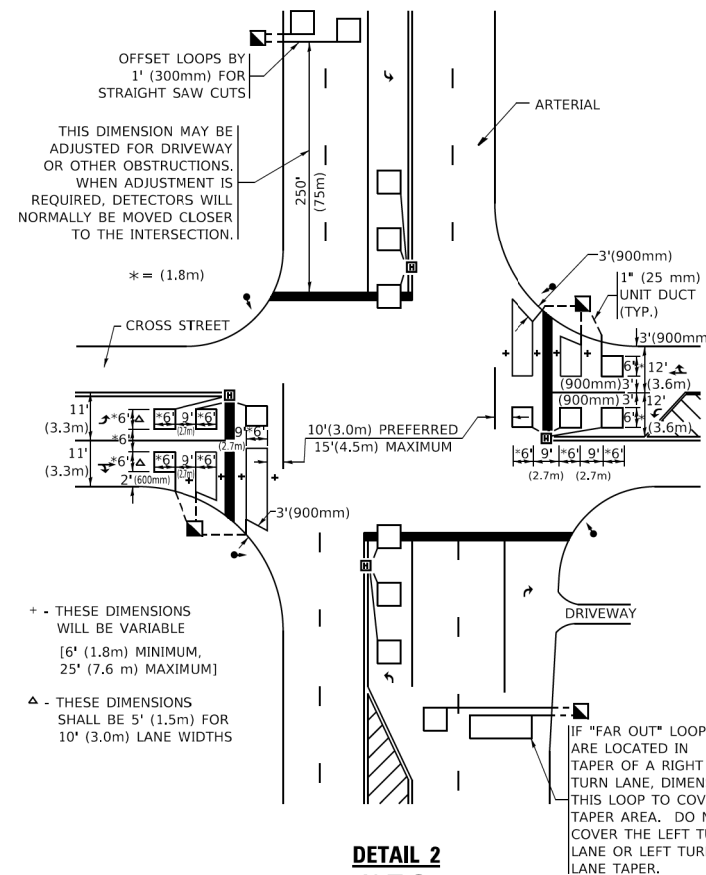

THIS DIMENSION MAY BE ADJUSTED FOR DRIVEWAY OR OTHER OBSTRUCTIONS. WHEN ADJUSTMENT IS REQUIRED, DETECTORS WILL NORMALLY BE MOVED CLOSER TO THE INTERSECTION.

+ - THESE DIMENSIONS WILL BE VARIABLE [6' (1.8m) MINIMUM, 25' (7.6 m) MAXIMUM]

Δ - THESE DIMENSIONS SHALL BE 5' (1.5m) FOR 10' (3.0m) LANE WIDTHS

IF "FAR OUT" LOOPS ARE LOCATED IN TAPER OF A RIGHT TURN LANE, DIMENSION THIS LOOP TO COVER TAPER AREA. DO NOT COVER THE LEFT TURN LANE OR LEFT TURN LANE TAPER.

DETAIL 2
 N.T.S.

STATE OF ILLINOIS
DEPARTMENT OF TRANSPORTATION

DISTRICT 1 - DETECTOR LOOP INSTALLATION
DETAILS FOR ROADWAY RESURFACING

USER NAME = footemj	DESIGNED -	REVISED -
PLOT SCALE = 50.0000' / 1.	DRAWN -	REVISED -
PLOT DATE = 3/4/2019	CHECKED - R.K.F.	REVISED -
	DATE -	REVISED -

SCALE: NONE SHEET 1 OF 1 SHEETS STA. TO STA.

F.A. RTE.	SECTION	COUNTY	TOTAL SHEETS	SHEET NO.
1219	22-00244-00-R5	LAKE	23	23
2736	TS-07	CONTRACT NO.	61164	
ILLINOIS / FED. AID PROJECT				