

STATE OF ILLINOIS  
DEPARTMENT OF TRANSPORTATION

F.A.P. RTE.	SECTION	COUNTY	TOTAL SHEETS	SHEET NO.
304	(4BR,4VBR)BDR,BJR,I	PIKE	12	1
		ILLINOIS	CONTRACT NO. 72711	

FOR INDEX OF SHEETS, SEE SHEET NO. 2

**PROPOSED  
CONTRACT MAINTENANCE**

FAP ROUTE 304 (IL 96)  
SECTION (4BR,4VBR)BDR,BJR,I  
PROJECT (STATE)  
BRIDGE DECK REPAIRS  
PIKE COUNTY

C-96-080-23

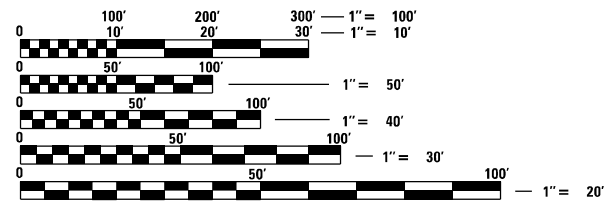
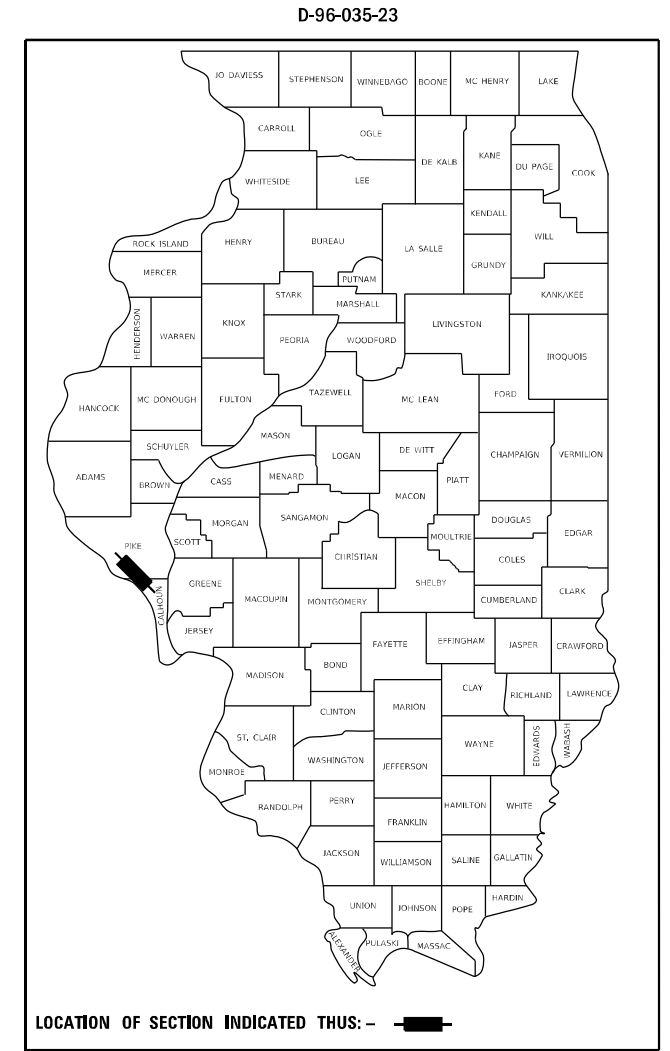

FULL SIZE PLANS HAVE BEEN PREPARED USING STANDARD ENGINEERING SCALES. REDUCED SIZED PLANS WILL NOT CONFORM TO STANDARD SCALES. IN MAKING MEASUREMENTS ON REDUCED PLANS, THE ABOVE SCALES MAY BE USED.

J.U.L.I.E.  
JOINT UTILITY LOCATION INFORMATION FOR EXCAVATORS  
1-800-892-0123  
OR 811

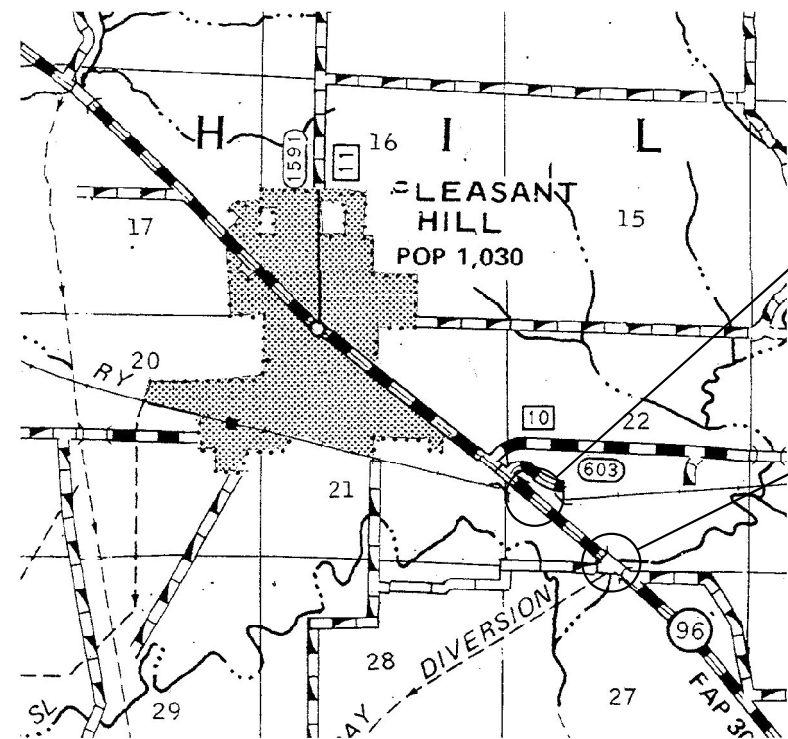

LOCATION #1  
SN 075-0047  
IL 96 OVER KCS RR  
1 MI SE PLEASANT HILL

LOCATION #2  
SN 075-0048  
IL 96 OVER  
6 MI BAY DIVERSION  
1.3 MI SE PLEASANT HILL

BRIDGE MAINTENANCE ENGINEER: BRANDON DUDLEY - (217) 785-9290

GROSS LENGTH = 3,620 FT. = 0.69 MILE  
NET LENGTH = 671 FT. = 0.13 MILE

CONTRACT NO. 72711

STATE OF ILLINOIS  
DEPARTMENT OF TRANSPORTATION

SUBMITTED May 17, 2023

*[Signature]*  
REGIONAL ENGINEER

June 30, 2023 *[Signature]*  
ENGINEER OF DESIGN AND ENVIRONMENT

June 30, 2023 *[Signature]*  
DIRECTOR OF HIGHWAYS PROJECT IMPLEMENTATION

**PRINTED BY THE AUTHORITY  
OF THE STATE OF ILLINOIS**

INDEX OF SHEETS

- 1 COVER SHEET
- 2 INDEX, STANDARDS, SIGNATURES, & GENERAL NOTES
- 3-4 SUMMARY OF QUANTITIES
- 5 STAGING PLAN
- 6-7 TRAFFIC CONTROL PLAN
- 8-12 BRIDGE PLANS

STANDARDS



- 000001-08
- 001001-02
- 001006
- 701001-02
- 701006-05
- 701201-05
- 701301-04
- 701316-13
- 701901-08

GENERAL NOTES:

AREAS OF DECK REPAIRS SHOWN ARE ESTIMATED. THE ENGINEER SHALL SHOW ACTUAL LOCATIONS ON AS-BUILT PLANS.

FULL DEPTH PATCHES SHALL BE COVERED WITH STEEL PLATES WHEN WORKERS ARE NOT PRESENT.

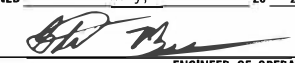
ALL TEMPORARY MARKING TAPE THAT IS TO REMAIN IN PLACE LONGER THAN 14 DAYS SHALL BE TYPE III OR TYPE IV TAPE. TYPE I TEMPORARY PAVEMENT MARKING TAPE MAY BE USED FOR APPLICATIONS OF 14 DAYS OR LESS.

<b>STATE OF ILLINOIS DEPARTMENT OF TRANSPORTATION DIVISION OF HIGHWAYS DISTRICT 6</b>	
EXAMINED	May, 8 20 23
 ENGINEER OF OPERATIONS	
EXAMINED	May, 2 20 23
 ENGINEER OF PROJECT IMPLEMENTATION	
EXAMINED	May, 12 20 23
 ENGINEER OF PROGRAM DEVELOPMENT	

\* REV. SK

MODEL: Default  
FILE NAME: S:\Ipadest\Bridges\plans\_CAD\72711 - 0750048 & 0048\_patching\planindex.dgn

	USER NAME = Brandon.Dudley	DESIGNED -	REVISED -	<b>STATE OF ILLINOIS DEPARTMENT OF TRANSPORTATION</b>	<b>INDEX OF SHEETS, STANDARDS, GENERAL NOTES, &amp; SIGNATURES</b>	SCALE:	SHEET OF SHEETS	STA. TO STA.	F.A.P. RTE.	SECTION	COUNTY	TOTAL SHEETS	SHEET NO.
		DRAWN -	REVISED -			304	(4BR,4VBR)BDR,BJR,I	PIKE	12	2			
	PLOT SCALE = 100.0000' / in.	CHECKED -	REVISED -			CONTRACT NO. 72711				ILLINOIS FED. AID PROJECT			
	PLOT DATE = 5/16/2023	DATE -	REVISED -										

0-02178-6007	0-02178-6007
SN 075-0047	SN 075-0048
100% STATE	100% STATE
BRIDGE/RURAL	BRIDGE/RURAL
0047	0047
PIKE	PIKE

CODE NO.	ITEM	UNIT	TOTAL QUANTITY	BRIDGE/RURAL 0047 PIKE	BRIDGE/RURAL 0047 PIKE
50102400	CONCRETE REMOVAL	CU YD	0.1	0	0.1
50300300	PROTECTIVE COAT	SQ YD	447	173	274
52000015	PREFORMED JOINT SEAL 1-1/2"	FOOT	37	0	37
52000030	PREFORMED JOINT SEAL 2-1/2"	FOOT	37	0	37
59200101	BRIDGE WASHING NO. 1	EACH	1	0	1
59300100	CONTROLLED LOW-STRENGTH MATERIAL	CU YD	13	13	0
67100100	MOBILIZATION	L SUM	1	0.5	0.5
70100100	TRAFFIC CONTROL AND PROTECTION, STANDARD 701316	EACH	2	1	1
70100450	TRAFFIC CONTROL AND PROTECTION, STANDARD 701201	L SUM	1	0.5	0.5
70106500	TEMPORARY BRIDGE TRAFFIC SIGNALS	EACH	2	1	1
70106700	TEMPORARY RUMBLE STRIPS	EACH	12	6	6
70107006	PAVEMENT MARKING BLACKOUT TAPE, 6"	FOOT	3773	1803	1970
70107025	CHANGEABLE MESSAGE SIGNS	CAL DAY	180	90	90
70300150	SHORT TERM PAVEMENT MARKING REMOVAL	SQ FT	1887	902	985

MODEL: D:\p\h\l  
 FILE NAME: S:\Addresses\Bridges\Bridges\_CAD\72711 - 0750048 & 0048\_patch\q\l\m\k\c\c\p\p

USER NAME = Brandon.Dudley	DESIGNED -	REVISED -
	DRAWN -	REVISED -
PLOT SCALE = 100,0000 ' / in.	CHECKED -	REVISED -
PLOT DATE = 5/16/2023	DATE -	REVISED -

**STATE OF ILLINOIS  
DEPARTMENT OF TRANSPORTATION**

**SUMMARY OF QUANTITIES**

SCALE: SHEET OF SHEETS STA. TO STA.

F.A.P. RTE.	SECTION	COUNTY	TOTAL SHEETS	SHEET NO.
304	(4BR,4VBR)BDR,BJR,I	PIKE	12	3
CONTRACT NO. 72711				
ILLINOIS FED. AID PROJECT				



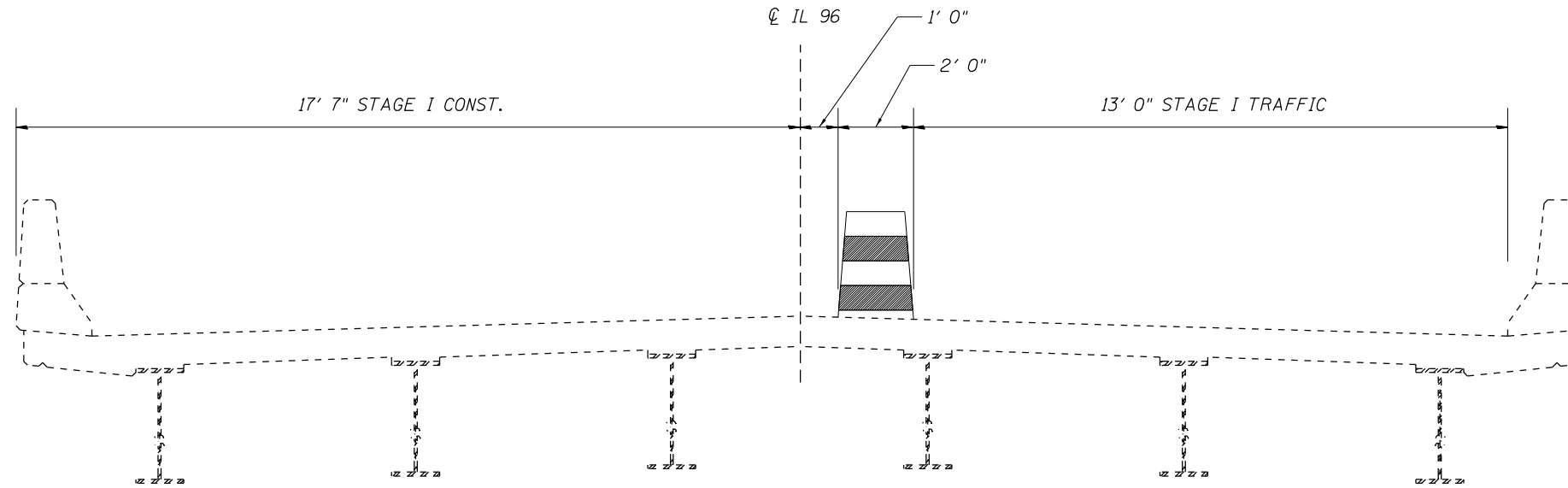

**STAGE I CROSS SECTION**  
(Looking South)

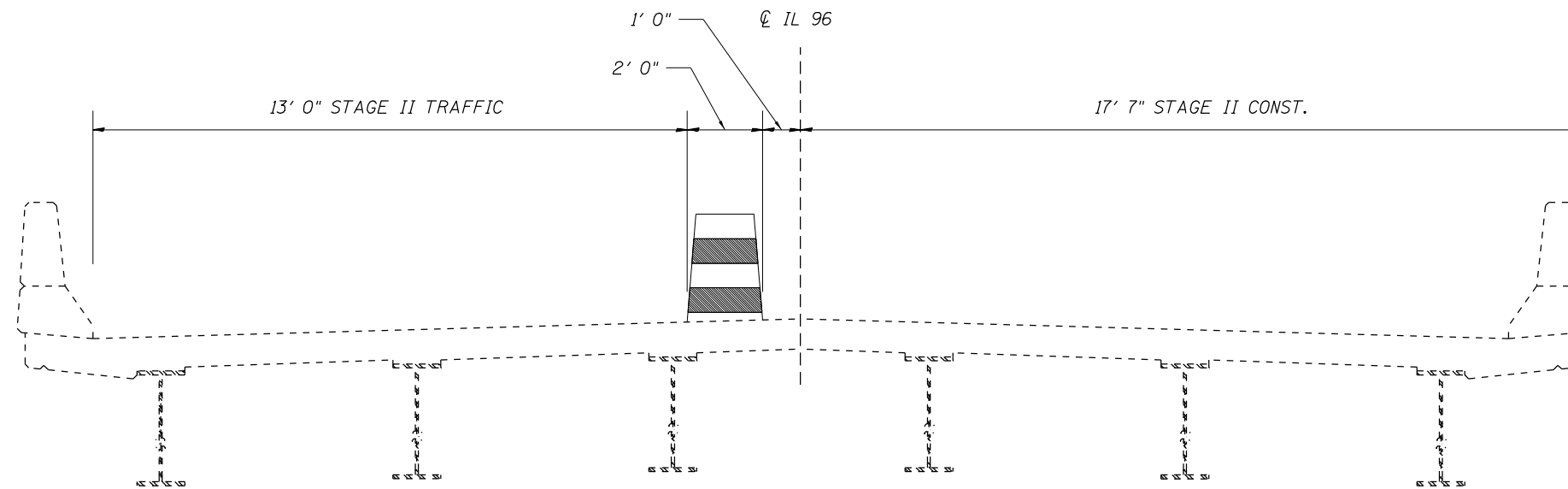

**STAGE II CROSS SECTION**  
(Looking South)

NOTE: CONSTRUCTION STAGES MAY BE SWAPPED AT THE CONTRACTOR'S OPTION

MODEL: Default  
FILE NAME: S:\Addresses\Bridges\BDR\72711 - 0750048 & 0049\_patch\planning\plan\stage.dgn

USER NAME = Brandon.Dudley	DESIGNED -	REVISED -
	DRAWN -	REVISED -
PLOT SCALE = 100,0000' / in.	CHECKED -	REVISED -
PLOT DATE = 5/16/2023	DATE -	REVISED -

**STATE OF ILLINOIS  
DEPARTMENT OF TRANSPORTATION**

**TRAFFIC STAGING PLAN**

SCALE: SHEET OF SHEETS STA. TO STA.

F.A.P. RTE.	SECTION	COUNTY	TOTAL SHEETS	SHEET NO.
304	(4BR,4VBR)BDR,BJR,I	PIKE	12	4
CONTRACT NO. 72711				
ILLINOIS FED. AID PROJECT				

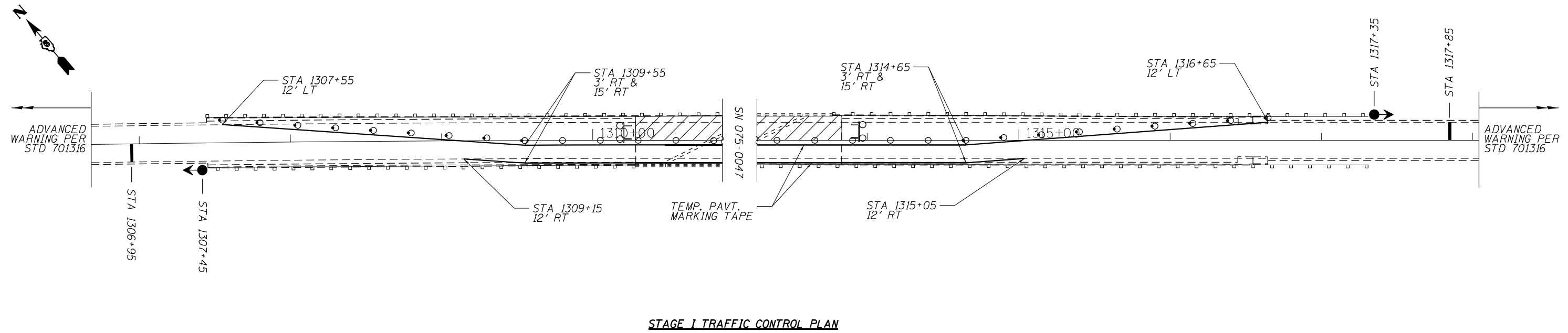



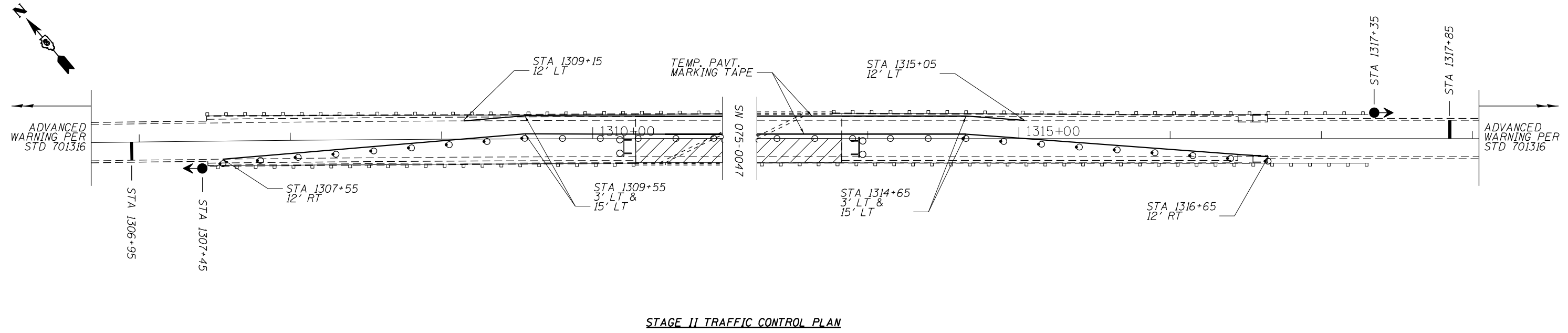

**STAGE I TRAFFIC CONTROL PLAN**

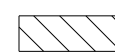

**STAGE II TRAFFIC CONTROL PLAN**

**SYMBOLS**

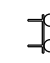
-  WORK AREA
-  DRUM WITH STEADY BURN BI-DIRECTIONAL LIGHT
-  DRUM
-  TRAFFIC SIGNAL
-  TYPE III BARRICADE WITH FLASHING LIGHTS

**TRAFFIC CONTROL NOTES:**

1. TRAFFIC CONTROL DEVICES NOT SHOWN IN THIS DETAIL SHALL BE PER STANDARD 701316. DEVICES AND TEMPORARY PAVEMENT MARKINGS SHOWN IN THIS DETAIL SHALL BE INCLUDED IN THE COST OF TRAFFIC CONTROL AND PROTECTION, STANDARD 701316. TEMPORARY RUMBLE STRIPS, AND TEMPORARY BRIDGE TRAFFIC SIGNALS SHALL BE PAID SEPARATELY.
2. IF SN 075-0047 & 0048 ARE UNDER CONSTRUCTION CONCURRENTLY, TEMPORARY RUMBLE STRIPS WILL NOT BE REQUIRED BETWEEN THE STRUCTURES.

MODEL: Default  
FILE NAME: S:\Addresses\Bridges\BDR\72711 - 0750048 & 0048\_patch\tdm\trkcr.dgn

USER NAME = Brandon.Dudley	DESIGNED -	REVISED -
DRAWN -	REVISOR -	REVISION -
PLOT SCALE = 100,0000' / in.	CHECKED -	REVISOR -
PLOT DATE = 5/16/2023	DATE -	REVISION -

**STATE OF ILLINOIS  
DEPARTMENT OF TRANSPORTATION**

**TRAFFIC CONTROL PLAN  
SN 075-0047**

SCALE: SHEET OF SHEETS STA. TO STA.

F.A.P. RTE.	SECTION	COUNTY	TOTAL SHEETS	SHEET NO.
304	(4BR,4VBR)BDR,BJR,I	PIKE	12	6
CONTRACT NO. 72711				
ILLINOIS FED. AID PROJECT				

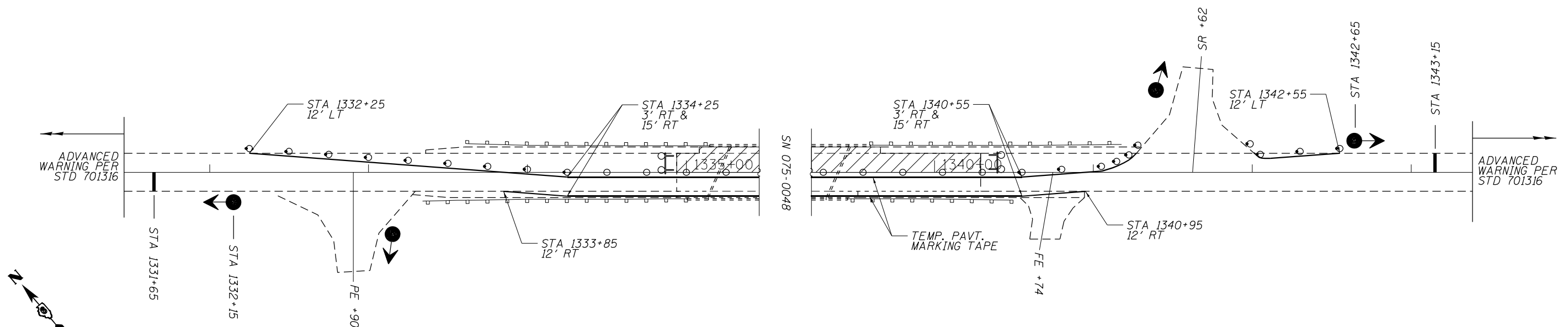

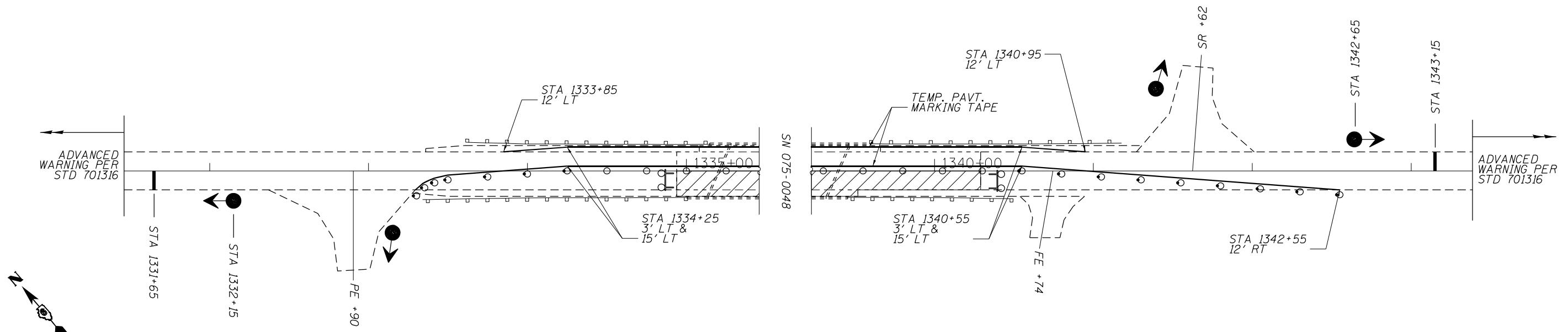

**STAGE I TRAFFIC CONTROL PLAN**

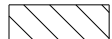

**STAGE II TRAFFIC CONTROL PLAN**

**SYMBOLS**

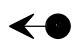
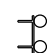
-  WORK AREA
-  DRUM WITH STEADY BURN BI-DIRECTIONAL LIGHT
-  DRUM
-  TRAFFIC SIGNAL
-  TYPE III BARRICADE WITH FLASHING LIGHTS

**TRAFFIC CONTROL NOTES:**

1. TRAFFIC CONTROL DEVICES NOT SHOWN IN THIS DETAIL SHALL BE PER STANDARD 701316. DEVICES AND TEMPORARY PAVEMENT MARKINGS SHOWN IN THIS DETAIL SHALL BE INCLUDED IN THE COST OF TRAFFIC CONTROL AND PROTECTION, STANDARD 701316. TEMPORARY RUMBLE STRIPS, AND TEMPORARY BRIDGE TRAFFIC SIGNALS SHALL BE PAID SEPARATELY.
2. IF SN 075-0047 & 0048 ARE UNDER CONSTRUCTION CONCURRENTLY, TEMPORARY RUMBLE STRIPS WILL NOT BE REQUIRED BETWEEN THE STRUCTURES.

MODEL: Default  
FILE NAME: S:\Addresses\Bridges\sn\_075\0048 & 0048\_traffic\_control\_plan.dgn

USER NAME = Brandon.Dudley	DESIGNED -	REVISED -
	DRAWN -	REVISED -
PLOT SCALE = 100,0000' / in.	CHECKED -	REVISED -
PLOT DATE = 5/16/2023	DATE -	REVISED -

**STATE OF ILLINOIS  
DEPARTMENT OF TRANSPORTATION**

**TRAFFIC CONTROL PLAN  
SN 075-0048**

SCALE: SHEET OF SHEETS STA. TO STA.

F.A.P. RTE.	SECTION	COUNTY	TOTAL SHEETS	SHEET NO.
304	(4BR,4VBR)BDR,BJR,I	PIKE	12	7
ILLINOIS FED. AID PROJECT			CONTRACT NO. 72711	

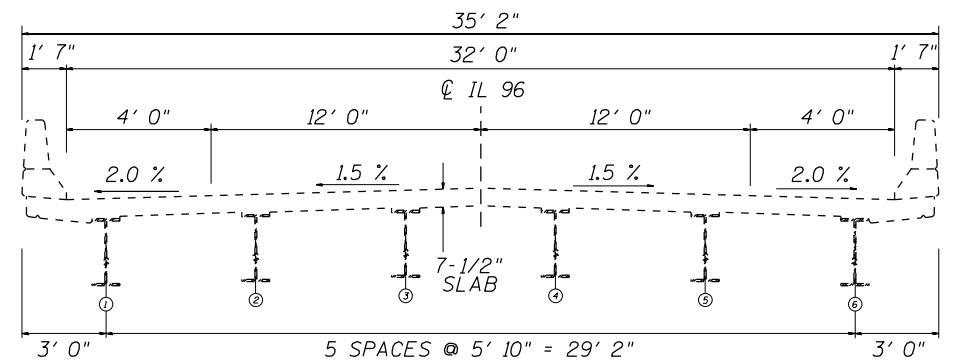
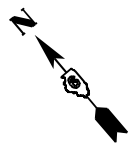
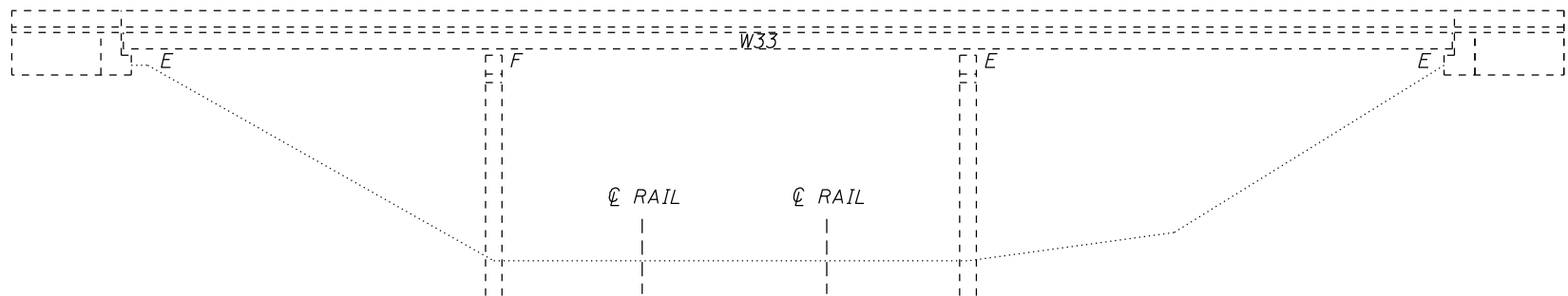

**CROSS SECTION**  
 (Looking South)

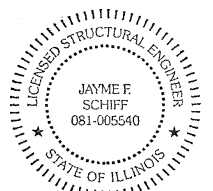
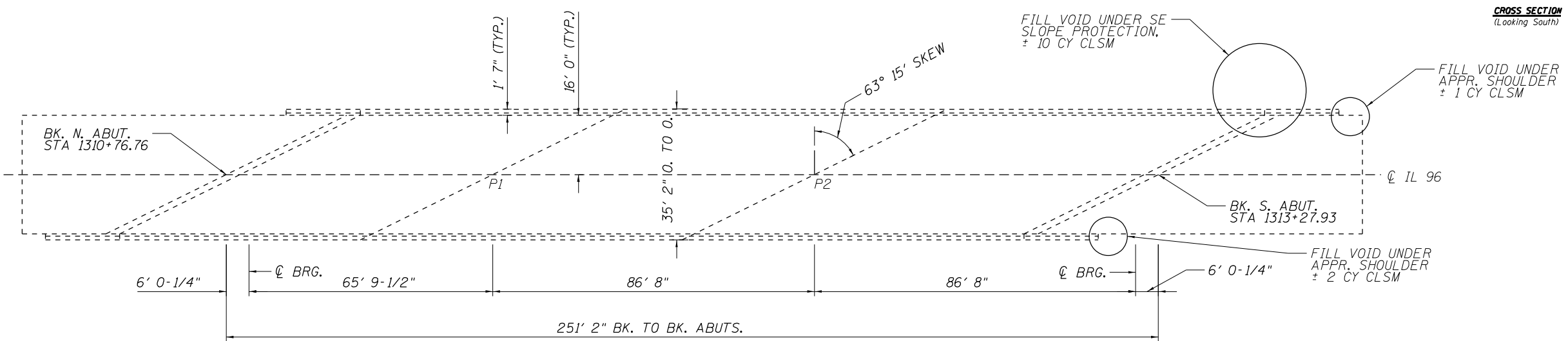

EXPIRES 11-30-2024

*Jayme F. Schiff*

**TOTAL BILL OF MATERIAL (SN 075-0047)**

ITEM	UNIT	QUANTITY
Deck Slab Repair (Partial)	Sq. Yd.	120
Approach Slab Repair (Partial Depth)	Sq. Yd.	53
Deck Slab Repair (Full Depth, Type II)	Sq. Yd.	5*
Joint Sealing (Patches)	Foot	1300
Protective Coat	Sq. Yd.	173
Controlled Low-Strength Material	Cu. Yd.	13

\* No FD patches anticipated, nominal quantity included

**STRUCTURE GENERAL NOTES:**

PRIOR TO POURING THE NEW CONCRETE PATCHES, ALL HEAVY OR LOOSE MILL SCALE AND OTHER LOOSE OR POTENTIALLY DETRIMENTAL FOREIGN MATERIAL SHALL BE REMOVED FROM THE SURFACES IN CONTACT WITH CONCRETE. TIGHTLY ADHERED PAINT MAY REMAIN UNLESS OTHERWISE NOTED. REMOVAL SHALL BE ACCOMPLISHED BY METHODS THAT WILL NOT DAMAGE THE STEEL AND THE COST WILL BE INCLUDED IN CONCRETE REMOVAL.

PLAN DIMENSIONS AND DETAILS RELATIVE TO EXISTING PLANS ARE SUBJECT TO NOMINAL CONSTRUCTION VARIATIONS. THE CONTRACTOR SHALL FIELD VERIFY EXISTING DIMENSIONS AND DETAILS AFFECTING NEW CONSTRUCTION AND MAKE NECESSARY APPROVED ADJUSTMENTS PRIOR TO CONSTRUCTION OR ORDERING OF MATERIALS. SUCH VARIATIONS SHALL NOT BE CAUSE FOR ADDITIONAL COMPENSATION FOR A CHANGE IN THE SCOPE OF WORK, HOWEVER, THE CONTRACTOR WILL BE PAID FOR THE QUANTITY ACTUALLY FURNISHED AT THE UNIT PRICE BID FOR THE WORK.

EXISTING REINFORCEMENT BARS EXTENDING INTO THE REMOVAL AREA SHALL BE CLEANED, STRAIGHTENED, AND INCORPORATED INTO THE NEW CONSTRUCTION. ANY REINFORCEMENT BARS THAT ARE DAMAGED DURING CONCRETE REMOVAL SHALL BE REPLACED WITH AN APPROVED BAR SPLICER OR ANCHORAGE SYSTEM. COST INCLUDED WITH CONCRETE REMOVAL.

PROTECTIVE COAT SHALL BE APPLIED TO NEW CONCRETE ONLY.

FILLING VOIDS UNDER APPROACH SHOULDERS SHALL BE COMPLETED PRIOR TO STAGING TRAFFIC

MODEL: D:\p\br... FILE NAME: S:\p\br... CAD: 7/21/23... 0750048 & 0049\_patch\br... dgm

USER NAME = Brandon.Dudley	DESIGNED - BRANDON DUDLEY	REVISED -
	DRAWN - BRANDON DUDLEY	REVISED -
PLOT SCALE = 100,0000' / in.	CHECKED -	REVISED -
PLOT DATE = 5/16/2023	DATE - 4/14/2023	REVISED -

**STATE OF ILLINOIS  
 DEPARTMENT OF TRANSPORTATION**

**BRIDGE PLAN & ELEVATION  
 SN 075-0047**

SCALE: SHEET 1 OF 2 SHEETS STA. TO STA.

F.A.P. RTE.	SECTION	COUNTY	TOTAL SHEETS	SHEET NO.
304	(4BR,4VBR)BDR,BJR,I	PIKE	12	8
ILLINOIS FED. AID PROJECT			CONTRACT NO. 72711	



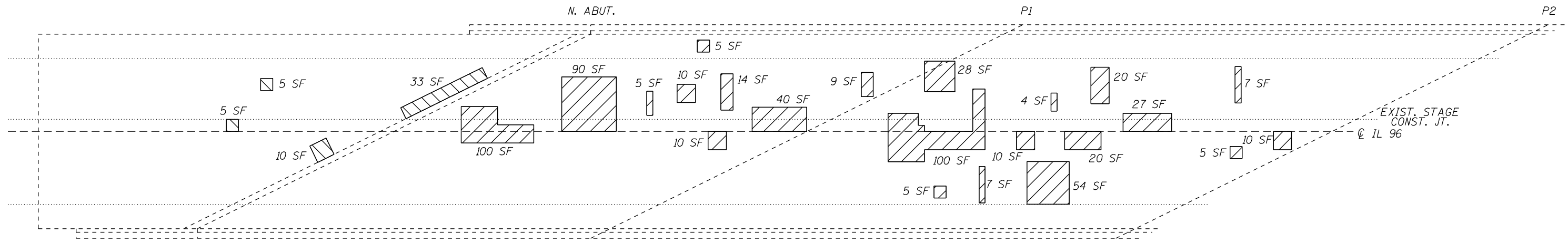

**PARTIAL DECK PLAN**

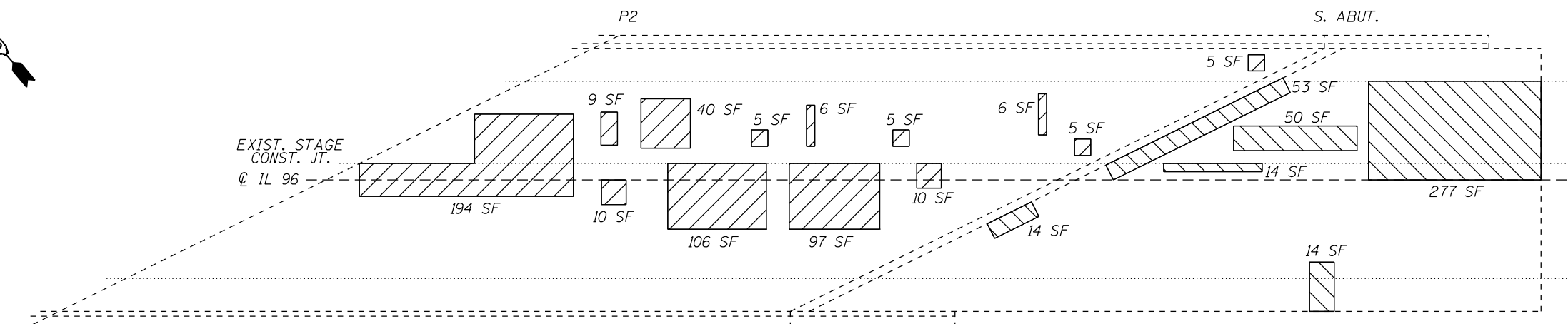
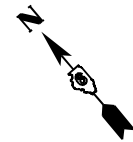

**PARTIAL DECK PLAN**

**PATCHING BILL OF MATERIAL**

ITEM	UNIT	QUANTITY
Deck Slab Repair (Partial)	Sq. Yd.	120
Approach Slab Repair (Partial Depth)	Sq. Yd.	53
Deck Slab Repair (Full Depth, Type II) *	Sq. Yd.	5*
Joint Sealing (Patches)	Foot	950

\* No FD patches anticipated, nominal quantity included



APPROACH SLAB REPAIR (PARTIAL DEPTH)



DECK SLAB REPAIR (PARTIAL)

**NOTES:**

IDENTIFIED PATCHING LOCATIONS ARE ESTIMATED FROM A DECK SURVEY PERFORMED ON 1/24/2023. THE PATCHING SURVEY IS INCLUDED FOR INFORMATION ONLY. THE ENGINEER SHALL LAY OUT ACTUAL PATCH LOCATIONS IN THE FIELD.

THE ENGINEER SHALL SHOW ACTUAL LOCATIONS OF DECK REPAIRS ON AS-BUILT PLANS.

IF FULL DEPTH PATCHES ARE DISCOVERED, THEY SHALL BE COVERED WITH STEEL PLATES DURING NON-WORK HOURS.

JOINT SEALING (PATCHES) SHALL BE APPLIED IN LOCATIONS AS DIRECTED IN THE SPECIAL PROVISIONS, ALONG THE ENTIRE LENGTH OF THE EXISTING STAGE CONSTRUCTION LINE, AND ALONG THE CONSTRUCTION JOINTS BETWEEN THE ABUTMENT AND APPROACHES.

MODEL: Default  
FILE NAME: S:\Addresses\Bridges\BDR\72711 - 0750047 & 0048 - patching\slabrepair.dgn

USER NAME = Brandon.Dudley	DESIGNED -	REVISED -
PLOT SCALE = 100,0000' / in.	DRAWN -	REVISED -
PLOT DATE = 5/16/2023	CHECKED -	REVISED -
	DATE -	REVISED -

**STATE OF ILLINOIS  
DEPARTMENT OF TRANSPORTATION**

**SLAB REPAIR PLAN  
SN 075-0047**

SCALE: SHEET 2 OF 2 SHEETS STA. TO STA.

F.A.P. RTE.	SECTION	COUNTY	TOTAL SHEETS	SHEET NO.
304	(4BR,4VBR)BDR,BJR,I	PIKE	12	9
ILLINOIS FED. AID PROJECT			CONTRACT NO. 72711	

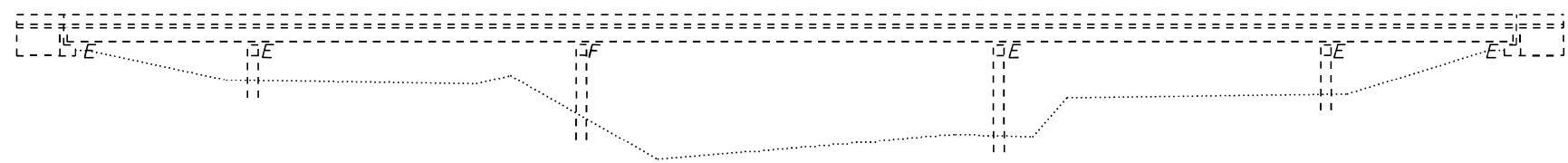

**ELEVATION**

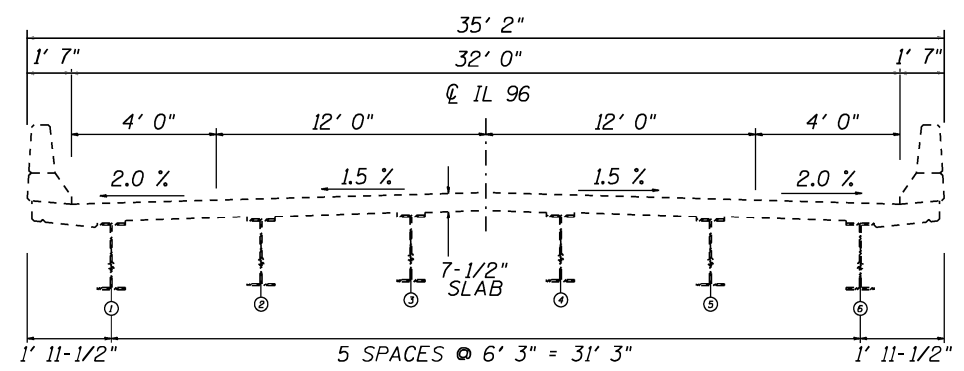

**CROSS SECTION**  
(Looking South)

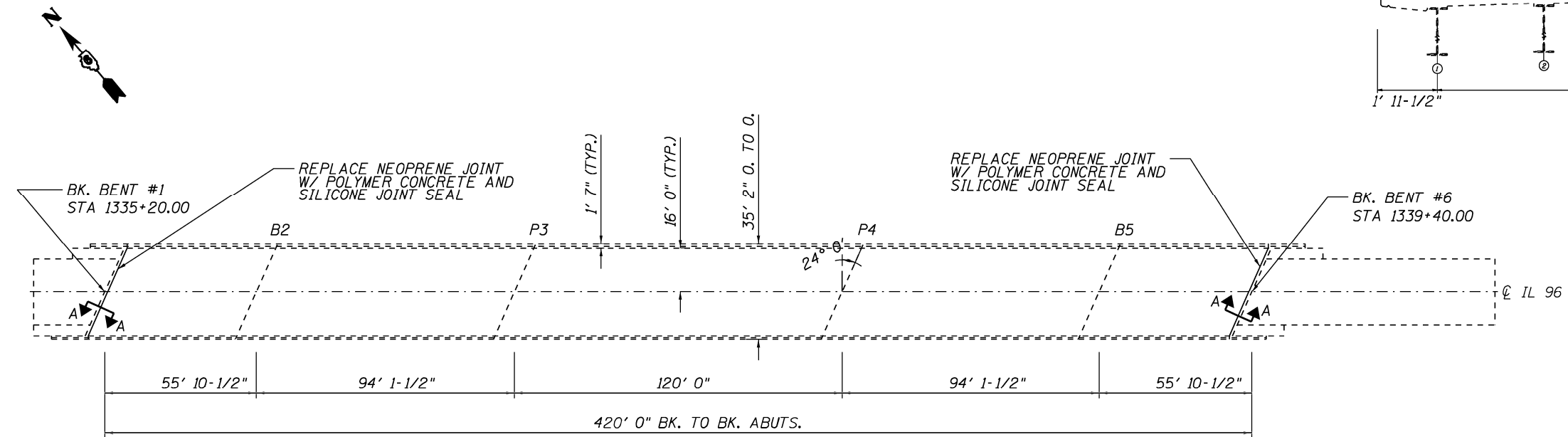

**PLAN**

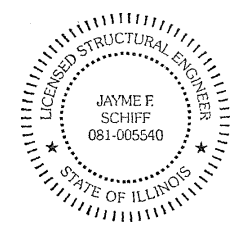

EXPIRES 11-30-2024

*Jayme F. Schiff*

**TOTAL BILL OF MATERIAL (075-0048)**

ITEM	UNIT	QUANTITY
Deck Slab Repair (Partial)	Sq. Yd.	120
Approach Slab Repair (Partial Depth)	Sq. Yd.	141
Deck Slab Repair (Full Depth, Type II)	Sq. Yd.	13
Joint Sealing (Patches)	Foot	2000
Polymer Concrete	Cu. Yd.	13
Preformed Joint Seal 1-1/2"	Foot	37
Preformed Joint Seal 2-1/2"	Foot	37
Concrete Removal	Cu. Yd.	0.1
Protective Coat	Sq. Ft.	274
Bridge Washing No. 1	Each	1

**STRUCTURE GENERAL NOTES:**

PRIOR TO POURING THE NEW CONCRETE PATCHES, ALL HEAVY OR LOOSE MILL SCALE AND OTHER LOOSE OR POTENTIALLY DETRIMENTAL FOREIGN MATERIAL SHALL BE REMOVED FROM THE SURFACES IN CONTACT WITH CONCRETE. TIGHTLY ADHERED PAINT MAY REMAIN UNLESS OTHERWISE NOTED. REMOVAL SHALL BE ACCOMPLISHED BY METHODS THAT WILL NOT DAMAGE THE STEEL AND THE COST WILL BE INCLUDED IN CONCRETE REMOVAL.

PLAN DIMENSIONS AND DETAILS RELATIVE TO EXISTING PLANS ARE SUBJECT TO NOMINAL CONSTRUCTION VARIATIONS. THE CONTRACTOR SHALL FIELD VERIFY EXISTING DIMENSIONS AND DETAILS AFFECTING NEW CONSTRUCTION AND MAKE NECESSARY APPROVED ADJUSTMENTS PRIOR TO CONSTRUCTION OR ORDERING OF MATERIALS. SUCH VARIATIONS SHALL NOT BE CAUSE FOR ADDITIONAL COMPENSATION FOR A CHANGE IN THE SCOPE OF WORK, HOWEVER, THE CONTRACTOR WILL BE PAID FOR THE QUANTITY ACTUALLY FURNISHED AT THE UNIT PRICE BID FOR THE WORK.

EXISTING REINFORCEMENT BARS EXTENDING INTO THE REMOVAL AREA SHALL BE CLEANED, STRAIGHTENED, AND INCORPORATED INTO THE NEW CONSTRUCTION. ANY REINFORCEMENT BARS THAT ARE DAMAGED DURING CONCRETE REMOVAL SHALL BE REPLACED WITH AN APPROVED BAR SPLICER OR ANCHORAGE SYSTEM. COST INCLUDED WITH CONCRETE REMOVAL.

PROTECTIVE COAT SHALL BE APPLIED TO NEW CONCRETE ONLY.

MODEL: Default; FILE: M:\MIS\_S\Sub\Bridges\Bridges\CAD\17711\_0750048\_0048\_patchings\plan-sheet.dgn

USER NAME = Brandon.Dudley	DESIGNED - BRANDON DUDLEY	REVISED -
	DRAWN - BRANDON DUDLEY	REVISED -
PLOT SCALE = 100.0000' / in.	CHECKED -	REVISED -
PLOT DATE = 5/16/2023	DATE - 4/14/2023	REVISED -

**STATE OF ILLINOIS**  
**DEPARTMENT OF TRANSPORTATION**

**BRIDGE PLAN & ELEVATION**  
**SN 075-0048**

SCALE: SHEET 1 OF 3 SHEETS STA. TO STA.

F.A.P. RTE.	SECTION	COUNTY	TOTAL SHEETS	SHEET NO.
304	(4BR,4VBR)BDR,BJR,I	PIKE	12	10
			CONTRACT NO. 72711	
		ILLINOIS FED. AID PROJECT		

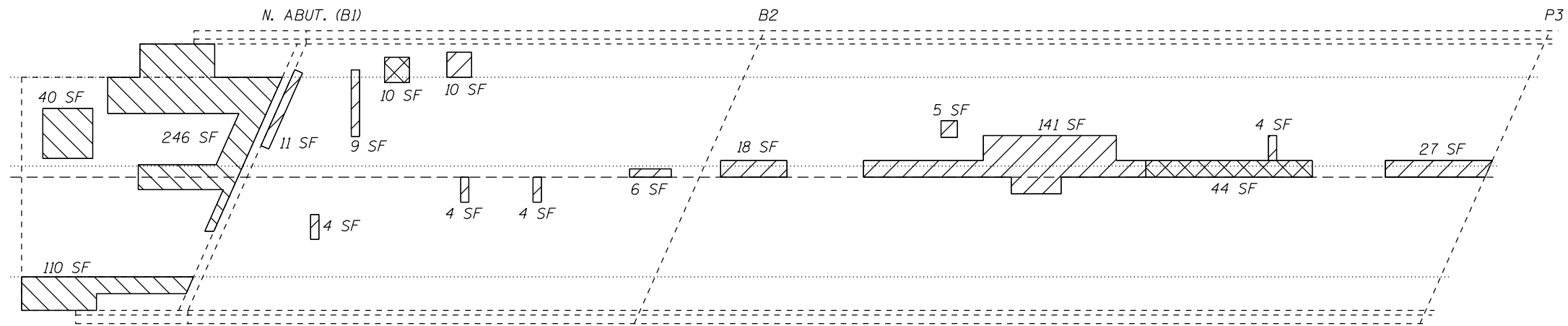
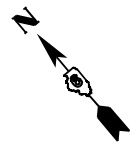

**PARTIAL DECK PLAN**

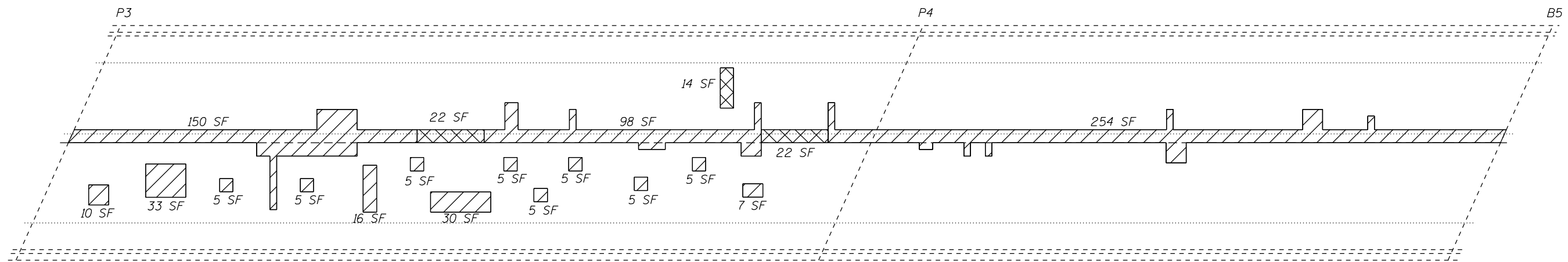

**PARTIAL DECK PLAN**

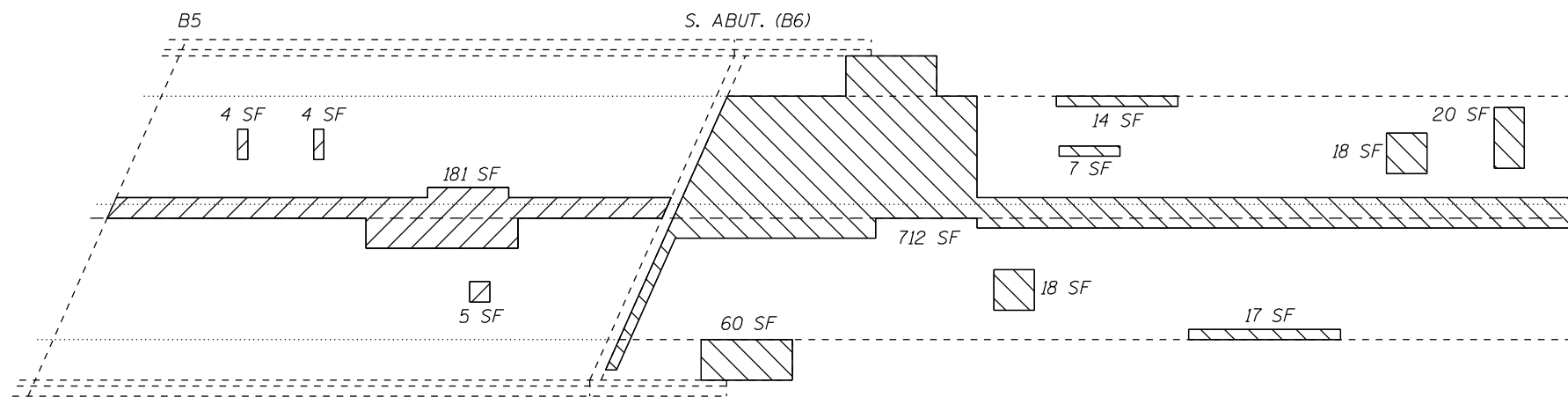

**PARTIAL DECK PLAN**

**PATCHING BILL OF MATERIAL**

ITEM	UNIT	QUANTITY
Deck Slab Repair (Partial)	Sq. Yd.	120
Approach Slab Repair (Partial Depth)	Sq. Yd.	141
Deck Slab Repair (Full Depth, Type II)	Sq. Yd.	13
Joint Sealing (Patches)	Foot	2000



DECK SLAB REPAIR (FULL DEPTH)



APPROACH SLAB REPAIR (PARTIAL DEPTH)



DECK SLAB REPAIR (PARTIAL)

**NOTES:**

IDENTIFIED PATCHING LOCATIONS ARE ESTIMATED FROM A DECK SURVEY PERFORMED ON 1/24/2023. THE PATCHING SURVEY IS INCLUDED FOR INFORMATION ONLY. THE ENGINEER SHALL LAY OUT ACTUAL PATCH LOCATIONS IN THE FIELD.

THE ENGINEER SHALL SHOW ACTUAL LOCATIONS OF DECK REPAIRS ON AS-BUILT PLANS.

FULL DEPTH PATCHING LOCATIONS MAY BE OMITTED IF SOUND CONCRETE IS ENCOUNTERED.

JOINT SEALING (PATCHES) SHALL BE APPLIED IN LOCATIONS AS DIRECTED IN THE SPECIAL PROVISIONS, ALONG THE ENTIRE LENGTH OF THE EXISTING STAGE CONSTRUCTION LINE, AND ALONG THE CONSTRUCTION JOINTS BETWEEN THE ABUTMENT AND APPROACHES.

MODEL: Default  
FILE NAME: S:\Addresses\Bridges\BDR\72711 - 0750048 & 0018\_patch\plan\slabrepair.dgn

USER NAME = Brandon.Dudley	DESIGNED -	REVISED -
PLOT SCALE = 100,0000' / in.	DRAWN -	REVISED -
PLOT DATE = 5/16/2023	CHECKED -	REVISED -
	DATE -	REVISED -

**STATE OF ILLINOIS  
DEPARTMENT OF TRANSPORTATION**

**SLAB REPAIR PLAN  
SN 075-0048**

SCALE: SHEET 2 OF 3 SHEETS STA. TO STA.

F.A.P. RTE.	SECTION	COUNTY	TOTAL SHEETS	SHEET NO.
304	(4BR,4VBR)BDR,BJR,I	PIKE	12	11
CONTRACT NO. 72711			ILLINOIS FED. AID PROJECT	

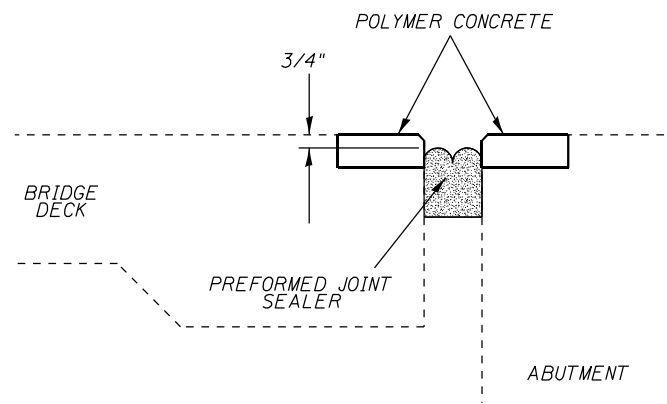

SECTION A-A:  
PREFORMED JOINT SEALER DETAIL

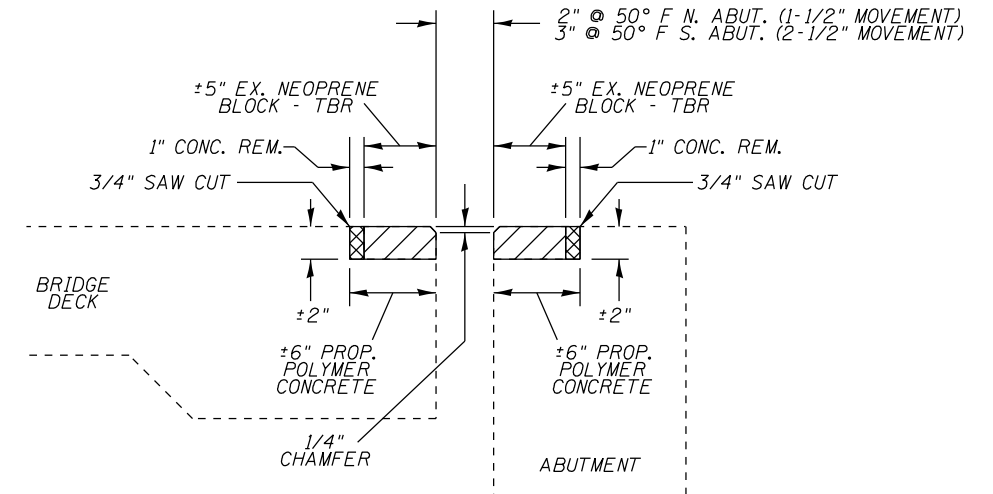

SECTION A-A  
PROPOSED POLYMER CONCRETE  
CROSS SECTION

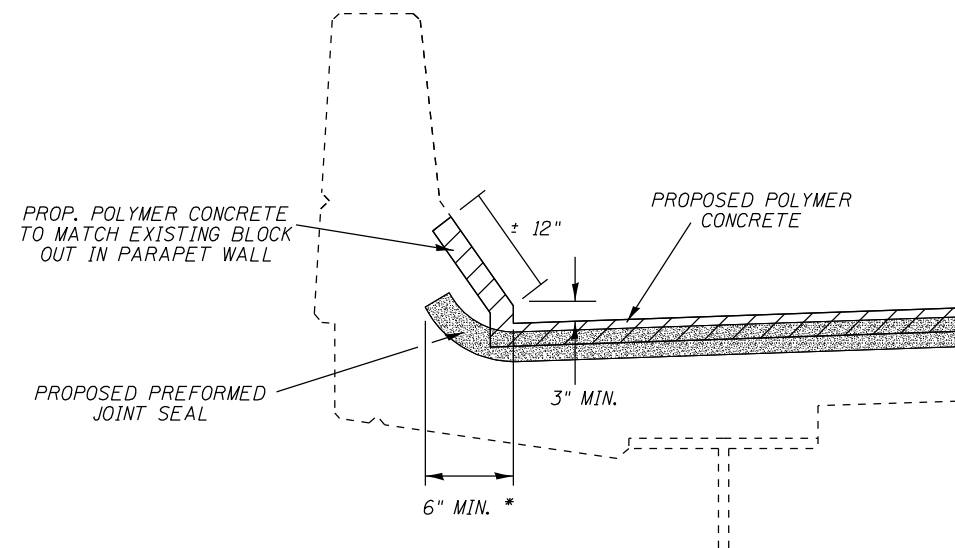

TYPICAL PARAPET CROSS SECTION:  
JOINT SEALER END TREATMENT

NOTES:

- 1/4" CHAMFER MAY BE ACHIEVED BY GRINDING AFTER POLYMER CONCRETE HAS CURED.
- REMOVAL OF EXISTING NEOPRENE EXPANSION JOINTS SHALL BE INCLUDED IN THE COST OF CONCRETE REMOVAL.
- ANY STEEL ANCHORING STUDS ENCOUNTERED IN THE NEOPRENE JOINT REMOVAL AREA SHALL BE CUT OFF FLUSH WITH THE EXISTING CONCRETE. COST TO BE INCLUDED IN THE BID PRICE FOR CONCRETE REMOVAL.
- THE PREFORMED PRE-COMPRESSED, SILICONE COATED, SELF-EXPANDING SEALANT SYSTEM SHALL BE USED.

JOINT REPAIR BILL OF MATERIAL

ITEM	UNIT	QUANTITY
Polymer Concrete	Cu. Ft.	13
Preformed Joint Seal 1-1/2"	Foot	37
Preformed Joint Seal 2-1/2"	Foot	37
Concrete Removal	Cu. Yd.	0.1

MODEL: Default  
FILE NAME: S:\Addresses\Bridges\BDR\72711 - 0750048 & 0048\_patch\jdr\mshaker.dgn

USER NAME = Brandon.Dudley	DESIGNED -	REVISED -
PLOT SCALE = 100,0000' / in.	DRAWN -	REVISED -
PLOT DATE = 5/16/2023	CHECKED -	REVISED -
	DATE -	REVISED -

STATE OF ILLINOIS  
DEPARTMENT OF TRANSPORTATION

JOINT REPAIR DETAILS  
SN 075-0048

SCALE: SHEET 3 OF 3 SHEETS STA. TO STA.

F.A.P. RTE.	SECTION	COUNTY	TOTAL SHEETS	SHEET NO.
304	(4BR,4VBR)BDR,BJR,I	PIKE	12	12
ILLINOIS FED. AID PROJECT			CONTRACT NO. 72711	