

F.A.I. SECTION	COUNTY	TOTAL SHEETS	SHEET NO.
94/90	COOK	556	46
STA. TO STA.		FED. ROAD DIST. NO. ILLINOIS FED. AID PROJECT	
62300		1818, ETC., 2324.6-1PR-8	

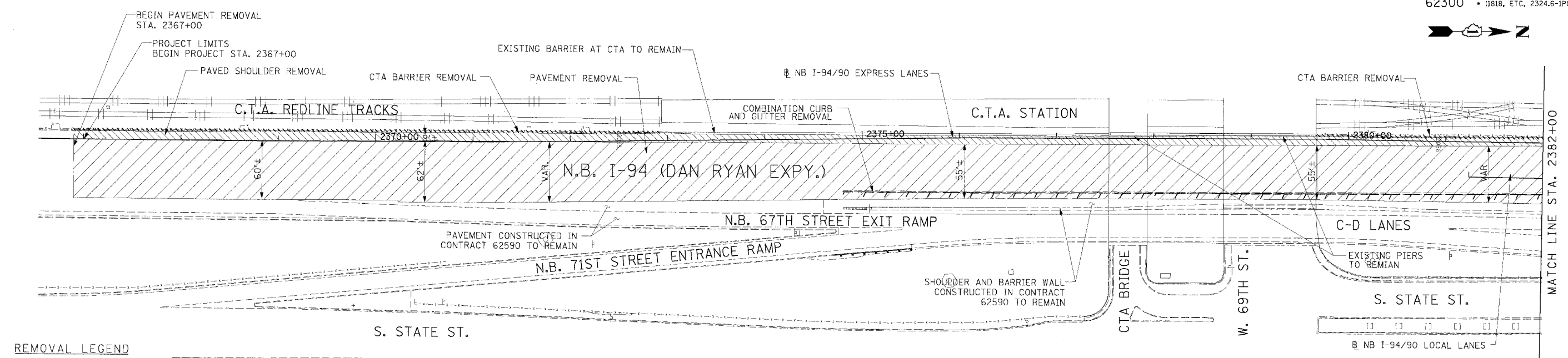

REMOVAL LEGEND

	PAVEMENT REMOVAL
	PAVED SHOULDER REMOVAL
	COMBINATION CURB AND GUTTER REMOVAL
	CONCRETE BARRIER OR GUARD RAIL REMOVAL

NOTE:
 1. THE LOCATION OF PAVEMENT CONSTRUCTED IN PREVIOUS CONTRACTS IS BASED OFF OF CONTRACT PLAN DRAWINGS. THE CONTRACTOR MUST VERIFY LIMITS OF PREVIOUS CONSTRUCTION IN THE FIELD.

EXISTING CONDITIONS & REMOVALS

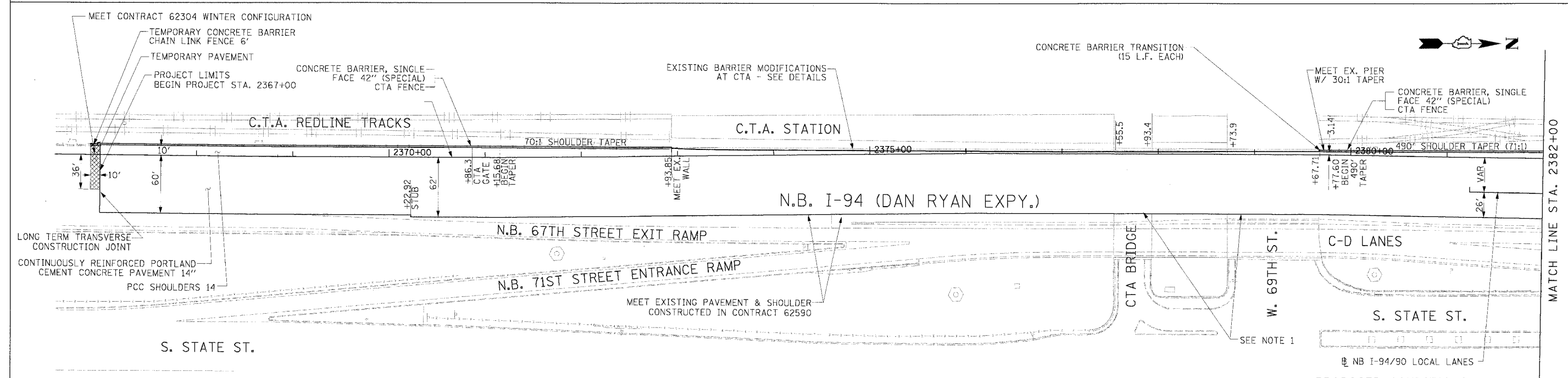

LONG TERM TRANSVERSE CONSTRUCTION JOINT
 CONTINUOUSLY REINFORCED PORTLAND CEMENT CONCRETE PAVEMENT 14"
 PCC SHOULDERS 14"

NOTE:
 1. BRIDGE OVER EXPRESS LANES OMITTED FOR CLARITY.

STATIONING
 +**.** STATION PROVIDED FROM THE I-90/94 EXPRESS LANES
 (+**.***) STATION PROVIDED FROM THE I-90/94 LOCAL LANES
 [+**.**#] STATION PROVIDED FROM THE SLIP RAMP

LEGEND

	TEMPORARY PAVEMENT (INTERSTATE)/TEMPORARY SHOULDER
	TEMPORARY CONCRETE BARRIER

REVISIONS	
NAME	DATE

ILLINOIS DEPARTMENT OF TRANSPORTATION
 F.A.I. 94/90 (DAN RYAN EXPRESSWAY)
 31ST STREET TO 71ST STREET
 NB EXPRESS LANE RECONSTRUCTION
 EXISTING AND PROPOSED PLAN
 NORTHBOUND STA. 2367+00 TO STA. 2382+00
 SCALE: 1"=50'
 DATE: 7/7/05
 DRAWN BY: TAI
 CHECKED BY: PJM

Edwards AND Kelcey
 ONE NORTH FRANKLIN CHICAGO, IL 60606
 PHONE: (312) 251-3000
 FAX: (312) 251-3015
 WEB: WWW.EKCORP.COM

06/24/2005 10:55:13 AM RDY-1