

62806

F. A. SITE NO.	SECTION	COUNTY	TOTAL SHEETS	SHEET NO.
90/94	*	COOK	35	20
STA. 523+45	TO STA. 539+40			
FED. ROAD DIST NO. 1	ILLINOIS	FED AID PROJECTS		

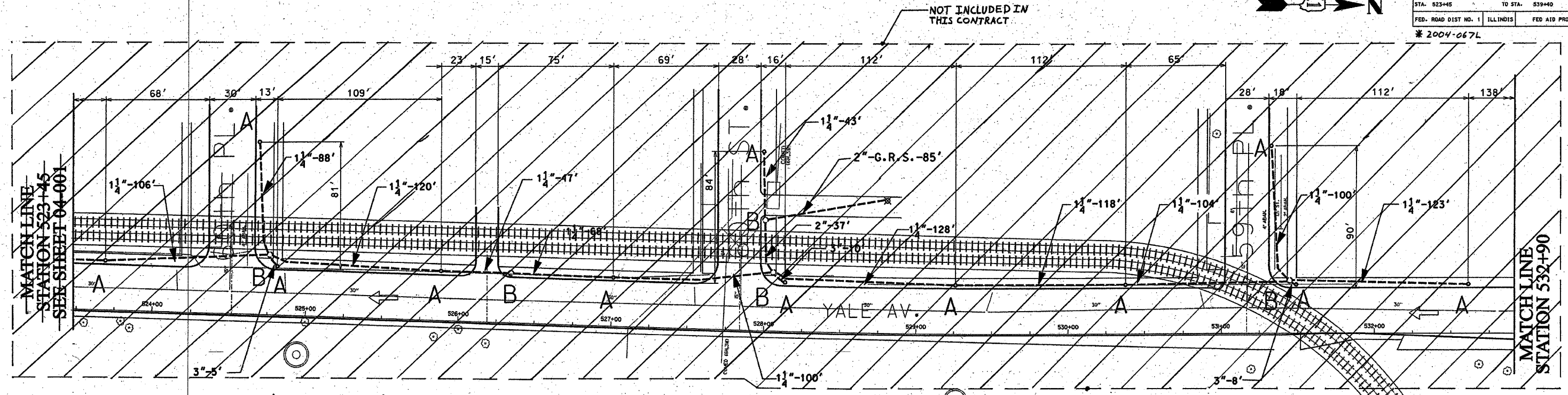

- 1 1/4" DIRECT BORED CONDUIT SCHEDULE #80 AS PER IDOT ARTICLE 810.03
- 2" DIRECT BORED CONDUIT SCHEDULE #80 AS PER IDOT ARTICLE 810.03
- 2", 3" CONDUIT SCHEDULE #40 INSTALLED IN TRENCH AS PER IDOT ARTICLE 810.03
- 2" GALVANIZED RIGID STEEL ELBOW ON STRUCTURE
- 2" GALVANIZED RIGID STEEL CONDUIT INSTALLED IN TRENCH AS PER IDOT ARTICLE 810.03
- HAND HOLE - 30" x 36" WITH 24" FRAME AND COVER
- CONCRETE FOUNDATION - 5' x 20", 10" B.C., 1" ANCHOR RODS

NOTES: CONTRACTOR IS TO INSTALL UNDERGROUND CONDUIT AND PULL ROPE BETWEEN FOUNDATIONS AS WELL AS PERFORM THE FOLLOWING WORK ITEMS ACCORDING TO BUREAU OF ELECTRICITY SPECIFICATIONS:

"A" - INSTALL 20" x 5' FOUNDATION, 10" B.C., 1" ANCHOR RODS AS PER DRAWING NO. 565, 2' OFF FACE OF CURB, UNLESS NOTED OTHERWISE. BUILD FOUNDATIONS FLUSH WITH SIDEWALK SURFACE.

"B" - INSTALL 30" HANDHOLE AS PER DRAWING NO. 867 WITH 24" FRAME AND COVER.

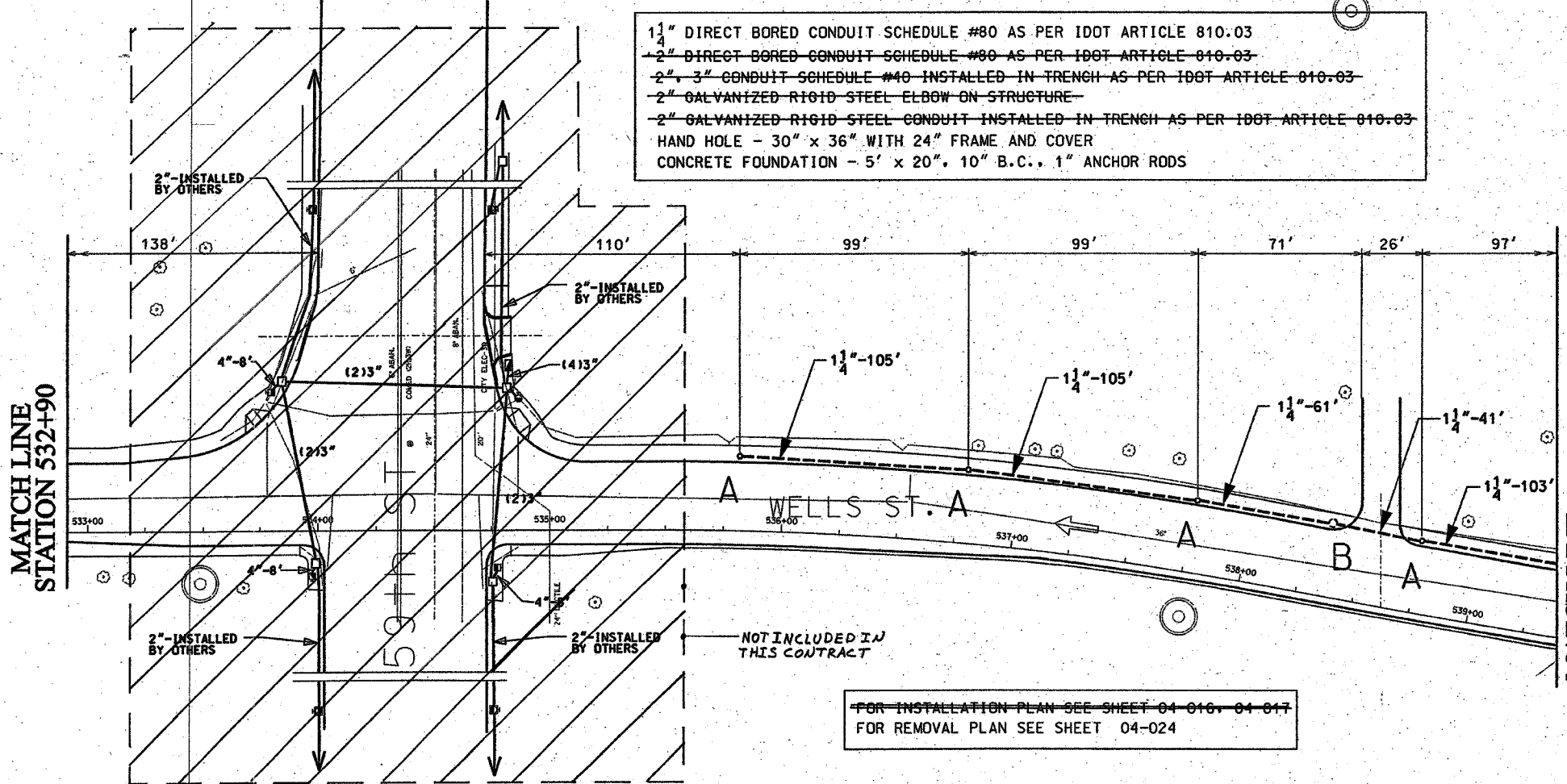

FOR INSTALLATION PLAN SEE SHEET 04-016, 04-017  
FOR REMOVAL PLAN SEE SHEET 04-024

CITY OF CHICAGO  
DEPT. OF STREETS AND SANITATION  
BUREAU OF ELECTRICITY  
DIVISION OF ELECTRICAL ENGINEERING

DRAFTSMAN B. GARNSEY	CHIEF DRAFTSMAN ROBERT CARTER	ENGINEER B. GARNSEY
SUPERVISING ENGINEER ELEC. DESIGN ENGR.		
ENGINEER OF ELECTRICITY:	DWG. NO. <b>04-002</b>	
GEN'L SUPT. OF ELECTRICITY:		
DEPUTY COMMISSIONER:		
SIZE: 22"   36"	SCALE: 1"=30'	DATE: 1/20/04

ILLINOIS DEPARTMENT OF TRANSPORTATION  
F.A.I. 90/94 (DAN RYAN EXPRESSWAY)  
59th St. TO 47th St. (FRONTAGE ROADS)

STREET LIGHTING  
UNDERGROUND CONDUIT FACILITIES

SCALE: 1" = 30'  
DATE: February 11, 2005  
DRAWN BY: B.T.G.  
CHECKED BY: O.L.

REVISIONS	
NAME	DATE