

62806

F. A. RITE	SECTION	COUNTY	TOTAL SHEETS	SHEET NO.
90/94	*	COOK	35	21
STA. 539+40		TO STA. 556+00		
FED. ROAD DIST. NO. 1		ILLINOIS	FED AID PROJECTS	
* 2004-067L				

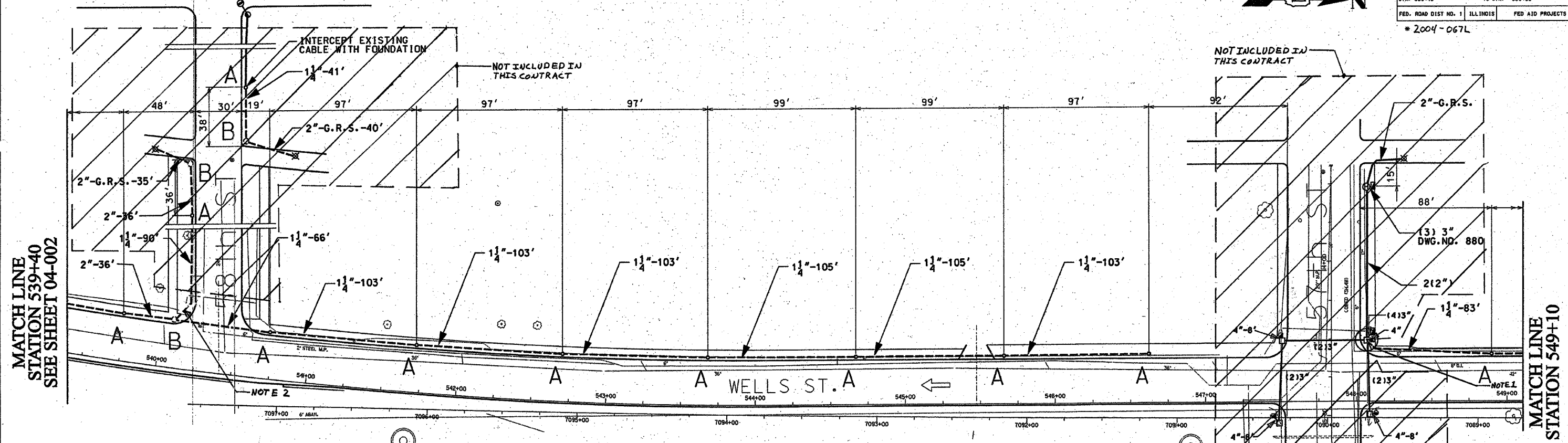

PRINCETON



MATCH LINE  
STATION 539+40  
SEE SHEET 04-002

MATCH LINE  
STATION 549+10

- 1 1/4" DIRECT BORED CONDUIT SCHEDULE #80 AS PER IDOT ARTICLE 810.03
- 2" DIRECT BORED CONDUIT SCHEDULE #80 AS PER IDOT ARTICLE 810.03
- 2" CONDUIT SCHEDULE #40 INSTALLED IN TRENCH AS PER IDOT ARTICLE 810.03
- 2" GALVANIZED RIGID STEEL ELBOW ON STRUCTURE
- 2" GALVANIZED RIGID STEEL CONDUIT INSTALLED IN TRENCH AS PER IDOT ARTICLE 810.03
- HAND HOLE - 30" x 36" WITH 24" FRAME AND COVER
- CONCRETE FOUNDATION - 5' x 20", 10" B.C., 1" ANCHOR RODS

- NOTES: CONTRACTOR IS TO INSTALL UNDERGROUND CONDUIT AND PULL ROPE BETWEEN FOUNDATIONS AS WELL AS PERFORM THE FOLLOWING WORK ITEMS ACCORDING TO BUREAU OF ELECTRICITY SPECIFICATIONS:
- "A" - INSTALL 20" x 5' FOUNDATION, 10" B.C., 1" ANCHOR RODS AS PER DRAWING NO. 565, 2' OFF FACE OF CURB, UNLESS NOTED OTHERWISE. BUILD FOUNDATIONS FLUSH WITH SIDEWALK SURFACE.
  - "B" - INSTALL 30" HANDHOLE AS PER DRAWING NO. 867 WITH 24" FRAME AND COVER
  - "D" - INSTALL BASE FOUNDATION AS PER DWG. 876 FOR STREET LIGHTING CONTROLLER. TO BE INSTALLED ON TRAFFIC SIGNAL CONTRACT

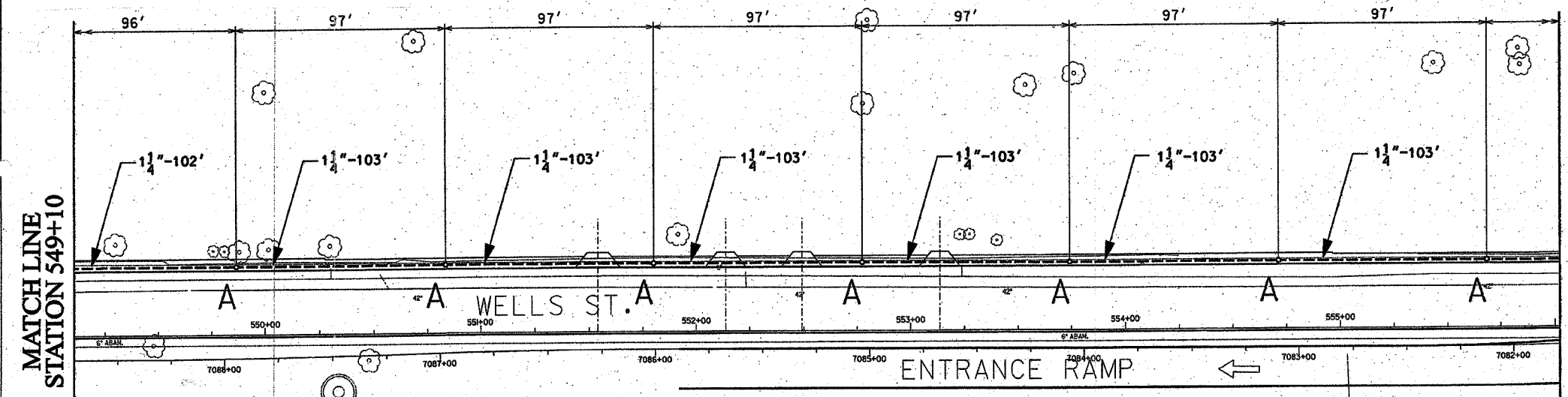

MATCH LINE  
STATION 549+10

MATCH LINE  
STATION 556+05  
SEE SHEET 04-004

FOR INSTALLATION PLAN SEE SHEET 04-017  
FOR REMOVAL PLAN SEE SHEETS 04-024, 04-025

- NOTES:
1. ROUTE PROPOSED CONDUIT RUN TO THE EXISTING MANHOLE OR HANDHOLE AS SHOWN. DRILL THE EXISTING MANHOLE OR HANDHOLE AND INSTALL PROPOSED CONDUIT THROUGH THE MANHOLE OR HANDHOLE WALL. SEE DRAWING BOE-2 FOR DETAILS.
  2. PROVIDE A CONDUIT STUB AT HANDHOLE EXTENDING TO ONE FOOT PAST THE LIMITS OF SIDEWALK REPLACEMENT. PROVIDE A CONDUIT CAP FOR THE CONDUIT STUB. THE CONDUIT CAP WILL BE INCLUDED IN THE UNIT PRICE FOR THE CONDUIT OF SPECIFIED TYPE AND DIAMETER. NO SEPARATE PAYMENT WILL BE MADE SEE IDOT CONTRACT 04-02586 AND 02795 FOR LIMITS OF SIDEWALK REPLACEMENT.

CITY OF CHICAGO			
DEPT. OF STREETS AND SANITATION			
BUREAU OF ELECTRICITY			
DIVISION OF ELECTRICAL ENGINEERING			
DRAFTSMAN	CHIEF DRAFTSMAN	ENGINEER	
B. GARNSEY	ROBERT CARTER	B. GARNSEY	
SUPERVISING ENGINEER	ELEC. DESIGN ENGR.		DWG. NO.
ENGINEER OF ELECTRICITY:			04-003
GEN'L SUPT. OF ELECTRICITY:			
DEPUTY COMMISSIONER:			
SIZE: 22"	36"	SCALE: 1"=30'	DATE: 1/20/04
ILLINOIS DEPARTMENT OF TRANSPORTATION			
F.A.I. 90/94 (DAN RYAN EXPRESSWAY)			
57th St. TO 47th St. (FRONTAGE ROADS)			
STREET LIGHTING UNDERGROUND CONDUIT FACILITIES			
SCALE: 1" = 30'		DRAWN BY: B.T.G.	
DATE: February 11, 2005		CHECKED BY: O.L.	

REVISIONS	
NAME	DATE