

F.A.I. RTE.	SECTION	COUNTY	TOTAL SHEETS	SHEET NO.
80/94	2004-133F	COOK	90	1

CONTRACT NO. 62898  
0-91-012-01 D-91-018-01

FOR INDEX OF SHEETS, SEE SHEET NO. 2

STATE OF ILLINOIS  
DEPARTMENT OF TRANSPORTATION  
DIVISION OF HIGHWAYS

**PROPOSED  
HIGHWAY PLANS**

F.A.I. 80/94 & F.A.P. 332  
(ROUTE: I-80/94 & IL 394)

SECTION 2004-133F  
BEAM AND BEARING FABRICATION  
(OVER THORN CREEK, HARRISON AVE., AND I-80)  
**PROJECT**  
COOK COUNTY, IL AND LAKE COUNTY, IN  
C-91-098-04

THIS PROJECT IS LOCATED IN  
THE VILLAGES OF LANSING AND  
SOUTH HOLLAND, ILLINOIS IN COOK COUNTY  
AND CITY OF HAMMOND, INDIANA  
IN LAKE COUNTY.

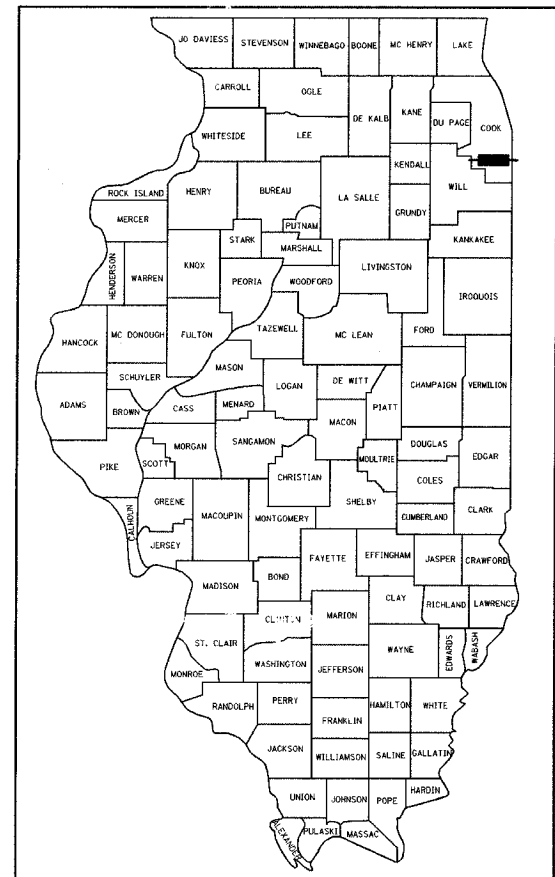

LOCATION OF SECTION INDICATED THUS: - ■ -

**TRAFFIC DATA**

FAI 80 (INTERSTATE 80)  
FAI 94 (INTERSTATE 94)  
IL 394 (ILLINOIS ROUTE 394)

**DESIGN DESIGNATION:**

I-94 WB (F.A.I. RTE 94) 4875 (20) 70.60 (CRCP-30)  
I-80/94 (F.A.I. RTE 80/94) 8135 (30) 76.6 (CRC-30)  
IL-394 NB (F.A.P. RTE 332) 3500 (20) 38.95 (CRCP-30)

**ADT:**

I-94 = 92,700 (1995); 116,000 (2020)  
IL-394 = 41,900 (1995); 78,000 (2020)  
I-80/94 US 6 = 145,100 (1995)  
I-80/94 US 6 = 168,000 (2020)

**DESIGN SPEED:**

I-94 = 110 KMHR  
IL 394 = 110 KMHR  
I-80/94 US 6 (ILLINOIS) = 110 KMHR  
I-80/94 US 6 (INDIANA) = 100 KMHR

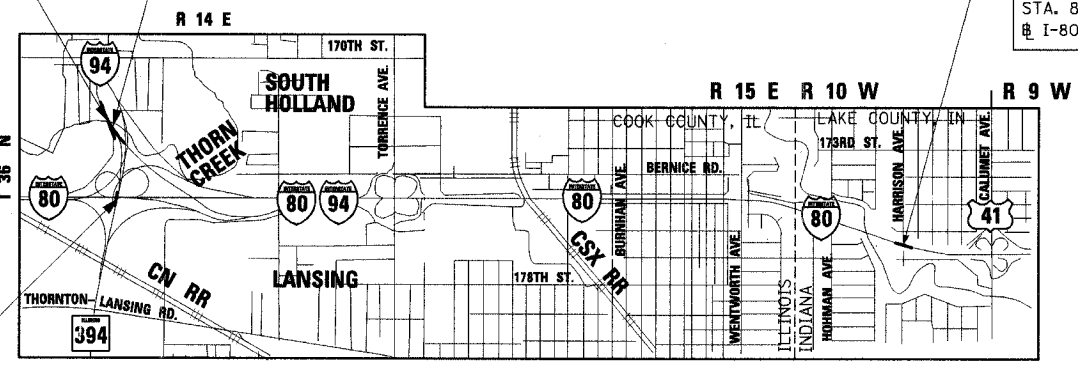
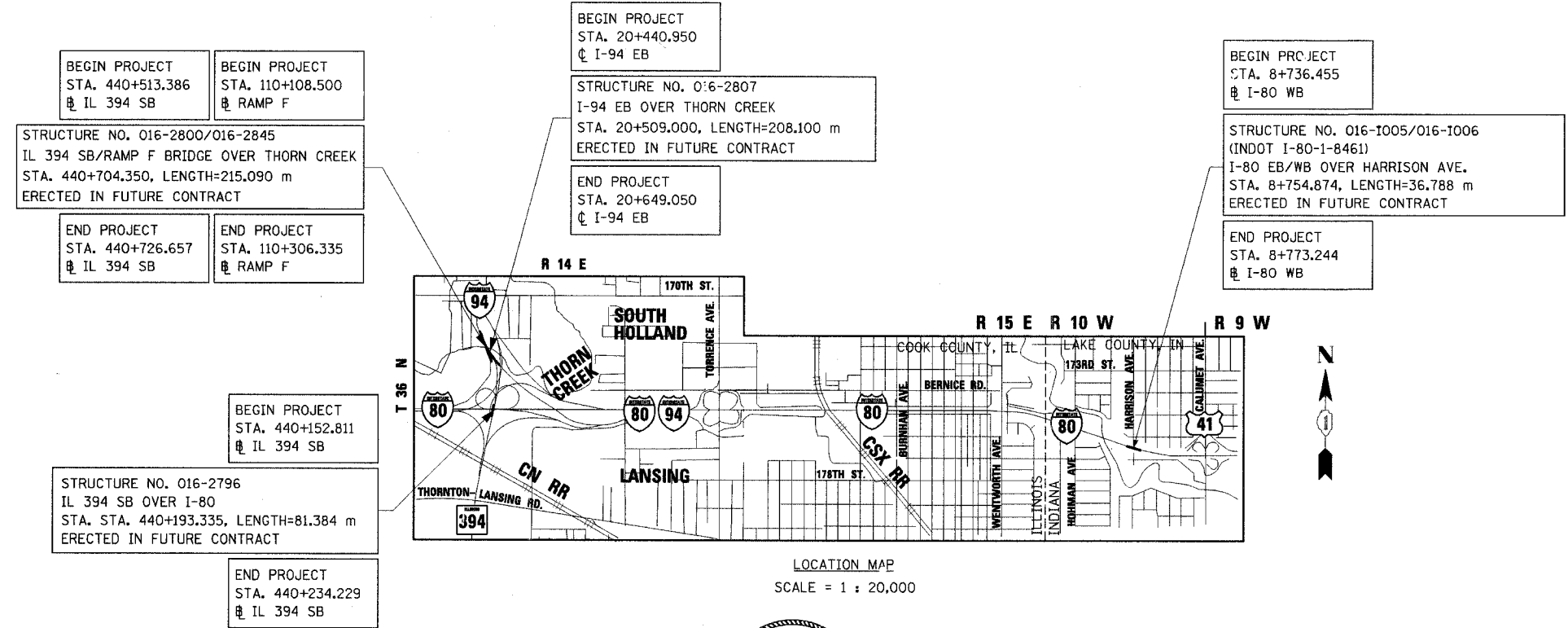

GROSS LENGTH, STRUCTURE NO. 016-2796 = 81.384 m  
GROSS LENGTH, STRUCTURE NO. 016-2800/016-2845 = 215.090 m  
GROSS LENGTH, STRUCTURE NO. 016-2807 = 208.100 m  
GROSS LENGTH, STRUCTURE NO. 016-1005/016-1006 = 36.788 m  
NET LENGTH OF PROJECT = 541.362 m

**CONTRACT NO. 62898**



*Philip C. Azzarello* 5-2-05  
PHILIP C. AZZARELLO, S.E.  
IL. LICENSE NO. 081-004245  
EXPIRES: 11/30/06  
DATE: 5-2-05  
SHEETS: 1-78



*Gary S. Powell*  
GARY S. POWELL, P.E.  
IN. LICENSE NO. 10403944  
EXPIRES: 07-31-2006  
DATE: 05-02-2005  
SHEETS: 79-90

STATE OF ILLINOIS  
DEPARTMENT OF TRANSPORTATION  
DIVISION OF HIGHWAYS

SUBMITTED May 3, 20 05

*Diana O'Keefe* / AP  
DEPUTY DIRECTOR OF HIGHWAYS, REGION ENGINEER

July 1, 20 05  
*Mike Hine* / RD  
ENGINEER OF DESIGN AND ENVIRONMENT

July 1, 20 05  
*Victor Madere* / RD  
DIRECTOR OF HIGHWAYS, CHIEF ENGINEER

**PRINTED BY THE AUTHORITY  
OF THE STATE OF ILLINOIS**

