

STATE OF ILLINOIS
DEPARTMENT OF TRANSPORTATION

Sheet No. 4
of 16 Sheets

ROUTE NO.	SECTION	COUNTY	TOTAL SHEETS	SHEET NO.
SBI 88	103C-BR	BUREAU	51	15
FEDERAL DIST. NO.	LINKS	PROJECT	CONTRACT #64423	

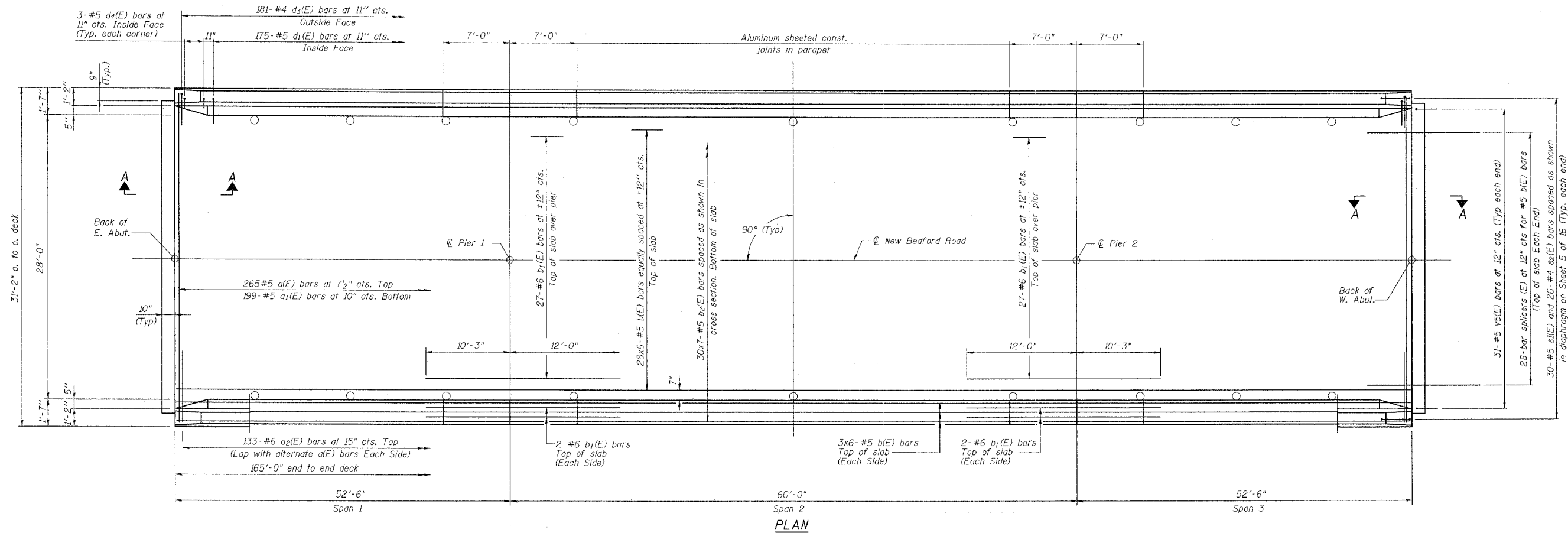

MIN BAR LAP
#5 bar = 2'-2"

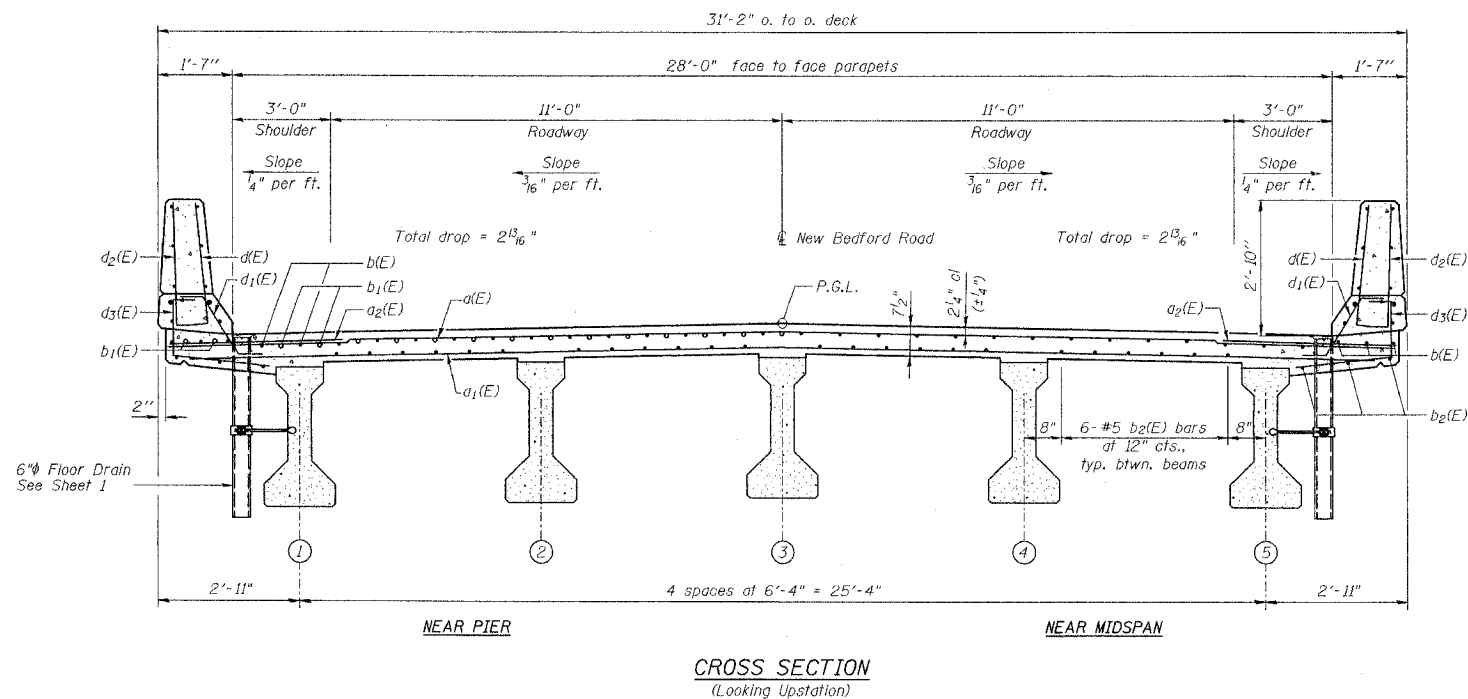

Notes:
See sheet 6 of 16 for superstructure details and Bill of Material.
For Section A-A and diaphragm details see sheet 5 of 16.
Reinforcement bars designated (E) shall be epoxy coated.
Bars indicated thus 20 x 3-#5 etc. indicates 20 lines of bars with 3 lengths per line.
See sheet 6 of 16 for parapet reinforcement.
For Floor Drain spacing see Sheet 1 of 16.
See sheet 14 of 16 for Bar Splicer Details.

NEW BEDFORD ROAD OVER GREEN RIVER

DECK PLAN AND CROSS SECTION

REVISIONS		STATE OF ILLINOIS DEPARTMENT OF TRANSPORTATION DIVISION OF HIGHWAYS		DRAWN BY DATE R King 4/04
NO.	DATE	INITIALS		CHECKED BY DATE CMV 4/04
1				DATE BY DATE CWC 4/04
2				BOOK NUMBER
3				
4				
5				
6				
7				
8				
9				
10				
11				
12				

SBI 88 SPUR	SECTION 103C-BR	PROJECT NO.
STA 29+25.34	SN 006-0163	4858-1
BUREAU COUNTY		SHEET NO.
HOMER L. CHASTAIN & ASSOCIATES, LLP CONSULTING ENGINEERS 184-000397		