

F.A.I. RTE.	SECTION	COUNTY	TOTAL SHEETS	SHEET NO.
57	(139-HB-1, HF-1)	KANKAKEE	78	1

INDEX OF SHEETS

1. COVER SHEET
2. GENERAL NOTES
3. SUMMARY OF QUANTITIES
4. SCHEDULES
5. GENERAL PLAN AND ELEVATION
- 5A PERMANENT PROTECTIVE SHIELD DETAILS
6. DECK SLAB REPAIR SURVEY

STANDARDS

- 701001-01 OFF-ROAD OPERATIONS 2L, 2W, MORE THAN 4.5 m (15') AWAY
- 701006-02 OFF-ROAD OPERATIONS 2L, 2W, 4.5 m (15') TO 600 mm (24") FROM PAVEMENT EDGE
- 701101-01 OFF-ROAD OPERATIONS MULTILANE, 4.5 m (15') TO 600 mm (24") FROM PAVEMENT EDGE
- 701106-01 OFF-ROAD OPERATIONS, MULTILANE, MORE THAN 4.5 m (15') AWAY
- 701301-02 LANE CLOSURE, 2L, 2W, SHORT TIME OPERATIONS
- 701316-03 LANE CLOSURE, 2L, 2W, BRIDGE REPAIR, FOR SPEEDS P 45 MPH
- 701400-02 APPROACH TO LANE CLOSURE, FREEWAY/EXPRESSWAY
- 701406-04 LANE CLOSURE, FREEWAY/EXPRESSWAY, DAY OPERATIONS ONLY
- 702001-05 TRAFFIC CONTROL DEVICES

**STATE OF ILLINOIS**  
**DEPARTMENT OF TRANSPORTATION**  
**DIVISION OF HIGHWAYS**

**PROPOSED**  
**HIGHWAY PLANS**

**FAI ROUTE 57 (I-57)**  
**SECTION (139HB-1, HF-1)**

**KANKAKEE COUNTY**

**C - 93 - 080 - 05**

**BRIDGE REPAIR**

**S.N. 046-0080**



LOCATION OF SECTION INDICATED THUS: - [black bar] -

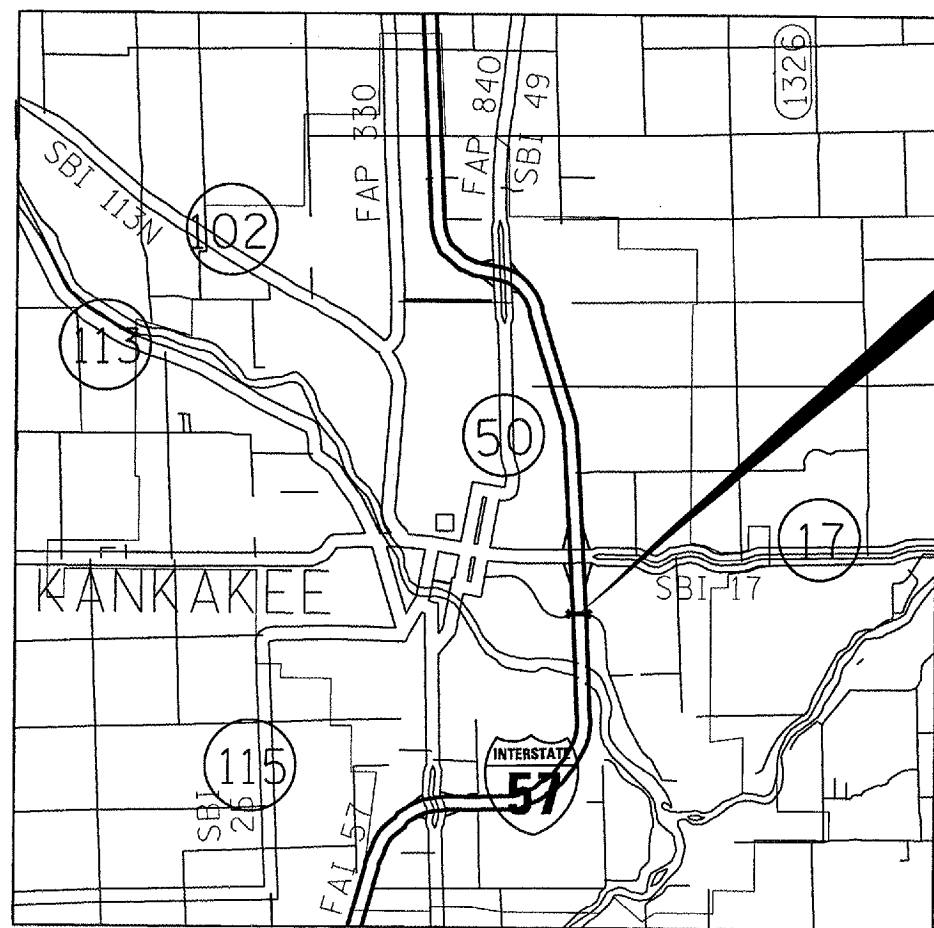

**PROJECT LOCATION**

S.N. 046-0080

CARRYING WALDRON ROAD OVER FAI 57  
 0.74 MILES SOUTH OF IL ROUTE 17

GROSS LENGTH = 204.3 FT. = 0.4 MI.  
 NET LENGTH = 204.3 FT. = 0.4 MI.

DATE: 04/12/05  
 FILE NAME: cr/projects/cmain06/cm305/details.dgn

MICROFILMED \_\_\_\_\_  
 REEL NUMBER \_\_\_\_\_  
 AWARDED \_\_\_\_\_  
 RESIDENT ENGINEER \_\_\_\_\_  
 AS BUILT CHANGES WERE MADE  
 ON THE FOLLOWING SHEETS \_\_\_\_\_

J.U.L.I.E.  
 JOINT UTILITY LOCATION INFORMATION FOR EXCAVATION  
 1-800-892-0123

DISTRICT 3 NO. (815) 434-6131

PROJECT ENGINEER: TOM HUFNAGEL (815)-434-8418  
 UNIT CHIEF: RON WOODSHANK (815)-434-8419

CONTRACT NO. 66575

KANKAKEE COUNTY (139-HB-1, HF-1) FAI 57

STATE OF ILLINOIS  
 DEPARTMENT OF TRANSPORTATION  
 DIVISION OF HIGHWAYS

SUBMITTED 5/19 2005

James Mount  
 DEPUTY DIRECTOR OF HIGHWAYS, REGION ENGINEER

July 1, 20 05  
Mike Hine  
 ENGINEER OF DESIGN AND ENVIRONMENT

July 1, 20 05  
John Mader  
 DIRECTOR OF HIGHWAYS, CHIEF ENGINEER

**PRINTED BY THE AUTHORITY**  
**OF THE STATE OF ILLINOIS**

F.A.I. RTE.	SECTION	COUNTY	TOTAL SHEETS	SHEET NO.
57	(139-HB-1, HF-1)I	KANKAKEE	6	2
STA. 18+41.66		TO STA.	20+76.14	

GENERAL NOTES:

Plan dimensions and details relative to the existing roadway and structure have been taken from existing plans and are subject to nominal construction variations. It shall be the contractor's responsibility to verify such dimensions and details in the field and to make necessary approved adjustments prior to construction or ordering of materials. Such variations shall not be cause for additional compensation for a change in the scope of the work, however, the contractor will be paid for the quantity actually furnished at the unit price bid for the work.

The contractor shall be responsible for protecting utility property from construction operations as outlined in Article 107.31 of the Standard Specifications. The "Julie" Number is 1-800-892-0123. A minimum of forty-eight (48) hours advance notice is required.

The cost of any saw cuts made to complete the work as described in plan details, unless otherwise noted shall not be paid for separately but shall be included in the various pay items involved.

The contractor is advised to the presence of utilities attached to structure within the project limits. Care shall be taken during deck slab repair operations so that the existing utilities are not damaged. If the utilities are damaged due to the Contractor's operations, they shall be repaired or replaced at the Contractor's expense.

For stabilization, all Type II barricades shall require a minimum of two sand bags per barricade. For stabilization, all Type III barricades shall require a minimum of four sand bags per barricade.

Where section or subsection monuments are encountered, the engineer shall be notified before such monuments are removed. The contractor shall protect and carefully preserve all monuments until an authorized surveyor or agent has witnessed or otherwise referenced their location. The contractor shall be responsible for having an authorized surveyor reestablish any section or subsection monuments destroyed by his operations.

All elevations referring to U.S.G.S. mean sea level datum.

Any reference to a standard in these plans shall be interpreted to mean the edition as indicated by the subnumber listed on the Index of sheets or the copy of the standard included in these plans.

New Reinforcement bars shall be Epoxy Coated.

Reinforcement bars that are to remain in place which are damaged during concrete removal operations shall be repaired or replaced using approved bar splicer or anchorage system. Cost included with "Concrete Removal".

Reinforcement bars shall conform to the requirements of AASHTO M 31 or M322 Grade 60.

DATE: May 18, 2005

PREPARED BY: *Bruce A. Husker*  
DISTRICT OPERATIONS ENGINEER

EXAMINED BY: *Hubert B. [Signature]*  
DISTRICT CONSTRUCTION ENGINEER

*Steven B. [Signature]*  
**ACTING** DISTRICT STUDIES & PLANS ENGINEER

*Kenneth L. [Signature]*  
DISTRICT MATERIALS ENGINEER

REVISIONS	
NAME	DATE

ILLINOIS DEPARTMENT OF TRANSPORTATION  
**GENERAL NOTES**  
FAI ROUTE 57 SEC. (139HB, HF-1)I  
KANKAKEE COUNTY  
STA. 230 + 53.99

DRAWN BY R.L.W.  
CHECKED BY  
DATE 04/12/05

DATE: 04/12/05  
FILE NAME: c:/projects/cmain06/cm305/details.dgn

F.A.I. RTE.	SECTION	COUNTY	TOTAL SHEETS	SHEET NO.
57	(139-HB-1, HF-1)I	KANKAKEE	6	3
STA. 18+41.66		TO STA. 20+76.14		

## SUMMARY OF QUANTITIES

CONSTRUCTION CODE TYPE: **SFTY-2A**

**URBAN**  
100% STATE  
TOTAL  
QUANTITY

CODE NO.	ITEM	UNIT	URBAN 100% STATE TOTAL QUANTITY
51000305	PIPE HANDRAIL (SPECIAL)	FOOT	24
67100100	MOBILIZATION	L SUM	1
70100100	TRAFFIC CONTROL AND PROTECTION, STANDARD 701316	EACH	1
70100305	TRAFFIC CONTROL AND PROTECTION, STANDARD 701400	L SUM	1
70100700	TRAFFIC CONTROL AND PROTECTION, STANDARD 701406	L SUM	1
70103815	TRAFFIC CONTROL SURVEILLANCE	CAL DA	30
70106500	TEMPORARY BRIDGE TRAFFIC SIGNALS	EACH	1
X0322066	PROTECTIVE SHIELD (PERMANENT)	SQ YD	391
Z0016000	DECK SLAB REPAIR (FULL DEPTH)	<del>SQ</del> YD	30
Z0016200	DECK SLAB REPAIR (PARTIAL)	SQ YD	234

DATE: 04/12/05  
FILE NAME: c:/projects/cmain06/cm305/details.dgn

REVISIONS	
NAME	DATE

ILLINOIS DEPARTMENT OF TRANSPORTATION  
**SUMMARY OF QUANTITIES**  
FAI ROUTE 57 SEC. (139HB, HF-1)I  
KANKAKEE COUNTY  
STA. 230 + 53.99

DRAWN BY RLW  
CHECKED BY  
DATE 04/12/05

F.A.I. RTE.	SECTION	COUNTY	TOTAL SHEETS	SHEET NO.
57	(139-HB-1, HF-1)	KANKAKEE	6	4
STA. 18+41.66		TO STA. 20+76.14		

DECK SLAB REPAIR SCHEDULE														
WESTBOUND LANE														
LOCATION						DIMENSIONS				SQ YDS				
DECK LENGTH			DECK WIDTH			DECK LENGTH		DECK WIDTH						
10	FT	TO	15	FT	1	FT	TO	4	FT	5.0	FT	3.0	FT	1.7
16	FT	TO	19	FT	1	FT	TO	4	FT	3.0	FT	3.0	FT	1.0
22	FT	TO	25	FT	1	FT	TO	6	FT	3.0	FT	5.0	FT	1.7
29	FT	TO	32	FT	1	FT	TO	6	FT	3.0	FT	5.0	FT	1.7
29	FT	TO	31	FT	7	FT	TO	13	FT	2.0	FT	6.0	FT	1.3
34	FT	TO	36	FT	8	FT	TO	13	FT	2.0	FT	5.0	FT	1.1
36	FT	TO	38	FT	1	FT	TO	6	FT	2.0	FT	5.0	FT	1.1
37	FT	TO	41	FT	9	FT	TO	13	FT	4.0	FT	4.0	FT	1.8
39	FT	TO	41	FT	0	FT	TO	6	FT	2.0	FT	6.0	FT	1.3
41	FT	TO	43	FT	1	FT	TO	13	FT	2.0	FT	12.0	FT	2.7
43	FT	TO	45	FT	1	FT	TO	7	FT	2.0	FT	6.0	FT	1.3
45	FT	TO	47	FT	1	FT	TO	7	FT	2.0	FT	6.0	FT	1.3
47	FT	TO	52	FT	1	FT	TO	13	FT	5.0	FT	12.0	FT	6.7
53	FT	TO	95	FT	1	FT	TO	7	FT	42.0	FT	6.0	FT	28.0
59	FT	TO	63	FT	9	FT	TO	13	FT	4.0	FT	4.0	FT	1.8
86	FT	TO	88	FT	7	FT	TO	13	FT	2.0	FT	6.0	FT	1.3
102	FT	TO	105	FT	1	FT	TO	13	FT	3.0	FT	12.0	FT	4.0
138	FT	TO	140	FT	0	FT	TO	5	FT	2.0	FT	5.0	FT	1.1
140	FT	TO	143	FT	0	FT	TO	5	FT	3.0	FT	5.0	FT	1.7
147	FT	TO	149	FT	1	FT	TO	13	FT	2.0	FT	12.0	FT	2.7
150	FT	TO	152	FT	1	FT	TO	13	FT	2.0	FT	12.0	FT	2.7
152	FT	TO	155	FT	1	FT	TO	5	FT	3.0	FT	4.0	FT	1.3
157	FT	TO	159	FT	0	FT	TO	7	FT	2.0	FT	7.0	FT	1.6
158	FT	TO	160	FT	7	FT	TO	13	FT	2.0	FT	6.0	FT	1.3
161	FT	TO	162	FT	1	FT	TO	10	FT	1.0	FT	9.0	FT	1.0
162	FT	TO	164	FT	1	FT	TO	7	FT	2.0	FT	6.0	FT	1.3
164	FT	TO	169	FT	1	FT	TO	13	FT	5.0	FT	12.0	FT	6.7
177	FT	TO	179	FT	0	FT	TO	7	FT	2.0	FT	7.0	FT	1.6
179	FT	TO	181	FT	8	FT	TO	13	FT	2.0	FT	5.0	FT	1.1
182	FT	TO	183	FT	3	FT	TO	12	FT	1.0	FT	9.0	FT	1.0
187	FT	TO	189	FT	0	FT	TO	6	FT	2.0	FT	6.0	FT	1.3
191	FT	TO	195	FT	2	FT	TO	6	FT	4.0	FT	4.0	FT	1.8
197	FT	TO	215	FT	0	FT	TO	6	FT	18.0	FT	6.0	FT	12.0
205	FT	TO	207	FT	7	FT	TO	13	FT	2.0	FT	6.0	FT	1.3
210	FT	TO	212	FT	7	FT	TO	13	FT	2.0	FT	6.0	FT	1.3
218	FT	TO	222	FT	0	FT	TO	7	FT	4.0	FT	7.0	FT	3.1
223	FT	TO	224	FT	0	FT	TO	13	FT	1.0	FT	13.0	FT	1.4
224	FT	TO	226	FT	0	FT	TO	7	FT	2.0	FT	7.0	FT	1.6
229	FT	TO	231	FT	0	FT	TO	13	FT	2.0	FT	13.0	FT	2.9
TOTAL WESTBOUND LANE											112			

DECK SLAB REPAIR SCHEDULE														
EASTBOUND LANE														
LOCATION						DIMENSIONS				SQ YDS				
DECK LENGTH			DECK WIDTH			DECK LENGTH		DECK WIDTH						
33	FT	TO	37	FT	9	FT	TO	13	FT	4.0	FT	4.0	FT	1.8
38	FT	TO	40	FT	1	FT	TO	6	FT	2.0	FT	5.0	FT	1.1
41	FT	TO	43	FT	5	FT	TO	13	FT	2.0	FT	8.0	FT	1.8
43	FT	TO	53	FT	11	FT	TO	13	FT	10.0	FT	2.0	FT	2.2
43	FT	TO	53	FT	0	FT	TO	10	FT	10.0	FT	10.0	FT	11.1
58	FT	TO	60	FT	3	FT	TO	13	FT	2.0	FT	10.0	FT	2.2
71	FT	TO	78	FT	1	FT	TO	6	FT	7.0	FT	5.0	FT	3.9
78	FT	TO	85	FT	3	FT	TO	5	FT	7.0	FT	2.0	FT	1.6
94	FT	TO	97	FT	1	FT	TO	4	FT	3.0	FT	3.0	FT	1.0
102	FT	TO	104	FT	1	FT	TO	13	FT	2.0	FT	12.0	FT	2.7
112	FT	TO	114	FT	1	FT	TO	13	FT	2.0	FT	12.0	FT	2.7
109	FT	TO	121	FT	6	FT	TO	13	FT	12.0	FT	7.0	FT	9.3
127	FT	TO	129	FT	0	FT	TO	13	FT	2.0	FT	13.0	FT	2.9
129	FT	TO	132	FT	0	FT	TO	5	FT	3.0	FT	5.0	FT	1.7
132	FT	TO	136	FT	0	FT	TO	3	FT	4.0	FT	3.0	FT	1.3
150	FT	TO	152	FT	0	FT	TO	13	FT	2.0	FT	13.0	FT	2.9
152	FT	TO	155	FT	0	FT	TO	9	FT	3.0	FT	9.0	FT	3.0
157	FT	TO	161	FT	0	FT	TO	11	FT	4.0	FT	11.0	FT	4.9
162	FT	TO	164	FT	0	FT	TO	7	FT	2.0	FT	7.0	FT	1.6
164	FT	TO	166	FT	3	FT	TO	13	FT	2.0	FT	10.0	FT	2.2
166	FT	TO	168	FT	0	FT	TO	13	FT	2.0	FT	13.0	FT	2.9
170	FT	TO	171	FT	0	FT	TO	13	FT	1.0	FT	13.0	FT	1.4
174	FT	TO	175	FT	0	FT	TO	13	FT	1.0	FT	13.0	FT	1.4
179	FT	TO	181	FT	0	FT	TO	13	FT	2.0	FT	13.0	FT	2.9
185	FT	TO	187	FT	0	FT	TO	8	FT	2.0	FT	8.0	FT	1.8
187	FT	TO	191	FT	3	FT	TO	8	FT	4.0	FT	5.0	FT	2.2
205	FT	TO	207	FT	3	FT	TO	13	FT	2.0	FT	10.0	FT	2.2
207	FT	TO	210	FT	7	FT	TO	13	FT	3.0	FT	6.0	FT	2.0
212	FT	TO	218	FT	1	FT	TO	13	FT	6.0	FT	12.0	FT	8.0
218	FT	TO	222	FT	3	FT	TO	13	FT	4.0	FT	10.0	FT	4.4
222	FT	TO	226	FT	1	FT	TO	13	FT	4.0	FT	12.0	FT	5.3
226	FT	TO	232	FT	9	FT	TO	13	FT	6.0	FT	4.0	FT	2.7
226	FT	TO	232	FT	1	FT	TO	8	FT	6.0	FT	7.0	FT	4.7
231	FT	TO	237	FT	0	FT	TO	4	FT	6.0	FT	4.0	FT	2.7
237	FT	TO	239	FT	0	FT	TO	5	FT	2.0	FT	5.0	FT	1.1
241	FT	TO	243	FT	0	FT	TO	5	FT	2.0	FT	5.0	FT	1.1
243	FT	TO	245	FT	0	FT	TO	13	FT	2.0	FT	13.0	FT	2.9
245	FT	TO	247	FT	0	FT	TO	9	FT	2.0	FT	9.0	FT	2.0
247	FT	TO	251	FT	0	FT	TO	7	FT	4.0	FT	7.0	FT	3.1
251	FT	TO	254	FT	0	FT	TO	8	FT	3.0	FT	8.0	FT	2.7
254	FT	TO	258	FT	1	FT	TO	7	FT	4.0	FT	6.0	FT	2.7
TOTAL EASTBOUND LANE											122			

DATE: 04/12/05  
FILE NAME: c:/projects/cmain06/cm305/details.dgn

REVISIONS	
NAME	DATE

ILLINOIS DEPARTMENT OF TRANSPORTATION  
**SCHEDULES**  
FAI ROUTE 57 SEC. (139HB, HF-1)  
KANKAKEE COUNTY  
STA. 230 + 53.99  
DATE 04/12/05  
DRAWN BY RLW  
CHECKED BY



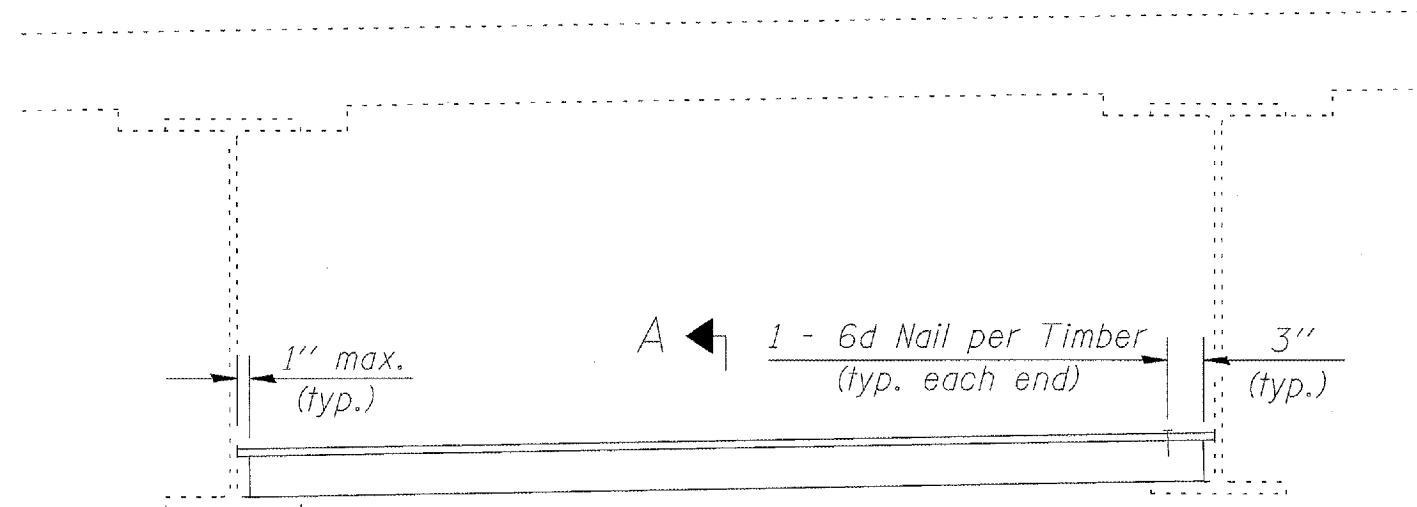

Notes:

Plywood shall be placed such that the face grain is perpendicular to the timber supports.  
When less than a full sheet (4' width) of plywood is used, the width of the strip used shall not be less than 2'.  
Transverse plywood joints shall be supported by timbers.

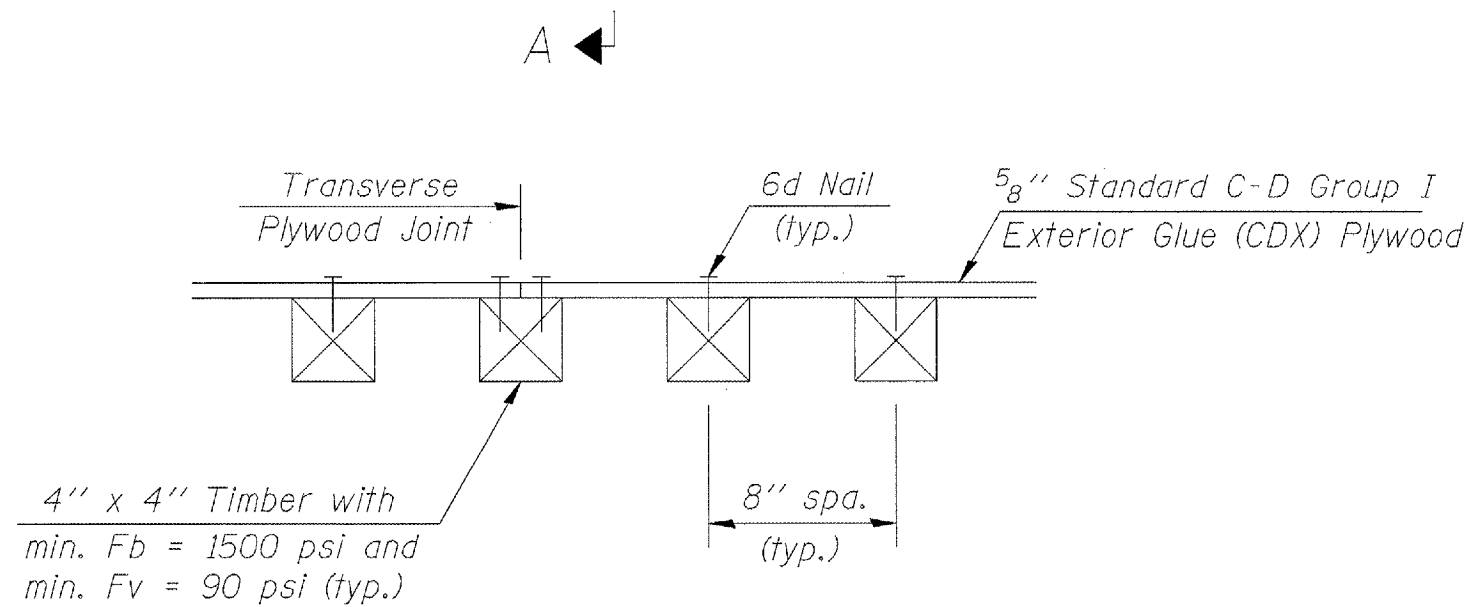

SECTION A-A

PERMANENT PROTECTIVE  
SHIELD DETAILS

F.A.I. RTE.	SECTION	COUNTY	TOTAL SHEETS	SHEET NO.
57	(139-HB-1, HF-1)I	KANKAKEE	6	6
STA. 18+41.66 TO STA. 20+76.14				

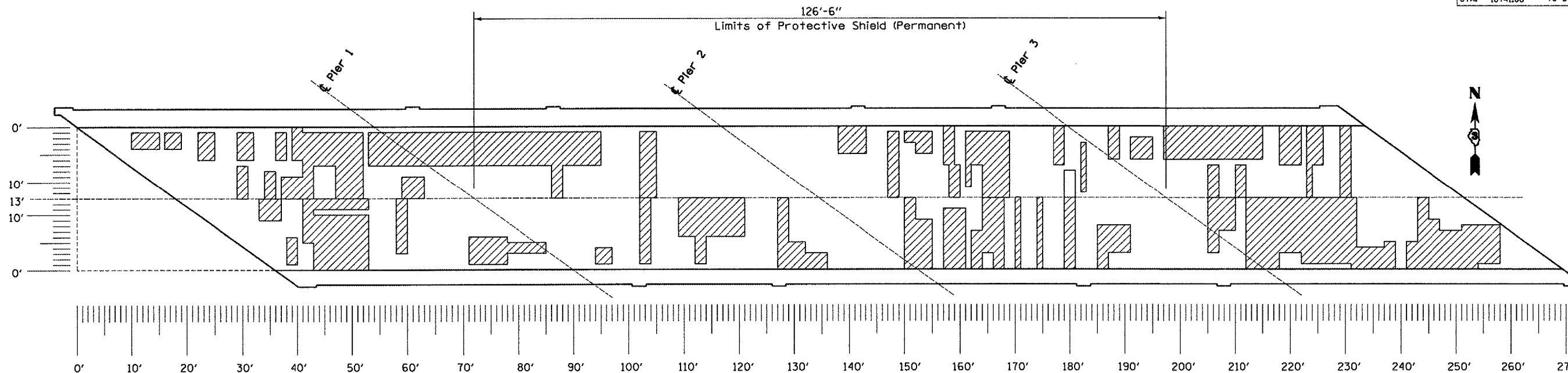

**PLAN**  
**S.N. 046-0080**

**NOTES:**

Hatched areas represent Deck Slab Repair (Partial Depth)

Deck lengths are measured from the inside curb face at the northwest corner of the deck for both lanes of traffic.

Deck widths are measured from the face of curb to centerline of roadway.

The Engineer shall record the actual locations of the deck repair on the "As-Built" plans.

Date of Deck Survey: 04/20/05

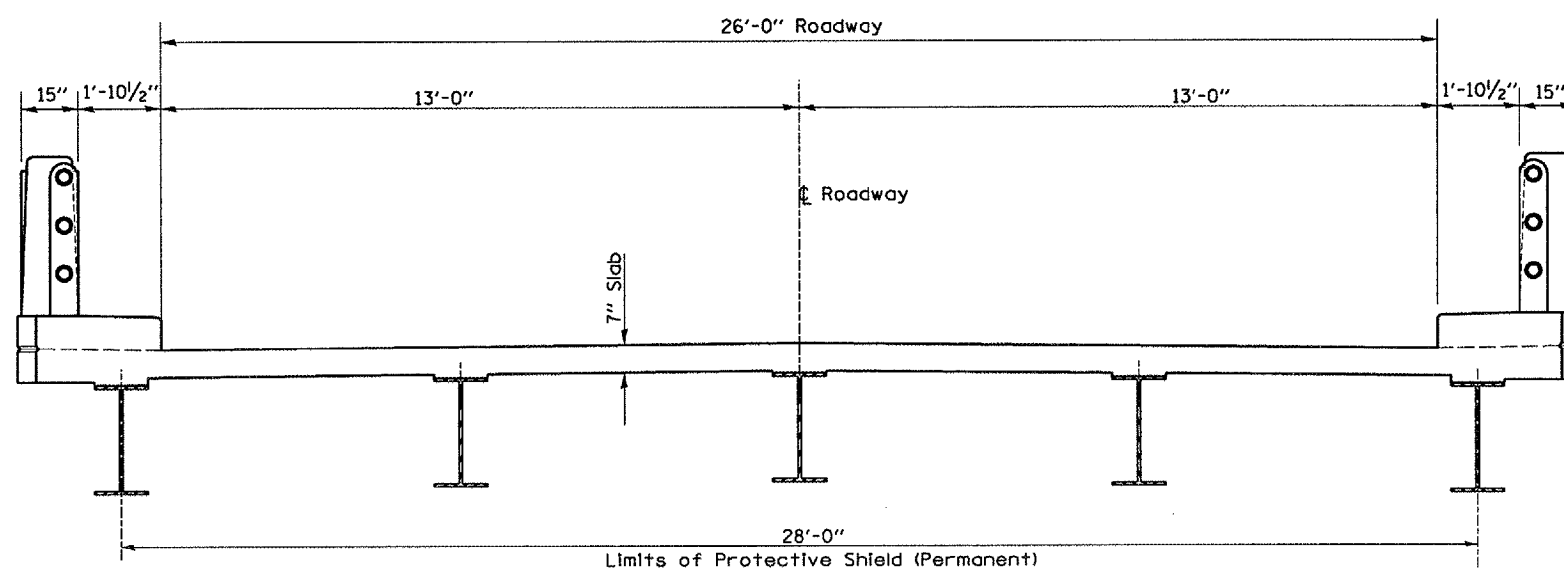

**CROSS SECTION**  
**Looking East**

REVISIONS	
NAME	DATE

ILLINOIS DEPARTMENT OF TRANSPORTATION  
**DECK SLAB REPAIR SURVEY**  
FAI ROUTE 57 SEC. (139HB, HF-1)I  
KANKAKEE COUNTY  
STA. 230 + 53.99

DATE 04/12/05  
DRAWN BY RLW  
CHECKED BY

DATE: 04/12/05  
FILE NAME: c:\projects\cmain06\cm305\details.dgn