

FOR INDEX OF SHEETS AND HIGHWAY
STANDARDS, SEE SHEET 2.

STATE OF ILLINOIS
DEPARTMENT OF TRANSPORTATION
DIVISION OF HIGHWAYS

**PLANS FOR PROPOSED
CONTRACT MAINTENANCE
FAU ROUTE 8041 (DIRKSEN PKWY)
SECTION 28RS-7
SANGAMON COUNTY
C96-027-05 / D96-014-05**

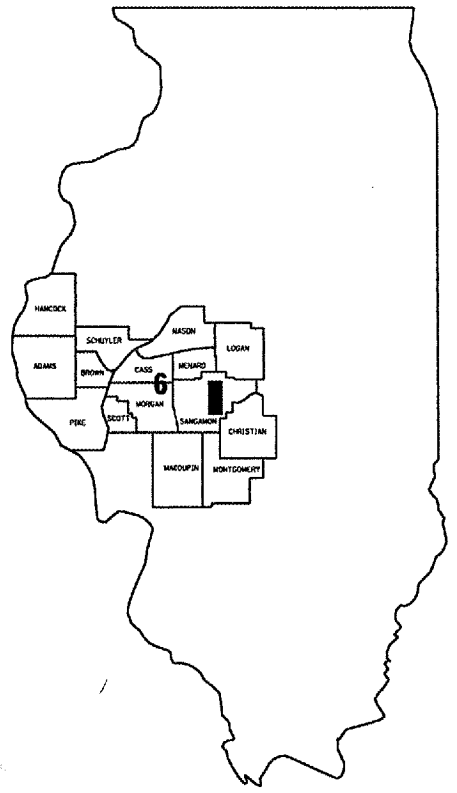

LOCATION OF SECTION INDICATED THUS: ■

STA. 513 + 53.39
END PROJECT

STA. 467 + 45.39
BEGIN PROJECT

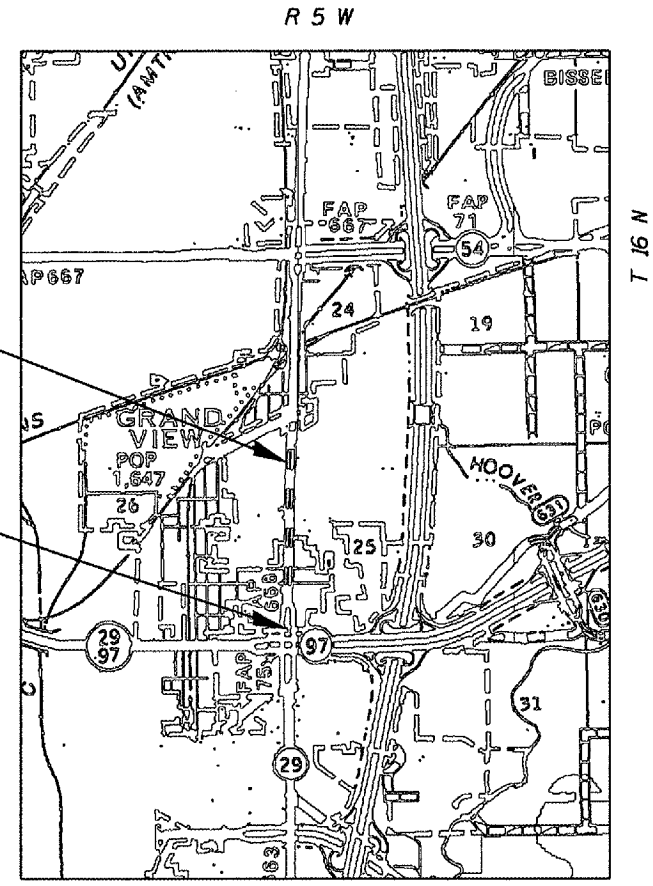

J. U. L. I. E.
JOINT UTILITY LOCATION INFORMATION FOR EXCAVATION
1-800-892-0123

DESIGN & PLANNING ENGINEER: CECIL DOWNING
PLANS & CONTRACT TECHNICIAN: TIMOTHY SHARP
PHONE: (217) 782-7743

NET LTH OF SEC: 4,608 FT = 0.873 mile

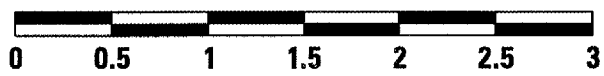

SCALE: 1" = 1 MILES

STATE OF ILLINOIS
DEPARTMENT OF TRANSPORTATION
DIVISION OF HIGHWAYS

SUBMITTED May 11, 20 05
Christ H. Reed
DEPUTY DIRECTOR OF HIGHWAYS, REGION ENGINEER

July 1, 20 05
Mike Fine / (P)
ENGINEER OF DESIGN AND ENVIRONMENT

July 1, 20 05
Victor Mader / (P)
DIRECTOR OF HIGHWAYS, CHIEF ENGINEER

CONTRACT NO. 72988

INDEX

1	COVER
2	INDEX/STANDARDS/SIGNATURES
3-4	QUANTITIES
5-6	TYPICAL SECTIONS
7	SCHEDULES
8-15	PLAN SHEET
16-27	PAVEMENT MARKING
28	BUTT JOINT DETAILS

STANDARDS

- 701502-01
- 701602-02
- 701606-04
- 702001-05
- 780001-01
- 781001-02

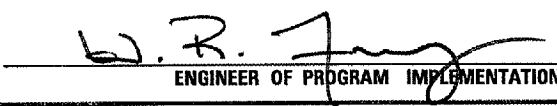
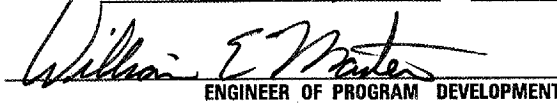
STATE OF ILLINOIS DEPARTMENT OF TRANSPORTATION DIVISION OF HIGHWAYS DISTRICT 6		
EXAMINED	May 10	20 05
 ENGINEER OF OPERATIONS		
EXAMINED	April 7	20 05
 ENGINEER OF PROGRAM IMPLEMENTATION		
EXAMINED	April 21	20 05
 ENGINEER OF PROGRAM DEVELOPMENT		

INDEX/STANDARDS/SIGNATURES
FAU 8041 (DIRKSEN PKWY)
SECTION 28RS-7
SANGAMON COUNTY

S U M M A R Y O F Q U A N T I T I E S

URBAN

CODE NO.	ITEM	UNIT	100% STATE
			1000
			TOTAL QTY
40600200	BITUMINOUS MATERIALS (PRIME COAT)	TON	10.0
40600300	AGGREGATE (PRIME COAT)	TON	52.8
40600895	CONSTRUCTING TEST STRIP	EACH	1
40600990	TEMPORARY RAMP	SQ YD	58
44000006	BITUMINOUS SURFACE REMOVAL 1 1/2"	SQ YD	26,417
67100100	MOBILIZATION	L SUM	1
70102622	TRAFFIC CONTROL AND PROTECTION, STANDARD 701502	L SUM	1
70102625	TRAFFIC CONTROL AND PROTECTION, STANDARD 701606	L SUM	1
70102632	TRAFFIC CONTROL AND PROTECTION, STANDARD 701602	L SUM	1
70300100	SHORT-TERM PAVEMENT MARKING	FOOT	1,079
70300210	TEMPORARY PAVEMENT MARKING - LETTERS AND SYMBOLS	SQ FT	702
70300230	TEMPORARY PAVEMENT MARKING - LINE 5"	FOOT	20,647
70300240	TEMPORARY PAVEMENT MARKING - LINE 6"	FOOT	707
70300260	TEMPORARY PAVEMENT MARKING - LINE 12"	FOOT	340

QUANTITIES
FAU 8041 (DIRKSEN PKWY)
SECTION 28RS-7
SANGAMON COUNTY

S U M M A R Y O F Q U A N T I T I E S

CODE NO.	ITEM	UNIT	URBAN
			100% STATE
			1000
			TOTAL QTY
70301000	WORK ZONE PAVEMENT MARKING REMOVAL	SQ FT	360
* 78000300	THERMOPLASTIC PAVEMENT MARKING - LINE 5"	FOOT	20,328
* 78000600	THERMOPLASTIC PAVEMENT MARKING - LINE 12"	FOOT	360
78003100	PREFORMED PLASTIC PAVEMENT MAKING, TYPE B - LETTERS AND SYMBOLS	SQ FT	702
78003120	PREFORMED PLASTIC PAVEMENT MARKING, TYPE B - LINE 5"	FOOT	319
78003130	PREFORMED PLASTIC PAVEMENT MARKING, TYPE B - LINE 6"	FOOT	707
* 78100100	RAISED REFLECTIVE PAVEMENT MARKER	EACH	256
78300200	RAISED REFLECTIVE PAVEMENT MARKER REMOVAL	EACH	282
X4066528	POLYMERIZED BITUMINOUS CONCRETE SURFACE COURSE, SUPERPAVE, MIX D, N90	TON	2,378

* SPECIALTY ITEMS

QUANTITIES
FAU 8041 (DIRKSEN PKWY)
SECTION 28RS-7
SANGAMON COUNTY

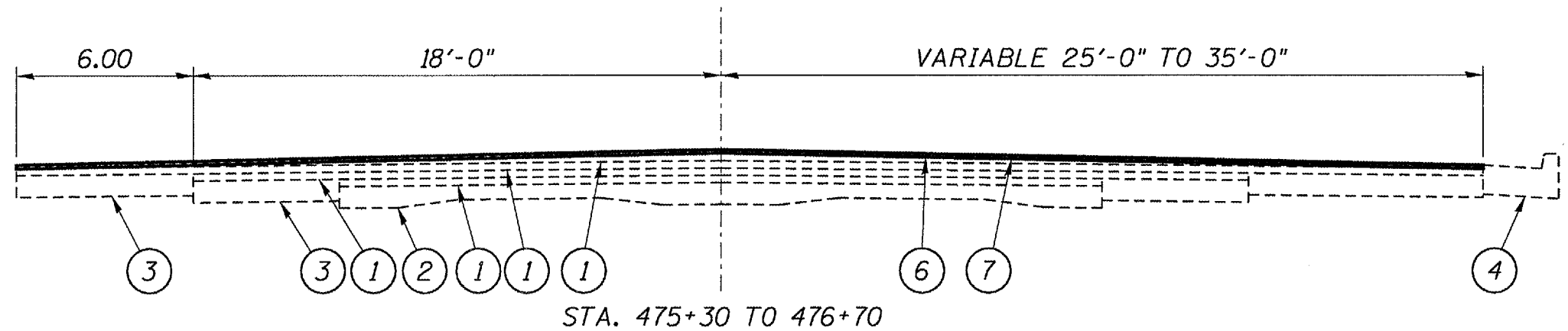
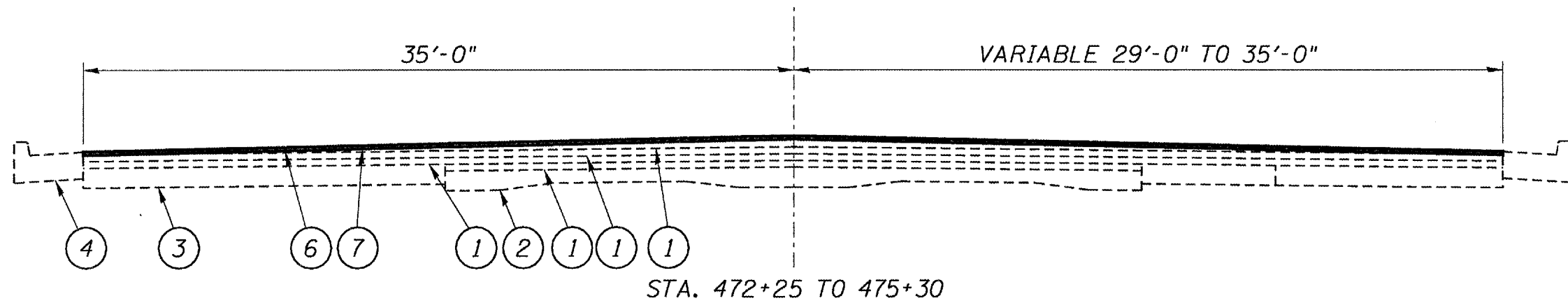
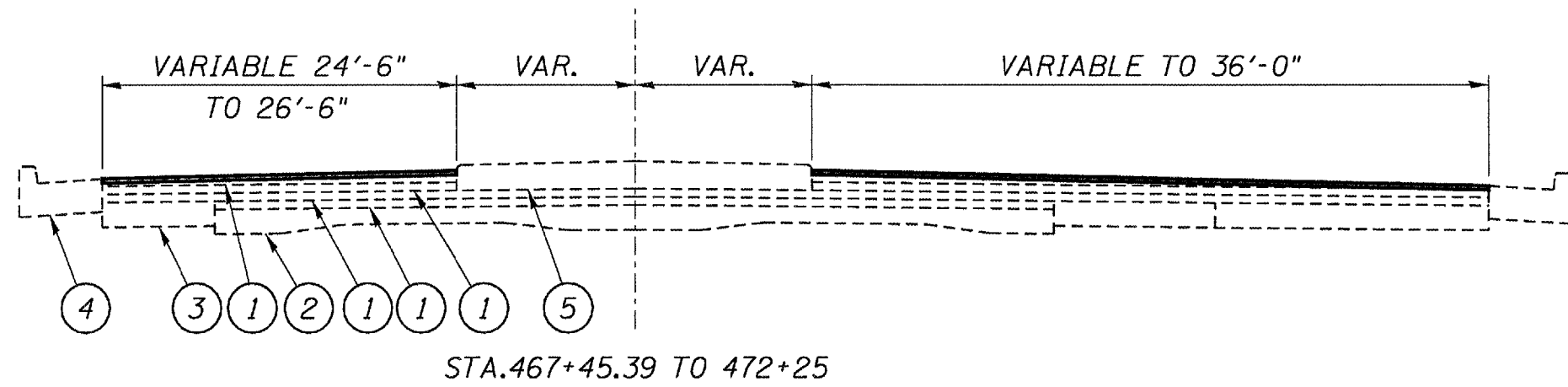

LEGEND

- 1 - EXIST. BITUMINOUS SURFACE COURSE VARIABLE DEPTH
- 2 - EXIST. 9-7-9-7-9 P.C.C. PAVEMENT
- 3 - EXIST. P.C.C. BASE COURSE 9"
- 4 - EXIST. CONCRETE CURB AND GUTTER TYPE B-6-24
- 5 - EXIST. CONCRETE MEDIAN
- 6 - PROP. BITUMINOUS SURFACE REMOVAL 1 1/2"
- 7 - PROP. POLYMERIZED BITUMINOUS CONCRETE SURFACE COURSE, SUPERPAVE, MIX D, N90 1 1/2"

TYPICAL
 FAU 8041 (DIRKSEN PKWY)
 SECTION 28RS-7
 SANGAMON COUNTY

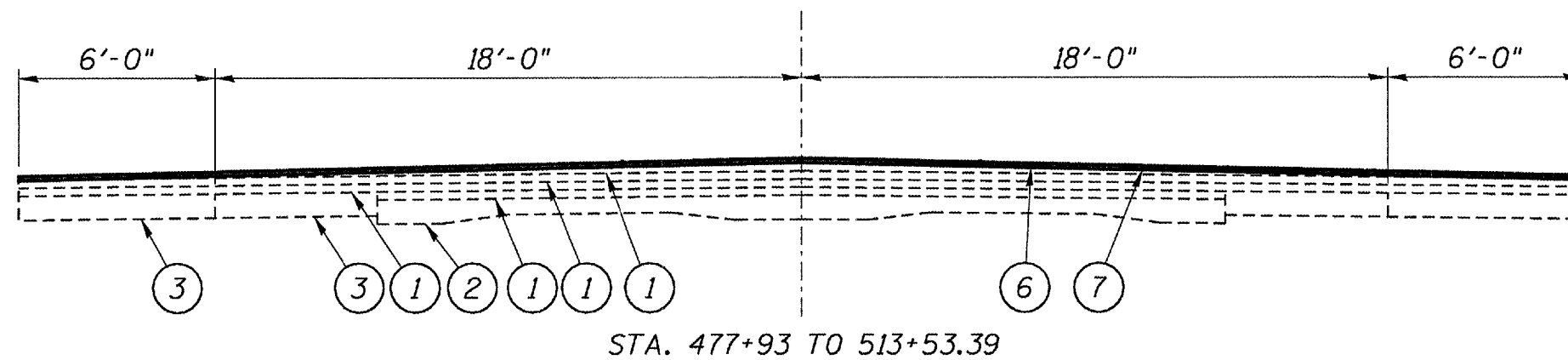
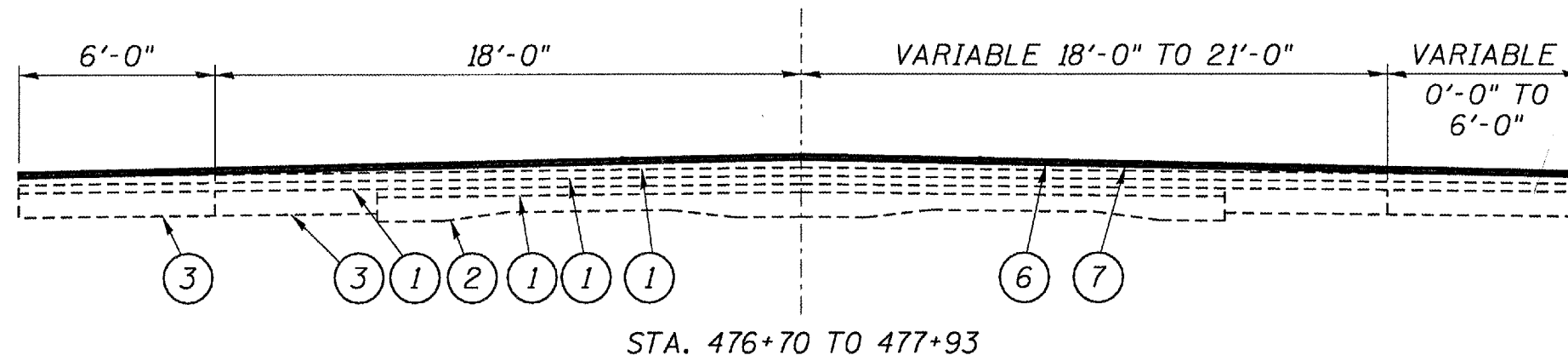

LEGEND

- 1 - EXIST. BITUMINOUS SURFACE COURSE VARIABLE DEPTH
- 2 - EXIST. 9-7-9-7-9 P.C.C. PAVEMENT
- 3 - EXIST. P.C.C. BASE COURSE 9"
- 4 - EXIST. CONCRETE CURB AND GUTTER TYPE B-6-24
- 5 - EXIST. CONCRETE MEDIAN
- 6 - PROP. BITUMINOUS SURFACE REMOVAL 1 1/2"
- 7 - PROP. POLYMERIZED BITUMINOUS CONCRETE SURFACE COURSE, SUPERPAVE, MIX D, N90 1 1/2"

TYPICAL
FAU 8041 (DIRKSEN PKWY)
SECTION 28RS-7
SANGAMON COUNTY

PAVEMENT MARKING SCHEDULE							
STATION	TYPE	THERMOPLASTIC PAVEMENT MARKING - LINE 5"		THERMOPLASTIC PAVEMENT MARKING LINE 12" - YELLOW	PREFORMED PLASTIC PAV'T MARKING LETTERS & SYMBOLS	PREFORMED PLASTIC PAV'T MARKING LINE 5" - WHITE	PREFORMED PLASTIC PAV'T MARKING LINE 6" - WHITE
		WHITE	YELLOW				
STA. 467+45.39 TO 513+53.39	EDGE LINE	8,764 FT					
STA. 467+45.39 TO 513+53.39	SKIP-DASH		1,290 FT				
STA. 467+45.39 TO 513+53.39	MEDIAN LINE		3,771 FT				
STA. 467+45.39 TO 513+53.39	BI-DIRECTIONAL TURN LANE		5,161 FT				
STA. 467+45.39 TO 513+53.39	TURN LANE		1,342 FT				
STA. 467+45.39 TO 513+53.39	GORE LINE			188 FT			
STA. 467+45.39 TO 513+53.39	TURN ARROW				702 SQ FT		
STA. 467+45.39 TO 513+53.39	SKIP-DASH					319 FT	
STA. 467+45.39 TO 513+53.39	TURN LANE						707 FT
TOTALS		8,764 FT	11,564 FT	188 FT	702 SQ FT	319 FT	707 FT

NOTES:

1. STATIONS ARE APPROXIMATE.
2. SEE SHEETS 16-27 FOR PAVEMENT MARKING LOCATIONS.

MIXTURE REQUIREMENTS	
THE FOLLOWING MIXTURE REQUIREMENTS ARE APPLICABLE FOR THIS PROJECT	
MIXTURE USE(S):	POLYMERIZED BIT.CONC. SURF. CRSE., SUPER, MIX "D", N90
AC/PG	SBS PG 70-22
RAP %: (MAX)	0%
DESIGN AIR VOIDS:	4.0% @ N DESIGN = 90
MIXTURE COMP:	IL 9.5 OR 12.5
FRICITION AGG:	MIX "D"

SCHEDULES
FAU 8041 (DIRKSEN PKWY)
SECTION 28RS-7
SANGAMON COUNTY

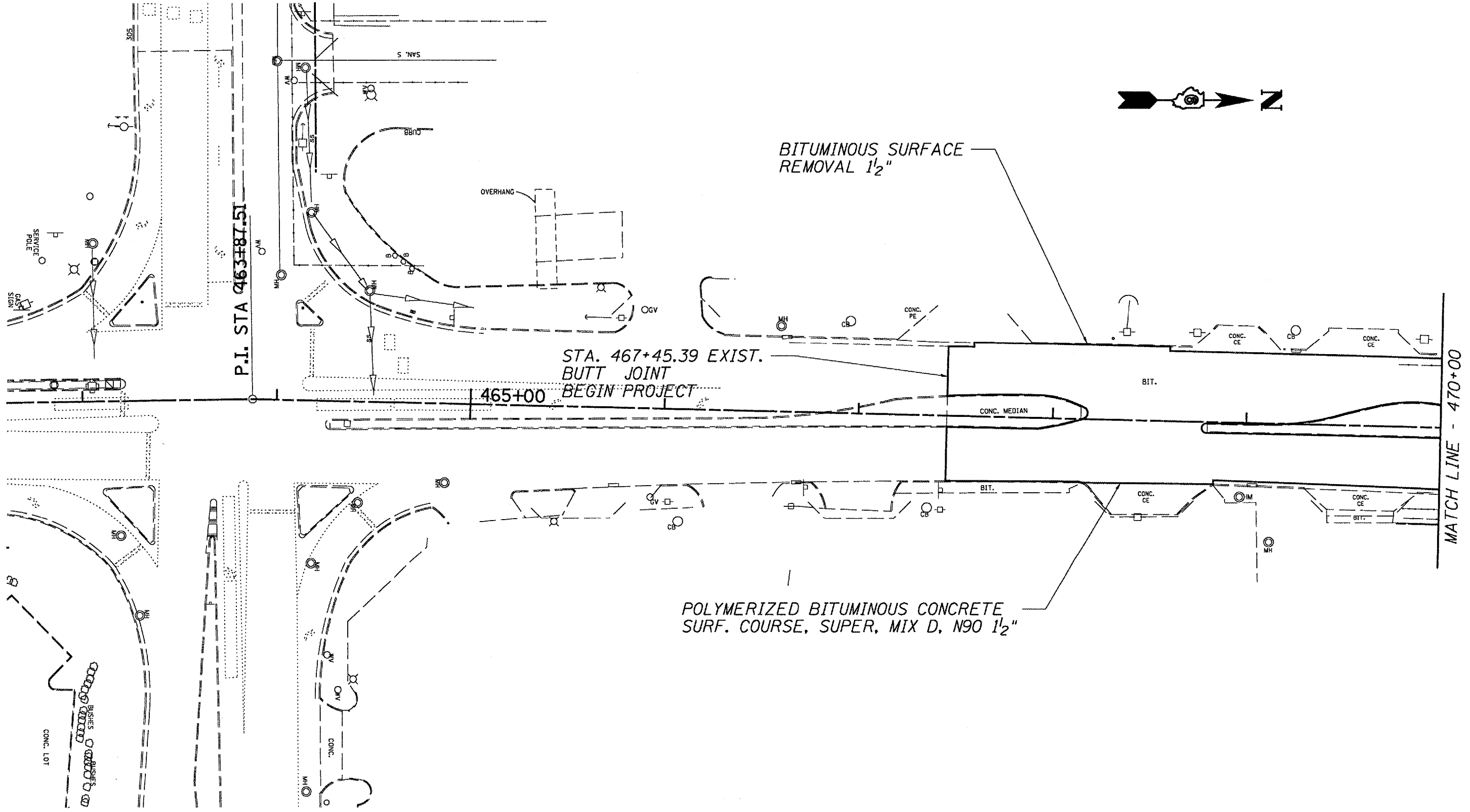

POLYMERIZED BITUMINOUS CONCRETE
SURF. COURSE, SUPER, MIX D, N90 1/2"

BITUMINOUS SURFACE
REMOVAL 1/2"

STA. 467+45.39 EXIST.
BUTT JOINT
BEGIN PROJECT

P.I. STA 463+87.51

MATCH LINE - 470+00

PLAN
FAU 8041 (DIRKSEN PKWY)
SECTION 28RS-7
SANGAMON COUNTY

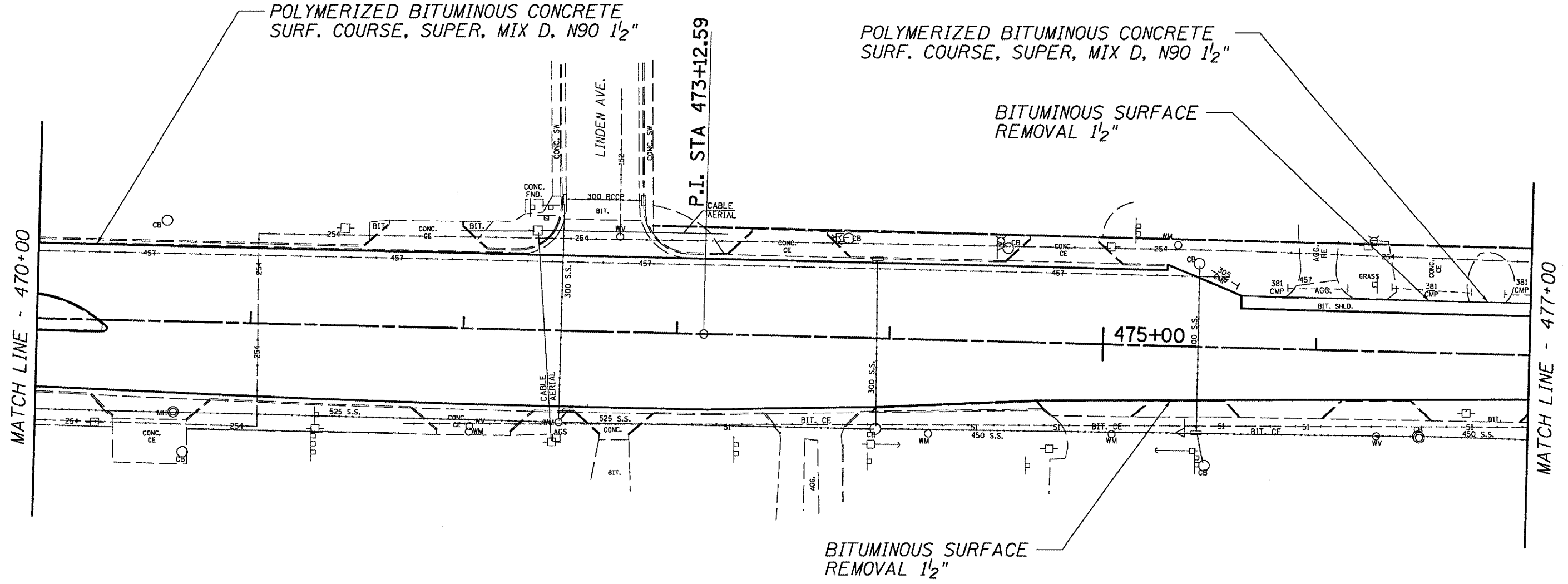

PLAN
FAU 8041 (DIRKSEN PKWY)
SECTION 28RS-7
SANGAMON COUNTY

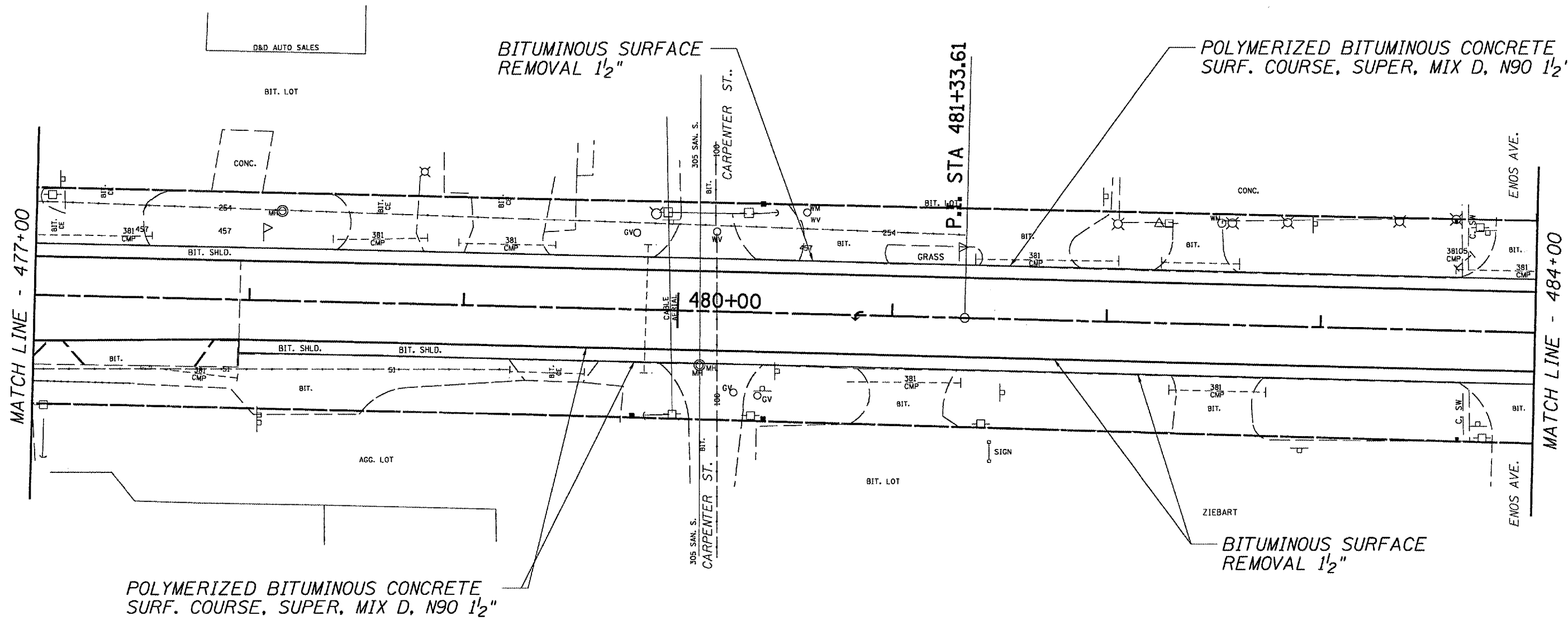

PLAN
FAU 8041 (DIRKSEN PKWY)
SECTION 28RS-7
SANGAMON COUNTY

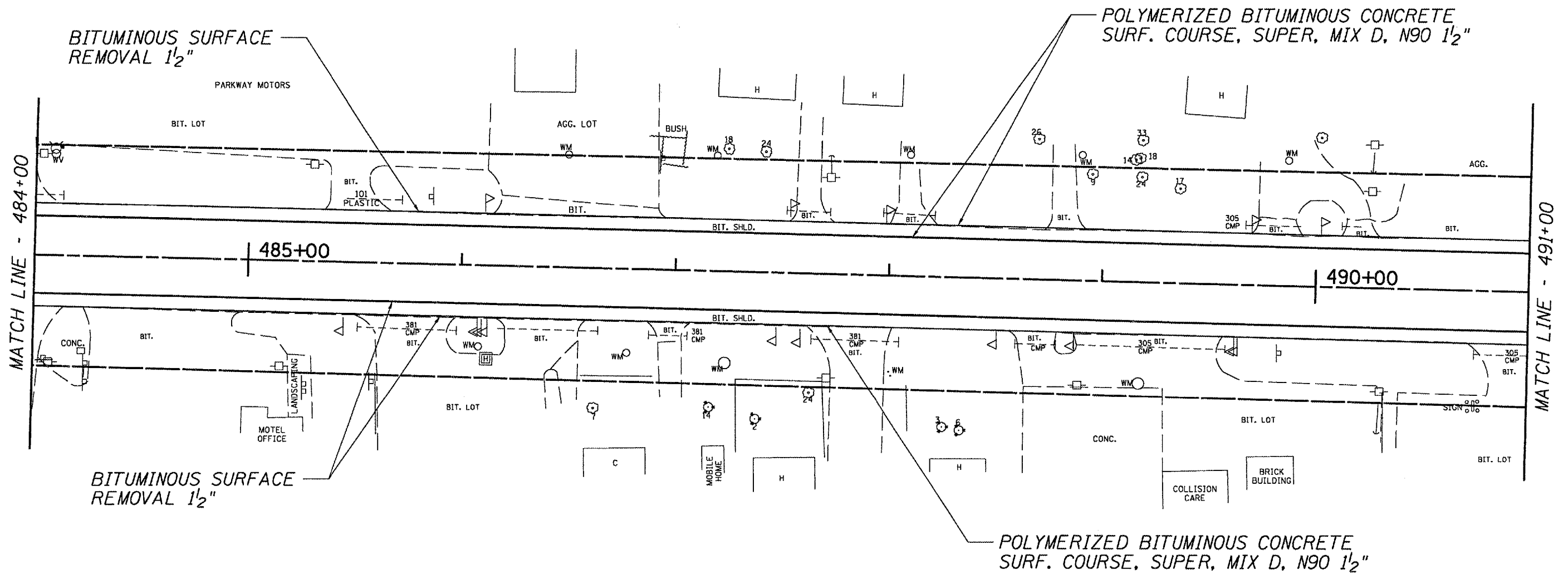

PLAN
FAU 8041 (DIRKSEN PKWY)
SECTION 28RS-7
SANGAMON COUNTY

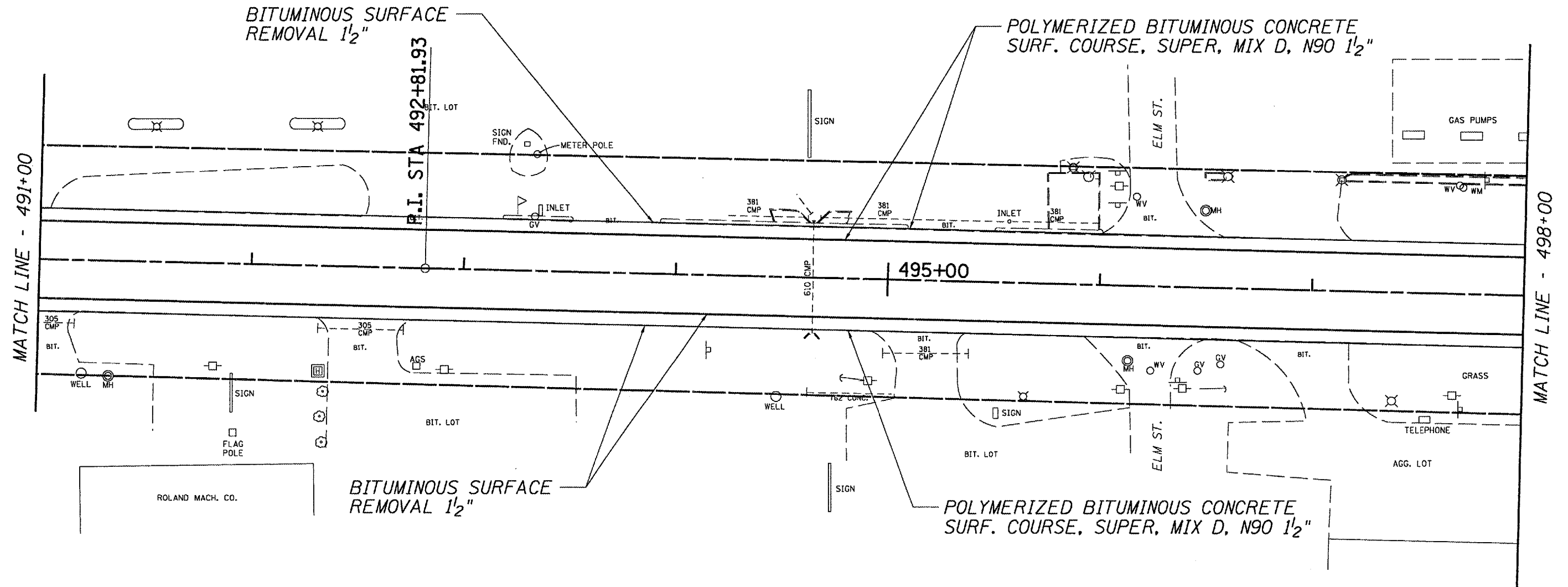

PLAN
FAU 8041 (DIRKSEN PKWY)
SECTION 28RS-7
SANGAMON COUNTY

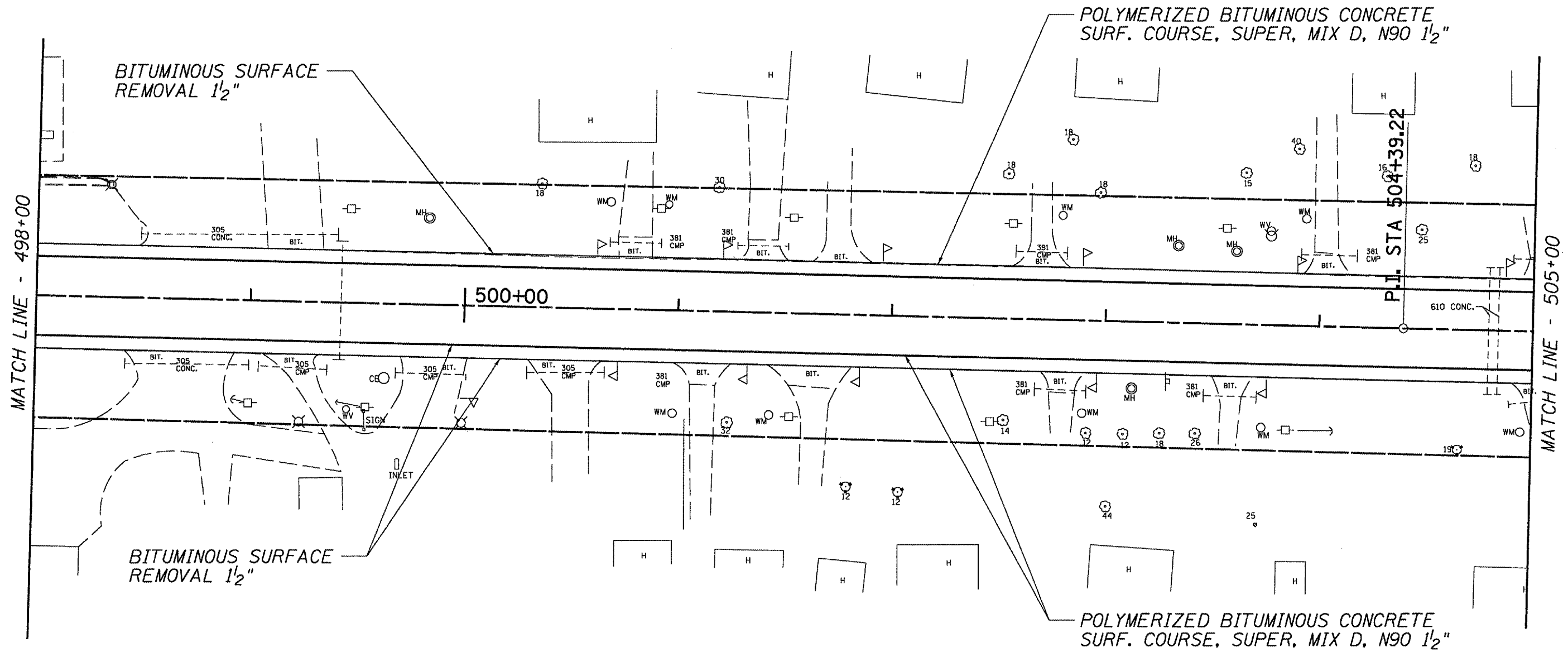

PLAN
FAU 8041 (DIRKSEN PKWY)
SECTION 28RS-7
SANGAMON COUNTY

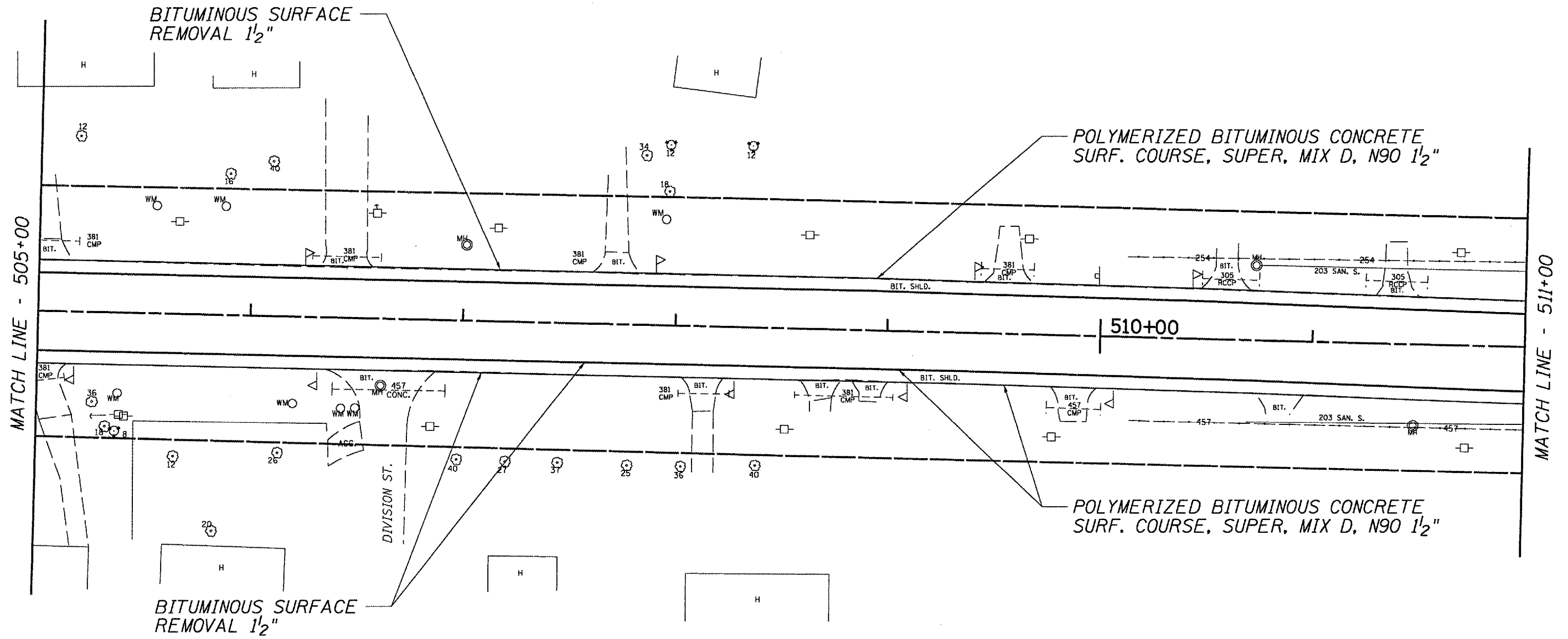

PLAN
FAU 8041 (DIRKSEN PKWY)
SECTION 28RS-7
SANGAMON COUNTY

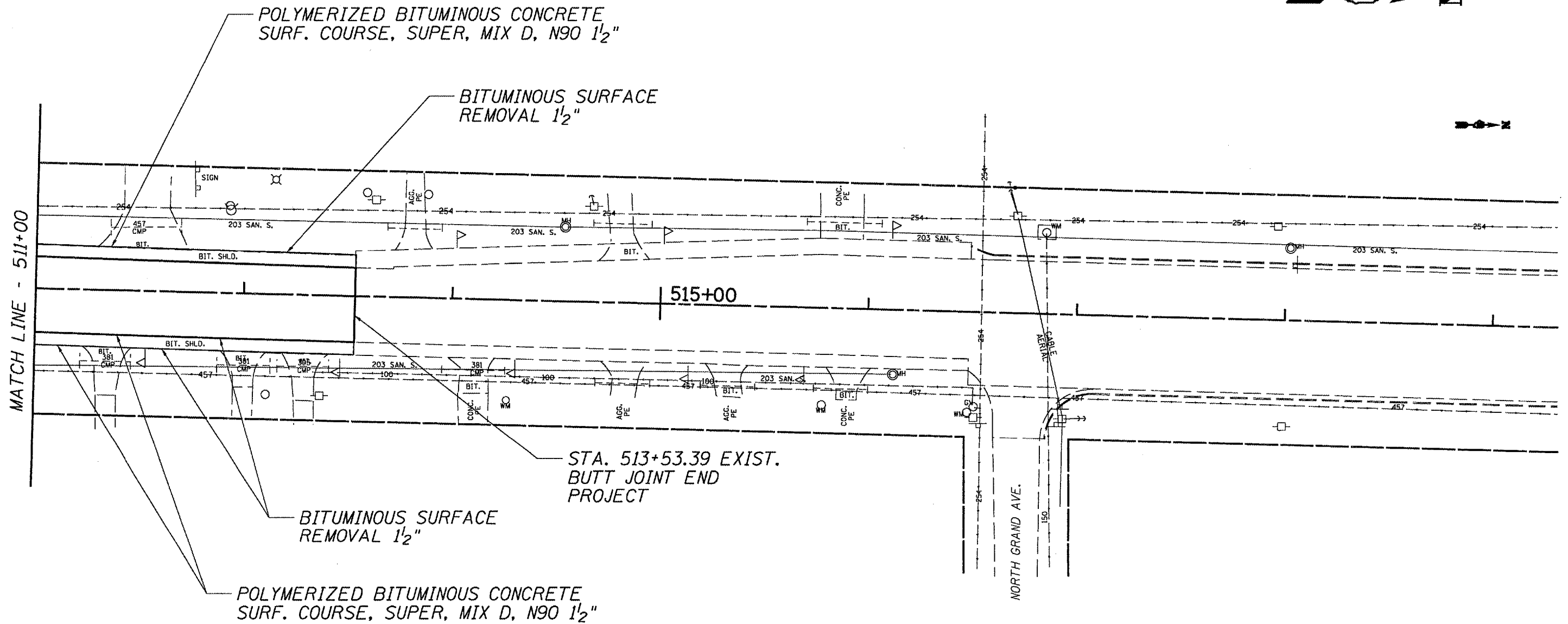

PLAN
FAU 8041 (DIRKSEN PKWY)
SECTION 28RS-7
SANGAMON COUNTY

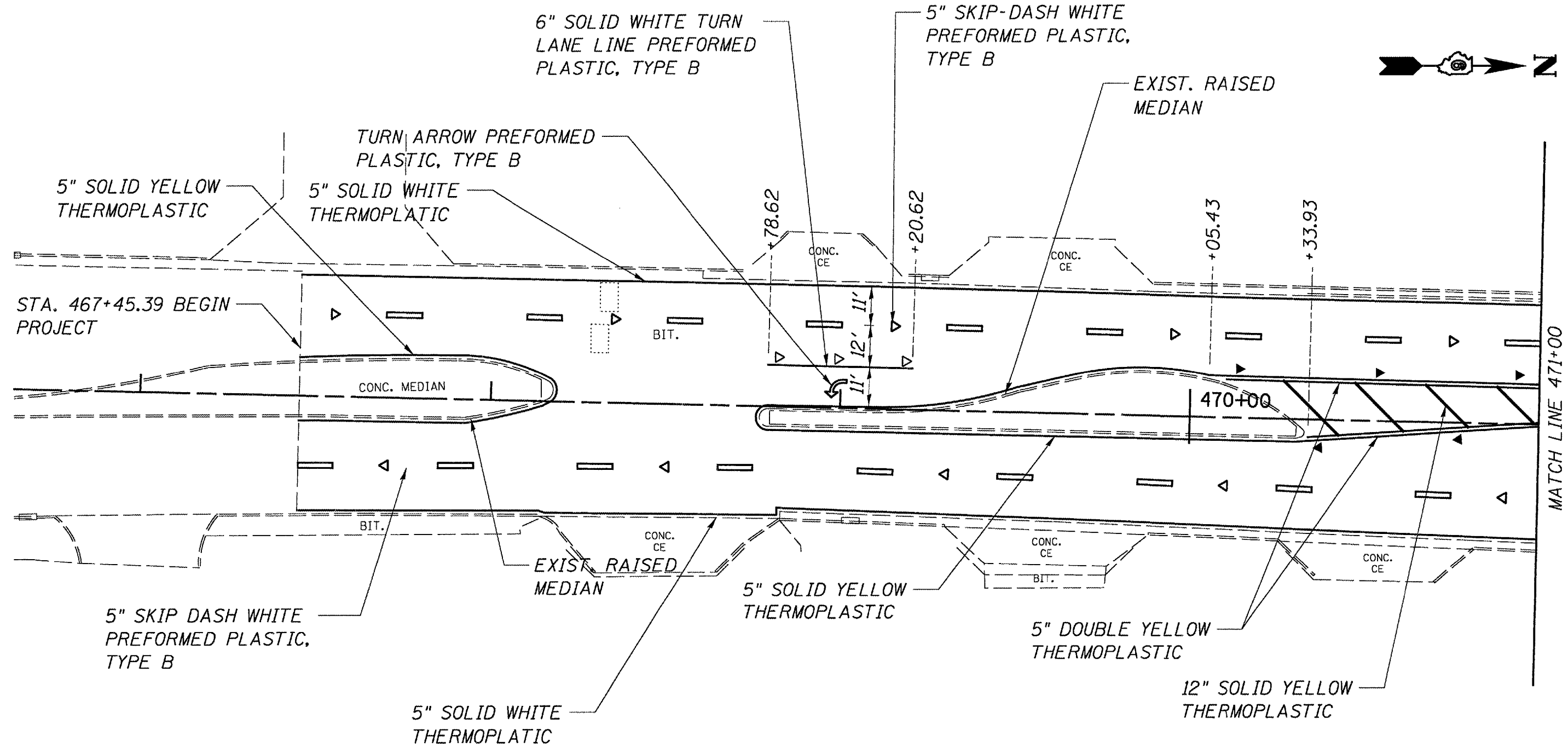

PAVEMENT MARKING
FAU 8041 (DIRKSEN PKWY)
SECTION 28RS-7
SANGAMON COUNTY

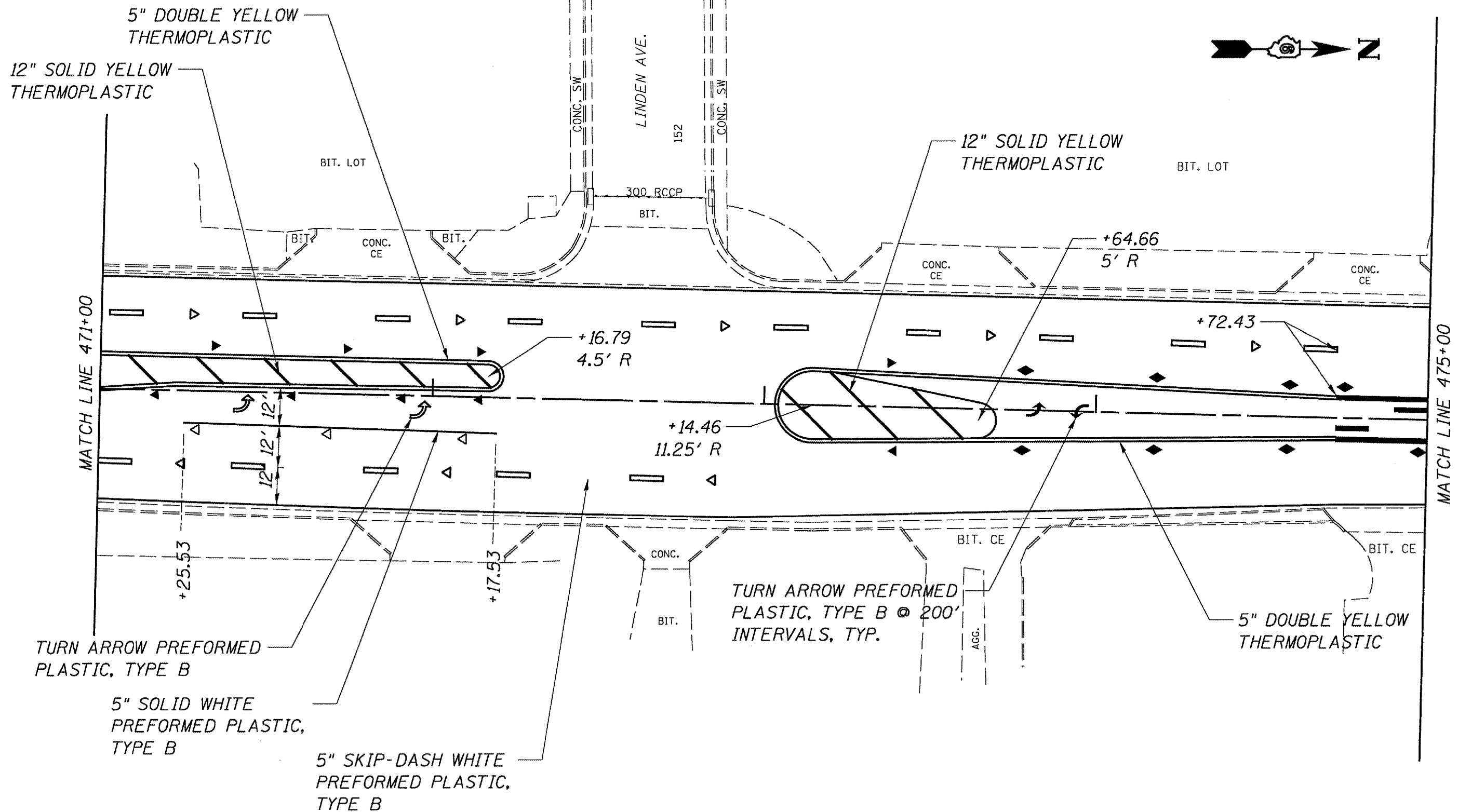

PAVEMENT MARKING
FAU 8041 (DIRKSEN PKWY)
SECTION 28RS-7
SANGAMON COUNTY

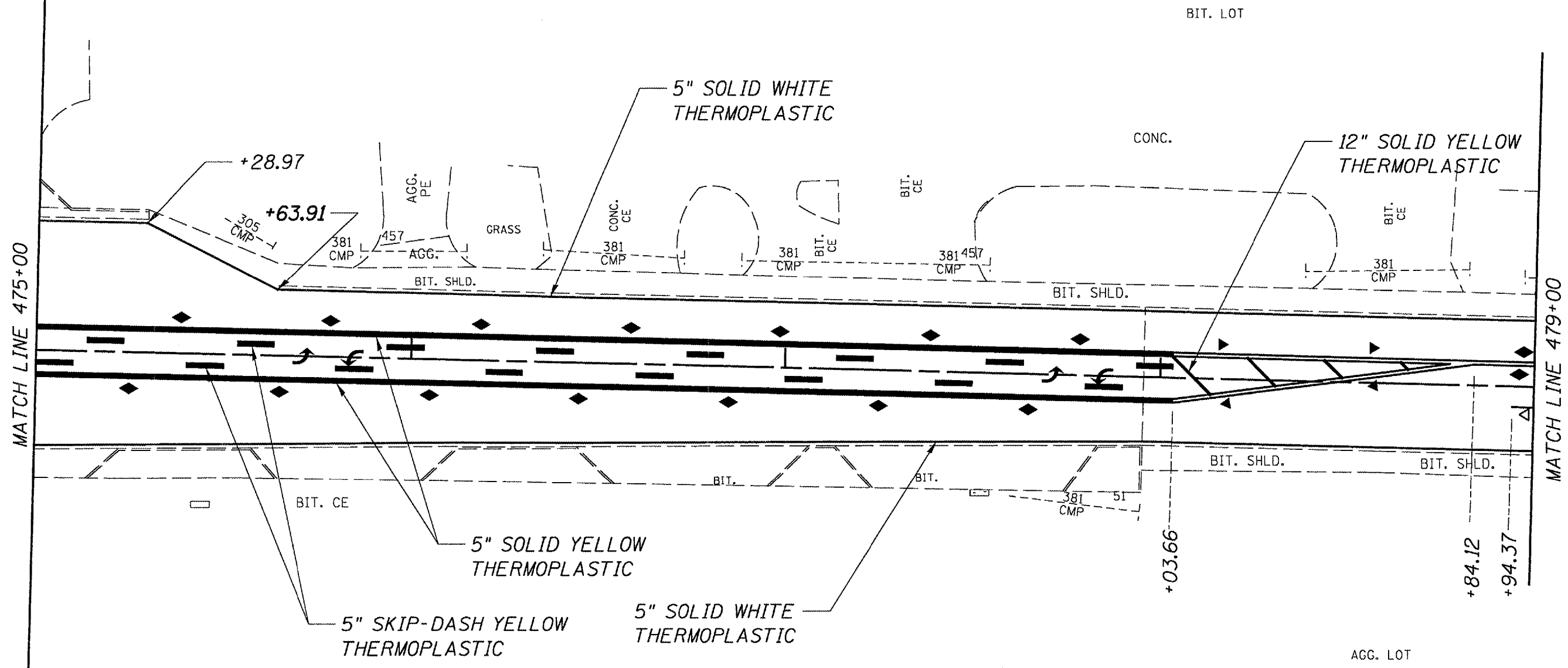

PAVEMENT MARKING
FAU 8041 (DIRKSEN PKWY)
SECTION 28RS-7
SANGAMON COUNTY

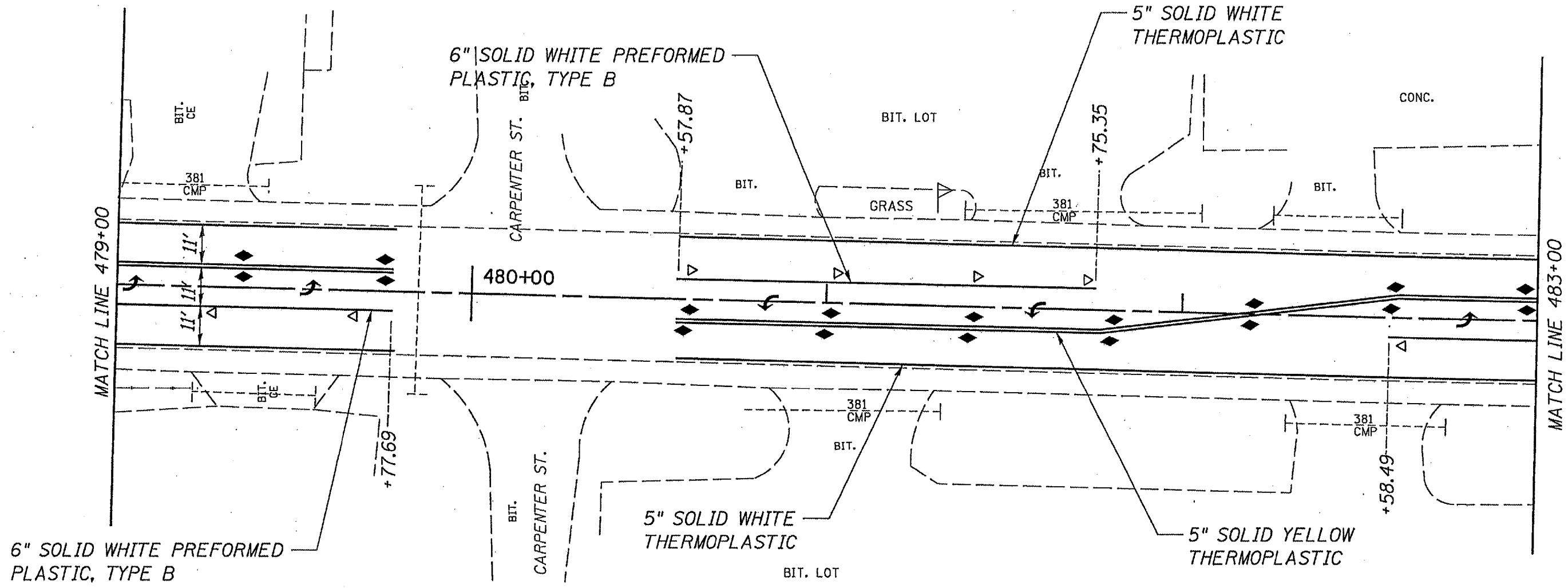

PAVEMENT MARKING
FAU 8041 (DIRKSEN PKWY)
SECTION 28RS-7
SANGAMON COUNTY

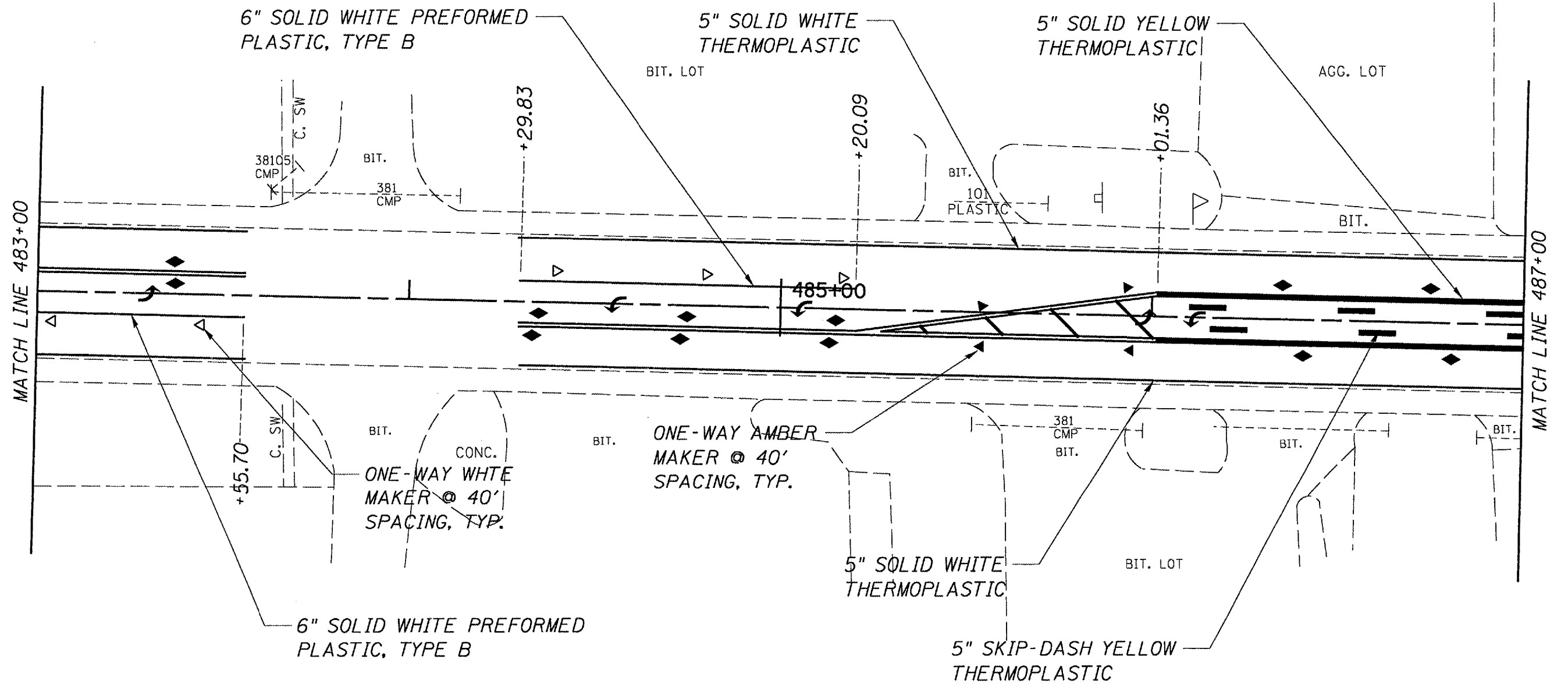

PAVEMENT MARKING
FAU 8041 (DIRKSEN PKWY)
SECTION 28RS-7
SANGAMON COUNTY

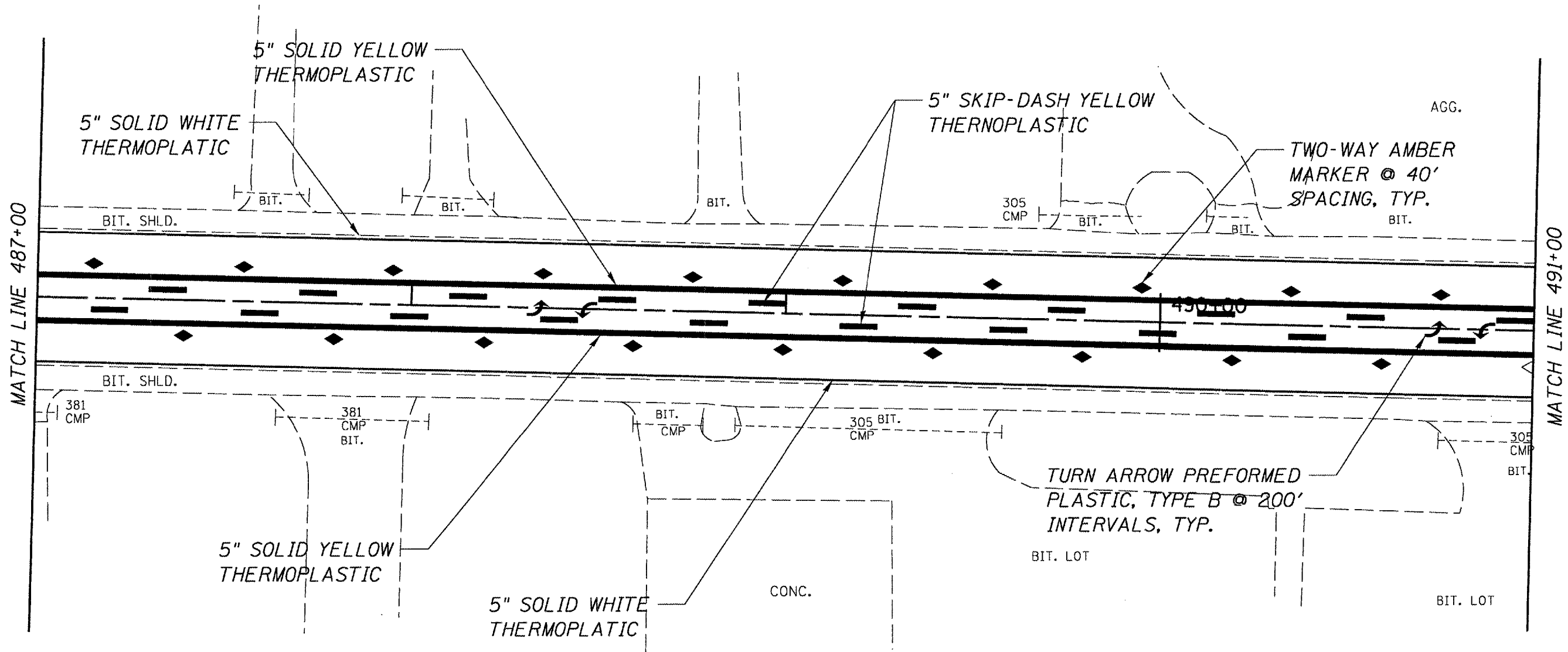

PAVEMENT MARKING
FAU 8041 (DIRKSEN PKWY)
SECTION 28RS-7
SANGAMON COUNTY

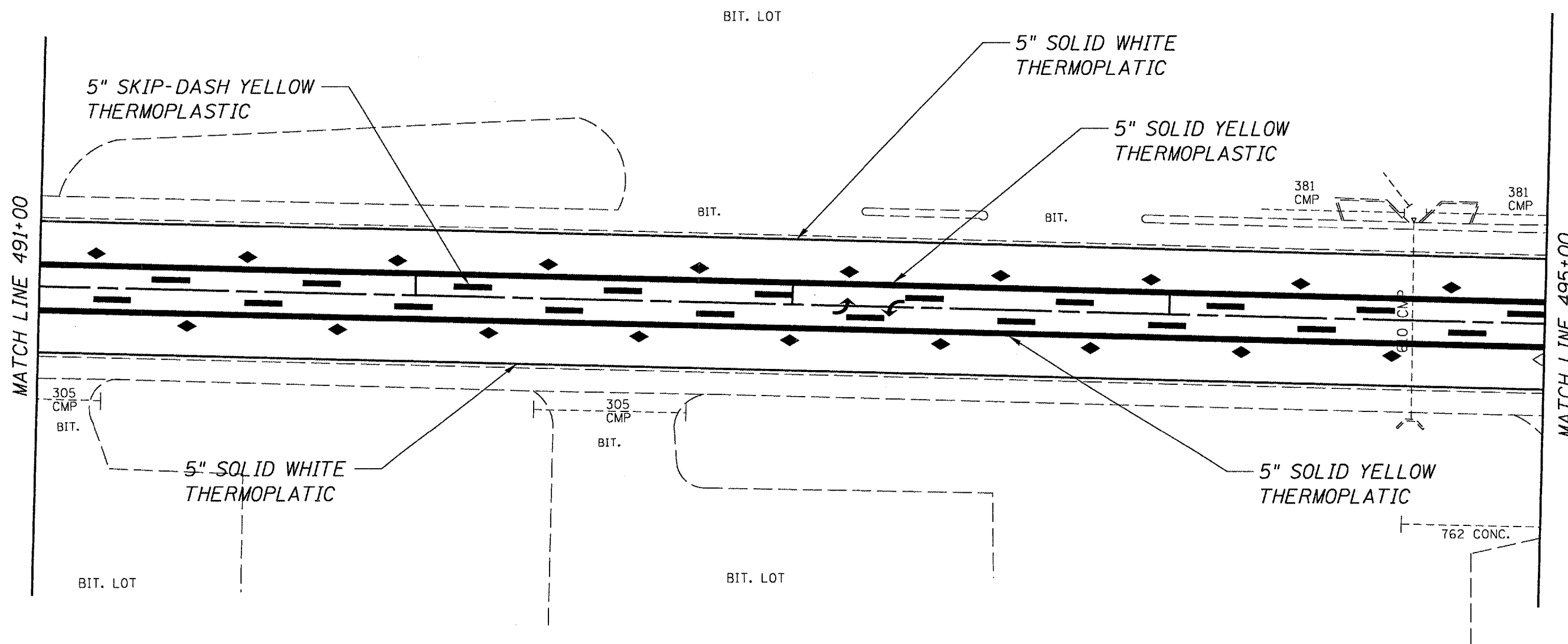

10

PAVEMENT MARKING
FAU 8041 (DIRKSEN PKWY)
SECTION 28RS-7
SANGAMON COUNTY

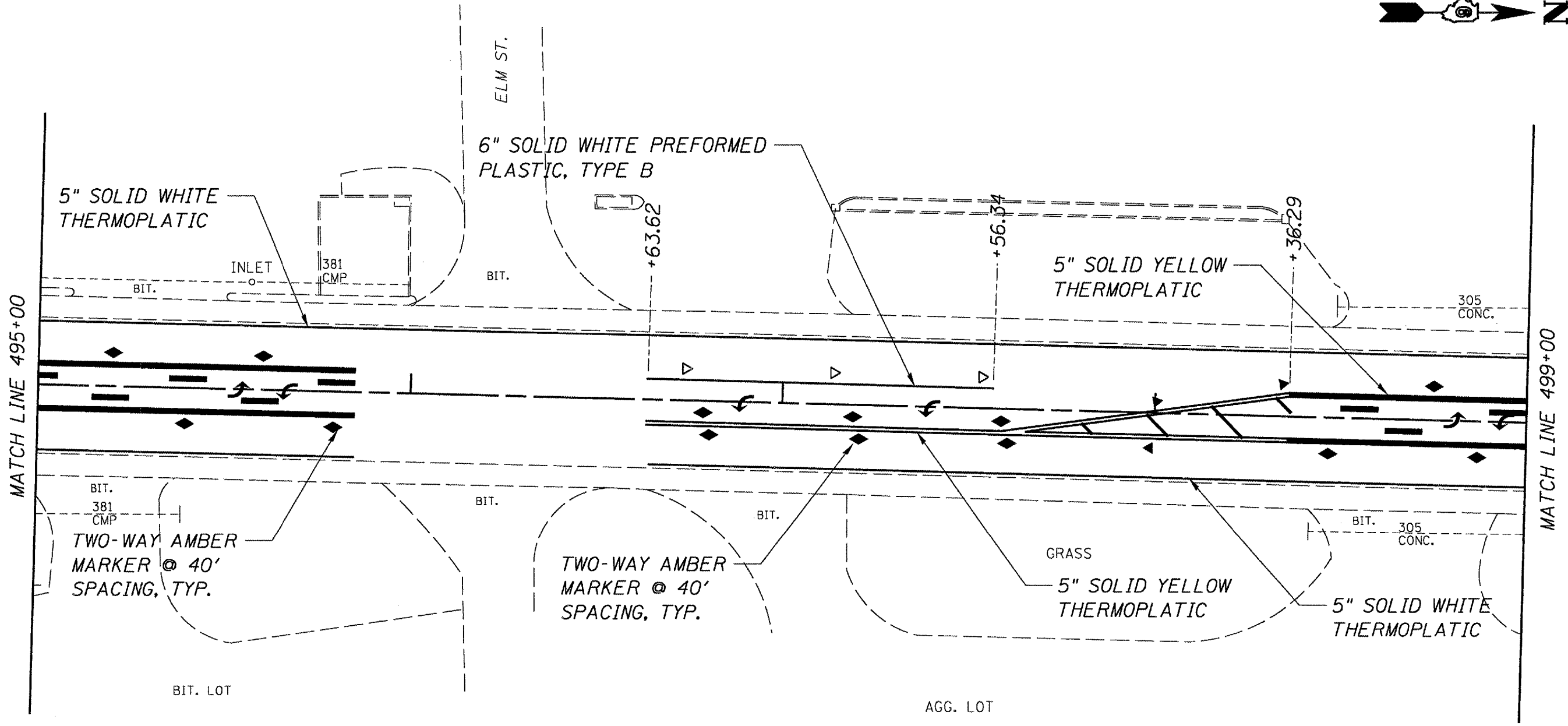

SIGN

PAVEMENT MARKING
FAU 8041 (DIRKSEN PKWY)
SECTION 28RS-7
SANGAMON COUNTY

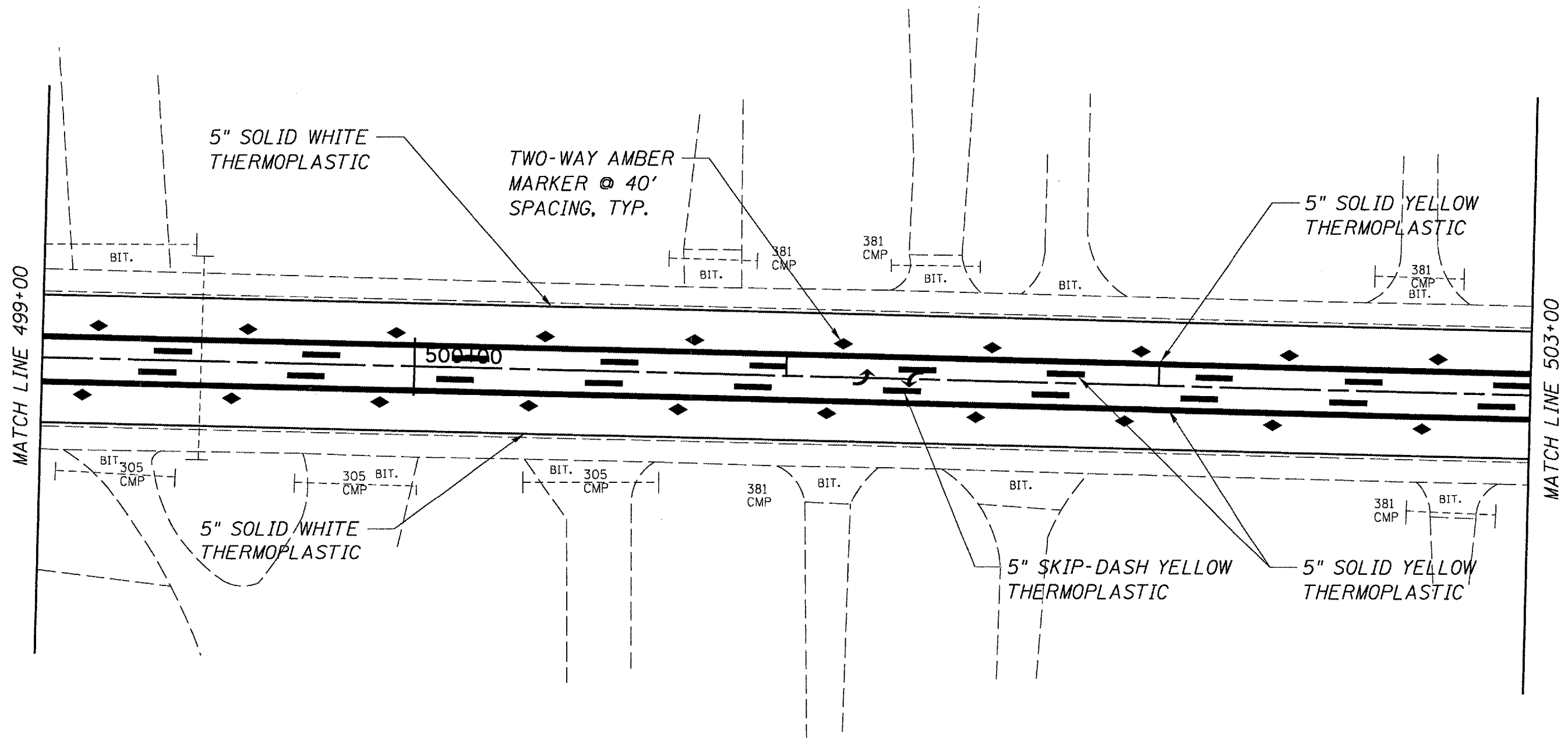

PAVEMENT MARKING
FAU 8041 (DIRKSEN PKWY)
SECTION 28RS-7
SANGAMON COUNTY

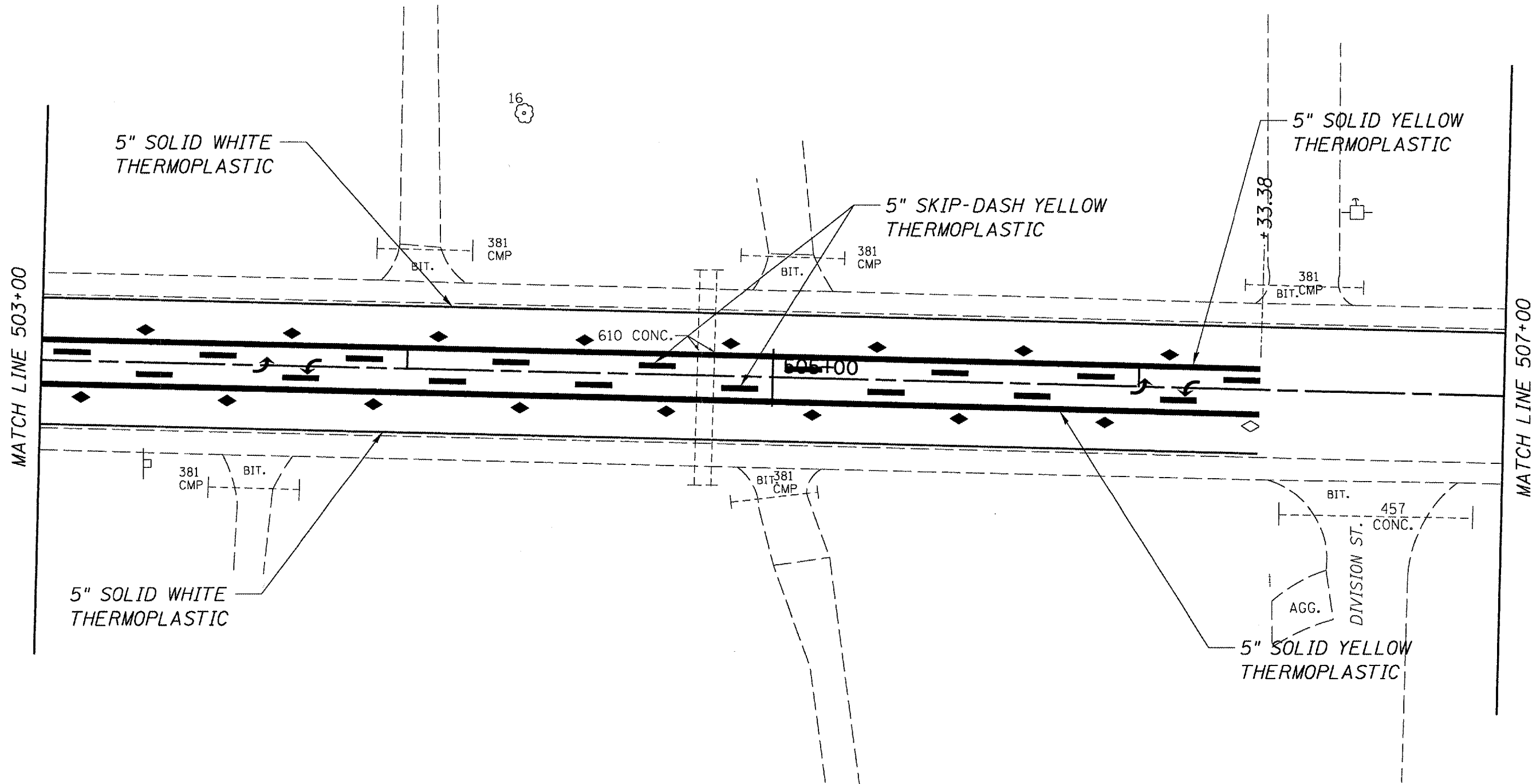

PAVEMENT MARKING
FAU 8041 (DIRKSEN PKWY)
SECTION 28RS-7
SANGAMON COUNTY

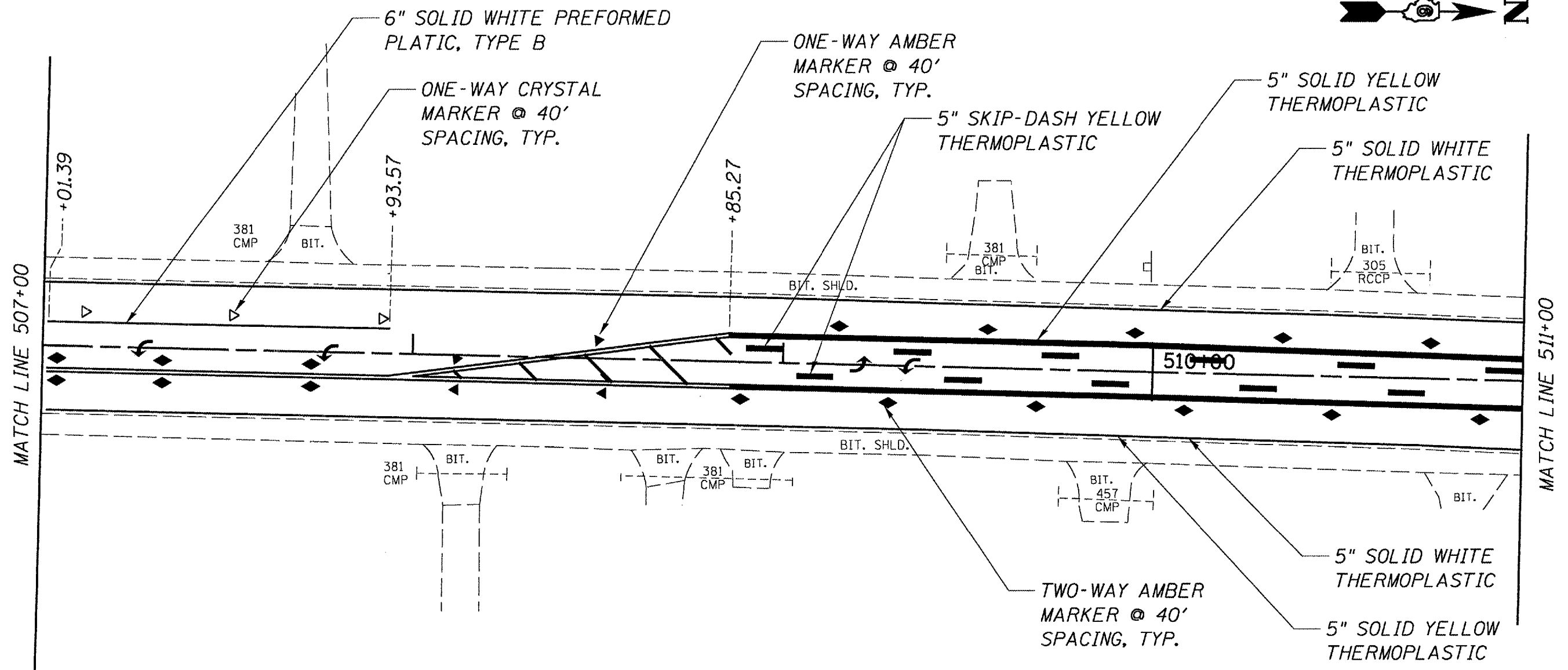

PAVEMENT MARKING
FAU 8041 (DIRKSEN PKWY)
SECTION 28RS-7
SANGAMON COUNTY

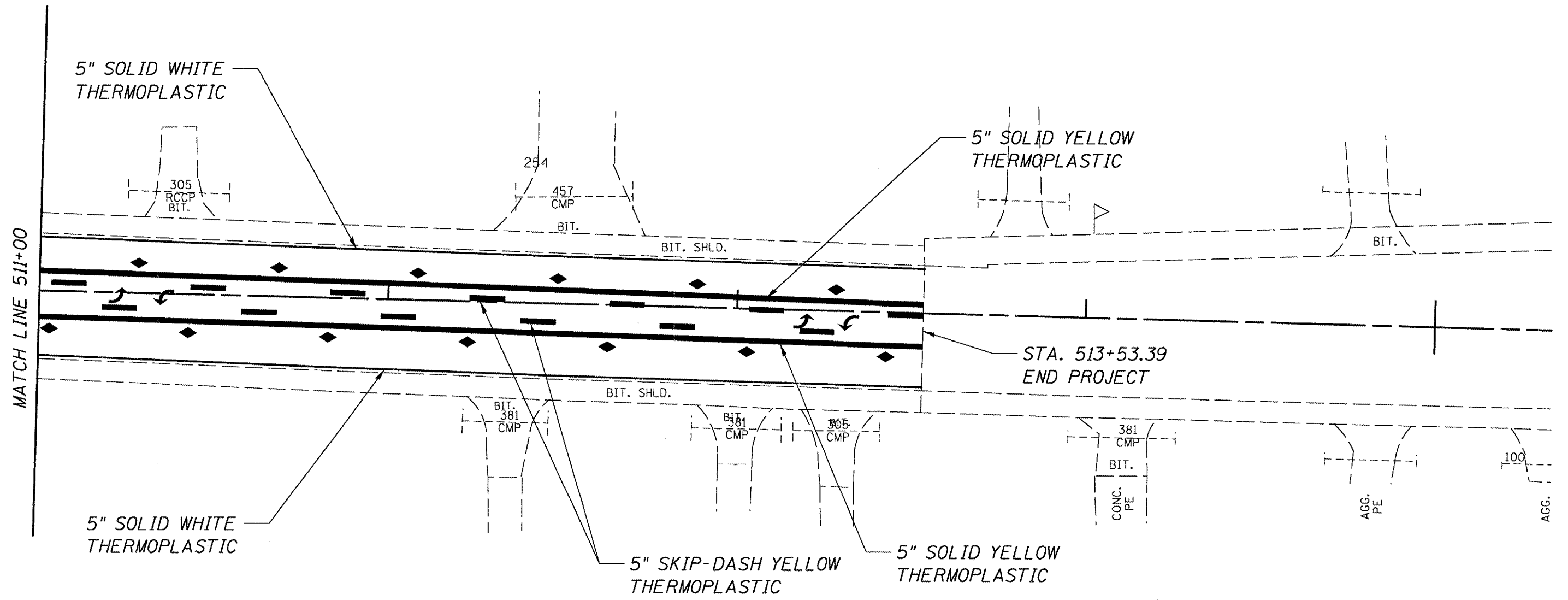

PAVEMENT MARKING
FAU 8041 (DIRKSEN PKWY)
SECTION 28RS-7
SANGAMON COUNTY

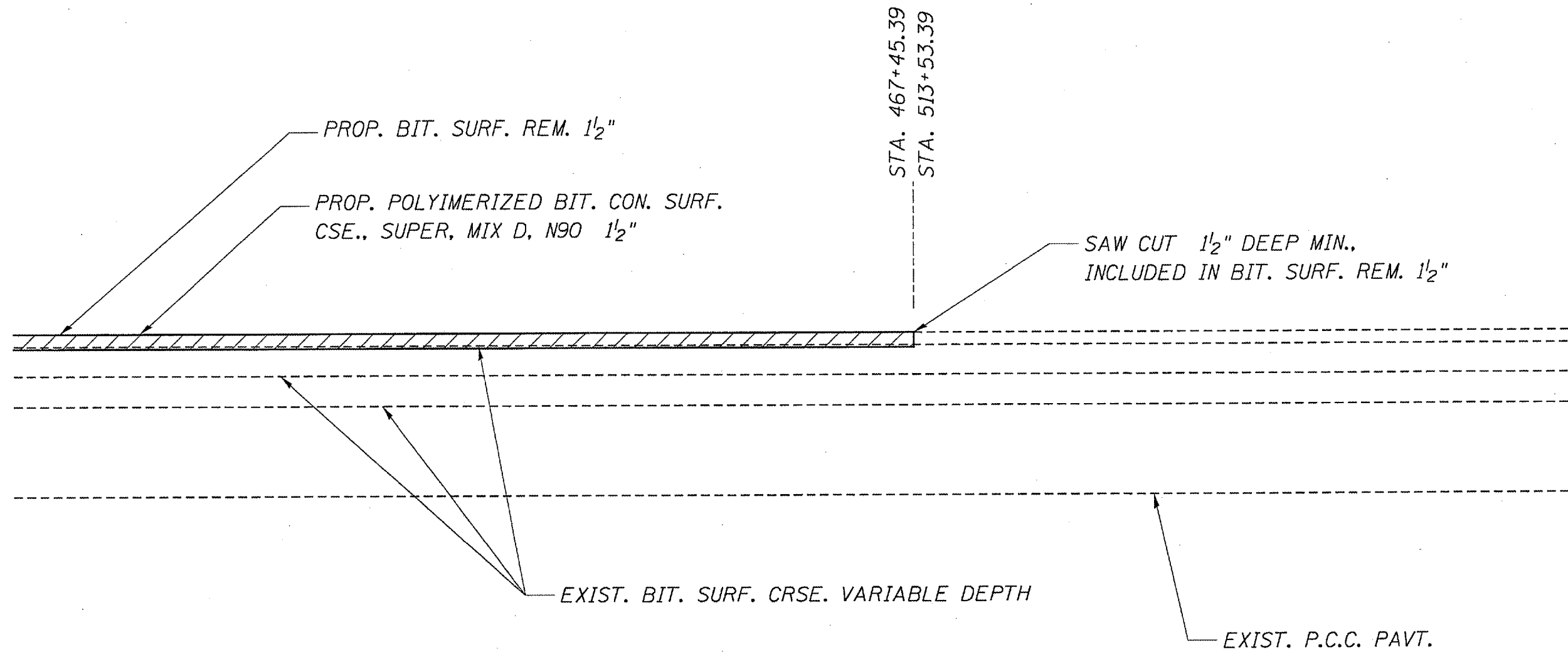

BUTT JOINT DETAIL
FAU 8041 (DIRKSEN PKWY)
SECTION 28RS-7
SANGAMON COUNTY