

F.A.S. RTE.	SECTION	COUNTY	TOTAL SHEETS	SHEET NO.
1771	25RS-7	LOGAN	8	1

STATE OF ILLINOIS
DEPARTMENT OF TRANSPORTATION
DIVISION OF HIGHWAYS

PROPOSED HIGHWAY PLANS

FAS ROUTE 1771 (OLD U.S.66)
SECTION 25RS-7
LOGAN COUNTY
C-96-510-06

INDEX OF SHEETS

- 1 COVER SHEET
- 2 GENERAL NOTES
- 3 SUMMARY OF QUANTITIES
- 4 TYPICAL SECTIONS
- 5 SCHEDULES OF QUANTITIES
- 6 LINE DIAGRAM
- 7 BUTT JOINT DETAIL
- 8 SIDEROAD DETAIL

HIGHWAY STANDARDS

442201-01	701311-02
701006-02	702001-05
701201-02	780001-01
701301-02	000001-04
701306-01	

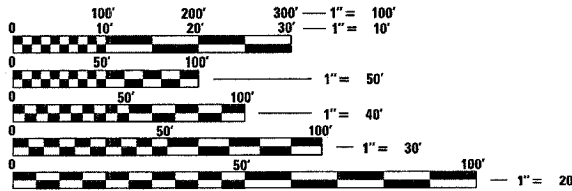
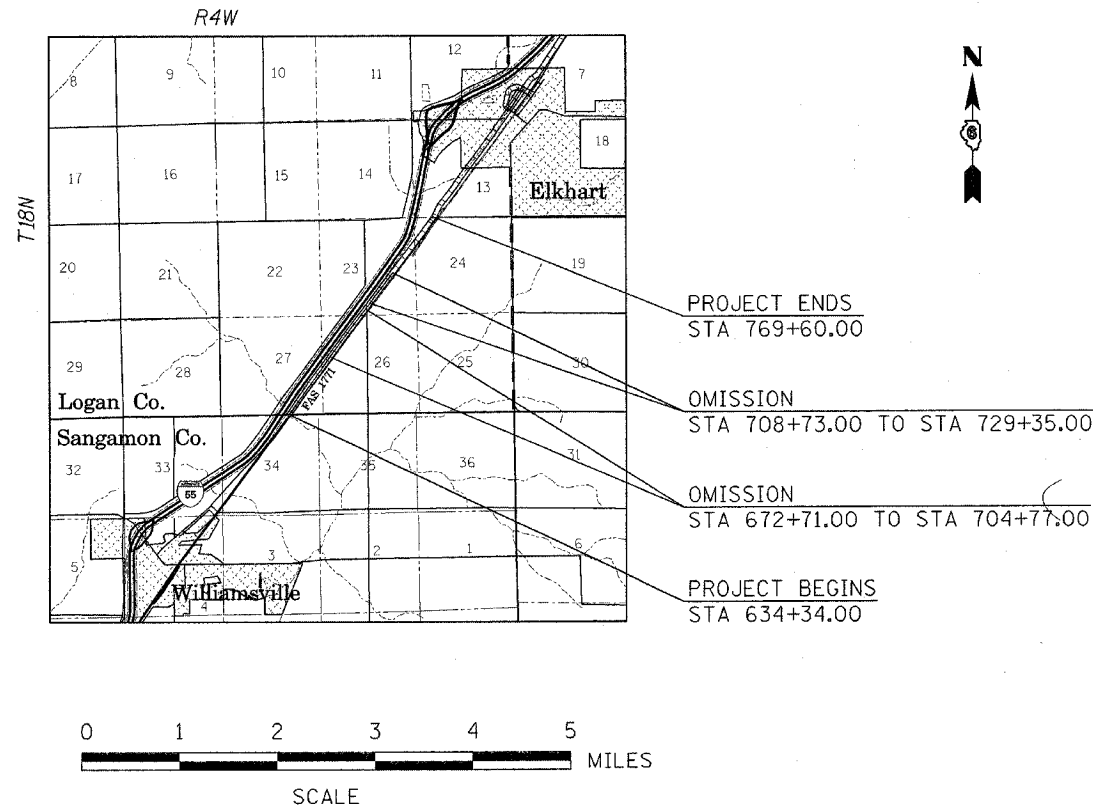
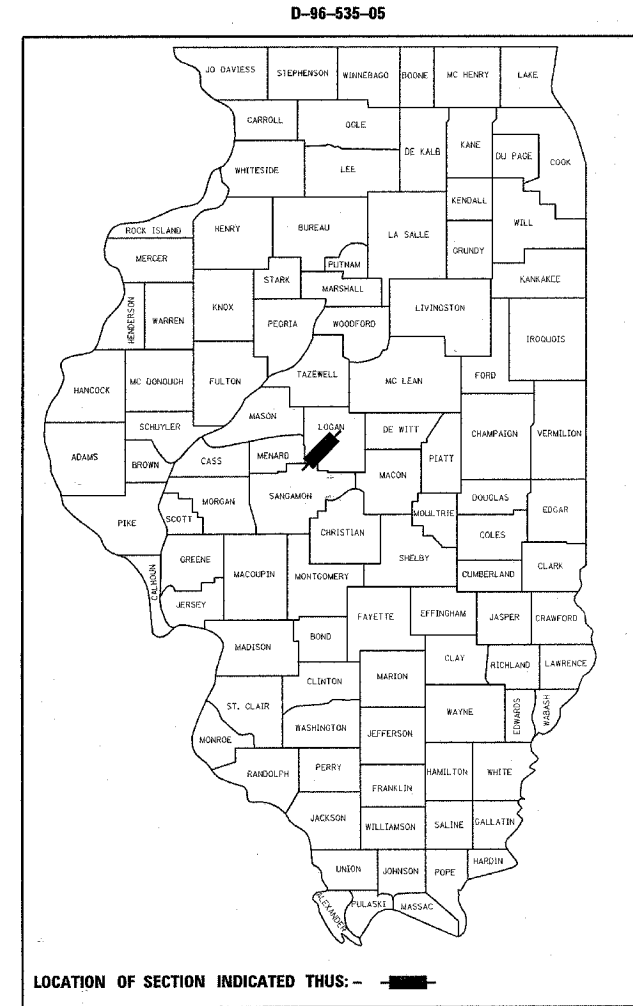

FULL SIZE PLANS HAVE BEEN PREPARED USING STANDARD ENGINEERING SCALES. REDUCED SIZED PLANS WILL NOT CONFORM TO STANDARD SCALES. IN MAKING MEASUREMENTS ON REDUCED PLANS, THE ABOVE SCALES MAY BE USED.

J.U.L.I.E.
JOINT UTILITY LOCATION INFORMATION FOR EXCAVATION
1-800-892-0123

GROSS LENGTH OF PROJECT = 13,526.00 FEET = 2.56 MILES
NET LENGTH OF PROJECT = 8,258.00 FEET = 1.56 MILES

STATE OF ILLINOIS
DEPARTMENT OF TRANSPORTATION
DIVISION OF HIGHWAYS

SUBMITTED May 23, 2005

Chris H. Reed
DEPUTY DIRECTOR OF HIGHWAYS, REGION ENGINEER

July 1, 2005
Mike Hine
ENGINEER OF DESIGN AND ENVIRONMENT

July 1, 2005
Vito Moder
DIRECTOR OF HIGHWAYS, CHIEF ENGINEER

**PRINTED BY THE AUTHORITY
OF THE STATE OF ILLINOIS**

PROJECT ENGINEER: SAL MADONIA (217) 782-4761
SQUAD LEADER: JEFFREY P. MYERS (217) 524-7940

CONTRACT NO. 72A07

LOGAN COUNTY

SECTION 25RS-7

F.A.S. RTE.	SECTION	COUNTY	TOTAL SHEETS	SHEET NO.
1771	25RS-7	LOGAN	8	2
STA.		TO STA.		
FED. ROAD DIST. NO.		ILLINOIS	FED. AID PROJECT	

GENERAL NOTES

- THE CONTRACTOR SHALL BE RESPONSIBLE FOR PROTECTING UTILITY PROPERTY FROM CONSTRUCTION OPERATIONS AS OUTLINED IN ARTICLE 107.31 OF THE STANDARD SPECIFICATIONS. THE JULIE NUMBER IS 800-892-0123. A MINIMUM OF FORTY-EIGHT HOURS ADVANCE NOTICE IS REQUIRED. ANY DAMAGE TO THE UNDERGROUND FACILITIES, CAUSED BY THE CONTRACTOR SHALL BE REPAIRED TO THE SATISFACTION OF THE DEPARTMENT AT THE CONTRACTOR'S EXPENSE, INCLUDING TEMPORARY REPAIRS WHICH MAY BE REQUIRED TO KEEP THE FACILITY OPERATIONAL WHILE MATERIAL IS BEING OBTAINED TO MAKE PERMANENT REPAIRS.
- THE LOCATIONS OF THOSE BURIED AND ABOVEGROUND UTILITIES SHOWN ARE APPROXIMATE, ARE SHOWN FOR CONTRACTOR INFORMATIONAL USE ONLY, AND ARE NOT TO BE REFERENCED FOR CONSTRUCTIONS PURPOSES. THE IMPLIED PRESENCE OR ABSENCE OF UTILITIES IS NOT TO BE CONSTRUED BY THE OWNER, ENGINEER, CONTRACTOR, OR SUBCONTRACTORS TO BE AN ACCURATE AND COMPLETE REPRESENTATION OF UTILITIES THAT MAY OR MAY NOT EXIST ON THE CONSTRUCTION SITE. BURIED AND ABOVEGROUND UTILITY LOCATION, IDENTIFICATION, AND MARKING ARE THE SOLE RESPONSIBILITY OF THE CONTRACTOR. REROUTING, DISCONNECTION, PROTECTION, ETC. OF ANY UTILITIES MUST BE COORDINATED BETWEEN THE CONTRACTOR, UTILITY COMPANY, AND OWNER. SITE SAFETY, INCLUDING THE AVOIDANCE OF HAZARDS ASSOCIATED WITH BURIED AND ABOVEGROUND UTILITIES, REMAINS THE SOLE RESPONSIBILITY OF THE CONTRACTOR.
- THE THICKNESS OF BITUMINOUS MIXTURES SHOWN ON THE PLANS IS THE NOMINAL THICKNESS. DEVIATIONS FROM THE NOMINAL THICKNESS WILL BE PERMITTED WHEN SUCH DEVIATIONS OCCUR DUE TO IRREGULARITIES IN THE EXISTING SURFACE OR BASE ON WHICH THE BITUMINOUS MIXTURE IS PLACED.
- AGGREGATE (PRIME COAT): FA 20 MAY BE USED IN ADDITION TO THE GRADATIONS LISTED IN THE 2ND PARAGRAPH OF ARTICLE 1003.03(c).
- FOR STABILIZATION, ALL TYPE III BARRICADES SHALL REQUIRE A MINIMUM OF FOUR SANDBAGS PER BARRICADE.
- WHERE SECTION OR SUBSECTION MONUMENTS ARE ENCOUNTERED, THE ENGINEER SHALL BE NOTIFIED BEFORE SUCH MONUMENTS ARE REMOVED. THE CONTRACTOR SHALL PROTECT AND CAREFULLY PRESERVE ALL MONUMENTS UNTIL AN AUTHORIZED SURVEYOR OR AGENT HAS WITNESSED OR OTHERWISE REFERENCED THEIR LOCATION. THE CONTRACTOR SHALL BE RESPONSIBLE FOR HAVING AN AUTHORIZED SURVEYOR RE-ESTABLISH ANY SECTION OR SUBSECTION MONUMENTS DESTROYED BY HIS OPERATIONS.
- THE FOLLOWING RATES OF APPLICATION HAVE BEEN USED IN CALCULATING PLAN QUANTITIES:

GRANULAR MATERIALS	2.05	TONS / CU YD
AGGREGATE (PRIME COAT)	0.002	TONS / SQ YD
BITUMINOUS MATERIALS (PRIME COAT)	0.00038	TONS / SQ YD
BITUMINOUS CONCRETE	112	LBS / SQ YD
- ANY REFERENCE TO A STANDARD IN THESE PLANS SHALL BE INTERPRETED TO MEAN THE EDITION AS INDICATED BY THE SUBNUMBER LISTED ON THE INDEX OF SHEETS OR THE COPY OF THE STANDARD INCLUDED IN THESE PLANS.
- UNLESS NOTED OTHERWISE, STATIONS AND OFFSETS REFER TO CENTERLINE OF PROJECT.
- IN ADDITION TO FIELD SURVEYS AND AERIAL SURVEYS, PLAN DIMENSIONS AND DETAILS RELATIVE TO THE EXISTING FACILITIES HAVE BEEN TAKEN FROM EXISTING PLANS AND ARE SUBJECT TO CONSTRUCTION VARIATIONS. IT SHALL BE THE CONTRACTOR'S RESPONSIBILITY TO VERIFY SUCH DIMENSIONS AND DETAILS IN THE FIELD. SUCH VARIATIONS SHALL NOT BE A CAUSE FOR ADDITIONAL COMPENSATION DUE TO A CHANGE IN THE SCOPE OF THE WORK. HOWEVER, THE CONTRACTOR WILL BE PAID FOR THE QUANTITY ACTUALLY FURNISHED AT THE UNIT PRICE BID FOR THE WORK.

COMMITMENTS:

THERE ARE NO COMMITMENTS ON THIS PROJECT.

MIX REQUIREMENTS TABLE			
The following mixture requirements are applicable for this project.			
MIXTURE USE (S):	SURFACE COURSE	LEVELING BINDER	INCIDENTAL BIT SURF
AC/PG:	PG 64-22	PG 64-22	PG 64-22
RAP%: (MAX)	15%	15%	15%
DESIGN AIR VOIDS:	4.0% @ N DESIGN = 50	4.0% @ N DESIGN = 50	4.0% @ N DESIGN = 50
MIXTURE COMPOSITION: (GRADATION MIXTURE)	IL 9.5 OR 12.5	IL 9.5	IL 9.5 OR 12.5
FRICITION AGGREGATE:	MIX "C"	N/A	MIX "C"

DISTRICT SIX	
EXAMINED <i>May 20</i>	20 <i>05</i>
OPERATIONS ENGINEER	
EXAMINED <i>May 11</i>	20 <i>05</i>
PROGRAM IMPLEMENTATION ENGINEER	
EXAMINED <i>May 23</i>	20 <i>05</i>
PROGRAM DEVELOPMENT ENGINEER	

REVISIONS		ILLINOIS DEPARTMENT OF TRANSPORTATION
NAME	DATE	
		GENERAL NOTES FAS 1771 (OLD US 66) SECTION 25RS-7 LOGAN COUNTY SCALE: VERT. HORIZ. DATE

PLOT DATE = 5/28/2005
 FILE NAME = S:\Projects\Myers\55 FR Mill\mills\11e\gennotes.dgn
 PLOT SCALE = 59.8606 / IN.
 USER NAME = mjg-jp

F.A.S. RTE.	SECTION	COUNTY	TOTAL SHEETS	SHEET NO.
1771	25RS-7	LOGAN	8	3
STA.		TO STA.		
FED. ROAD DIST. NO.	ILLINOIS	FED. AID PROJECT		

ILLINOIS DEPARTMENT OF TRANSPORTATION
SUMMARY OF QUANTITIES

LOCATION OF WORK				ROADWAY	SN 054-2000 STA 638+04.5 TO STA 638+31.5	
SUMMARY OF QUANTITIES				CONSTRUCTION TYPE CODE	CONSTRUCTION TYPE CODE	
CODE NO.	ITEM	UNIT	TOTAL QUANTITY	I000	SFTY-2A	
40600200	BITUMINOUS MATERIALS (PRIME COAT)	TON	9.5	9.4	0.1	
40600300	AGGREGATE (PRIME COAT)	TON	50	49.8	0.2	
40600895	CONSTRUCTING TEST STRIP	EACH	1	1		
40600990	TEMPORARY RAMP	SQ YD	129	129		
40800040	INCIDENTAL BITUMINOUS SURFACING	TON	10	10		
44000030	BITUMINOUS SURFACE REMOVAL (VARIABLE DEPTH)	SQ YD	25,079	24,998	81	
44200176	PAVEMENT PATCHING, TYPE I, 15 INCH	SQ YD	25	25		
44200180	PAVEMENT PATCHING, TYPE II, 15 INCH	SQ YD	275	275		
44200184	PAVEMENT PATCHING, TYPE III, 15 INCH	SQ YD	75	75		
48101200	AGGREGATE SHOULDERS, TYPE B	TON	627	625	2	
67100100	MOBILIZATION	L SUM	1	1		
70100450	TRAFFIC CONTROL AND PROTECTION, STANDARD 701201	L SUM	1	1		
70100460	TRAFFIC CONTROL AND PROTECTION, STANDARD 701306	L SUM	1	1		
70300100	SHORT-TERM PAVEMENT MARKING	FOOT	2,477	2,469	8	
70300230	TEMPORARY PAVEMENT MARKING - LINE 5"	FOOT	18,581	18,520	61	
70301000	WORK ZONE PAVEMENT MARKING REMOVAL	SQ FT	275	274	1	
* 78001120	PAINT PAVEMENT MARKING - LINE 5"	FOOT	18,581	18,520	61	
X4066414	BITUMINOUS CONCRETE SURFACE COURSE, SUPERPAVE, MIX "C", N50	TON	2,100	2,093	7	
X4066765	LEVELING BINDER (MACHINE METHOD), SUPERPAVE N50	TON	1,050	1,047	3	

* SPECIALTY ITEMS

REVISIONS	
NAME	DATE

ILLINOIS DEPARTMENT OF TRANSPORTATION
SUMMARY OF QUANTITIES
FAS 1771 (OLD US 66)
SECTION 25RS-7
LOGAN COUNTY

SCALE: VERT.
HORIZ.
DATE

DRAWN BY
CHECKED BY

F.A.S. RTE.	SECTION	COUNTY	TOTAL SHEETS	SHEET NO.
1771	25RS-7	LOGAN	8	4
STA.		TO STA.		
FED. ROAD DIST. NO.		ILLINOIS	FED. AID PROJECT	

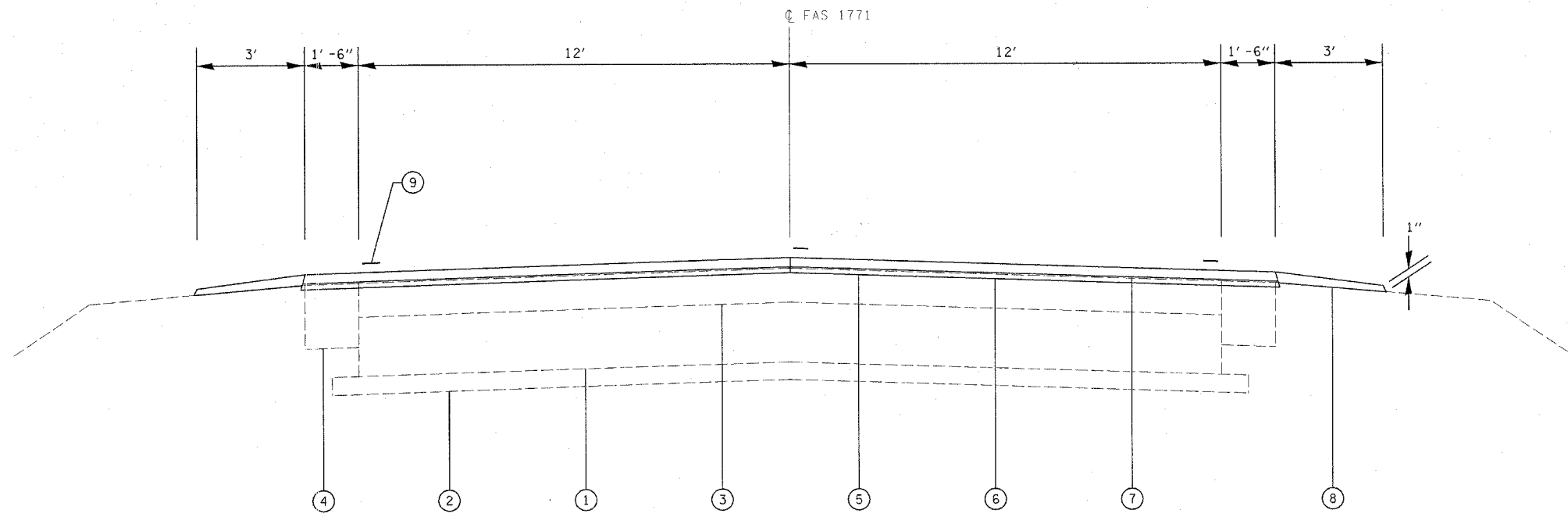

STA 634+34.00 TO 672+71.00
 STA 704+77.00 TO 708+73.00
 STA 729+35.00 TO 766+93.00

LEGEND

- ① EX PCC PAVEMENT 10"
- ② EX SUBBASE GRANULAR MATERIAL
- ③ EX BITUMINOUS CONCRETE 5 1/2"
- ④ EX BITUMINOUS SHOULDERS
- ⑤ PR BITUMINOUS SURFACE REMOVAL (VARIABLE DEPTH) (3/4" @ ϕ)
- ⑥ PR LEVEL BINDER (MACHINE METHOD), SUPERPAVE N50, 3/4"
- ⑦ PR BITUMINOUS CONCRETE SURFACE COURSE, SUPERPAVE, MIX "C", N50 1 1/2"
- ⑧ PR AGGREGATE SHOULDER, TYPE B
- ⑨ PR PAINT PAVEMENT MARKING LINE - 5"

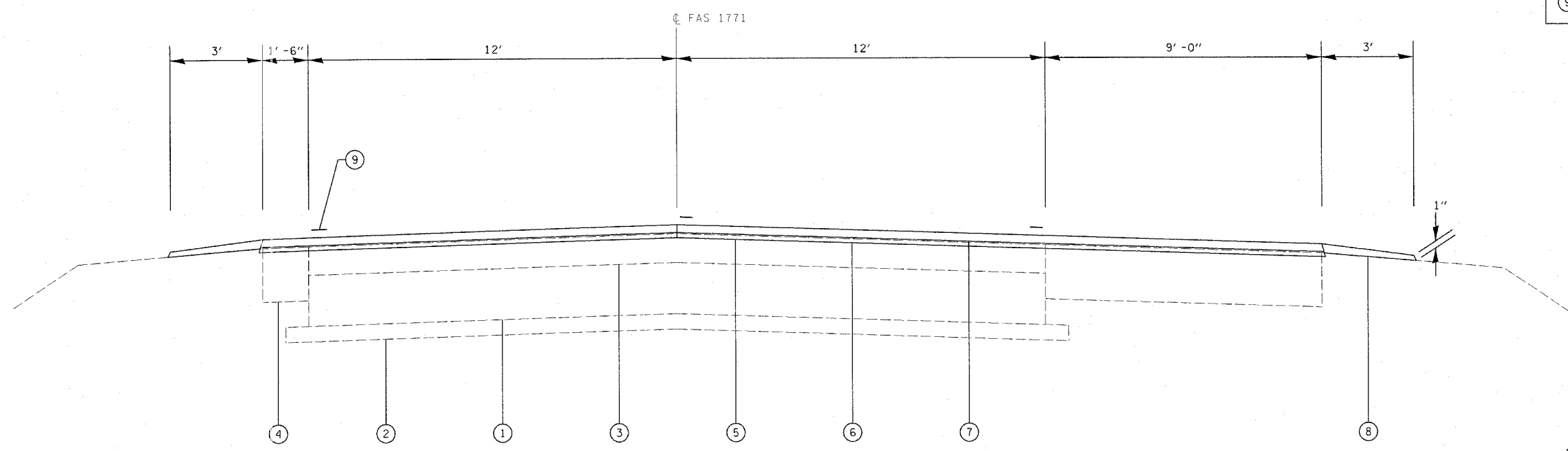

STA 766+93.00 TO 769+60.00

REVISIONS	
NAME	DATE

ILLINOIS DEPARTMENT OF TRANSPORTATION
 TYPICAL SECTIONS
 FAS 1771 (OLD US 66)
 SECTION 25RS-7
 LOGAN COUNTY

SCALE: VERT. _____
 HORIZ. _____
 DATE _____

DRAWN BY _____
 CHECKED BY _____

F.A.S. RTE.	SECTION	COUNTY	TOTAL SHEETS	SHEET NO.
1771	25RS-7	LOGAN	8	5
STA.		TO STA.		
FED. ROAD DIST. NO.	ILLINOIS	FED. AID PROJECT		

PAVING SCHEDULE

LOCATION	LENGTH (FOOT)	LT SHLD WIDTH (FOOT)	PAVEMENT WIDTH (FOOT)	RT SHLD WIDTH (FOOT)	BIT SURF REM (VD) (SQ YD)	BIT MATL PR CT (TON)	AGG PR CT (TON)	LEVEL BINDER (TON)	BIT SURF COURSE (TON)	INC BIT SURF (TON)
STA 634+34.00 TO STA 672+71.00	3,837.00	1.5	24.0	1.5	11,511.00	4.37	23.02	483.46	966.92	
STA 704+77.00 TO STA 708+73.00	396.00	1.5	24.0	1.5	1,188.00	0.45	2.38	49.90	99.79	
STA 729+35.00 TO STA 766+93.00	3,758.00	1.5	24.0	1.5	11,274.00	4.28	22.55	473.51	947.02	
STA 766+93.00 TO STA 769+60.00	267.00	1.5	24.0	9.0	1,023.50	0.39	2.05	42.99	85.97	
SIDERoads & ENTRANCES					82.67	0.03	0.17			10.42
TOTAL					25,079.17	9.52	50.17	1,049.86	2,099.70	10.42

AGGREGATE SHOULDERS, TYPE B

LOCATION	LENGTH (FOOT)	LT SHLD WIDTH (FOOT)	RT SHLD WIDTH (FOOT)	AVE DEPTH (INCH)	QUANTITY (SQ YD)
STA 634+34.00 TO STA 672+71.00	3,837.00	3.0	3.0	2.0	291.33
STA 704+77.00 TO STA 708+73.00	396.00	3.0	3.0	2.0	30.07
STA 729+35.00 TO STA 769+60.00	4,025.00	3.0	3.0	2.0	305.60
TOTAL					627.00

PAINT PAVEMENT MARKING - LINE 5"

LOCATION	LENGTH (FOOT)	SKIP-DASH 5" YELLOW (FOOT)	EDGE LINES 5" WHITE (FOOT)	TOTAL (FOOT)
STA 634+34.00 TO STA 672+71.00	3,837.00	959.25	7,674.00	8,633.25
STA 704+77.00 TO STA 708+73.00	396.00	99.00	792.00	891.00
STA 729+35.00 TO STA 769+60.00	4,025.00	1,006.25	8,050.00	9,056.25
TOTAL				18,580.50

TEMPORARY RAMP

LOCATION	LENGTH (FOOT)	PAVEMENT WIDTH (FOOT)	AREA (SQ YD)
STA 634+34.00	5.00	27.0	15.00
STA 672+71.00	5.00	27.0	15.00
STA 704+77.00	5.00	27.0	15.00
STA 708+73.00	5.00	27.0	15.00
STA 729+35.00	5.00	27.0	15.00
STA 769+60.00	5.00	27.0	15.00
STA 708+14 RT - SIDEROAD	5.00	71.0	39.44
TOTAL			129.44

SHORT-TERM PAVEMENT MARKING

LOCATION	LENGTH (FOOT)	NO. OF APS	TOTAL LENGTH (FOOT)
STA 634+34.00 TO STA 672+71.00	383.70	3	1,151.10
STA 704+77.00 TO STA 708+73.00	39.60	3	118.80
STA 729+35.00 TO STA 769+60.00	402.50	3	1,207.50
TOTAL			2,477.40

WORK ZONE PAVEMENT MARKING REMOVAL

LOCATION	LENGTH (FOOT)	AREA (SQ FT)
STA 634+34.00 TO STA 672+71.00	383.70	127.90
STA 704+77.00 TO STA 708+73.00	39.60	13.20
STA 729+35.00 TO STA 769+60.00	402.50	134.17
TOTAL		275.27

PLOT DATE = 5/19/2005
 FILE NAME = S:\Projects\Myers\55 FR Millersville\Aschedule.dgn
 PLOT SCALE = 50.0000' / IN.
 USER NAME = mjers.jp

REVISIONS		ILLINOIS DEPARTMENT OF TRANSPORTATION SCHEDULES OF QUANTITIES FAS 1771 (OLD US 66) SECTION 25RS-7 LOGAN COUNTY
NAME	DATE	
		SCALE: VERT. HORIZ. DATE
DRAWN BY		CHECKED BY

F.A.S. RTE.	SECTION	COUNTY	TOTAL SHEETS	SHEET NO.
1771	25RS-7	LOGAN	8	6
STA.		TO STA.		
FED. ROAD DIST. NO.	ILLINOIS	FED. AID PROJECT		

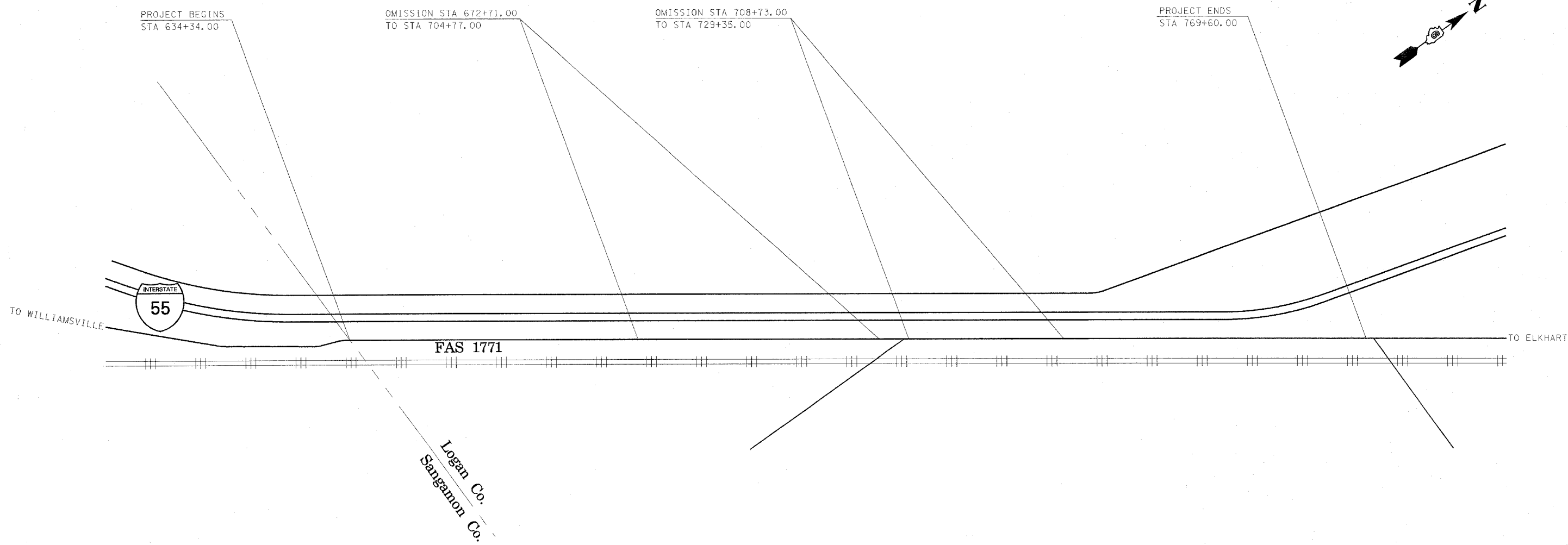

PLOT DATE = 5/19/2005
 FILE NAME = S:\Projects\1100\1100.dgn
 PLOT SCALE = 2000000 / 1 IN.
 USER NAME = mjg

REVISIONS	
NAME	DATE

ILLINOIS DEPARTMENT OF TRANSPORTATION

LINE DIAGRAM
 FAS 1771 (OLD US 66)
 SECTION 25RS-7
 LOGAN COUNTY

SCALE: VERT. _____
 HORIZ. _____

DATE _____

DRAWN BY _____
 CHECKED BY _____

F.A.S. RTE.	SECTION	COUNTY	TOTAL SHEETS	SHEET NO.
1771	25RS-7	LOGAN	8	7
STA.		TO STA.		
FED. ROAD DIST. NO.	ILLINOIS	FED. AID PROJECT		

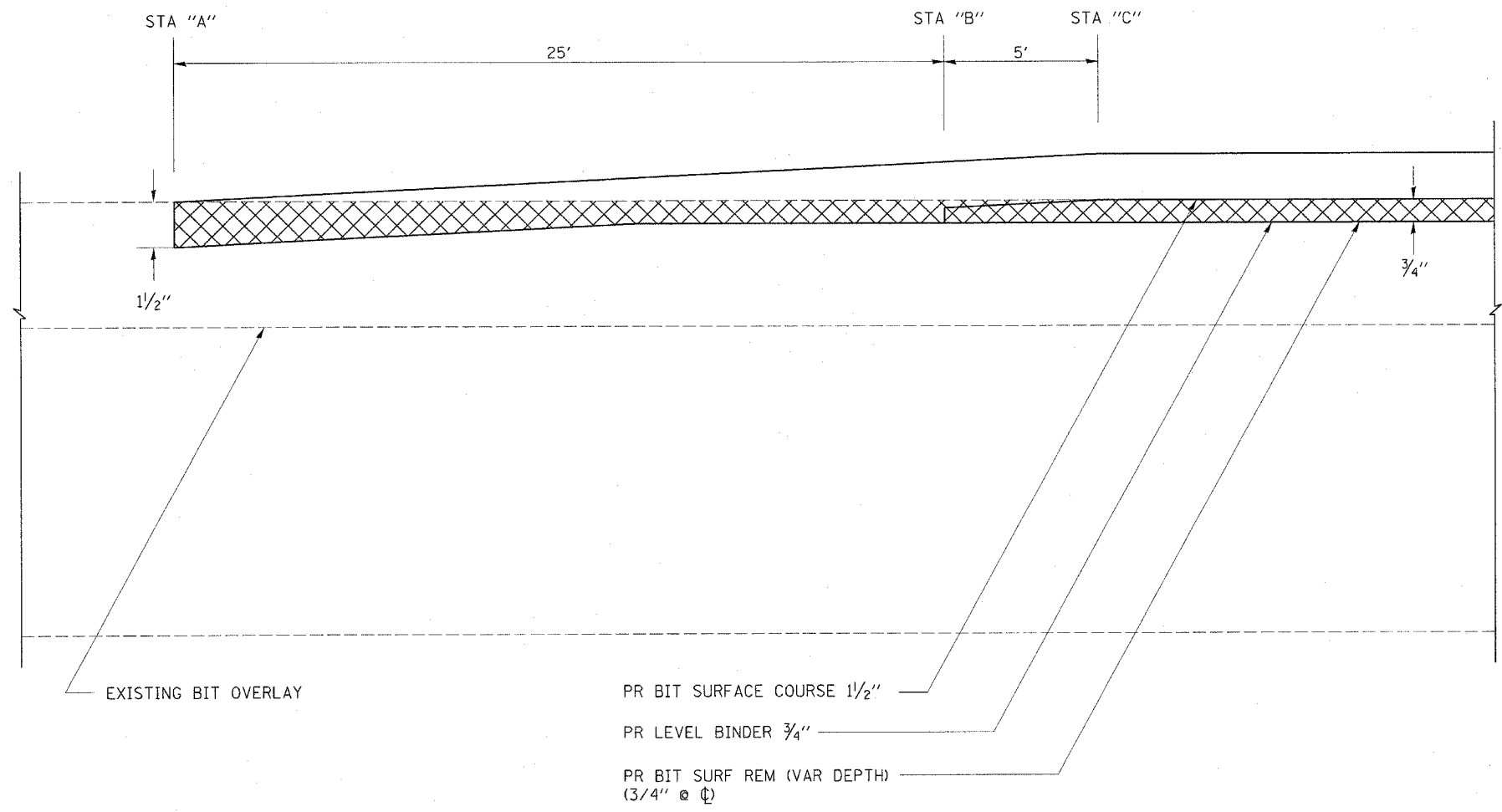

BUTT JOINT DETAIL

STA "A"	STA "B"	STA "C"
634+34.00	634+59.00	634+64.00
672+71.00	672+46.00	672+41.00
704+77.00	705+02.00	705+07.00
708+73.00	708+48.00	708+43.00
729+35.00	729+60.00	729+65.00
769+60.00	769+35.00	769+30.00

REVISIONS		ILLINOIS DEPARTMENT OF TRANSPORTATION
NAME	DATE	
		<p align="center">BUTT JOINT DETAIL</p> <p align="center">FAS 1771 (OLD US 66)</p> <p align="center">SECTION 25RS-7</p> <p align="center">LOGAN COUNTY</p> <p>SCALE: VERT. _____</p> <p> HORIZ. _____</p> <p>DATE _____</p> <p align="right">DRAWN BY _____</p> <p align="right">CHECKED BY _____</p>

PLOT DATE = 5/19/2005
 FILE NAME = S:\Projects\Myer\155 FR Williamsville\butt.jcdgn
 PLOT SCALE = 50.0000' / IN.
 USER NAME = mjgajp

F.A.S. RTE.	SECTION	COUNTY	TOTAL SHEETS	SHEET NO.
1771	25RS-7	LOGAN	8	8
STA.		TO STA.		
FED. ROAD DIST. NO.		ILLINOIS	FED. AID PROJECT	

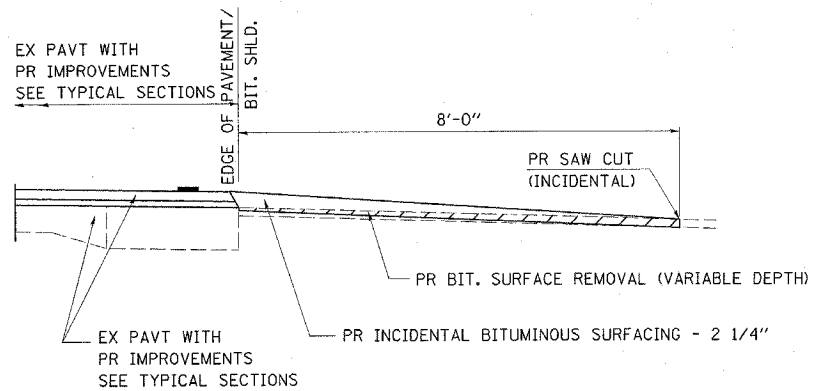
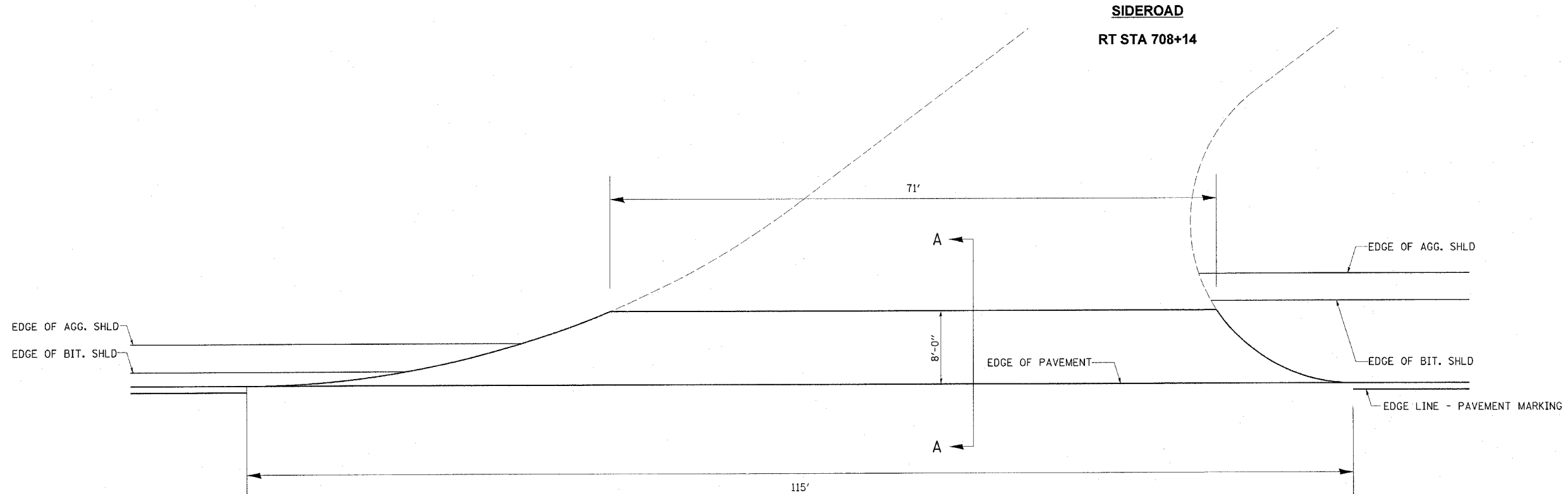

SECTION A-A FOR EX BITUMINOUS SIDE ROAD

GENERAL NOTES:

THE RESIDENT ENGINEER WILL DETERMINE THE EXACT TYPE OF IMPROVEMENT TO BE COMPLETED FOR ALL ENTRANCES, SIDEROADS AND MAILBOX TURNOUTS ON THIS PROJECT.

THE PLAN DETAILS AND SCHEDULES SHOULD BE USED AS A GUIDE FOR THE ENGINEER TO IMPLEMENT THE FINAL DESIGN. THE ENGINEER MAY DECIDE TO SALVAGE PORTIONS OF THE EXISTING ENTRANCE PAVEMENT STRUCTURE; THEREFORE, REDUCING PAY ITEM QUANTITIES. NO ADDITIONAL PAYMENT WILL BE ALLOWED FOR THIS REDUCTION IN QUANTITIES.

ANY WORK THE ENGINEER REQUIRES WHICH IS NOT COVERED BY A PAY ITEM CONTAINED IN THE PLANS WILL BE PAID FOR IN ACCORDANCE WITH ARTICLE 109.04 OF THE STANDARD SPECIFICATIONS.

BITUMINOUS CONCRETE REQUIRED TO CONSTRUCT THE ENTRANCES SHALL BE IN ACCORDANCE WITH THE APPLICABLE PORTIONS OF SECTION 406 AND 408 OF THE STANDARD SPECIFICATIONS AND AS DIRECTED BY THE ENGINEER.

WHEN THE BITUMINOUS CONCRETE PROPOSED FOR THE IMPROVEMENT IS THICKER THAN 75 mm (3 INCHES) AND REQUIRE PLACEMENT IN MORE THAN ONE LIFT. THE BOTTOM LIFT(S) SHALL MEET THE REQUIREMENTS OF BITUMINOUS BASE COURSE IN SECTION 406 OF THE STANDARD SPECIFICATIONS AND THE TOP LIFT OF 50 mm (2 INCHES) SHALL MEET THE REQUIREMENTS OF BITUMINOUS CONCRETE SURFACE COURSE, SUPERPAVE.

THIS WORK WILL BE PAID FOR IN ACCORDANCE WITH SECTIONS 351, 358, 408, 423 AND 440 OF THE STANDARD SPECIFICATIONS.

ALL DIMENSIONS ARE IN INCHES UNLESS OTHERWISE SHOWN.

SHEET 1 OF 1

REVISIONS	
NAME	DATE
JPM	5/05/05

ILLINOIS DEPARTMENT OF TRANSPORTATION
SIDEROAD DETAIL
 FAS 1771 (OLD US 66)
 SECTION 25RS-7
 LOGAN COUNTY
 SCALE: VERT. _____
 HORIZ. _____
 DATE _____
 DRAWN BY _____
 CHECKED BY _____

PLOT DATE = 5/19/2005
 FILE NAME = S:\Projects\Wyers\105 PR Millersville\Burt\tdgn
 USER NAME = mgarajp