

ROUTE	SECTION	COUNTY	TOTAL SHEETS	SHEET NO.
•	••	•••	25	16
STA.	TO STA.			
FED. ROAD DIST. NO.	ILLINOIS	FED. AID PROJECT	••••	
•	FAI 55/70	CONTRACT#	76966	
••	DIST 8 ITS 2006-1			
•••	MADISON & ST. CLAIR			

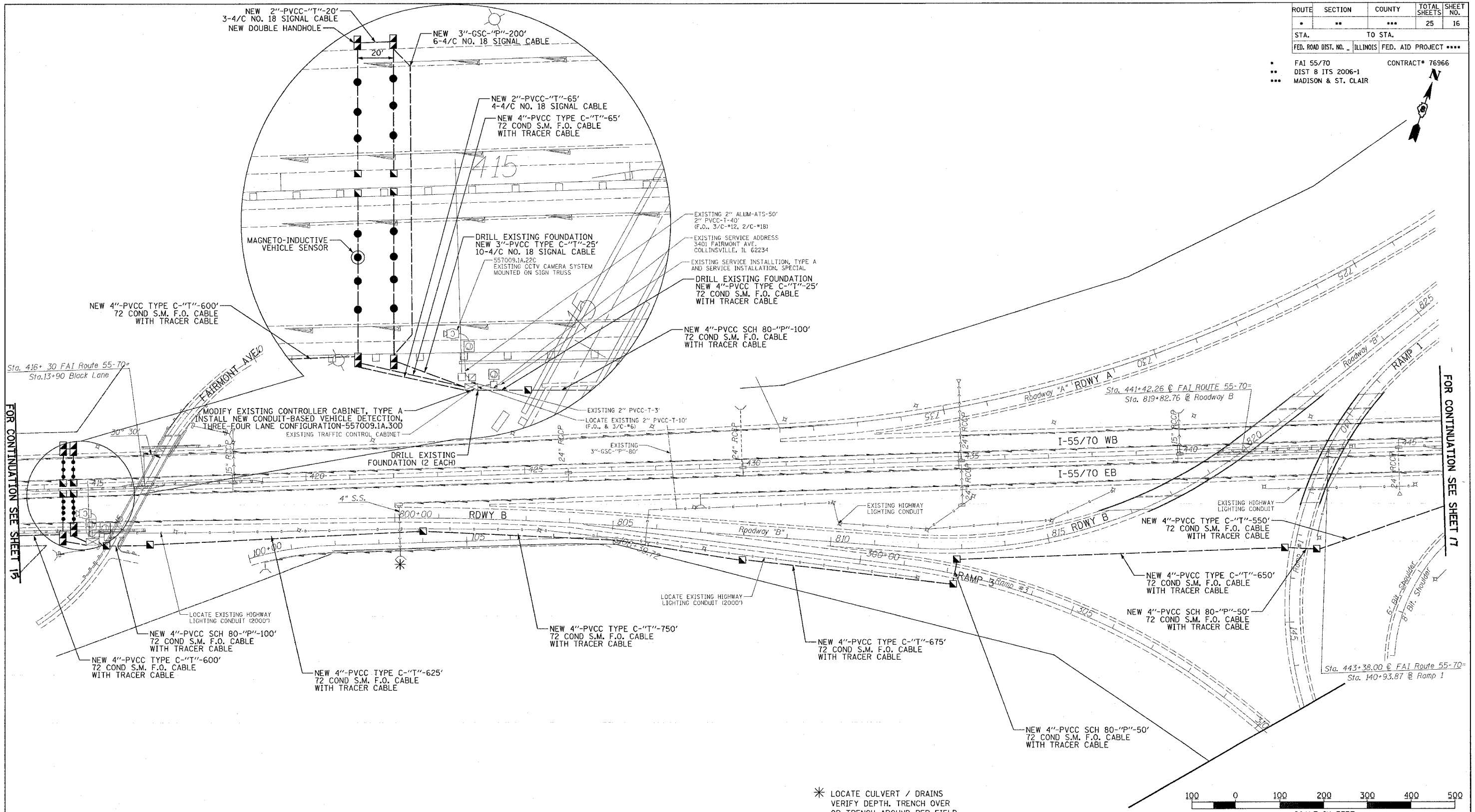

FOR CONTINUATION SEE SHEET 15

FOR CONTINUATION SEE SHEET 17

NOTE:
 ANY BRUSH CLEARING AT LOCATION
 557009.1A.30D SHALL BE INCLUDED
 IN THE COST OF TRENCH AND BACKFILL
 PAY ITEM

* LOCATE CULVERT / DRAINS
 VERIFY DEPTH. TRENCH OVER
 OR TRENCH AROUND PER FIELD
 ENGINEER'S RECOMMENDATION.

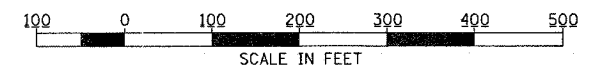
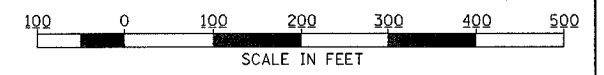

REVISIONS	
NAME	DATE

ILLINOIS DEPARTMENT OF TRANSPORTATION
 LOCATION 557009.1A.30D
 FAI 55/70
 SECTION DIST 8 ITS 2006-1
 MADISON AND ST. CLAIR COUNTY

SCALE: 1" = 100'
 DATE 05/02/05

DRAWN BY MAM
 CHECKED BY CAF