

F.A.U. R.T.E.	SECTION	COUNTY	TOTAL SHEETS	SHEET NO.
1636	92-00037-03-PV	WILL	33	11
STA.		TO STA.		
FED. ROAD DIST. NO.		ALNOS.	FED. AID PROJECT	

83680

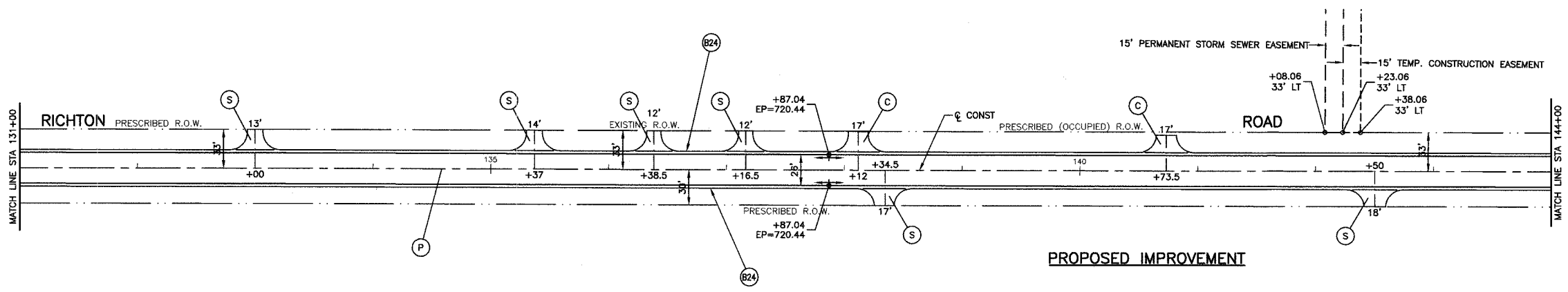
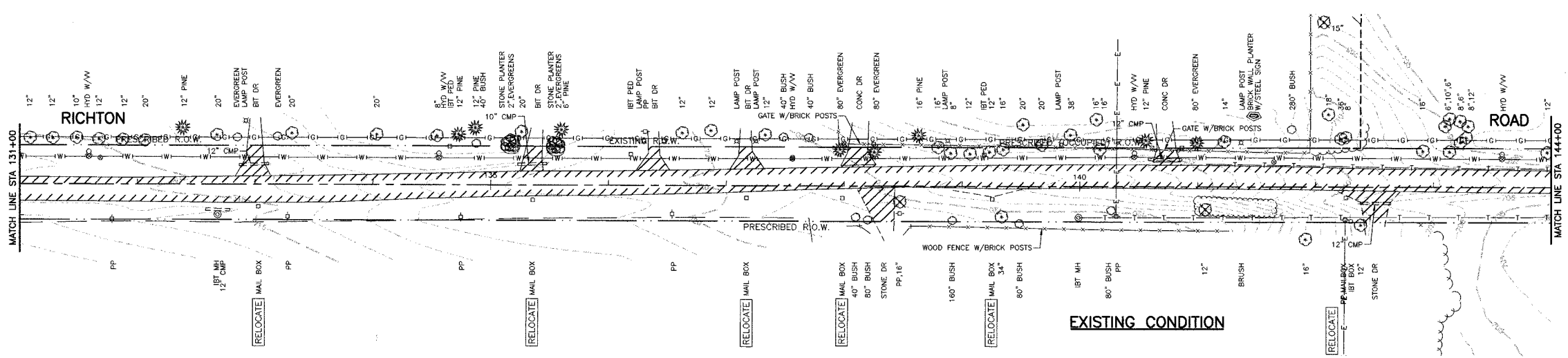

PROPOSED LEGEND

- (P) FULL DEPTH PAVEMENT
- (C) CONCRETE DRIVEWAY
- (S) STABILIZED DRIVEWAY
- (B24) COMBINATION CONCRETE CURB AND GUTTER, TYPE B-6.24
- (T) TRANSITION FROM TYPE B-6.24 CURB AND GUTTER TO 0" CURB HEIGHT
- ////// PAVEMENT/DRIVEWAY REMOVAL
- (X) TREE TO BE REMOVED

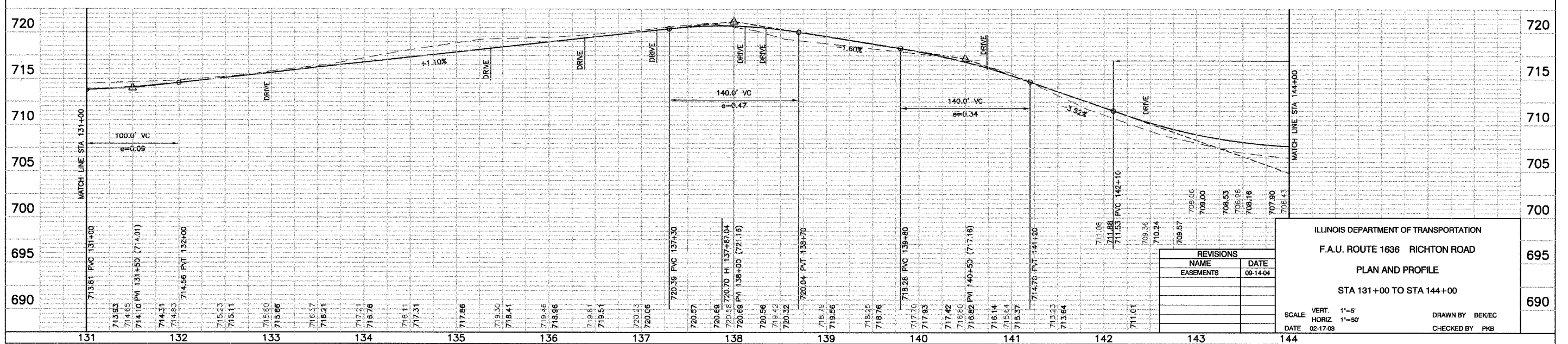

REVISIONS	
NAME	DATE
EASEMENTS	09-14-04

ILLINOIS DEPARTMENT OF TRANSPORTATION
 F.A.U. ROUTE 1636 RICHTON ROAD
 PLAN AND PROFILE
 STA 131+00 TO STA 144+00

SCALE: VERT. 1"=5'
 HORIZ. 1"=50'
 DATE 02-17-03

DRAWN BY BEK/EC
 CHECKED BY PKB