

F.A.U. NO.	SECTION	COUNTY	TOTAL SHEETS	SHEET NO.
1638	92-00037-03-PV	WILL	37	37
STA.	TO STA.			
FED. ROAD DIST. NO.	ALLOYS	FED. AID PROJECT		

83080

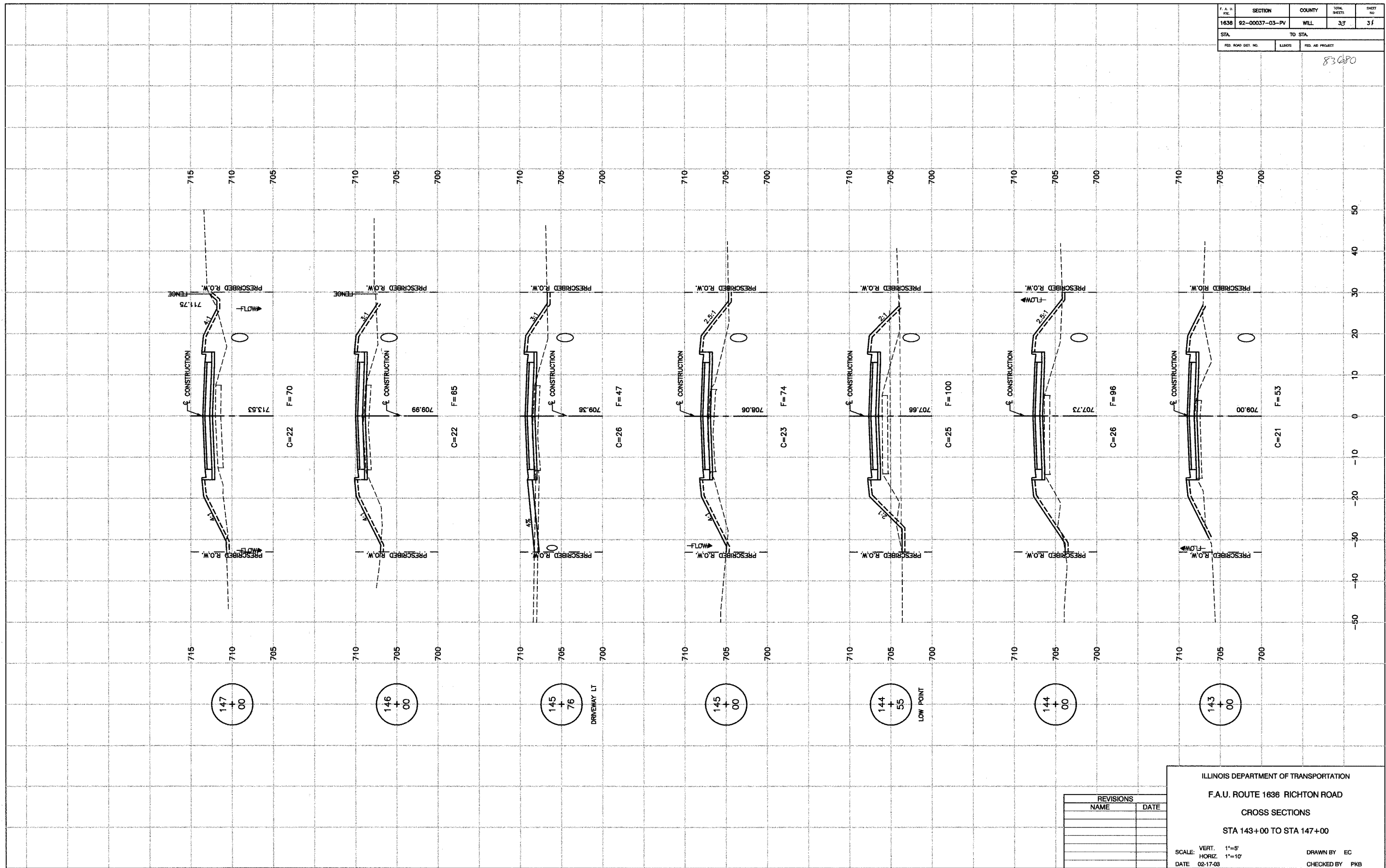

REVISIONS	
NAME	DATE

ILLINOIS DEPARTMENT OF TRANSPORTATION
 F.A.U. ROUTE 1636 RICHTON ROAD
 CROSS SECTIONS
 STA 143+00 TO STA 147+00
 SCALE: VERT. 1"=5'
 HORIZ. 1"=10'
 DATE 02-17-03
 DRAWN BY EC
 CHECKED BY PKB