

F. A. U. R/O.	SECTION	COUNTY	TOTAL SHEETS	SHEET NO.
1636	92-00037-03-PV	WILL	33	32
STA.	TO STA.			
FED. ROAD DIST. NO.	ILLINOIS	FED. AID PROJECT		

83080

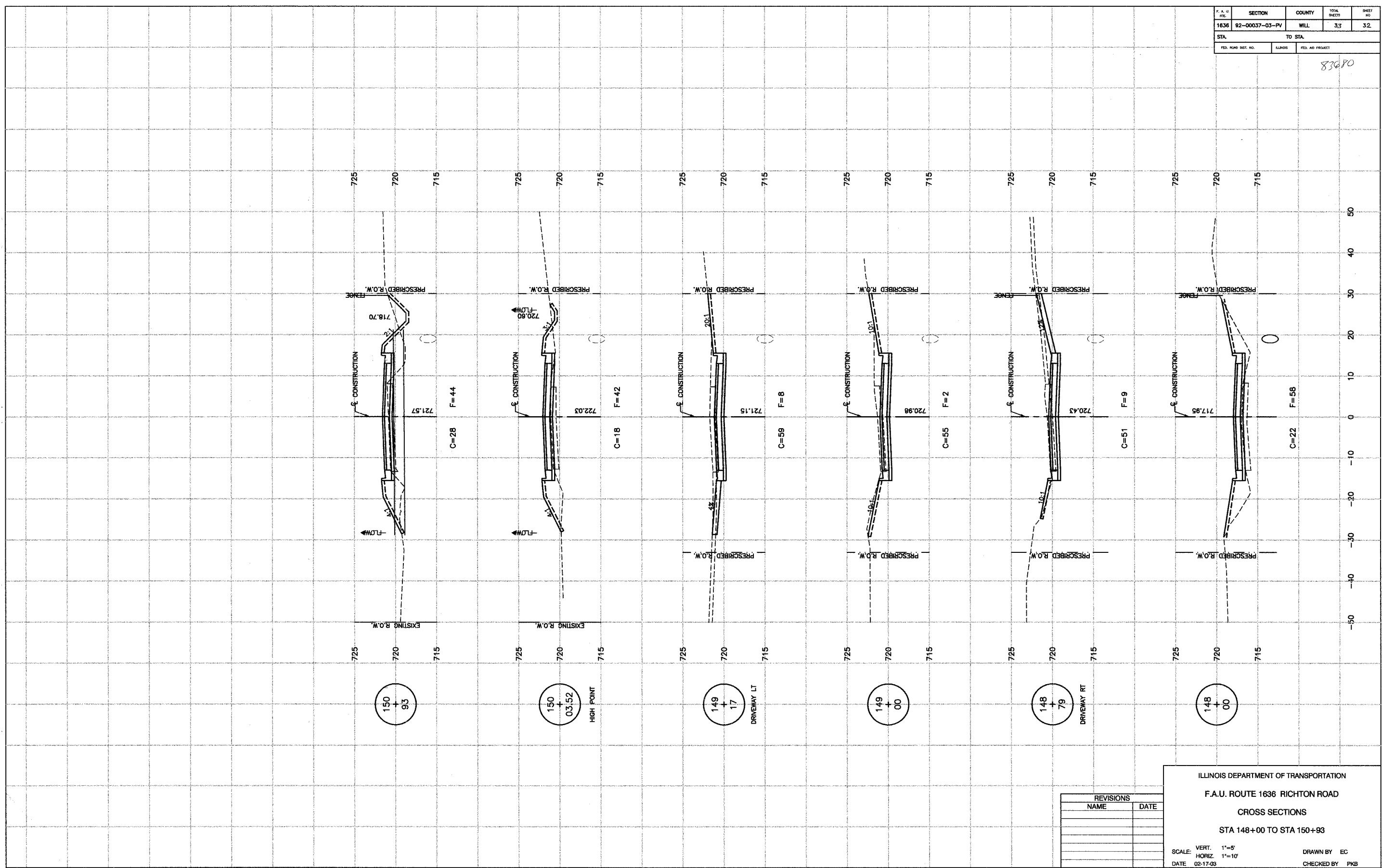

REVISIONS	
NAME	DATE

ILLINOIS DEPARTMENT OF TRANSPORTATION
 F.A.U. ROUTE 1636 RICHTON ROAD
 CROSS SECTIONS
 STA 148+00 TO STA 150+93
 SCALE: VERT. 1"=5'
 HORIZ. 1"=10'
 DATE 02-17-03
 DRAWN BY EC
 CHECKED BY PKB