

F.A.P. ROUTE	COUNTY SECTION	COUNTY	TOTAL SHEET
336	99-00243-00-FV	KANE	268 42
CONTRACT NO. 83782		EROSION CONTROL STAGE 1 RANDALL ROAD	
F.H.W.A. REG.5 ILLINOIS PROJECT F-0336(008)			

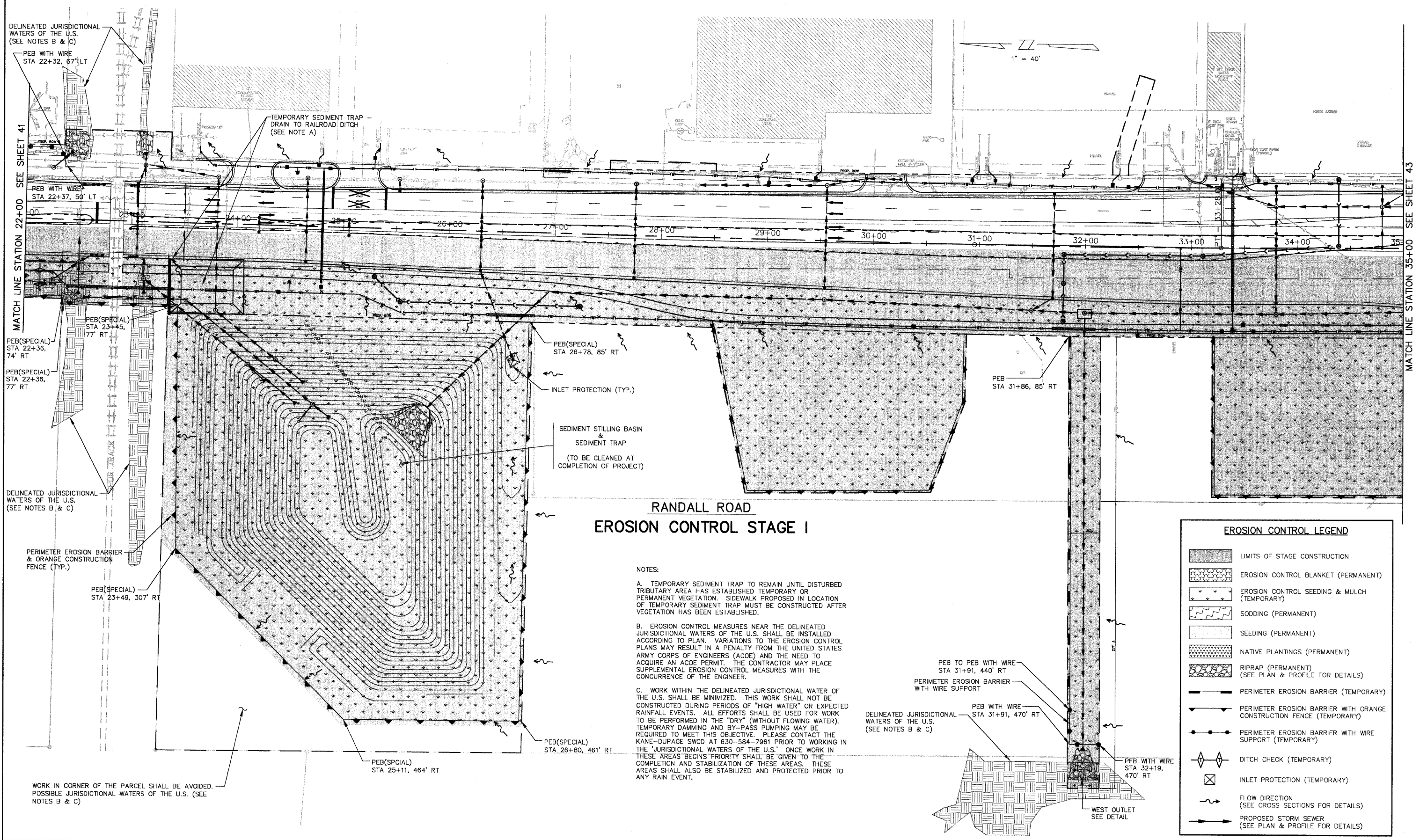

**RANDALL ROAD  
 EROSION CONTROL STAGE I**

**NOTES:**

A. TEMPORARY SEDIMENT TRAP TO REMAIN UNTIL DISTURBED TRIBUTARY AREA HAS ESTABLISHED TEMPORARY OR PERMANENT VEGETATION. SIDEWALK PROPOSED IN LOCATION OF TEMPORARY SEDIMENT TRAP MUST BE CONSTRUCTED AFTER VEGETATION HAS BEEN ESTABLISHED.

B. EROSION CONTROL MEASURES NEAR THE DELINEATED JURISDICTIONAL WATERS OF THE U.S. SHALL BE INSTALLED ACCORDING TO PLAN. VARIATIONS TO THE EROSION CONTROL PLANS MAY RESULT IN A PENALTY FROM THE UNITED STATES ARMY CORPS OF ENGINEERS (ACOE) AND THE NEED TO ACQUIRE AN ACOE PERMIT. THE CONTRACTOR MAY PLACE SUPPLEMENTAL EROSION CONTROL MEASURES WITH THE CONCURRENCE OF THE ENGINEER.

C. WORK WITHIN THE DELINEATED JURISDICTIONAL WATER OF THE U.S. SHALL BE MINIMIZED. THIS WORK SHALL NOT BE CONSTRUCTED DURING PERIODS OF "HIGH WATER" OR EXPECTED RAINFALL EVENTS. ALL EFFORTS SHALL BE USED FOR WORK TO BE PERFORMED IN THE "DRY" (WITHOUT FLOWING WATER). TEMPORARY DAMMING AND BY-PASS PUMPING MAY BE REQUIRED TO MEET THIS OBJECTIVE. PLEASE CONTACT THE KANE-DUPAGE SWCD AT 630-584-7961 PRIOR TO WORKING IN THE JURISDICTIONAL WATERS OF THE U.S. ONCE WORK IN THESE AREAS BEGINS PRIORITY SHALL BE GIVEN TO THE COMPLETION AND STABILIZATION OF THESE AREAS. THESE AREAS SHALL ALSO BE STABILIZED AND PROTECTED PRIOR TO ANY RAIN EVENT.

**EROSION CONTROL LEGEND**

[Pattern]	LIMITS OF STAGE CONSTRUCTION
[Pattern]	EROSION CONTROL BLANKET (PERMANENT)
[Pattern]	EROSION CONTROL SEEDING & MULCH (TEMPORARY)
[Pattern]	SODDING (PERMANENT)
[Pattern]	SEEDING (PERMANENT)
[Pattern]	NATIVE PLANTINGS (PERMANENT)
[Pattern]	RIPRAP (PERMANENT) (SEE PLAN & PROFILE FOR DETAILS)
[Symbol]	PERIMETER EROSION BARRIER (TEMPORARY)
[Symbol]	PERIMETER EROSION BARRIER WITH ORANGE CONSTRUCTION FENCE (TEMPORARY)
[Symbol]	PERIMETER EROSION BARRIER WITH WIRE SUPPORT (TEMPORARY)
[Symbol]	DITCH CHECK (TEMPORARY)
[Symbol]	INLET PROTECTION (TEMPORARY)
[Symbol]	FLOW DIRECTION (SEE CROSS SECTIONS FOR DETAILS)
[Symbol]	PROPOSED STORM SEWER (SEE PLAN & PROFILE FOR DETAILS)

DELINEATED JURISDICTIONAL WATERS OF THE U.S. (SEE NOTES B & C)

MATCH LINE STATION 22+00 SEE SHEET 41

MATCH LINE STATION 35+00 SEE SHEET 43

PEB WITH WIRE STA 22+32, 67' LT  
 PEB WITH WIRE STA 22+37, 50' LT  
 PEB(SPECIAL) STA 22+36, 74' RT  
 PEB(SPECIAL) STA 22+36, 77' RT

DELINEATED JURISDICTIONAL WATERS OF THE U.S. (SEE NOTES B & C)

PERIMETER EROSION BARRIER & ORANGE CONSTRUCTION FENCE (TYP.)

PEB(SPECIAL) STA 23+45, 77' RT

WORK IN CORNER OF THE PARCEL SHALL BE AVOIDED. POSSIBLE JURISDICTIONAL WATERS OF THE U.S. (SEE NOTES B & C)

TEMPORARY SEDIMENT TRAP - DRAIN TO RAILROAD DITCH (SEE NOTE A)

PEB(SPECIAL) STA 26+78, 85' RT

INLET PROTECTION (TYP.)

SEDIMENT STILLING BASIN & SEDIMENT TRAP (TO BE CLEANED AT COMPLETION OF PROJECT)

PEB(SPECIAL) STA 26+80, 461' RT

PEB(SPECIAL) STA 25+11, 464' RT

PEB STA 31+86, 85' RT

PEB TO PEB WITH WIRE STA 31+91, 440' RT

PERIMETER EROSION BARRIER WITH WIRE SUPPORT

DELINEATED JURISDICTIONAL WATERS OF THE U.S. (SEE NOTES B & C)

PEB WITH WIRE STA 31+91, 470' RT

PEB WITH WIRE STA 32+19, 470' RT

WEST OUTLET SEE DETAIL

1" = 40'