

DRAINAGE STRUCTURE TABLE STA. 51+50 TO STA. 56+50

NO.	STA.	OFFSET	STRUCTURE TYPE/SIZE	FRAME & GRATE	RIM ELEV EPI/FR	INVERT (N)	INVERT (S)	INVERT (E)	INVERT (W)
198	52+20	8' LT	A 4		11V 784.30				780.30
199	52+20	8' RT	A 4		11V 784.30			780.15	780.05
200	52+20	54' RT	A 5		1C 784.50	788.43	788.53	779.59	
201	53+20	44' LT	A 4		24 784.56				780.56
202	53+20	8' LT	A 4		11V 784.80			780.19	780.09
203	53+20	CL	A 4		8 785.10			780.02	779.92
204	53+20	8' RT	A 4		11V 784.80			779.85	779.75
205	53+20	44' RT	A 4		24 784.56			779.38	779.28
206	53+20	54' RT	A 5		1C 784.90	789.43	789.53	779.15	
207	54+20	8' LT	A 4		11V 785.30				781.30
208	54+20	4.88' RT	A 4		11V 785.24			781.19	781.09
209	54+20	57' RT	A 5		1C 784.80	770.43	770.53	780.57	778.64
210	54+20	73' RT	C 2		8 782.80				778.80
211	55+20	44' LT	A 4		24 785.56				781.56
212	55+20	8' LT	A 4		11V 785.80			781.19	781.09
213	55+20	1.12' LT	A 4		11V 785.62			781.04	780.94
214	55+20	53.12' RT	A 4		24 785.33			780.39	780.29
215	55+20	85' RT	A 5		1C 785.10	771.43	771.53	780.13	
216	56+10	8' LT	A 4		11V 786.25			782.16	
217	56+20	4' LT	A 4		11V 786.06			782.06	781.96
218	56+20	86' RT	A 5		1C 786.00	771.78	771.78	781.25	

MATCH LINE STA. 51+50 SHEET NO. 96

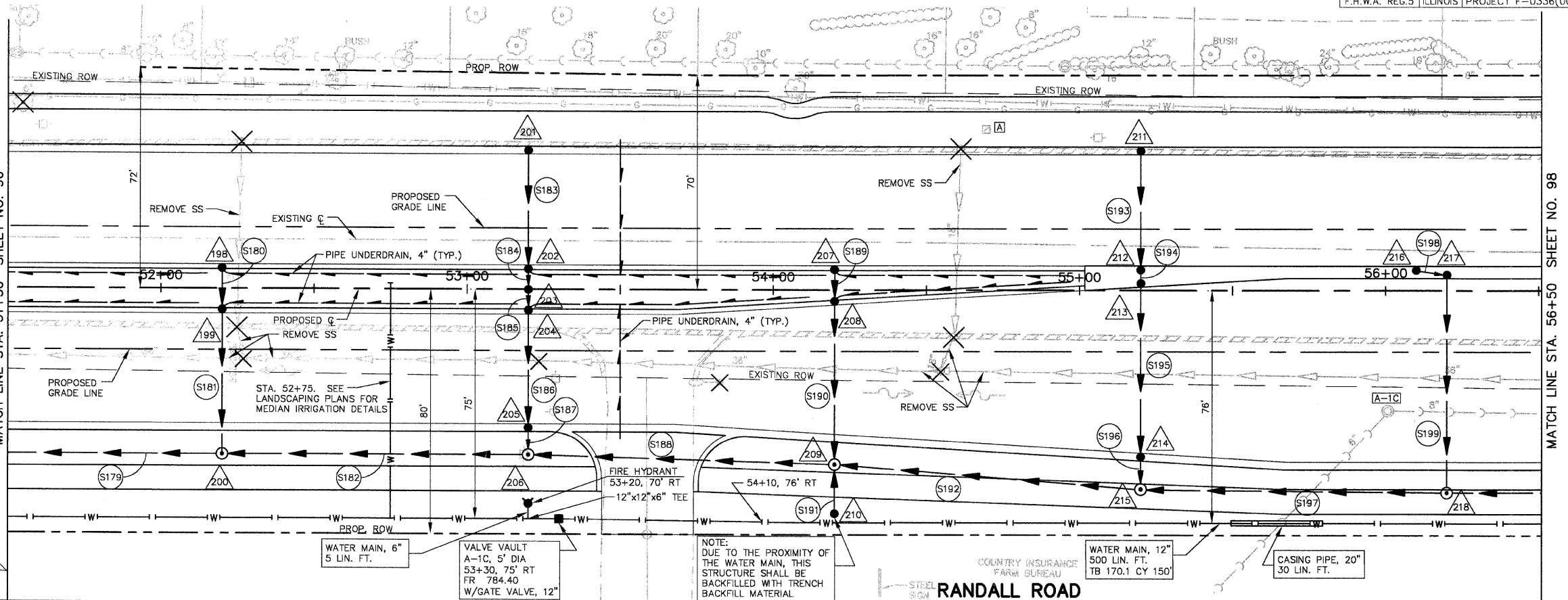

MATCH LINE STA. 56+50 SHEET NO. 98

SCALE: 1" = 20'

PIPE TABLE STA. 51+50 TO STA. 56+50

PIPE NO.	LOCATION FROM STR #	LOCATION TO STR #	DESCRIPTION	DIA (IN)	L (FT)	S (%)	TRENCH BACKFILL	
							L (FT)	VOL (CY)
S179	200	197	SS 3 RCCP CL IV	42	100	0.90	100	351.1
S180	198	199	SS 1 RCCP CL IV	12	15	1.00	4	0.6
S181	199	200	SS 2 RCCP CL IV	12	46	1.00	41	5.4
S182	206	200	SS 3 RCCP CL IV	42	100	0.90	100	340.4
S183	201	202	SS 2 RCCP CL IV	12	37	1.00	37	4.9
S184	202	203	SS 2 RCCP CL IV	12	7	1.00	2	0.5
S185	203	204	SS 2 RCCP CL IV	12	7	1.00	2	0.5
S186	204	205	SS 2 RCCP CL IV	12	37	1.00	37	6.4
S187	205	206	SS 2 RCCP CL IV	12	9	1.44	2	1.5
S188	209	206	SS 3 RCCP CL IV	42	100	0.90	100	312.4
S189	207	208	SS 1 RCCP CL IV	12	11	1.00	2	0.3
S190	208	209	SS 2 RCCP CL IV	12	52	1.00	47	6.2
S191	210	209	SS 2 RCCP CL IV	12	16	1.00	12	4.6
"O" RING								
S192	215	209	SS 3 RCCP CL IV	42	100	0.90	100	286.8
S193	211	212	SS 2 RCCP CL IV	12	37	1.00	37	4.9
S194	212	213	SS 2 RCCP CL IV	12	5	1.00	5	0.7
S195	213	214	SS 2 RCCP CL IV	12	55	1.00	55	7.3
S196	214	215	SS 2 RCCP CL IV	12	11	1.44	2	0.8
S197	218	215	SS 2 RCCP CL IV	42	100	0.25	100	275.8
S198	216	217	SS 1 RCCP CL IV	12	10	1.00	10	1.3
S199	217	218	SS 2 RCCP CL IV	12	71	1.00	71	9.4

