

SIGN SCHEDULE - STA. 42+00 TO STA. 64+50  
 SIGN SCHEDULE - STA. 449+00 TO STA. 451+25

NO.	STATION	OFFSET	SIGN TYPES	SUPPL. INFO.	TOTAL SIGN AREA	POST TYPE	TOTAL POST LENGTH
34	43+00	56' RT	W4-2R	-	9.0	LP	-
35	43+00	85' LT	R3-5R	-	7.5	LP	-
36	43+75	10' RT	R3-5L (MOD)	-	12.0	2T	20.0
37	44+80	56' RT	R2-1	"45"	7.5	LP	-
38	44+80	56' LT	R3-8B	3 THRU	12.5	LP	-
39	48+40	52' LT	W3-3 & W16-8	"IL ROUTE 64 MAIN STREET"	14.0	LP	-
40	48+40	51' RT	W9-1	-	9.0	LP	-
41	52+00	50' RT	W2-1 & W16-8	"OAK STREET"	13.0	LP	-
42	53+80	50' LT	R2-1	"45"	7.5	LP	-
43	55+60	61' RT	R3-5R	-	7.5	LP	-
44	450+70	44' LT	R1-1	-	5.2	1T	10.0
45	449+37	33' RT	R1-1	-	5.2	1T	10.0
46	61+80	37' RT	R2-1	"45"	7.5	2T	21.0
47	65+80	44' LT	W2-1 & W16-8	"OAK STREET"	13.0	2T	23.0
48-49	NOT USED						

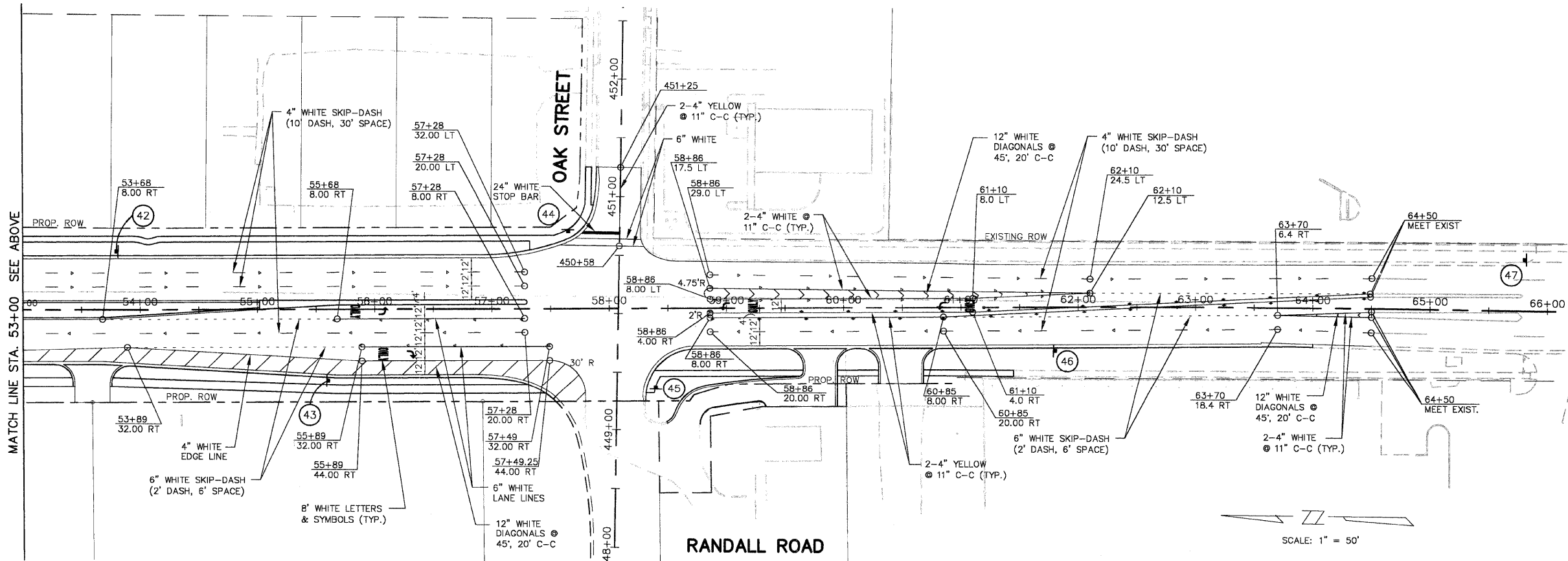

FOR PAVEMENT MARKING AND SIGNING NOTES AND LEGEND. SEE SHEET 113.