

| | | | |
|---|----------------|--------|-------------|
| F.A.P. ROUTE | COUNTY SECTION | COUNTY | TOTAL SHEET |
| 336 | 99-00243-00-PV | KANE | 268 |
| CONTRACT NO. 83782 | | | 145 |
| LIGHTING PLAN | | | |
| F.H.W.A. REG.5 ILLINOIS PROJECT F-0336(008) | | | |

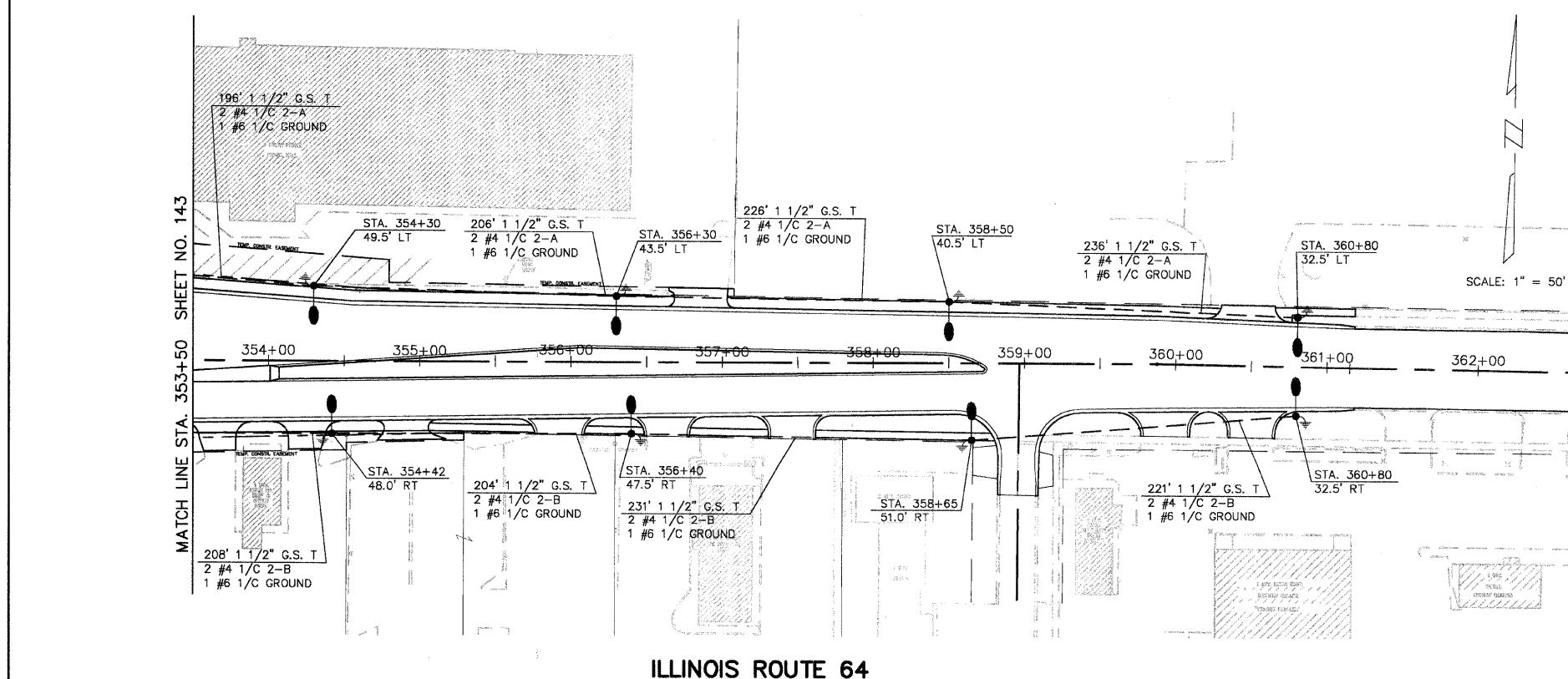

LEGEND

- PROPOSED LIGHT STANDARD WITH 310 WATT LUMINAIRE
- PROPOSED COMBINATION MAST ARM ASSEMBLY AND POLE WITH 400 WATT LUMINAIRE
- PROPOSED COMBINATION MAST ARM ASSEMBLY AND POLE WITH TWO LIGHTING MAST ARMS WITH 400 WATT LUMINAIRES
- PROPOSED LIGHTING CONTROLLER
- PROPOSED HANDHOLE
- GROUND ROD
- PROPOSED GFCI FESTOON OUTLET
- GALVANIZED STEEL CONDUIT IN TRENCH (T), IN COMMON TRENCH (CT), EMBEDDED (EM), OR PUSHED (P) OF THE SIZE SPECIFIED WITH THE NUMBER AND SIZE OF CABLES SPECIFIED. CONDUIT LENGTHS INCLUDE 3 FEET OF VERTICAL CONDUIT AT EACH LIGHT STANDARD.
- EXISTING LIGHT STANDARD
- EXISTING LIGHT STANDARD TO BE REMOVED

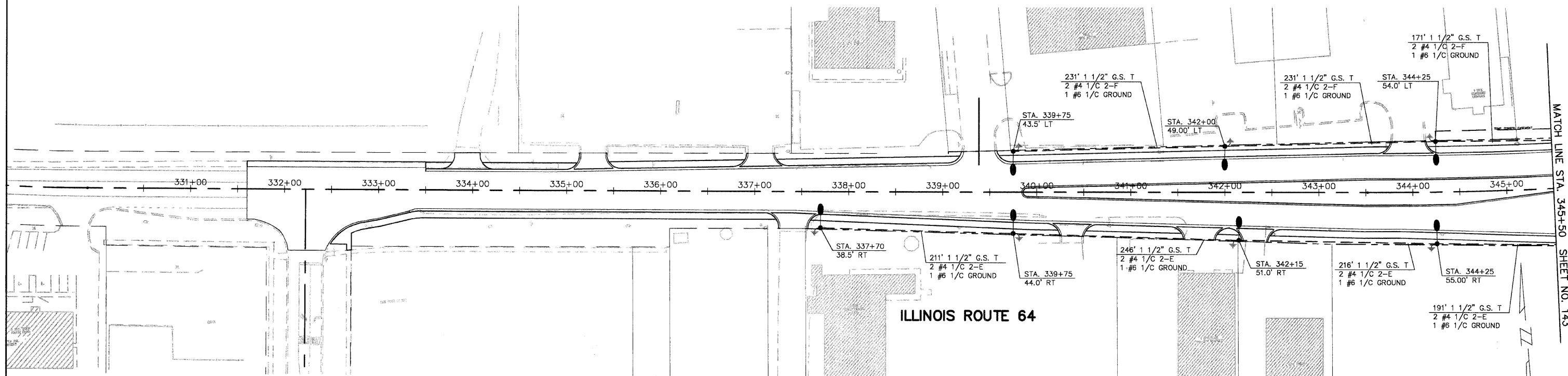
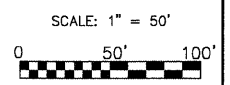

| REVISIONS | |
|----------------|---------|
| NAME | DATE |
| PER BEG REVIEW | 10-7-04 |
| | |
| | |
| | |

STREET LIGHTING PLAN

STATION 330+00 TO 360+00

MAIN STREET (ILLINOIS ROUTE 64)

SCALE: AS SHOWN
 DATE: 5-26-04

DRAWN BY: JMH
 CHECKED BY: DAY