

F.A.P. ROUTE	COUNTY SECTION	COUNTY	TOTAL SHEET
336	99-00243-00-PV	KANE	268
	CONTRACT NO.		230
	83782		
CROSS SECTION STA. 45+50 TO STA. 47+00			
F.H.W.A. REG 5 ILLINOIS PROJECT F-0336(008)			

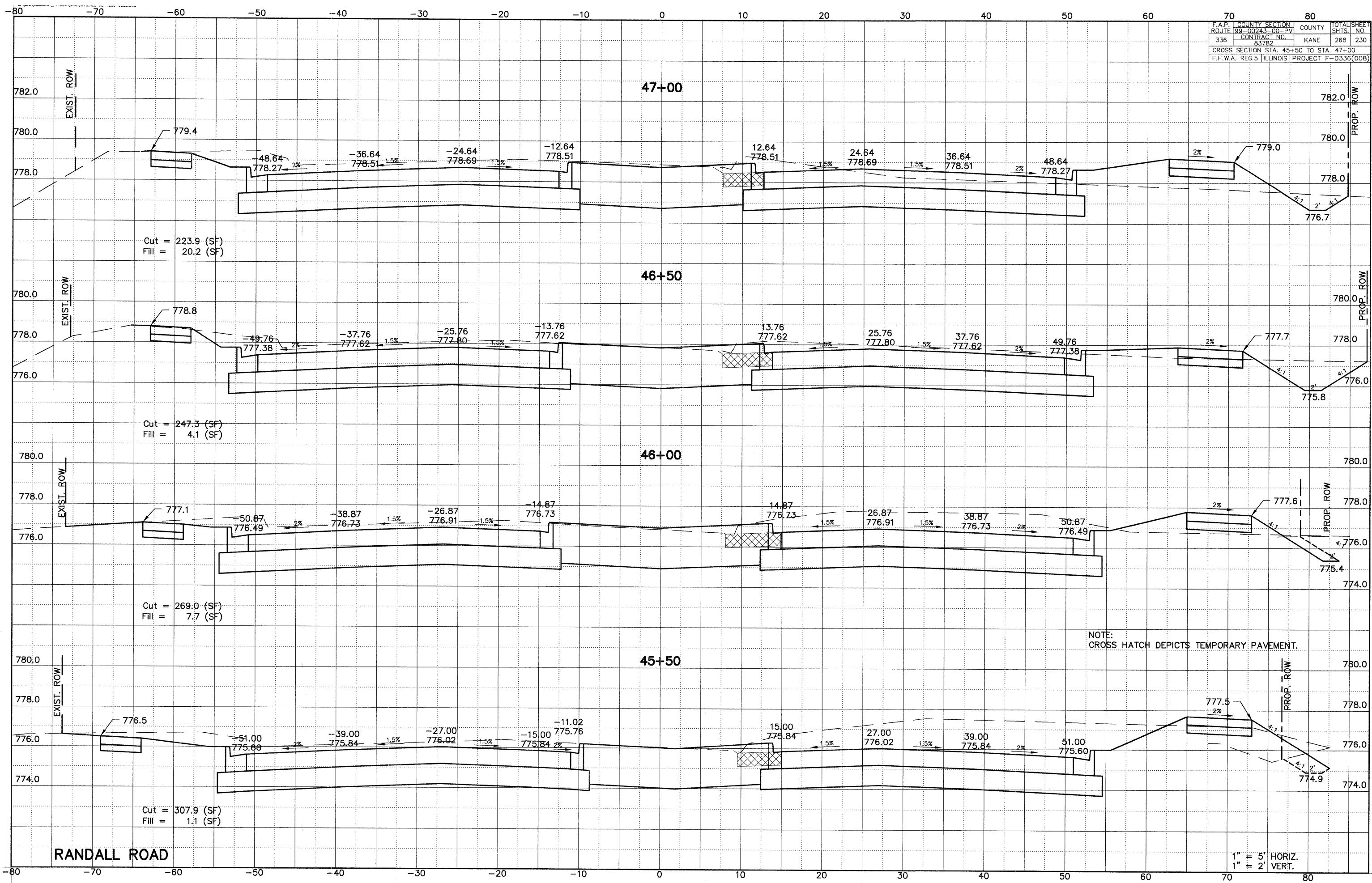

NOTE:
CROSS HATCH DEPICTS TEMPORARY PAVEMENT.

RANDALL ROAD

1" = 5' HORIZ.
1" = 2' VERT.