

F.A.P. COUNTY SECTION	ROUTE 99-00243-00-PV	COUNTY	TOTAL SHEET
336	CONTRACT NO. 83782	KANE	SHTS. NO. 268 244
CROSS SECTION STA. 336+50 TO STA. 337+50			
F.H.W.A. REG.5 ILLINOIS PROJECT F-0336(008)			

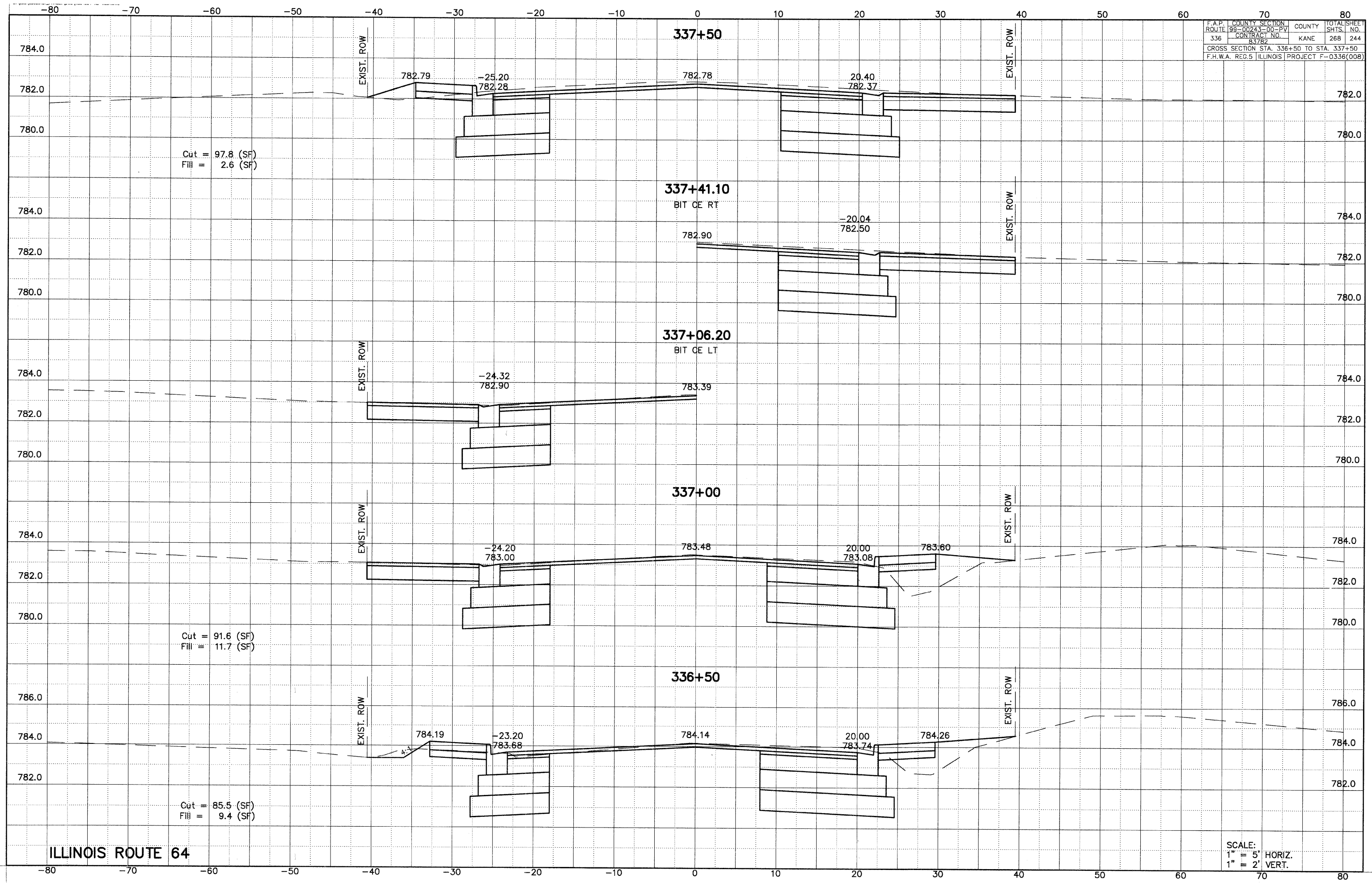

ILLINOIS ROUTE 64

SCALE:  
1" = 5' HORIZ.  
1" = 2' VERT.