

F.A.P. ROUTE	COUNTY	SECTION	TOTAL SHEET
336	KANE	98-00243-00-PV	268
CONTRACT NO.		SHTS. NO.	
83782		249	
CROSS SECTION STA. 343+97.8 TO STA. 345+00			
F.H.W.A. REG.5 ILLINOIS PROJECT F-0336(008)			

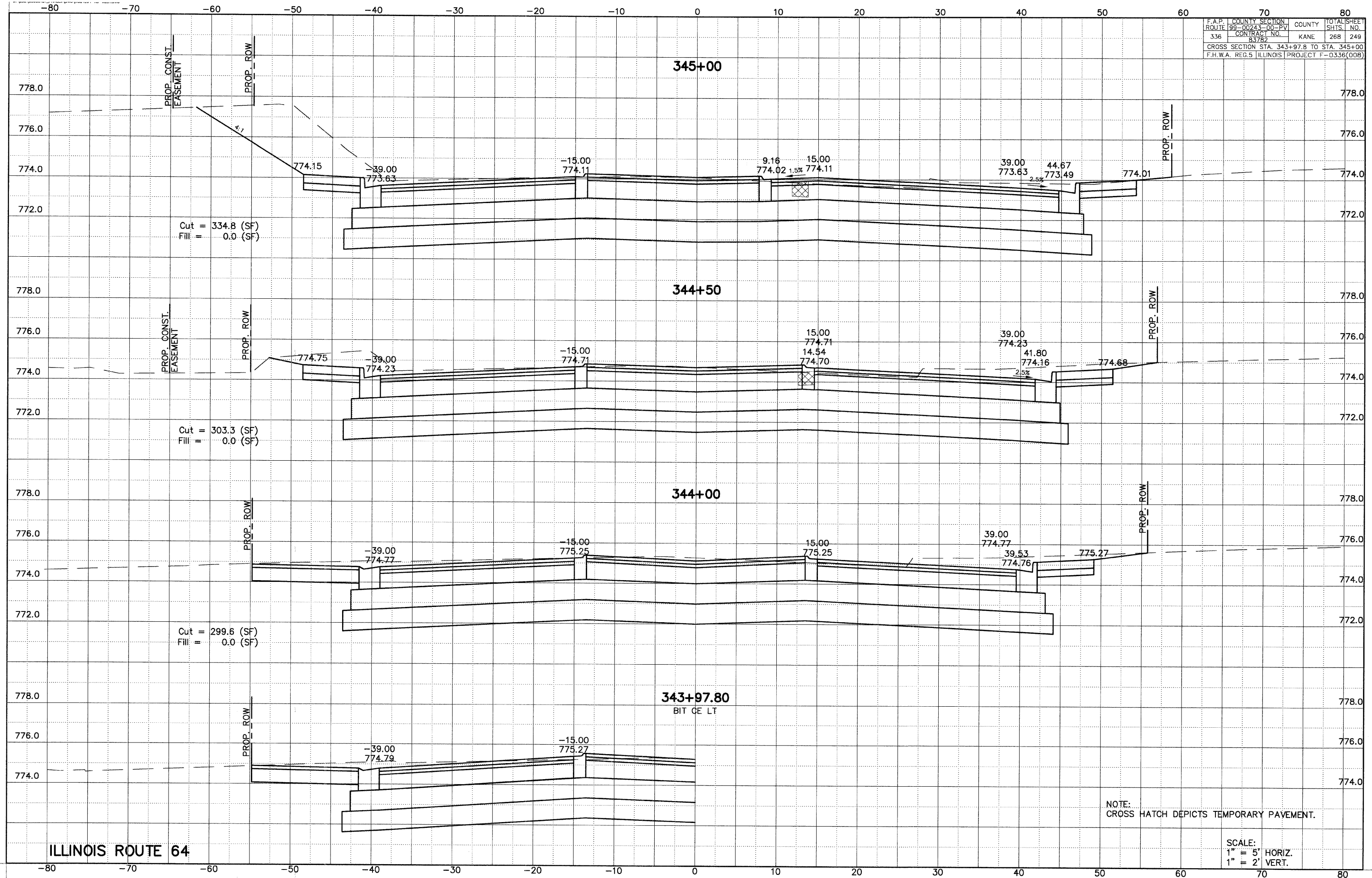

ILLINOIS ROUTE 64