

F.A.U. RTE.	SECTION	COUNTY	TOTAL SHEETS	SHEET NO.
2802	05-00026-00-SW	COOK	9	1
STA. 10+50		TO STA. 36+47		
FED. ROAD DIST. NO.		ILLINOIS	FED. AID PROJECT	
CONTRACT NO. 83804				

**INDEX TO SHEETS:**

SHEET NO.	DESCRIPTION
1.	COVER SHEET
2.	GENERAL NOTES - SUMMARY OF QUANTITIES
3.	TYPICAL SECTIONS
4-6.	SIDEWALK PLAN
7.	CURB OR CURB AND GUTTER REMOVAL AND REPLACEMENT
8.	TRAFFIC CONTROL AND PROTECTION FOR SIDE ROADS, INTERSECTIONS AND DRIVEWAYS
9.	CROSS SECTIONS

STATE OF ILLINOIS  
DEPARTMENT OF TRANSPORTATION  
DIVISION OF HIGHWAYS

# PLANS FOR PROPOSED FEDERAL AID HIGHWAY

F.A.U. ROUTE 2802 (SAYRE AVENUE)  
SIDEWALK CONSTRUCTION 79TH STREET TO 75TH STREET  
SECTION NO. 05-00026-00-SW  
PROJECT NO: CMM-8003(497)  
JOB NO: C-91-163-05  
VILLAGE OF BEDFORD PARK, COOK COUNTY

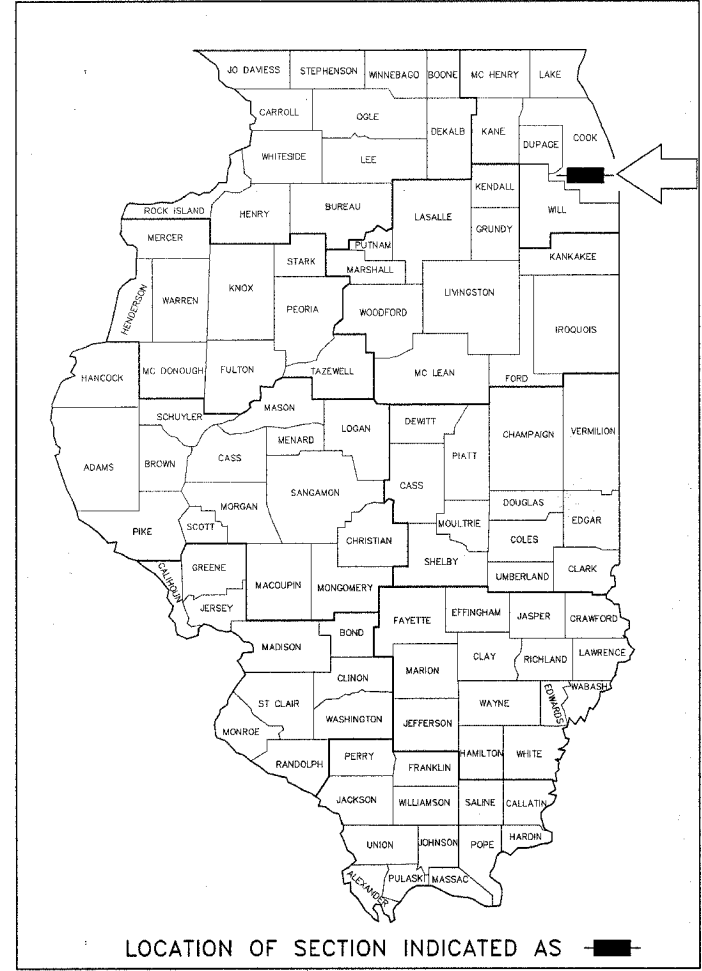

**LIST OF STATE STANDARDS:**

STANDARD NO.	DESCRIPTION
000001-04:	STANDARD SYMBOLS, ABBREVIATIONS AND PATTERNS
424001-03:	SIDEWALK RAMPS ACCESSIBLE TO THE DISABLED
606001-02:	CONCRETE CURB, AND COMBINATION CONCRETE CURB AND GUTTER
702001-05:	TRAFFIC CONTROL DEVICES
701501-03:	URBAN LANE CLOSURE, 2L, 2W, UNDIVIDED
701801-03:	LANE CLOSURE, MULTILANE 1W OR 2W CROSSWALK OR SIDEWALK CLOSURE

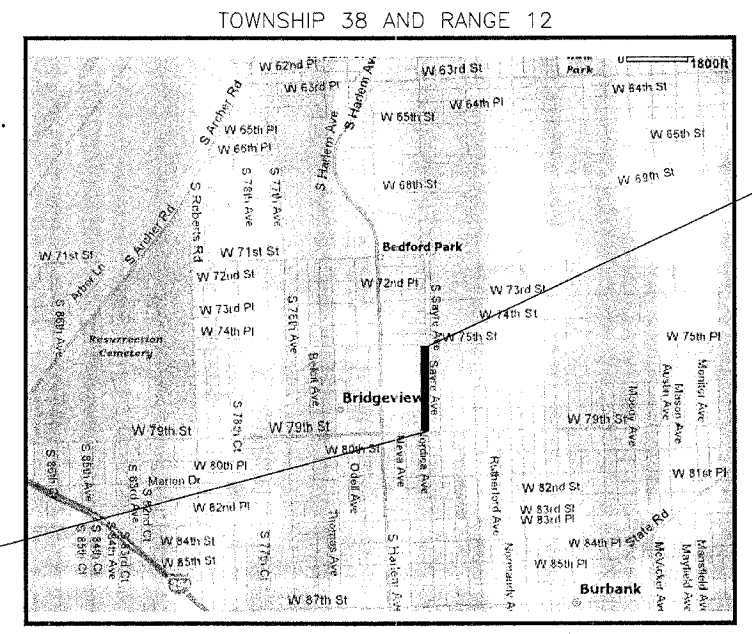

PROJECT ENDS AT STA. 36+47

PROJECT BEGINS AT STA. 10+50

**TRAFFIC DATA**  
ADT = 10,000  
SPEED LIMIT = 30 MPH

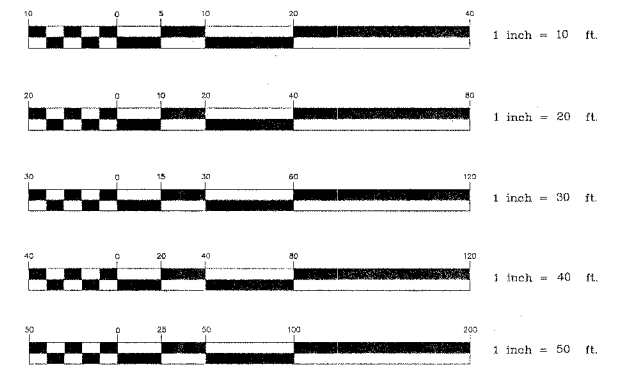

FULL SIZE PLANS HAVE BEEN PREPARED USING STANDARD ENGINEERING SCALES. REDUCED SIZED PLANS WILL NOT CONFORM TO STANDARD SCALES, IN MAKING MEASUREMENTS ON REDUCED PLANS, THE ABOVE SCALES MAY BE USED

J.U.L.I.E.  
JOINT UTILITY LOCATION FOR EXCAVATION  
1-800-892-0123

CONTRACT NO. 83804

GROSS LENGTH OF PROJECT 2598 FEET (0.49 MILES)  
NET LENGTH OF PROJECT 2598 FEET (0.49 MILES)

STATE OF ILLINOIS  
DEPARTMENT OF TRANSPORTATION  
DIVISION OF HIGHWAYS

APPROVED 6/1 20 05  
*David R. Pandy* LOCAL AGENCY OFFICIAL

APPROVED 6/2 20 05  
*Chapman* ENGINEER OF LOCAL ROADS AND STREETS

APPROVED June 6, 20 05  
*Diana O'Keefe/AP* DISTRICT ENGINEER

**hbe Hoeffler-Butler Engineering, Inc.**  
Consulting Civil Engineers - Land Surveyors  
PROFESSIONAL DESIGN FIRM LICENSE NO. 104-000819  
6714 S. ROBERTS ROAD HECKY HILLS, ILLINOIS 60457  
(708) 599-8980 FAX (708) 599-8790

STEPHEN A. LEIBER  
38352 REGISTERED PROFESSIONAL ENGINEER OF ILLINOIS  
EXPIRES 11-30-05  
*Stephen A. Leiber*  
SIGNATURE  
6/1/05  
DATE

FEDERAL-AID DESIGN ENGINEER: ABIGAIL BRINKS (847) 705-4233  
CONSULTANT: HOFFERLE-BUTLER ENGINEERING, INC. (708) 599-8980

F.A.U. RTE.	SECTION	COUNTY	TOTAL SHEETS	SHEET NO.
2802	05-00026-00-SW	COOK	9	2
STA. 10+50		TO STA. 36+47		
FED. ROAD DIST. NO.		ILLINOIS	FED. AID PROJECT	
CONTRACT NO. 83804				

## GENERAL NOTES

### UTILITIES

THE CONTRACTOR SHALL BE RESPONSIBLE FOR CONTACTING THE OWNER OF ALL EXISTING FACILITIES SO THAT THE UTILITIES AND THEIR APPURTENANCES MAY BE LOCATED AND ADJUSTED OR MOVED, IF NECESSARY, PRIOR TO THE START OF CONSTRUCTION OPERATIONS. THE CONTRACTORS SHALL COOPERATE WITH ALL UTILITY OWNERS AS PROVIDED FOR IN THE STANDARD SPECIFICATIONS.

THE LOCATIONS OF EXISTING DRAINAGE STRUCTURES, STORM AND SANITARY SEWERS, WATER SERVICE LINES AND OTHER UTILITY LINES ARE APPROXIMATE, AND THE VILLAGE DOES NOT GUARANTEE THEIR ACCURACY. THEIR EXACT HORIZONTAL AND VERTICAL LOCATIONS ARE TO BE DETERMINED IN THE FIELD BY THE CONTRACTOR AT HIS OWN EXPENSE.

THE CONTRACTOR SHALL BE RESPONSIBLE FOR THE PROTECTION OF ALL UNDERGROUND OR SURFACE UTILITIES EVEN THOUGH THEY MAY NOT BE SHOWN ON THE PLANS. ANY UTILITY THAT IS DAMAGED DURING CONSTRUCTION SHALL BE REPAIRED OR REPLACED TO THE SATISFACTION OF THE ENGINEER OR THE VILLAGE. THIS WORK SHALL BE AT THE CONTRACTORS EXPENSE.

COORDINATION OF ALL UTILITY WORK INVOLVED IN THE CONSTRUCTION AREA WILL BE DISCUSSED AT THE PRECONSTRUCTION CONFERENCE.

BEFORE STARTING ANY EXCAVATION, THE CONTRACTOR SHALL CALL "JULIE" AT 800-852-0123 FOR FIELD LOCATIONS OF BURIED ELECTRIC, TELEPHONE, GAS AND CABLE TELEVISION FACILITIES. (48 HOURS NOTIFICATION IS REQUIRED.)

### STORM SEWER

WHENEVER, DURING CONSTRUCTION OPERATIONS, ANY LOOSE MATERIAL IS DEPOSITED IN THE FLOW LINE OF DRAINAGE STRUCTURES SUCH THAT THE NATURAL FLOW OF WATER IS OBSTRUCTED, IT SHALL BE REMOVED AT THE CLOSE OF EACH WORKING DAY. AT THE CONCLUSION OF CONSTRUCTION OPERATIONS, ALL UTILITY STRUCTURES SHALL BE FREE FROM DIRT AND DEBRIS. THE WORK SPECIFIED ABOVE WILL NOT BE PAID FOR SEPARATELY BUT SHALL BE INCLUDED IN THE COST FOR CATCH BASINS TO BE ADJUSTED.

ANY EXISTING OR PROPOSED STORM SEWER DAMAGED BY THE CONTRACTOR DURING CONSTRUCTION SHALL BE REPLACED BY THE CONTRACTOR AT NO COST TO THE VILLAGE.

### RESTORATION

CONTRACTOR IS TO RESTORE ALL UNPAVED AREAS DAMAGED DURING CONSTRUCTION OPERATIONS TO THEIR ORIGINAL CONDITION INCLUDING THE FINE GRADING AND SODDING OF AREAS WITHIN EASEMENTS AND RIGHTS-OF-WAY.

### MISCELLANEOUS

ACCESS: THE CONTRACTOR SHALL PROVIDE ACCESS TO ADJUTING PROPERTY AT ALL TIMES DURING THE CONSTRUCTION OF THIS PROJECT, EXCEPT FOR PERIODS OF SHORT DURATION, THE COST TO PROVIDE ACCESS SHALL BE PAID FOR AS AGGREGATE SURFACE COURSE, TYPE B.

DIMENSIONS: IT SHALL BE THE CONTRACTOR'S RESPONSIBILITY TO VERIFY ALL DIMENSIONS AND CONDITIONS EXISTING IN THE FIELD PRIOR TO ORDERING MATERIALS AND BEGINNING CONSTRUCTION.

ALL SAWCUTTING SHALL BE INCLUDED IN THE UNIT OF COST OF REMOVAL ITEMS AND SHALL BE PERFORMED PRIOR TO BEGINNING REMOVAL. ANY ITEMS OF WORK REMOVED PRIOR TO SAWCUTTING WILL NOT BE MEASURED FOR PAYMENT.

BARRICADES: THE CONTRACTOR SHALL PROVIDE AND INSTALL TWO (2) WEIGHTED SAND BAGS ON EACH TYPE I OR TYPE II BARRICADE USED. (ONE (1) WEIGHTED SAND BAG ACROSS EACH BOTTOM RAIL.)

AGGREGATE BASE WILL BE INCLUDED IN THE UNIT COST OF "P.C.C. SIDEWALK"

AGGREGATE BASE WILL BE INCLUDED IN THE UNIT COST OF "BITUMINOUS CONCRETE SURFACE COURSE"

ANY EXISTING PAVEMENT DAMAGED BY THE CONTRACTOR DURING THE CONSTRUCTION SHALL BE REPLACED/REPAIRED BY THE CONTRACTOR AT HIS/HERS OWN EXPENSE TO THE SATISFACTION OF THE ENGINEER WITH NO ADDITIONAL COMPENSATION TO THE CONTRACTOR.

PAY ITEMS IN THE SUMMARY OF QUANTITIES HAVE BEEN ESTIMATED, IF, IN THE ENGINEER'S OPINION, THE WORK IS NOT REQUIRED, THE ITEM WILL BE DEDUCTED FROM THE CONTRACT AND NO ADDITIONAL COMPENSATION WILL BE ALLOWED.

HOEFFERLE-BUTLER ENGINEERING SHALL BE NOTIFIED AT LEAST TWO (2) WORKING DAYS PRIOR TO THE COMMENCEMENT OF WORK. THEY SHALL BE NOTIFIED AT LEAST 72 HOURS IN ADVANCE IF CONSTRUCTION STAKING IS REQUIRED.

## SUMMARY OF QUANTITIES

ITEM #	ITEMS	UNITS	QUANTITY	SFTY- 1B
20200100	EARTH EXCAVATION	C.Y.	298.71	298.71
21101615	TOPSOIL FURNISH AND PLACE 4"	S.Y.	1607.00	1607.00
25000400	NITROGEN FERTILIZER NUTRIENT	POUND	19.90	19.90
25000500	PHOSPHOROUS FERTILIZER NUTRIENT	POUND	19.90	19.90
25000600	POTASSIUM FERTILIZER NUTRIENT	POUND	19.90	19.90
25200110	SODDING, SALT TOLERANT	S.Y.	1607.00	1607.00
25300600	TRANSPLANTED SALVAGED TREES	EACH	7.00	7.00
40200800	AGGREGATE SURFACE COURSE, TYPE B	TON	60.00	60.00
42400200	PORTLAND CEMENT CONCRETE SIDEWALK, 5 INCH	S.F.	12040.00	12040.00
42400410	PORTLAND CEMENT CONCRETE SIDEWALK, 8 INCH	S.F.	310.00	310.00
44000200	DRIVEWAY PAVEMENT REMOVAL	S.Y.	76.00	76.00
44001700	COMBINATION CONCRETE CURB AND GUTTER REMOVAL AND REPLACEMENT.	FOOT	30.00	30.00
56400100	FIRE HYDRANTS TO BE MOVED	EACH	3.00	3.00
67100100	MOBILIZATION	L.S.	1.00	1.00
70102630	TRAFFIC CONTROL AND PROTECTION			
	STD. 701501	L.S.	1.00	1.00
70102640	TRAFFIC CONTROL AND PROTECTION			
	STD. 701801	L.S.	1.00	1.00
78000400	EPOXY PAVEMENT MARKING-LINE 6"	FOOT	131.00	131.00
X0322924	RETAINING WALL REMOVAL	S.F.	75.00	75.00
X4066414	BITUMINOUS CONCRETE SURFACE COURSE,			
	SUPERPAVE, 3" MIX C, N50	TON	6.00	6.00
42400900	DETECTABLE WARNINGS	S.F.	70.00	70.00

## TRANSPLANTED TREE SCHEDULE

WIDTH (INCHES)	EXISTING		PROPOSED	
	STATION	OFFSET (FT)	STATION	OFFSET (FT)
4	27+92	27	27+82	20
4	28+56	27	29+56	20
4	29+23	27	29+23	20
6	31+62	27	31+62	20
6	32+23	28	32+23	20
6	33+65	27	33+65	20
4	35+35	36	35+35	44.5

## EARTHWORK SCHEDULE OF QUANTITIES

LOCATION	REMOVE AND DISPOSE OF UNSUITABLE MATERIAL (PCES) (CU YD)	REMOVE AND DISPOSE OF UNSUITABLE MATERIAL (TOPSOIL) (CU YD)	EARTH EXCAVATION (CU YD)	TOTAL SUITABLE EXCAVATION (CU YD)	EXCAVATION TO BE USED IN EMBANKMENT (ADJUST FOR 15% SHRINKAGE) (CU YD)	EMBANKMENT (CU YD)	EARTHWORK BALANCE WASTE (+) OR SHORTAGE (-) (CU YD)
27+65 - 28+00	0	0	17.75	17.75	0	0	+17.75
28+00 - 28+50	0	0	34.87	34.87	0	0	+34.87
28+50 - 29+00	0	0	36.38	36.38	0	0	+36.38
29+00 - 29+50	0	0	26.97	26.97	0	0	+26.97
29+50 - 29+65.7	0	0	4.03	4.03	0	0	+3.93
30+80.11 - 31+00	0	0	5.15	5.15	0	0	+3.96
31+00 - 31+50	0	0	29.83	29.83	0	0	+28.18
31+50 - 32+00	0	0	38.67	38.67	0	0	+38.67
32+00 - 32+50	0	0	35.96	35.96	0	0	+35.96
32+50 - 32+51.8	0	0	1.4	1.4	0	0	+1.4
33+12.59 - 33+50	0	0	20.27	20.27	0	0	+20.27
33+50 - 34+00	0	0	42.41	42.41	0	0	+42.41
34+00 - 34+10	0	0	5.02	5.02	0	0	+5.02
TOTAL	0	0	298.71	298.71	0	0	+298.77

**Hoeflerle-Butler Engineering, Inc.**  
 Consulting Civil Engineers - Land Surveyors  
 PROFESSIONAL DESIGN FIRM LICENSE NO. 04-000009  
 8714 S. ROBERTS ROAD ROCKFORD, ILLINOIS 61007  
 (815) 399-8986 FAX (815) 399-8796

REVISIONS	NAME	DATE
PER IDOT REVIEW		05/20/05
PER IDOT REVIEW		05/31/05

ILLINOIS DEPARTMENT OF TRANSPORTATION  
 VILLAGE OF BEDFORD PARK  
 SAYRE AVE., 75TH ST.-79TH ST.  
 SIDEWALK CONSTRUCTION

SUMMARY OF QUANTITIES AND GENERAL NOTES  
 HORIZ: 1"=20'  
 DATE: 03/14/05  
 DRAWN BY: FCC  
 CHECKED BY: SAL

F.A.U. RTE.	SECTION	COUNTY	TOTAL SHEETS	SHEET NO.
2802	05-00026-00-SW	COOK	9	3
STA. 10+50		TO STA. 36+47		
FED. ROAD DIST. NO.		ILLINOIS	FED. AID PROJECT	
CONTRACT NO. 83804				

- ① EXISTING CURB AND GUTTER, TYPE B6.12
- ② EXISTING GROUND
- ③ PROPOSED AGGREGATE BASE, 2"
- ④ PROPOSED P.C.C. SIDEWALK, 5"

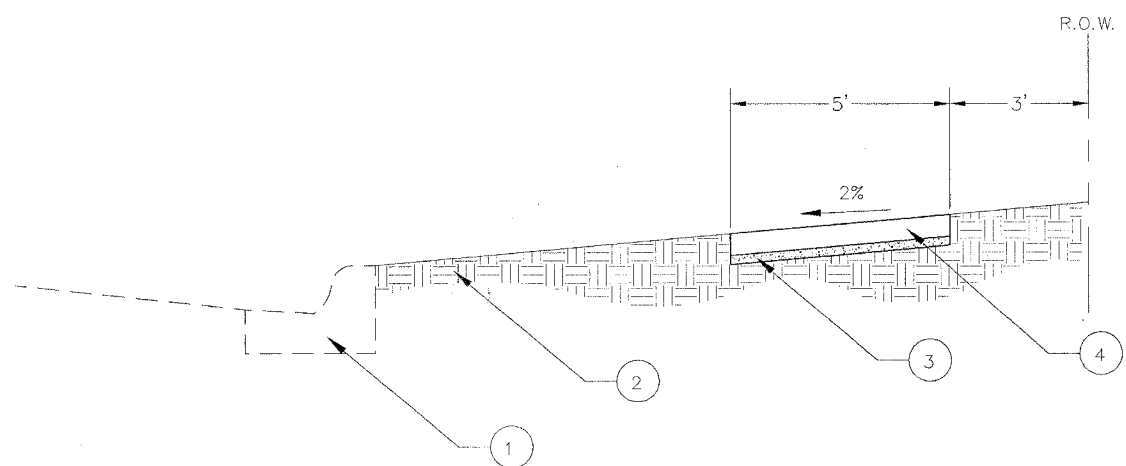

TYPICAL CROSS SECTION  
STA 10+50 - 26+61

- ① EXISTING CURB AND GUTTER, TYPE B6.12
- ② EXISTING GROUND
- ③ PROPOSED AGGREGATE BASE, 2"
- ④ PROPOSED P.C.C. SIDEWALK, 5"

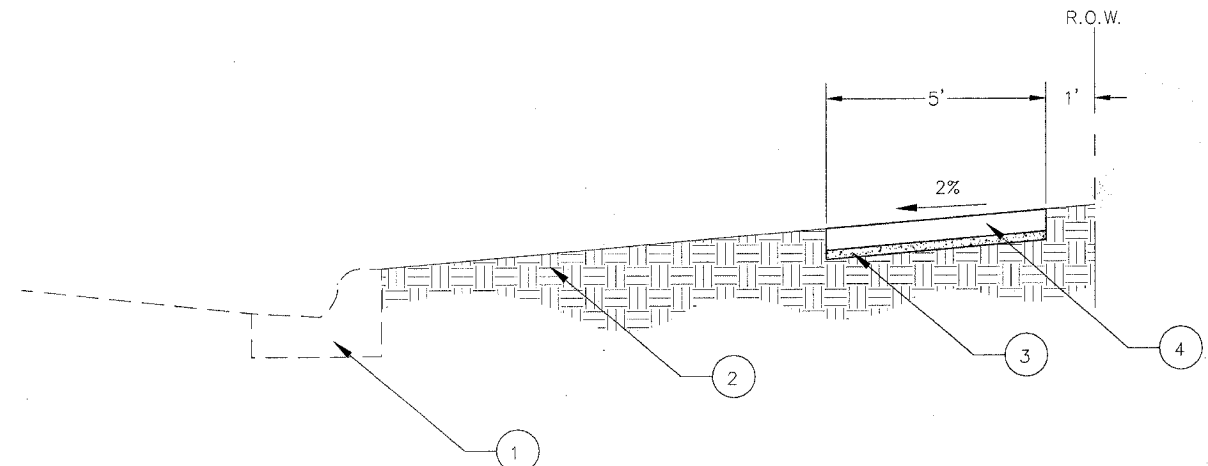

TYPICAL CROSS SECTION  
STA 26+61 - 34+10

**hbe** Hoeffler-Butler Engineering, Inc.  
 Consulting Civil Engineers - Land Surveyors  
 PROFESSIONAL REGISTRATION LICENSE NO. 04-008819  
 8714 S. ALBERTA ROAD HICKORY HILLS, ILLINOIS 60437  
 CHgo. 595-9988 FAX. 595-8791

- ① EXISTING CURB AND GUTTER (DEPRESSED)
- ② EXISTING BITUMINOUS DRIVEWAY SURFACE
- ③ PROPOSED BITUMINOUS DRIVEWAY PAVEMENT, SUPERPAVE MIX "C", N50 (MIN. 3", OR MATCH EX. DRIVEWAY THICKNESS)
- ④ EXISTING AGGREGATE DRIVEWAY BASE
- ⑤ PROPOSED AGGREGATE BASE, 2"
- ⑥ PROPOSED P.C.C. SIDEWALK, 8"

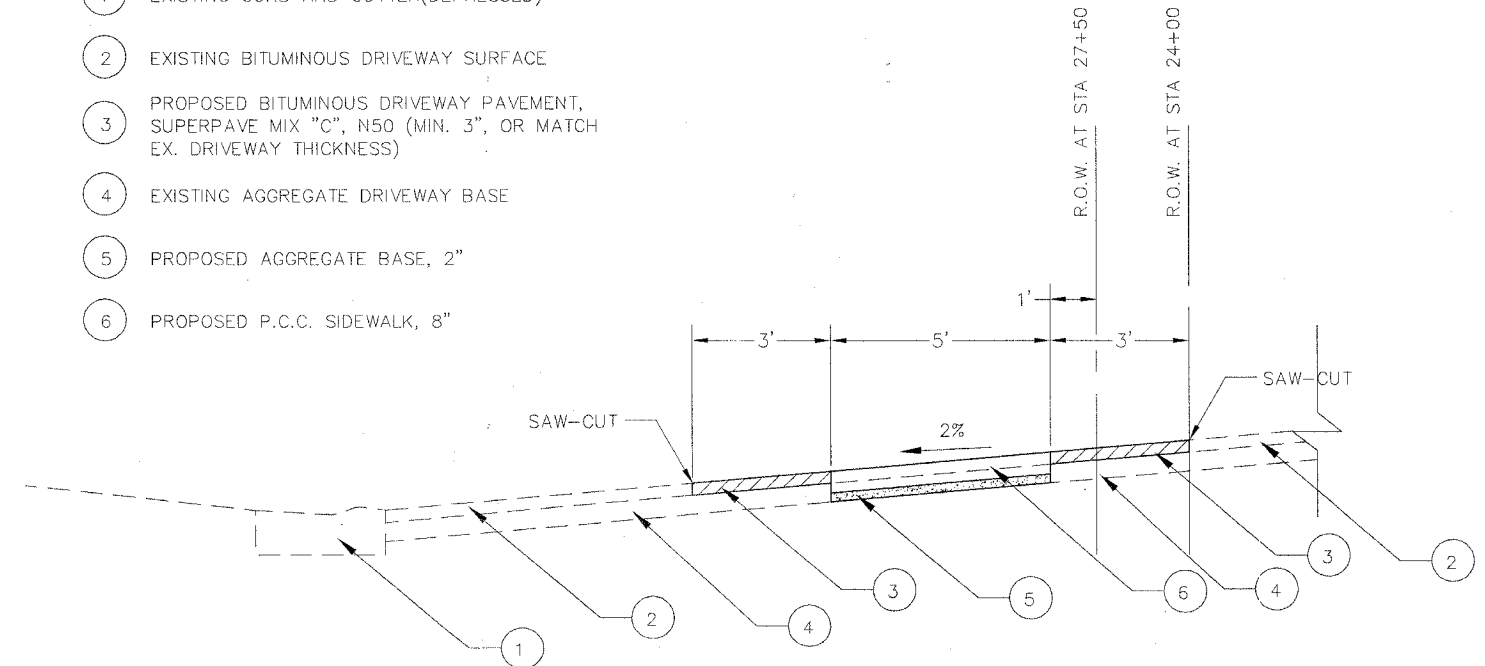

TYPICAL CROSS SECTION  
AT BITUMINOUS DRIVEWAYS

BITUMINOUS MIXTURE REQUIREMENTS			
PAY ITEM	AC TYPE	VOIDS	MAX RAP (%)
BITUMINOUS CONCRETE SURFACE COURSE, SUPERPAVE 3", MIX C, N50	PG 64-22	4%@50 GYR	15

NOTE: THE UNIT WEIGHT USED TO CALCULATE ALL BITUMINOUS SURFACE QUANTITIES IS 112 LBS./S.Y./IN.

- ① EXISTING CURB AND GUTTER, TYPE B6.12
- ② EXISTING GROUND
- ③ PROPOSED AGGREGATE BASE, 2"
- ④ PROPOSED 5" P.C.C. SIDEWALK, 8" P.C.C. SIDEWALK (STA 35+67-35+86)
- ⑤ PROPOSED EXPANSION JOINT

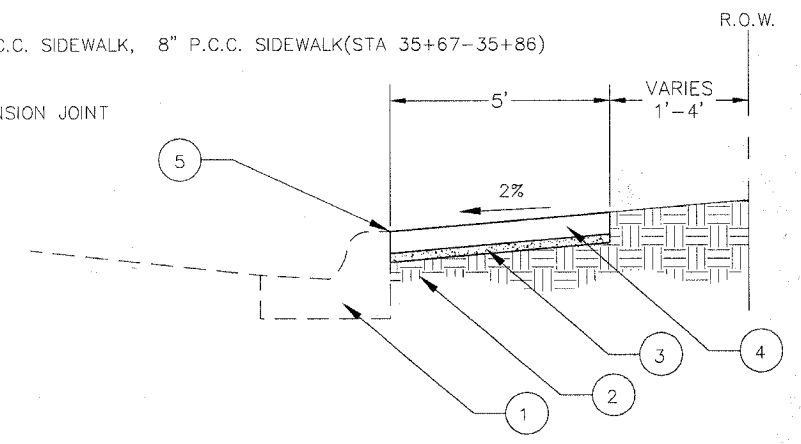

TYPICAL CROSS SECTION  
STA 34+98 - 35+86

REVISIONS	
NAME	DATE
PER IDOT REVIEW	05/20/05
PER IDOT REVIEW	05/31/05

ILLINOIS DEPARTMENT OF TRANSPORTATION  
 VILLAGE OF BEDFORD PARK  
 SAYRE AVE., 75TH ST.-79TH ST.  
 SIDEWALK CONSTRUCTION  
 TYPICAL CROSS SECTIONS  
 HORIZ: 1"=20'  
 DATE: 03/14/05  
 DRAWN BY: ECC  
 CHECKED BY: SAL

F.A.U. RTE.	SECTION	COUNTY	TOTAL SHEETS	SHEET NO.
2802	05-00026-00-SW	COOK	9	4
STA. 10+50		TO STA. 22+00		
FED. ROAD DIST. NO.	ILLINOIS	FED. AID PROJECT		
CONTRACT NO. 83804				

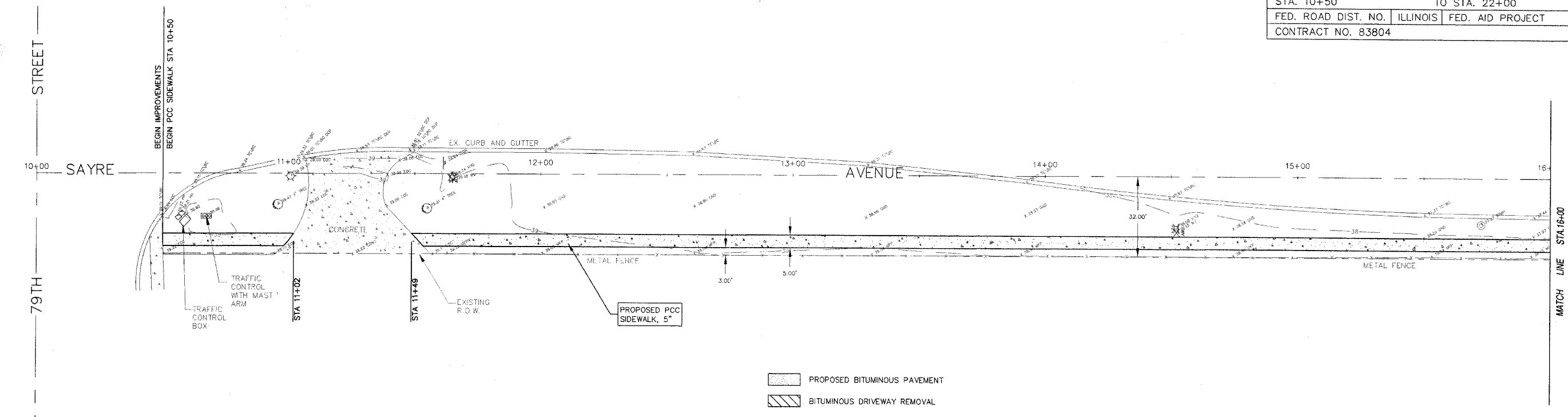

- PROPOSED BITUMINOUS PAVEMENT
- BITUMINOUS DRIVEWAY REMOVAL

**hbe** **Hoeffler-Butler Engineering, Inc.**  
 Consulting Civil Engineers - Land Surveyors  
 PROFESSIONAL DESIGN FIRM LICENSE NO. 04-008819  
 874 S. ALBERTS ROAD ROCKFORD HILLS, ILLINOIS 60087  
 (708) 399-9880 FAX (708) 399-9796

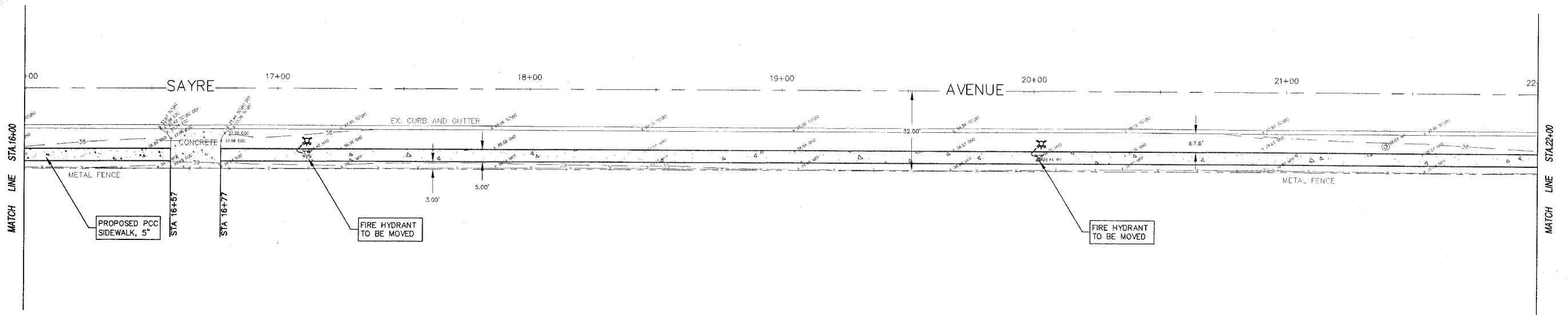

REVISIONS	
NAME	DATE
PER DOT REVIEW	05/20/05
PER DOT REVIEW	05/31/05

ILLINOIS DEPARTMENT OF TRANSPORTATION  
 VILLAGE OF BEDFORD PARK  
 SAYRE AVE., 75TH ST.-79TH ST.  
 SIDEWALK CONSTRUCTION  
**SIDEWALK PLAN**  
 HORIZ: 1"=20'  
 DATE: 03/14/05  
 DRAWN BY: ECC  
 CHECKED BY: SAL

F.A.U. RTE.	SECTION	COUNTY	TOTAL SHEETS	SHEET NO.
2802	05-00026-00-SW	COOK	9	5
STA. 22+00		TO STA. 34+00		
FED. ROAD DIST. NO.	ILLINOIS	FED. AID PROJECT		
CONTRACT NO. 83804				

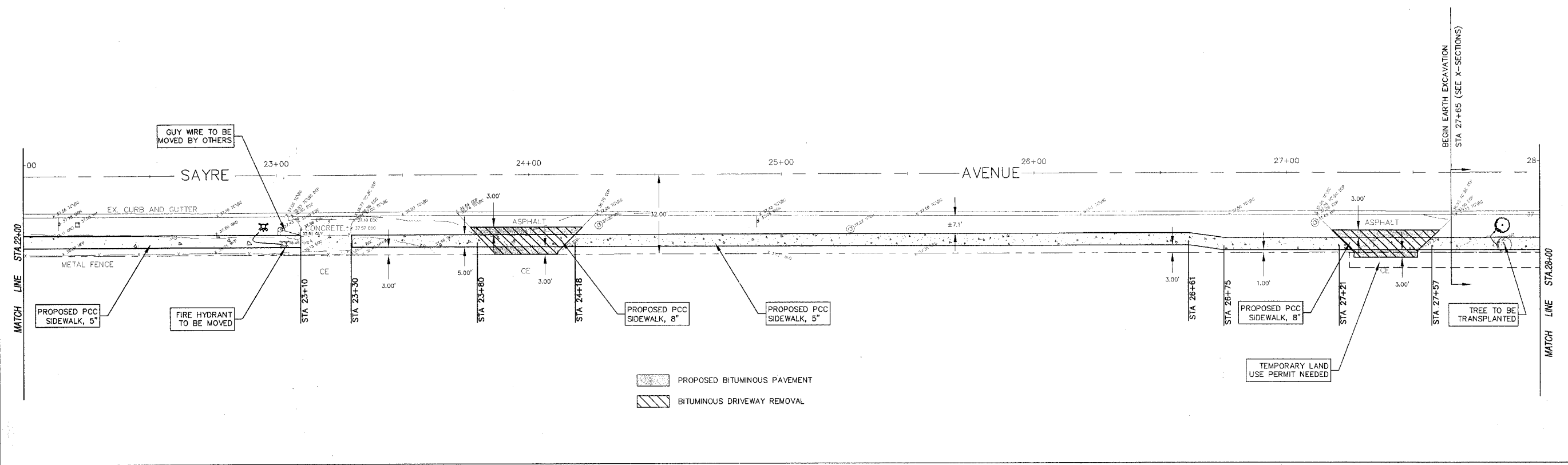

PROPOSED BITUMINOUS PAVEMENT  
 BITUMINOUS DRIVEWAY REMOVAL

**hbe** **Hoeffler-Butler Engineering, Inc.**  
 Consulting Civil Engineers - Land Surveyors  
 PROFESSIONAL DESIGN FIRM LICENSE NO. 024-008819  
 8714 S. ROBERTS ROAD - HOOVER HILLS, ILLINOIS 60437  
 (708) 599-8900 FAX (708) 599-8798

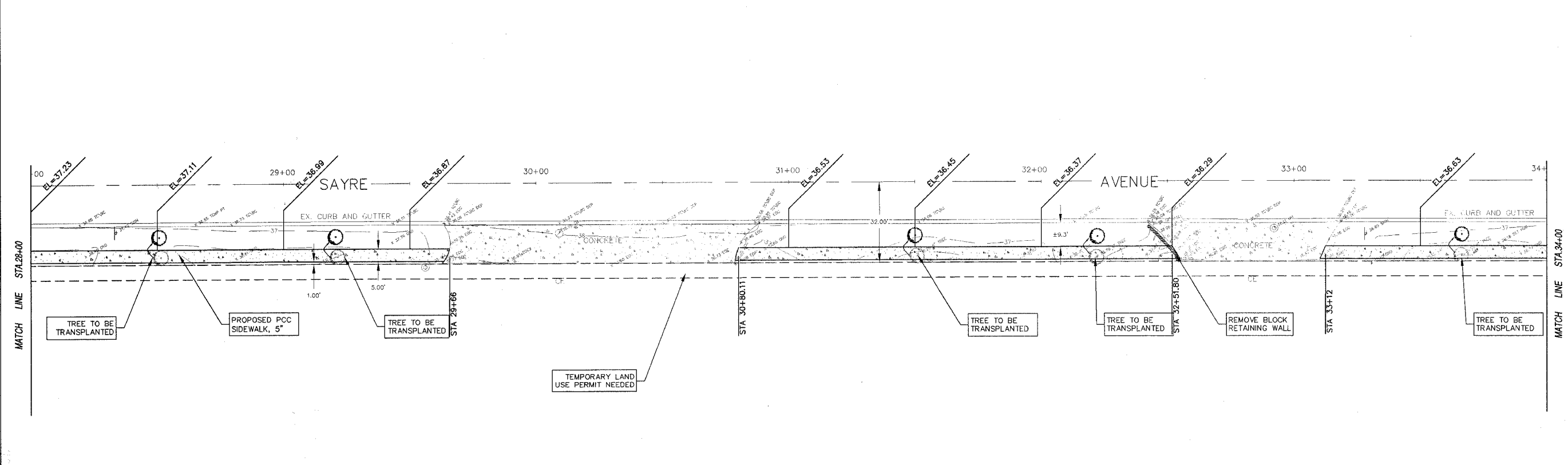

REVISIONS		ILLINOIS DEPARTMENT OF TRANSPORTATION VILLAGE OF BEDFORD PARK SAYRE AVE., 75TH ST.-79TH ST. SIDEWALK CONSTRUCTION
NAME	DATE	
PER IDOT REVIEW	05/20/05	
PER IDOT REVIEW	05/31/05	

SIDWALK PLAN  
 HORIZ. 1"=20'  
 DATE: 03-14-05  
 DRAWN BY: ECC  
 CHECKED BY: SAL

F.A.U. RTE.	SECTION	COUNTY	TOTAL SHEETS	SHEET NO.
2802	05-00026-00-SW	COOK	9	6
STA. 34+00		TO STA. 36+47		
FED. ROAD DIST. NO.	ILLINOIS	FED. AID PROJECT		
CONTRACT NO. 83804				

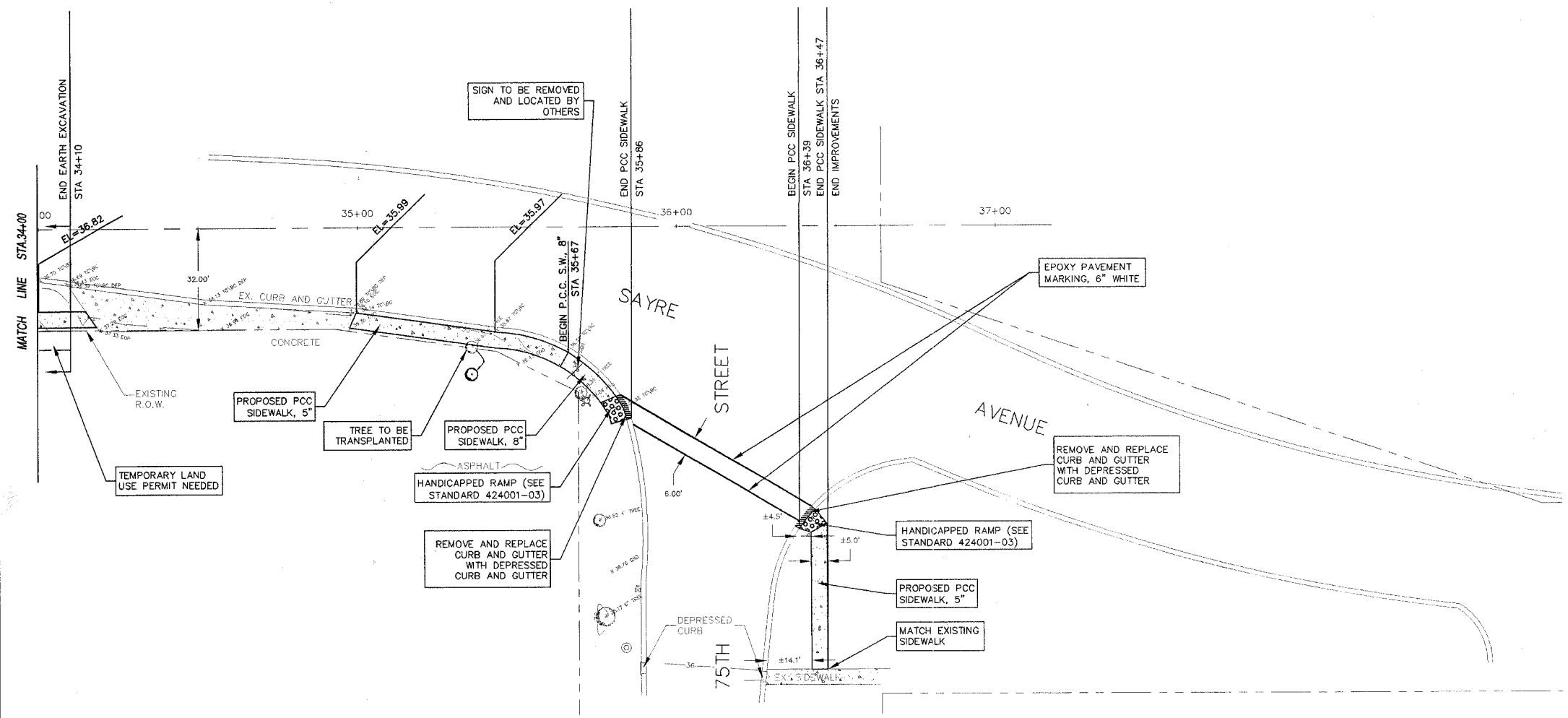

**(hbe) Hoeffler-Butler Engineering, Inc.**  
 Consulting Civil Engineers - Land Surveyors  
 PROFESSIONAL DESIGN FIRM LICENSE NO. 184-00818  
 8724 S. ROBERTS ROAD - HOCKEY HILLS, ILLINOIS 60457  
 (708) 959-0988 FAX (708) 959-0790

REVISIONS		
NO.	NAME	DATE
1	PER DOT REVIEW	05/20/05
2	PER DOT REVIEW	05/31/05

ILLINOIS DEPARTMENT OF TRANSPORTATION  
 VILLAGE OF BEDFORD PARK  
 SAYRE AVE., 75TH ST.-79TH ST.  
 SIDEWALK CONSTRUCTION

**SIDEWALK PLAN**  
 HORIZ. 1"=20'  
 DATE: 03-14-05  
 DRAWN BY: FCC  
 CHECKED BY: SAL



F.A.U. RTE.	SECTION	COUNTY	TOTAL SHEETS	SHEET NO.
2802	05-00026-00-SW	COOK	9	8
STA.		TO STA.		
FED. ROAD DIST. NO.		ILLINOIS	FED. AID PROJECT	
CONTRACT NO. 83804				

**hbe** **Hoeffler-Butler Engineering, Inc.**  
 Consulting Civil Engineers • Land Surveyors  
 PROFESSIONAL DESIGN FIRM LICENSE NO. 064-008619  
 674 S. ROBERTS ROAD • HICKORY HILLS, ILLINOIS 60157  
 (708) 599-8900 FAX (708) 599-8798

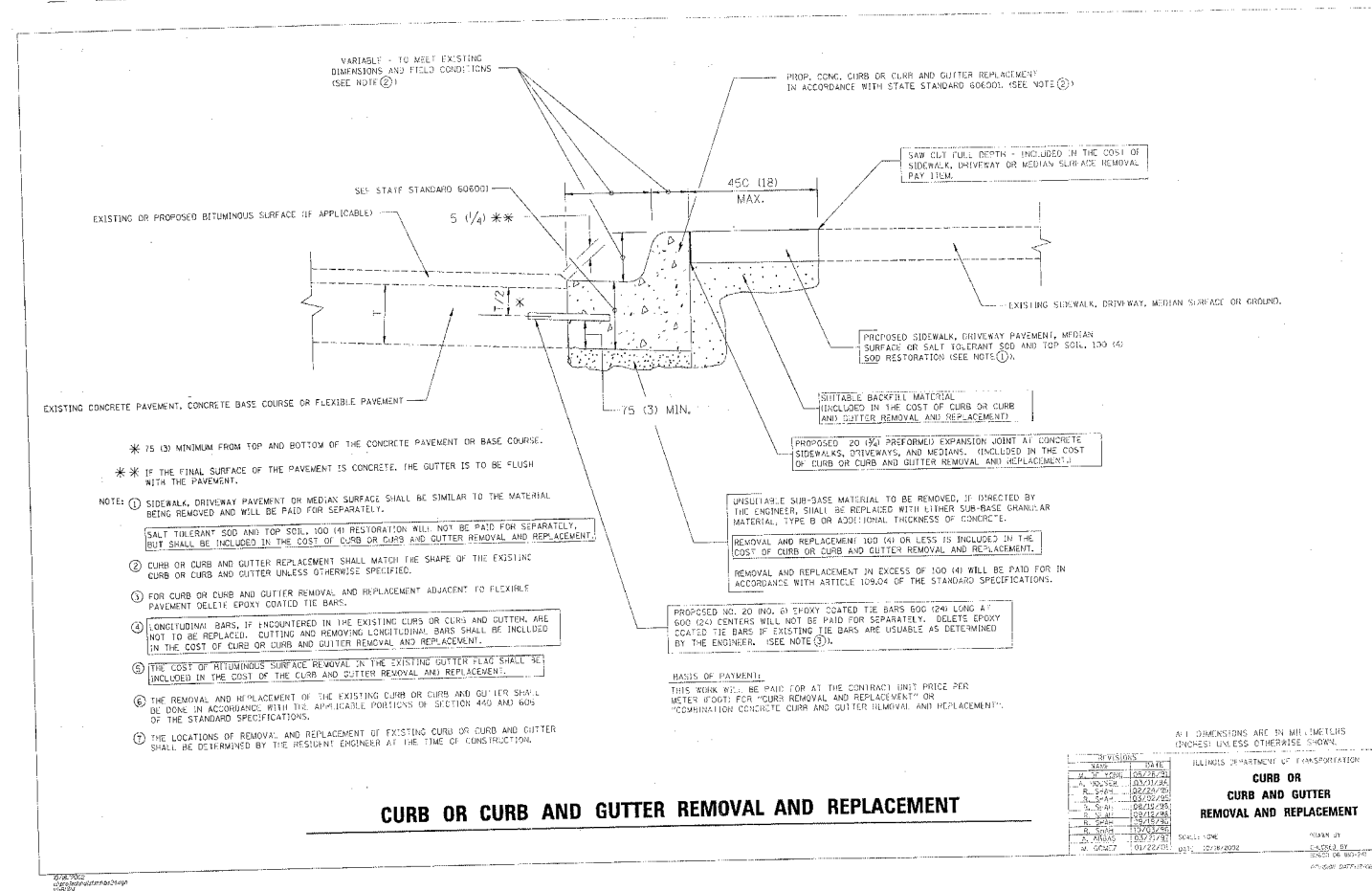



F.A.U. RTE.	SECTION	COUNTY	TOTAL SHEETS	SHEET NO.
2802	05-00026-00-SW	COOK	9	9
STA. 27+65		TO STA. 34+10		
FED. ROAD DIST. NO.		ILLINOIS	FED. AID PROJECT	
CONTRACT NO. 83804				

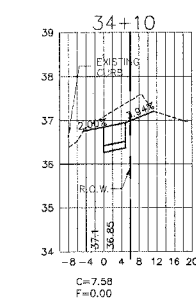
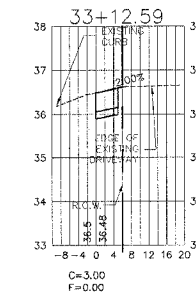
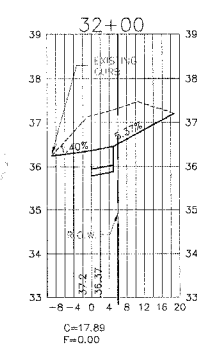
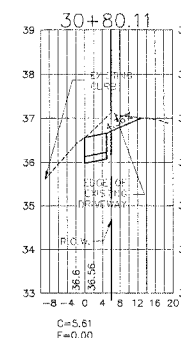
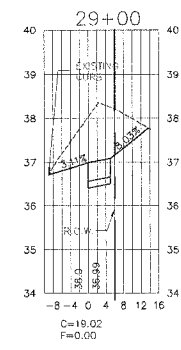
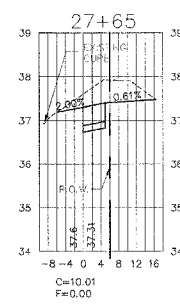
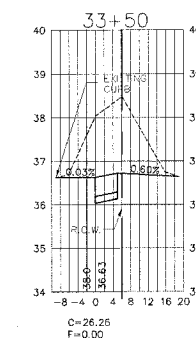
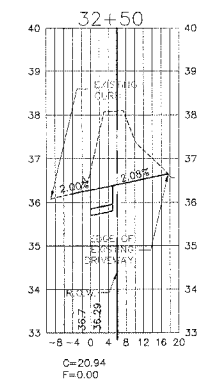
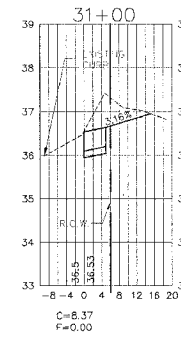
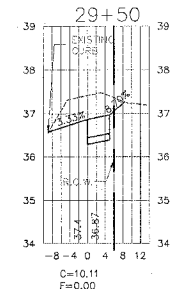
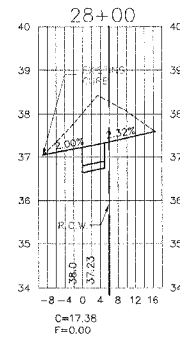
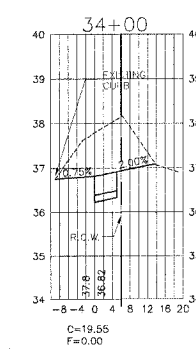
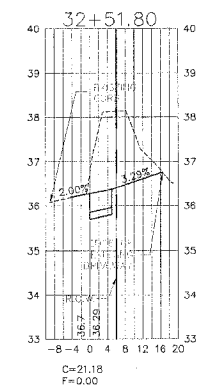
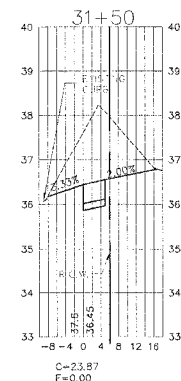
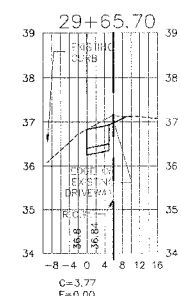
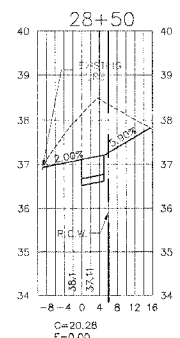

**hbe** **Hoeffler-Butler Engineering, Inc.**  
 Consulting Civil Engineers - Land Surveyors  
 PROFESSIONAL REVIEW FOR LICENSE NO. 000-00000  
 874 S. ROBERTS ROAD - HICORY HILLS, ILLINOIS 60457  
 (708) 399-9988 FAX (708) 399-9798

REVISIONS		DATE
NO.	DESCRIPTION	
PER	DOT REVIEW	05/20/05
PER	DOT REVIEW	05/31/05

ILLINOIS DEPARTMENT OF TRANSPORTATION  
 VILLAGE OF BEDFORD PARK  
 SAYRE AVE., 75TH ST., 79TH ST.  
 SIDEWALK CONSTRUCTION

VERT: 1"=2'  
 HORIZ: 1"=20'  
 DATE: 03/14/05

CROSS SECTIONS  
 DRAWN BY: ECC  
 CHECKED BY: SAL