

ISSUED FOR	DATE
AGENCY REVIEW	03.04.05
AGENCY REVIEW	05.03.05

REVISIONS	NO.	ITEM	DATE

DRAWN	MWT
CHECKED	JTS
PM	MRR

PROJECT NUMBER
04227

SHEET TITLE
PLAN
AND
PROFILE

MULFORD ROAD
STATION 282+00 TO
STATION 287+50
SHEET NUMBER

6 of x

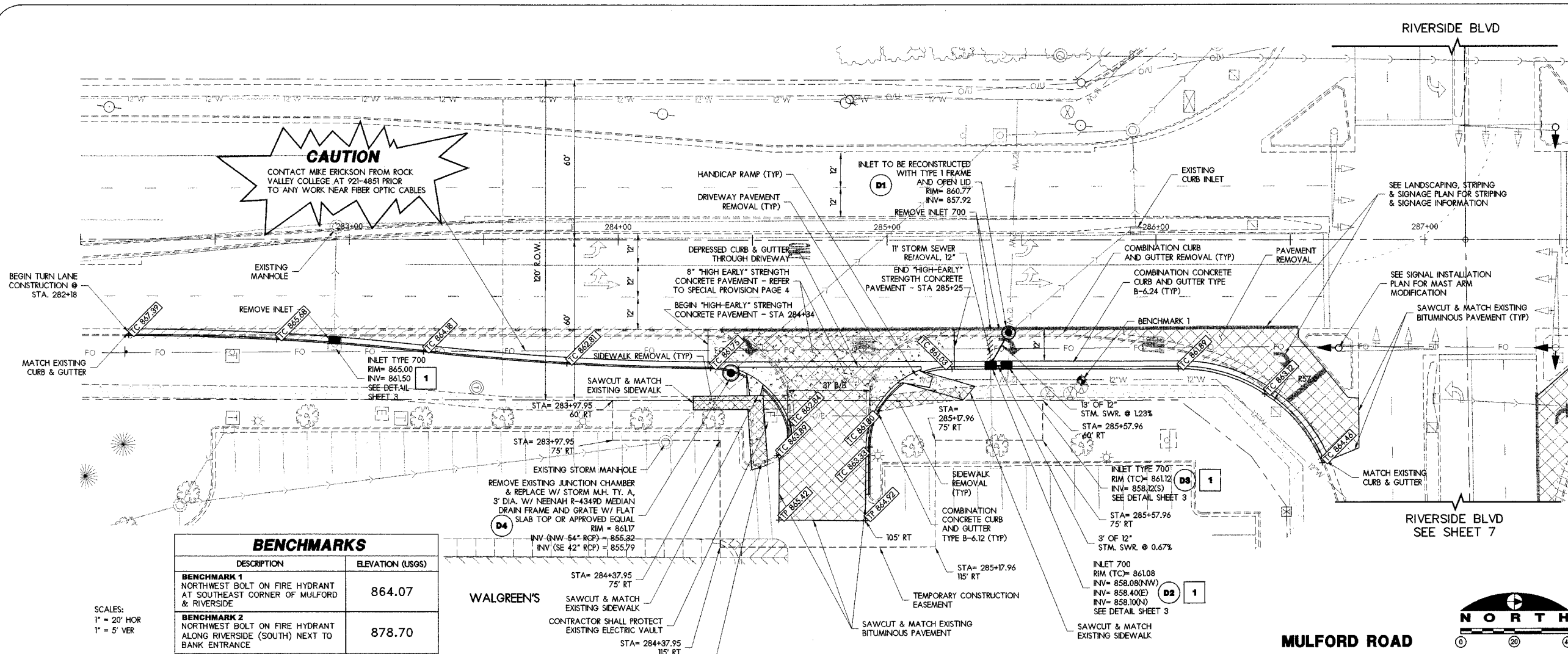

BENCHMARKS	
DESCRIPTION	ELEVATION (USGS)
BENCHMARK 1 NORTHWEST BOLT ON FIRE HYDRANT AT SOUTHEAST CORNER OF MULFORD & RIVERSIDE	864.07
BENCHMARK 2 NORTHWEST BOLT ON FIRE HYDRANT ALONG RIVERSIDE (SOUTH) NEXT TO BANK ENTRANCE	878.70

SCALES:
1" = 20' HOR
1" = 5' VER

