

COUNTY	ROUTE	SECTION	TOTAL SHEETS	SHEET NO.
ADAMS	FAS 432	05-00194-00-RS	12	4

STATION 144+00 TO STATION 163+00

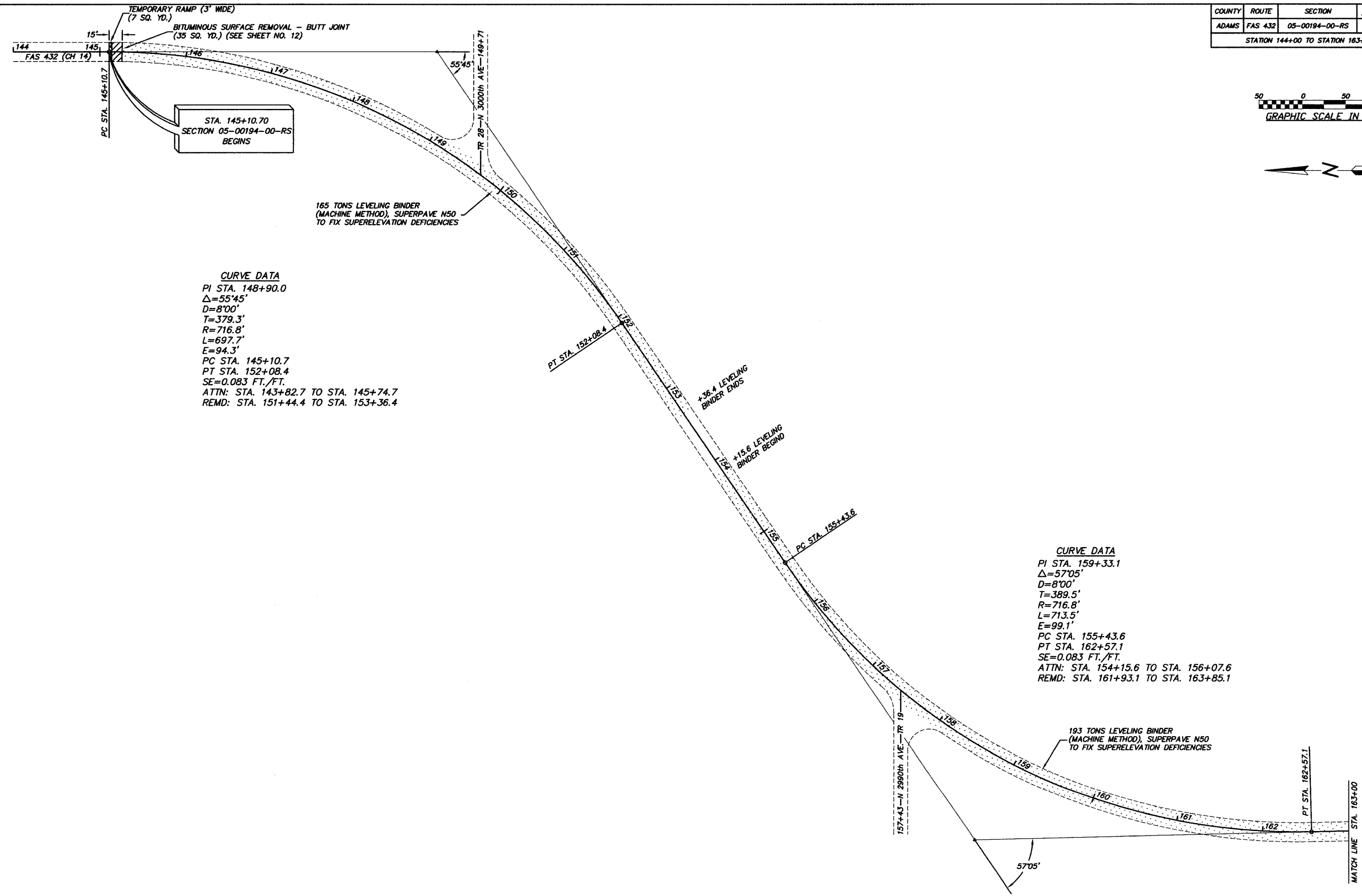
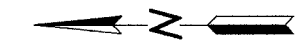
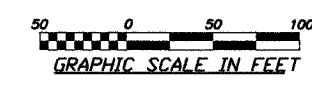

CURVE DATA
 PI STA. 148+90.0
 $\Delta=55^{\circ}45'$
 $D=8'00''$
 $T=379.3'$
 $R=716.8'$
 $L=697.7'$
 $E=94.3'$
 PC STA. 145+10.7
 PT STA. 152+08.4
 $SE=0.083$ FT./FT.
 ATTN: STA. 143+82.7 TO STA. 145+74.7
 REMD: STA. 151+44.4 TO STA. 153+36.4

CURVE DATA
 PI STA. 159+33.1
 $\Delta=57^{\circ}05'$
 $D=8'00''$
 $T=389.5'$
 $R=716.8'$
 $L=713.5'$
 $E=99.1'$
 PC STA. 155+43.6
 PT STA. 162+57.1
 $SE=0.083$ FT./FT.
 ATTN: STA. 154+15.6 TO STA. 156+07.6
 REMD: STA. 161+93.1 TO STA. 163+85.1

165 TONS LEVELING BINDER
 (MACHINE METHOD), SUPERPAVE N50
 TO FIX SUPERELEVATION DEFICIENCIES

+36.4 LEVELING
 BINDER ENDS

+15.6 LEVELING
 BINDER BEGINS

193 TONS LEVELING BINDER
 (MACHINE METHOD), SUPERPAVE N50
 TO FIX SUPERELEVATION DEFICIENCIES

MATCH LINE STA. 163+00