

STATE OF ILLINOIS
DEPARTMENT OF TRANSPORTATION
DIVISION OF HIGHWAYS

PROPOSED LOCAL AGENCY
FEDERAL-AID SECONDARY PROJECT

ROUTE SECTION PROJECT
MARION COUNTY

C-97-049-93

ROUTE	SECTION	COUNTY	TOTAL SHEETS	SHEET NO.
*FAU 8591, FAS 792, FAS 791	*05-00090-00-RS, 01-00117-00-RS	MARION	4	1

INDEX OF SHEETS

COVER SHEET	1
SUMMARY OF QUANTITIES AND GENERAL NOTES	2
CURVE DATA AND UTILITIES	
TYPICAL SECTIONS DETAILS	3
SCHEDULES	4

STANDARDS

- 000001-04 Standard Symbols, Abbreviations and Patterns
- 442201-01 Class C and D Patches
- 701201-02 Lane Closure, 2L, 2W, Day Only, for Speeds ≥ 45 MPH
- 701301-02 Lane Closure, 2L, 2W Short Time Operations
- 701306-01 Lane Closure, 2L, 2W Slow Moving Operations - Day Only for Speeds ≥ 45 MPH
- 701311-02 Lane Closure, 2L, 2W Slow Moving Operations - Day Only
- 701501-03 Urban Lane Closure, 2L, 2W, Undivided
- 702001-05 Traffic Control Devices
- 780001-01 Typical Pavement Markings

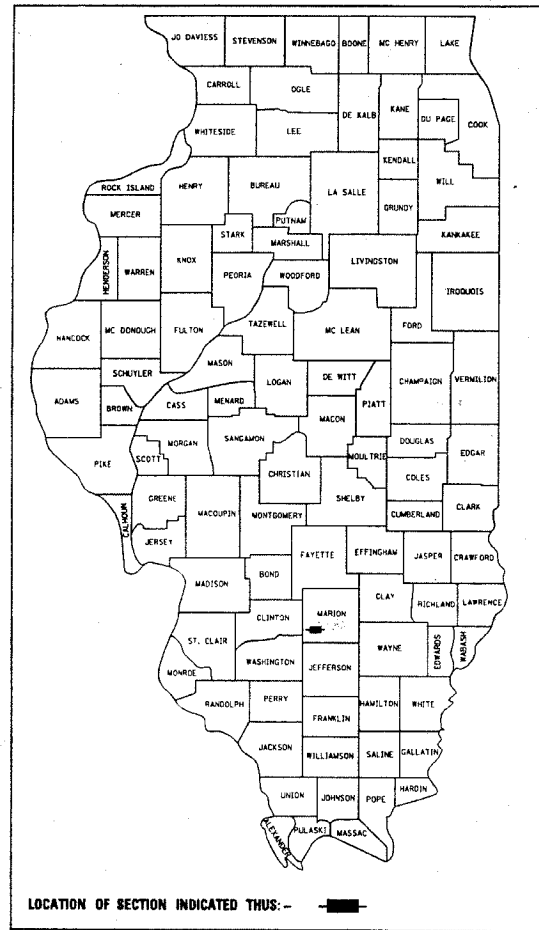

LOCATION OF SECTION INDICATED THUS: - ■ -

THE ACCEPTANCE OF THIS PROJECT IS BASED ON THE LOCAL AGENCY PAVEMENT PRESERVATION (LAPP) POLICIES ON THE COUNTY HIGHWAY SYSTEM.

Maureen Kavel
DISTRICT ENGINEER OF LOCAL ROADS AND STREETS
DATE: 5-31-05

STATE OF ILLINOIS
DEPARTMENT OF TRANSPORTATION
DIVISION OF HIGHWAYS

SUBMITTED: 05-11-2005

James E. Cunningham
COUNTY ENGINEER

5-31-2005
Maureen Kavel
DISTRICT ENGINEER OF LOCAL ROADS & STREETS

5-31-2005
Christie M. Reed
DEPUTY DIRECTOR OF HIGHWAYS
REGION FOUR ENGINEER

DESIGN CLASSIFICATION: RURAL MAJOR COLLECTOR
URBAN MINOR ARTERIAL

ADT₂₀₀₄: 2750
ADT₂₀₂₄: 3850
DESIGN SPEED - 60 MPH

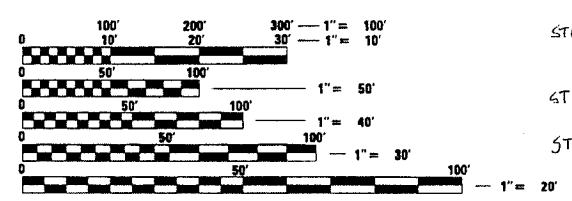

FULL SIZE PLANS HAVE BEEN PREPARED USING STANDARD ENGINEERING SCALES. REDUCED SIZED PLANS WILL NOT CONFORM TO STANDARD SCALES. IN MAKING MEASUREMENTS ON REDUCED PLANS, THE ABOVE SCALES MAY BE USED.

J.U.L.I.E.
JOINT UTILITY LOCATION INFORMATION FOR EXCAVATION
1-800-892-0123

CONTRACT NO. 95435

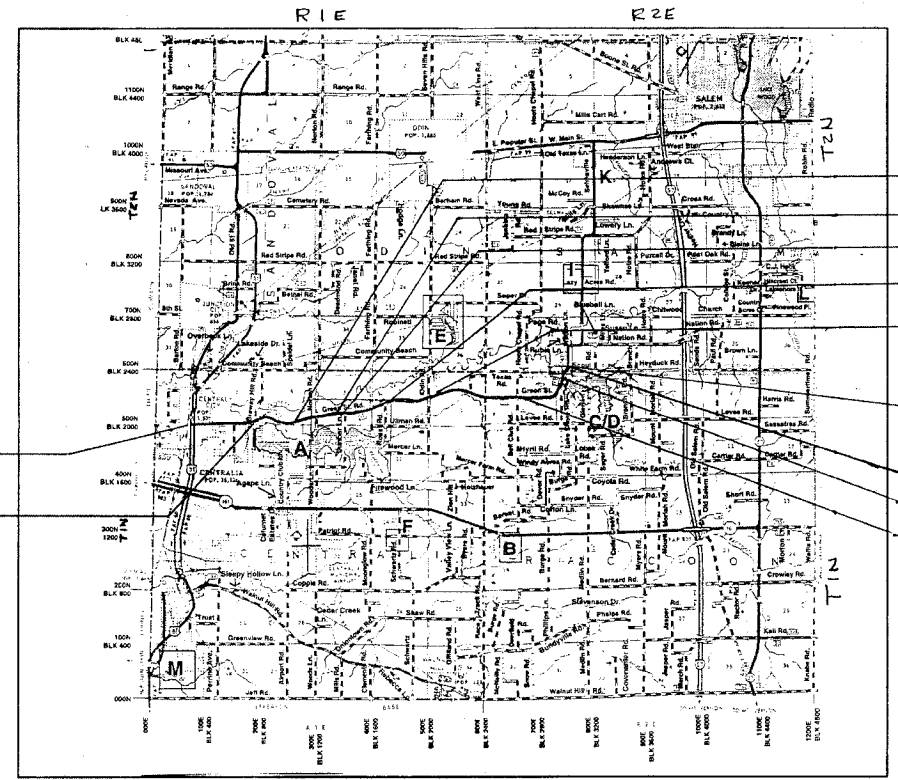

STA. 0+20 BEGIN SECTION
STU 05-00090-00-RS

STA. 70+02 END SECTION
STU 05-00090-00-RS

BEGIN SECTION
STR 01-00117-00-RS

BEGIN STA 0+20

EQUATION: 107+06.70 BACK
107+04.75 AHEAD

EQUATION: 137+27.53 BACK
137+45.00 AHEAD

EQUATION: 150+32.98 BACK
150+26.00 AHEAD

EQUATION: 175+45.23 BACK
175+46.99 AHEAD

EQUATION: 226+22.85 BACK
226+78.56 AHEAD

STA. 391+78.7 END SECTION
STR 01-00117-00-RS

END STA 391+78.7

EQUATION: 375+405.76 BACK
375+06.78 AHEAD

EQUATION: 297+38.98 BACK
297+46.08 AHEAD

THESE PLANS WERE PREPARED BY ME OR A FULL-TIME MEMBER OF MY STAFF UNDER MY PERSONAL SUPERVISION.



James E. Cunningham
COUNTY ENGINEER, MARION COUNTY
901 WEST ELM STREET
SALEM, ILLINOIS 62881
ILLINOIS LICENSED PROFESSIONAL ENGINEER
NO. 062-031357
LICENSE EXPIRES 11/30/05

GROSS LENGTH
Sta 0+20 to Sta 70+22.4 7002.4 FT. 1.33 MI.
Sta 70+22.4 to Sta. 391+78.7 31078.5 FT. 6.08 MI.

NET LENGTH 39090.7 FT. 7.41 MI.

ROUTE	SECTION	COUNTY	TOTAL SHEETS	SHEET NO.
★	★★	MARION	4	2

*FAU 8591, FAS 792, FAS 791
 **05-00090-00-RS, 01-00117-00-RS \\
 CONTRACT NUMBER 95435

CODE NO	PAY ITEM	H24 2000 SUMMARY OF QUANTITIES		H20 1000		TOTAL	
		STR SECTION 01-00117-00-RS STA 70 + 02 to STA 391 + 78.7		STU SECTION 05-00090-00-RS STA 0 + 20 to STA 70 + 02			
		UNIT	QUANTITY	UNIT	QUANTITY	UNIT	QUANTITY
40600100	BITUMINOUS MATERIALS (PRIME COAT)	GALLON	8,575	GALLON	1,940	GALLON	10,515
40600300	AGGREGATE (PRIME COAT)	TON	172	TON	3	TON	175
40600980	BITUMINOUS SURFACE REMOVAL - BUTT JOINT	SQ YD	286	SQ YD	286	SQ YD	532
40600990	TEMPORARY RAMP	SQ YD	44	SQ YD	44	SQ YD	88
44000005	BITUMINOUS SURFACE REMOVAL 1 1/4"	SQ YD	85,747	SQ YD	17,882	SQ YD	103,629
44201737	CLASS D PATCHES, TYPE I, 8 INCH	SQ YD		SQ YD	10	SQ YD	10
44201741	CLASS D PATCHES, TYPE II, 8 INCH	SQ YD	7	SQ YD	52	SQ YD	59
44201745	CLASS D PATCHES, TYPE III, 8 INCH	SQ YD		SQ YD	36	SQ YD	36
44201747	CLASS D PATCHES, TYPE IV, 8 INCH	SQ YD	27	SQ YD	45	SQ YD	72
48101200	AGGREGATE SHOULDERS, TYPE B	TON	805	TON	176	TON	981
67100100	MOBILIZATION	LUMP SUM	0.7	LUMP SUM	0.3	LUMP SUM	1
70100450	TRAFFIC CONTROL & PROTECTION, STANDARD 701201	LUMP SUM	1	LUMP SUM	0	LUMP SUM	1
70100460	TRAFFIC CONTROL & PROTECTION, STANDARD 701306	LUMP SUM	1	LUMP SUM	0	LUMP SUM	1
70102620	TRAFFIC CONTROL & PROTECTION, STANDARD 701501	LUMP SUM	0	LUMP SUM	1	LUMP SUM	1
70300100	SHORT-TERM PAVEMENT MARKING	FOOT	9,645	FOOT	2,047	FOOT	11,892
* 78000200	THERMOPLASTIC PAVEMENT MARKING LINE - 4"	FOOT	97,082	FOOT	15,175	FOOT	112,257
* 78000600	THERMOPLASTIC PAVEMENT MARKING LINE - 12"	FOOT		FOOT	228	FOOT	228
X4066414	BITUMINOUS CONCRETE SURFACE COURSE, SUPERPAVE, MIX "C", N50	TON	12,095	TON	2,681	TON	14,776
X4066616	BITUMINOUS CONCRETE BINDER COURSE, SUPERPAVE, IL 19.0, N70	TON	25			TON	25
XX003140	SHORT-TERM PAVEMENT MARKING REMOVAL	FOOT	3,215	FOOT	680	FOOT	3,895

*SPECIALTY ITEMS

UTILITIES

AMTCIA SBC	DAWN KRONENBERGER	818-482-6157
CCITY04 CENTRAL CITY, VILLAGE OF	MIKE GELSINGER	818-532-1585
CNTLOA CENTRALIA, CITY OF	BOB LYBARGER	818-533-7840
CVSIOA CHARTER COMMUNICATIONS	EDDIE PRIOR	818-242-9512x215
IPCOA AMEREN IP	BILL NIEBRUGGE	818-238-6201
MUSA04 MCLEOD USA	MARK MILLS	217-876-7194x240
ODW004 ODIN WATER DEPARTMENT	MARK THOMPSON	818-775-0460
RACCOA RACCOON WATER CO	JIM GREEN	818-532-8569
TCCO04 TRI-COUNTY ELECTRIC COOP	SUE ECHOLS	818-244-5151
SOIL4A SHELL PIPELINE CO. LP	DAVID FEATHER	818-432-5727
COG004 CITATION OIL & GAS CORPO	MICHAEL R. GARDEN	818-548-1803x12
FRO04 FARM BUREAU OIL COMPANY	MICKEY SMITH	812-838-8111

Existing Curve Data

RT Sta	Δ	D	R	SE	SE Attained	SE Ends
46 + 82.3	14°-00	2°-00	2,864.93'	0.038	(42 + 70.5)	(49 + 70.5)
					to	to
					(43 + 90.5)	(50 + 90.5)
76 + 55.8	51°-30	5°-00	1,146.28'	0.073	(64 + 53.9)	(79 + 83.9)
					to	to
					(72 + 51.9)	(82 + 81.9)
97 + 91.19	58°-01	2°-52	1,998.40'	0.058	(85 + 88.18)	(105 + 72.7)
					to	to
					(88 + 18.8)	(108 + 39.75)
122 + 31.3	33°-00	3°-54	1,469.41'	0.083	(116 + 11.87)	(124 + 58.02)
					to	to
					(119 + 79.87)	(128 + 26.02)
133 + 82.24	23°-06	3°-18	1,738.48'	0.066	(128 + 71.33)	(135 + 71.33)
					to	to
					(131 + 63.33)	(139 + 01.6)
146 + 64	20°-31	2°-45	2,083.68'	0.051	(141 + 56.9)	(149 + 02.9)
					to	to
					(144 + 16.9)	(151 + 66.2)
161 + 21.49	26°-21	3°-44	1,534.98'	0.08	(155 + 85.13)	(162 + 90.93)
					to	to
					(159 + 39.13)	(166 + 44.93)
171 + 95.66	7°-00	1°-00	5,729.65'	0.025	(167 + 98.23)	(174 + 98.23)
					to	to
					(168 + 92.93)	(175 + 95.39)
187 + 82.7	15°-54	1°-15	4,583.75'	0.025	(180 + 85.47)	(193 + 55.4)
					to	to
					(182 + 01.4)	(194 + 73.4)
204 + 93.72	49°-11	3°-54	1,469.41'	0.083	(196 + 37.2)	(208 + 98.3)
					to	to
					(200 + 05.2)	(212 + 66.3)
222 + 37.22	30°-52	3°-54	1,469.41'	0.083	(216 + 47.4)	(224 + 39)
					to	to
					(220 + 15.4)	(228 + 62.35)
241 + 89.3	6°-53	0°-54	6,366.26'	0.025	(237 + 63.44)	(245 + 28.25)
					to	to
					(238 + 49.44)	(246 + 14.25)
268 + 14.8	43°-12	2°-00	2,864.93'	0.038	(255 + 85.5)	(277 + 45.5)
					to	to
					(257 + 75.5)	(279 + 35.5)
287 + 55.75	25°-20	3°-36	1,591.85'	0.075	(282 + 27.98)	(289 + 31.68)
					to	to
					(285 + 67.98)	(292 + 71.68)
363 + 93.8	83°-55-20	4°-28	1,312.43'	0.065	(350 + 83.88)	(370 + 05.88)
					to	to
					(353 + 43.88)	(372 + 65.38)
378 + 15.8	33°-19	5°-33	1,032.76'	0.083	(373 + 40.76)	(379 + 42.08)
					to	to
					(376 + 71.78)	(382 + 72.08)
388 + 08.58	36°-25	5°-46	999.03'	0.083	(383 + 09.6)	(389 + 41.1)
					to	to
					(386 + 53.6)	(392 + 65.1)

GENERAL NOTES

THIS SECTION SHALL BE CONSTRUCTED IN ACCORDANCE WITH THE PLANS, THE "STANDARD SPECIFICATIONS FOR ROAD AND BRIDGE CONSTRUCTION", ADOPTED JANUARY 1, 2002, THE "SUPPLEMENTAL SPECIFICATIONS AND RECURRING SPECIAL PROVISIONS", AND THE SPECIAL PROVISIONS INCLUDED IN THE PROPOSAL.

THE PROPOSED PROJECT ON F.A.U. 8591, F.A.S. 792, AND F.A.S. 791, C.H. 11, BEGINS AT THE EAST EDGE OF THE SOUTH BOUND LANE OF U.S. ROUTE 51 IN CENTRAL CITY, ILLINOIS AT STATION 0+20 AND EXTENDS IN AN EASTERLY DIRECTION FOR A DISTANCE OF 7.41 MILES TO A POINT JUST NORTH OF SCOUT ROAD AT STATION 391+78.2.

THE WORK INCLUDED IN THIS PROJECT CONSISTS OF PAVEMENT REMOVAL 1 1/4", PAVEMENT PATCHING, 2 1/2" BITUMINOUS CONCRETE SURFACE COURSE, AGGREGATE SHOULDERS, AND ANY OTHER WORK NECESSARY TO COMPLETE THE PROJECT.

THERMOPLASTIC PAVEMENT MARKING LINE 4" AND 12" SHALL BE CONSTRUCTED AS DIRECTED BY THE ENGINEER.

THE EXISTING GRADE, ALIGNMENT, DRAINAGE STRUCTURES, BASE AND SURFACE WERE CONSTRUCTED UNDER THE ILLINOIS DEPARTMENT OF TRANSPORTATION'S DESIGN REQUIREMENTS FOR LOCAL ROUTE'S AT THE TIME OF THEIR INITIAL CONSTRUCTION. THE ORIGINAL PLANS ARE AVAILABLE FOR INSPECTION AT THE MARION COUNTY HIGHWAY DEPARTMENT, 901 WEST ELM STREET, SALEM, ILLINOIS.

COMPUTATION OF BITUMINOUS QUANTITIES IS BASED UPON 112 POUNDS/SQUARE YARD/1" THICK.

COMPUTATION OF AGGREGATE SHOULDER, TYPE B IS BASED UPON 2.05 TONS/CUBIC YARD.

ROUTE	SECTION	COUNTY	TOTAL SHEETS	SHEET NO.
*	**	MADISON	4	3

*FAU 8591, FAS 782, FAS 791
 **05-00080-00-RS, 01-00117-00-RS
 CONTRACT NUMBER 86435

PROPOSED TYPICAL SECTION
 STATION 0+23 TO STATION 2+72

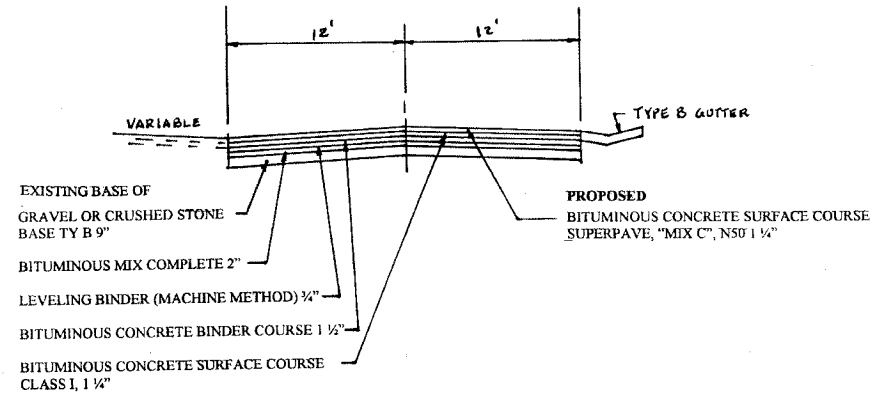

PROPOSED TYPICAL SECTION
 STATION 2+72 TO STATION 67+05

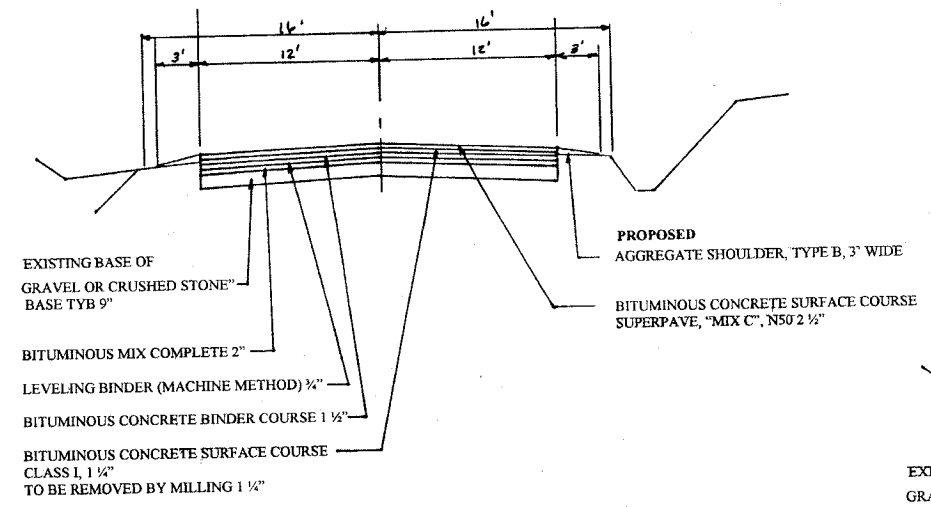

PROPOSED TYPICAL SECTION
 STATION 67+05 TO STATION 391+78.7

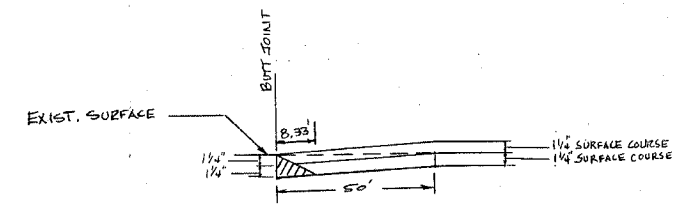
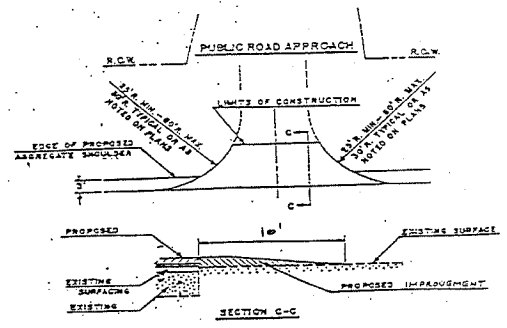
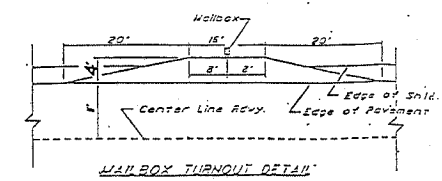
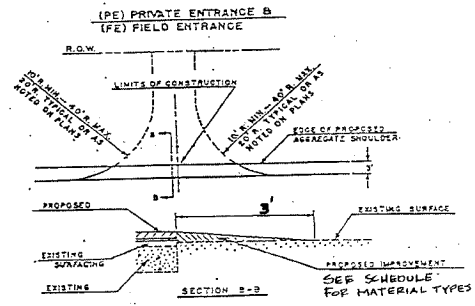
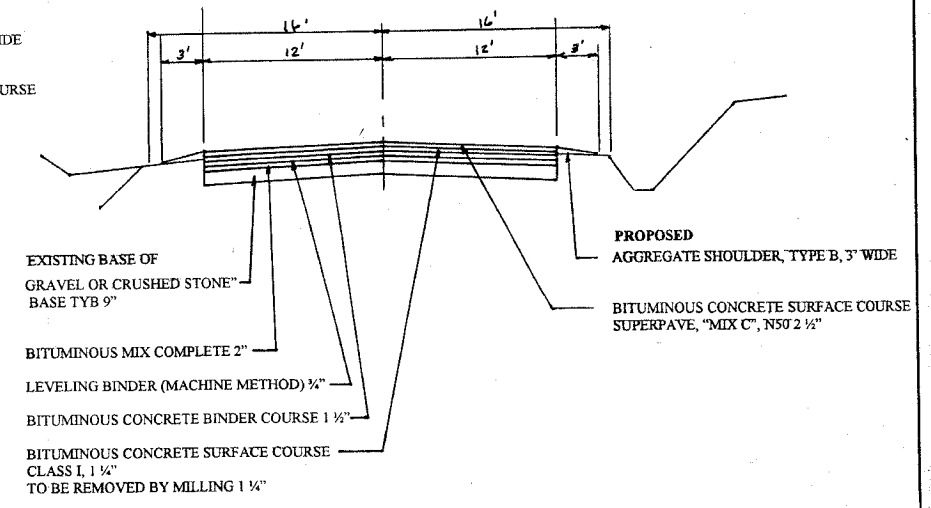

TYPICAL BUTT JOINT
 STA. 391+78.70
 END OF ROAD (BUT INTO ROW RD.)

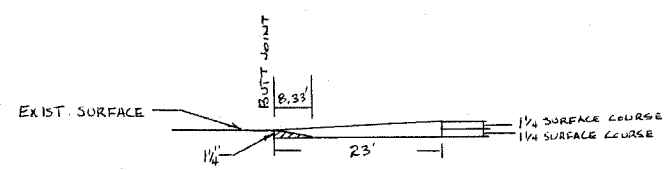

BUTT JOINT @ ODIN RD
 STA. 237+00

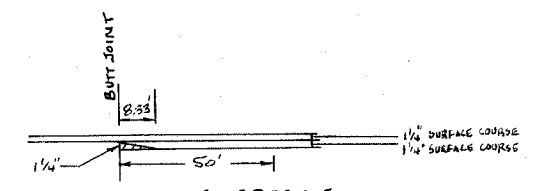

BUTT JOINT @ BRIDGE
 STA. 18+75.04
 STA. 20+75.64

ROUTE	SECTION	COUNTY	TOTAL SHEETS	SHEET NO.
*	**	MAHON	4	4

STA. 6+34 (CENTER OF DOUGLAS ST.) TO
 STA. 63+14 (CENTER OF BREWERY HILL RD.)

ENTRANCE SCHEDULE

TYPE	SIDE	STATION	AGG SURF CSE	BIT CONC SURF CSE SUPERPAVE MIX "C" N-50
			TON	TON
PE	RT	6+53		0.7
PE	RT	7+30		0.7
PE	RT	10+25		0.7
PE	RT	11+35		0.7
PE	RT	11+90		0.7
PE	RT	12+43		0.7
PE	RT	13+00		0.7
PE	RT	14+25		0.7
PE	RT	15+15		0.7
PE	LT	17+40	1.0	0.7
PE	RT	17+60		0.7
PE	RT	18+25		0.7
PE	RT	21+00		0.7
PE	RT	21+80		0.7
PE	LT	22+80	1.0	0.7
PE	RT	23+75	1.0	0.7
PE	LT	24+60		0.7
PE	RT	25+50		0.7
PE	LT	26+12	1.0	0.7
PE	LT	27+00		0.7
PE	RT	28+00		0.7
PE	RT	29+50		0.7
PE	RT	31+90	1.0	0.7
PE	RT	34+75		0.7
PE	LT	35+80		0.7
PE	RT	36+78		0.7
PE	RT	38+00	1.0	0.7
PE	LT	47+10	1.0	0.7
PE	RT	50+84	1.0	0.7
PE	LT	52+44	1.0	0.7
PE	LT	52+63		0.7
PE	LT	55+10	1.0	0.7
PE	RT	62+98		0.7
TOTALS			19.0	16.10

CLASS D PATCHES 8"

TYPE I	TYPE II	TYPE II	TYPE IV
(5'x5')	(6'x20')		
STA. 2+30	STA. 0+00		
STA. 4+00 (4'x7')	(6'x10')		
STA. 4+70 (4'x6')	STA. 4+50		
	(6'x30')		
	STA. 10+20		
	(6'x10')		
	STA. 10+60		
	STA. 16+30 (10'x10')	(12'x12')	
	STA. 55+50 (10'x10')	STA. 54+00	
		(10'x40')	STA. 55+50

SCHEDULE OF SIDE ROADS

NAME	SIDE	STATION	BIT CONC SURF CSE SUPERPAVE MIX "C" N-50
			TON
DOUGLAS	LT	6+34	1.5
ALLEY	LT	8+00	1.5
HARRISON	LT-RT	9+68	3.0
ALLEY	LT	11+35	1.5
BREESE	LT	13+08	1.5
TRAILER PARK	RT	14+06	1.5
ALLEY	LT	14+74	1.5
MORRISON	LT-RT	16+38	3.0
BRICK HILL	RT	42+64	1.5
BREWERY HILL	LT	63+14	1.5
TOTAL			= 18.0

STA. 63+14 (CENTER OF BREWERY HILL) TO
 STA. 324+18 (CENTER OF BELL CLUB RD.)

TYPE	SIDE	STATION	AGG SURF CSE	BIT CONC SURF CSE SUPERPAVE MIX "C" N-50	FE	RT	STATION	AGG SURF CSE	BIT CONC SURF CSE SUPERPAVE MIX "C" N-50	FE	RT		
			TON	TON									
PE	LT	65+08		0.7	PE	RT	113+85	1.0	0.7	FE	RT	221+10	1.0
PE	LT	70+00		0.7	PE	RT	120+84		0.7	FE	LT	222+00	1.0
PE	RT	70+20		0.7	PE	LT	121+67		0.7	FE	LT	228+37	1.0
PE	RT	72+00		0.7	PE	RT	121+62	1.0	0.7	FE	RT	227+96	1.0
PE	LT	72+40		0.7	PE	RT	122+50	1.0	0.7	FE	RT	229+24	1.0
PE	LT	74+00		0.7	PE	LT	123+45	1.0	0.7	FE	LT	231+25	1.0
PE	LT	76+00		0.7	PE	RT	124+00	1.0	0.7	FE	LT	233+00	1.0
PE	LT	76+40		0.7	PE	LT	124+80	1.0	0.7	FE	RT	234+67	1.0
PE	RT	76+40		0.7	PE	RT	132+39	1.0	0.7	FE	LT	236+20	1.0
PE	RT	76+60		0.7	PE	RT	133+40	1.0	0.7	FE	RT	251+15	1.0
PE	RT	76+80		0.7	PE	RT	134+60	1.0	0.7	FE	LT	251+62	1.0
PE	RT	76+80		0.7	PE	RT	135+80	1.0	0.7	FE	LT	251+50	1.0
PE	RT	76+80		0.7	PE	RT	137+00	1.0	0.7	FE	LT	253+15	1.0
PE	RT	76+80		0.7	PE	LT	139+66	1.0	0.7	FE	RT	253+40	1.0
PE	RT	76+80		0.7	PE	RT	142+72	1.0	0.7	FE	LT	257+32	1.0
PE	LT	77+80		0.7	PE	LT	144+50	1.0	0.7	FE	RT	257+71	1.0
PE	LT	79+20		0.7	PE	LT	146+43	1.0	0.7	FE	RT	258+90	1.0
PE	RT	81+00		0.7	PE	LT	149+31	1.0	0.7	FE	RT	261+31	1.0
PE	RT	82+00		0.7	PE	RT	151+70	1.0	0.7	FE	LT	271+00	1.0
PE	RT	83+64		0.7	PE	LT	154+63	1.0	0.7	FE	LT	274+14	1.0
PE	RT	83+84		0.7	PE	RT	156+57	1.0	0.7	FE	RT	280+35	1.0
PE	LT	84+00		0.7	PE	LT	156+93	1.0	0.7	FE	LT	281+85	1.0
PE	LT	88+22		0.7	PE	RT	160+00	1.0	0.7	FE	RT	283+70	1.0
PE	LT	88+86		0.7	PE	RT	162+57	1.0	0.7	FE	LT	284+00	1.0
PE	LT	90+63		0.7	PE	LT	162+64	1.0	0.7	FE	LT	288+00	1.0
PE	RT	91+10		0.7	PE	RT	165+00	1.0	0.7	FE	RT	291+05	1.0
PE	RT	92+00		0.7	PE	LT	167+44	1.0	0.7	FE	LT	290+89	1.0
PE	LT	92+40		0.7	PE	RT	169+00	1.0	0.7	FE	RT	293+69	1.0
PE	LT	93+57		0.7	PE	LT	169+12	1.0	0.7	FE	LT	293+69	1.0
PE	LT	95+56		0.7	PE	LT	172+50	1.0	0.7	FE	RT	302+41	1.0
PE	LT	96+12	1.0	0.7	PE	RT	176+75	1.0	0.7	FE	RT	305+34	1.0
PE	LT	104+59	1.0	0.7	PE	LT	177+50	1.0	0.7	FE	LT	306+74	1.0
PE	RT	104+70	1.0	0.7	PE	LT	183+20	1.0	0.7	FE	LT	308+36	1.0
PE	RT	105+10	1.0	0.7	PE	LT	184+50	1.0	0.7	FE	RT	311+32	1.0
PE	LT	105+40		0.7	PE	LT	185+60	1.0	0.7	FE	LT	313+00	1.0
PE	LT	110+63		0.7	PE	LT	187+00	1.0	0.7	FE	LT	315+00	1.0
PE	LT	111+93		0.7	PE	LT	189+00	1.0	0.7	FE	RT	319+88	1.0
FE	RT	112+80	1.0	0.7	PE	LT	191+50	1.0	0.7	FE	LT	321+20	1.0
FE	LT	113+68	1.0	0.7	PE	LT	193+00	1.0	0.7	FE	LT	323+18	1.0
					PE	LT	194+00	1.0	0.7				
					PE	LT	194+80	1.0	0.7				
					PE	LT	198+08	1.0	0.7				
					PE	LT	199+76	1.0	0.7				
					FE	RT	210+52	1.0	0.7				
					PE	LT	212+45	1.0	0.7				
TOTALS								41.0		TOTALS			56.0

NAME	SIDE	STATION	BIT CONC SURF CSE SUPERPAVE MIX "C" N-50
			TON
ARBOR	RT	65+43	1.5
LAKEPOINT	RT	92+86	1.5
LANGENFELD	RT	104+26	1.5
DOGWOOD	RT	111+38	1.5
NORTON	LT-RT	125+88	3.0
DUNBAR	RT	152+80	1.5
FARTHING	LT	180+39	1.5
ROSS	RT	194+80	1.5
ODIN	LT-RT	237+00	10.0
WESTLINE	LT	279+61	1.5
BELL CLUB	LT-RT	324+18	3.0
TOTAL			= 28.0

STA. 324+18 (CENTER OF BELL CLUB RD.) TO
 STA. 390+70 (CENTER OF RUBLE RD.)

TYPE	SIDE	STATION	AGG SURF CSE	BIT CONC SURF CSE SUPERPAVE MIX "C" N-50
			TON	TON
PE	RT	328+47		0.7
PE	LT	328+41		0.7
PE	LT	334+15		0.7
PE	LT	335+63		0.7
PE	RT	336+21		0.7
PE	LT	336+21		0.7
PE	LT	337+84		0.7
PE	RT	342+36		0.7
PE	LT	342+52		0.7
PE	LT	344+85		0.7
PE	LT	347+81		0.7
PE	RT	349+18	1.0	0.7
PE	RT	350+03		0.7
PE	LT	350+60	1.0	0.7
PE	LT	351+45		0.7
PE	LT	352+60		0.7
PE	LT	353+20	1.0	0.7
PE	LT	355+60		0.7
PE	RT	360+10		0.7
PE	LT	362+12		0.7
PE	LT	368+50		0.7
PE	LT	373+10		0.7
PE	LT	377+45		0.7
PE	RT	377+45		0.7
PE	RT	381+64		0.7
PE	LT	385+97		0.7
PE	LT	387+05		0.7
PE	LT	388+12		0.7
PE	RT	389+34		0.7
TOTALS			3.0	18.2

TYPE I	TYPE II	TYPE II	TYPE IV
	(6'x10')		(6'x40')
	STA. 377+00 LT.		STA. 66+00 LT.

NAME	SIDE	STATION	BIT CONC SURF CSE SUPERPAVE MIX "C" N-50
			TON
COLESTOCK	LT-RT	350+92	3.0
LAKE SHORE	RT	368+50	1.5
SCOUT	RT	384+90	1.5
RUBLE	LT	390+70	1.5
TOTAL			= 7.5

SCHEDULE OF THERMOPLASTIC PAVEMENT MARKING - 4" STU SECTION

TYPE OF LINE	LENGTH YELLOW (FT)	LENGTH WHITE (FT)
Centerline Stripe	1751	
No Passing Zone Stripe	1005	
EdgeLine		12419
Totals	2756	12419

SCHEDULE OF THERMOPLASTIC PAVEMENT MARKING - 4" STR SECTION

TYPE OF LINE	LENGTH YELLOW (FT)	LENGTH WHITE (FT)
Centerline Stripe	6305	
No Passing Zone Stripe	27580	
EdgeLine		63197
Totals	33885	63197