

JUN 13, 2005 11:40 AM CCC  
I:\AIRPORTS\DECATUR\02-04TX\RD\AIRPORT SHEETS\CONTRACT-2\1-R-701P\NP.DWG - STA. 378+00 TO 391+00

BITUMINOUS QUANTITIES				
ITEM No.	DESCRIPTION	LOCATION	S.Y.	TONS
AR201610	BITUMINOUS BASE COURSE	BITUMINOUS WIDENING	8,182	4,909
AR201610	BITUMINOUS BASE COURSE	PCC WIDENING	8,494	2,039
AR401610	BITUMINOUS SURFACE COURSE	BITUMINOUS WIDENING	8,023	1,926
AR401610	BITUMINOUS SURFACE COURSE	BITUMINOUS OVERLAY	10,992	2,821

**LEGEND**

- EXISTING PAVEMENT
- PROPOSED BITUMINOUS MILLING
- PROPOSED BITUMINOUS PAVEMENT
- PROPOSED P.C.C. PAVEMENT
- EXISTING UNDERDRAIN
- EXISTING STORM SEWER
- PROPOSED STORM SEWER
- EXISTING INLET
- EXISTING MANHOLE
- EXISTING INSPECTION HOLE
- PROPOSED INLET
- PROPOSED MANHOLE
- PROPOSED PIPE EXTENSION WITH HEADWALL

DE265

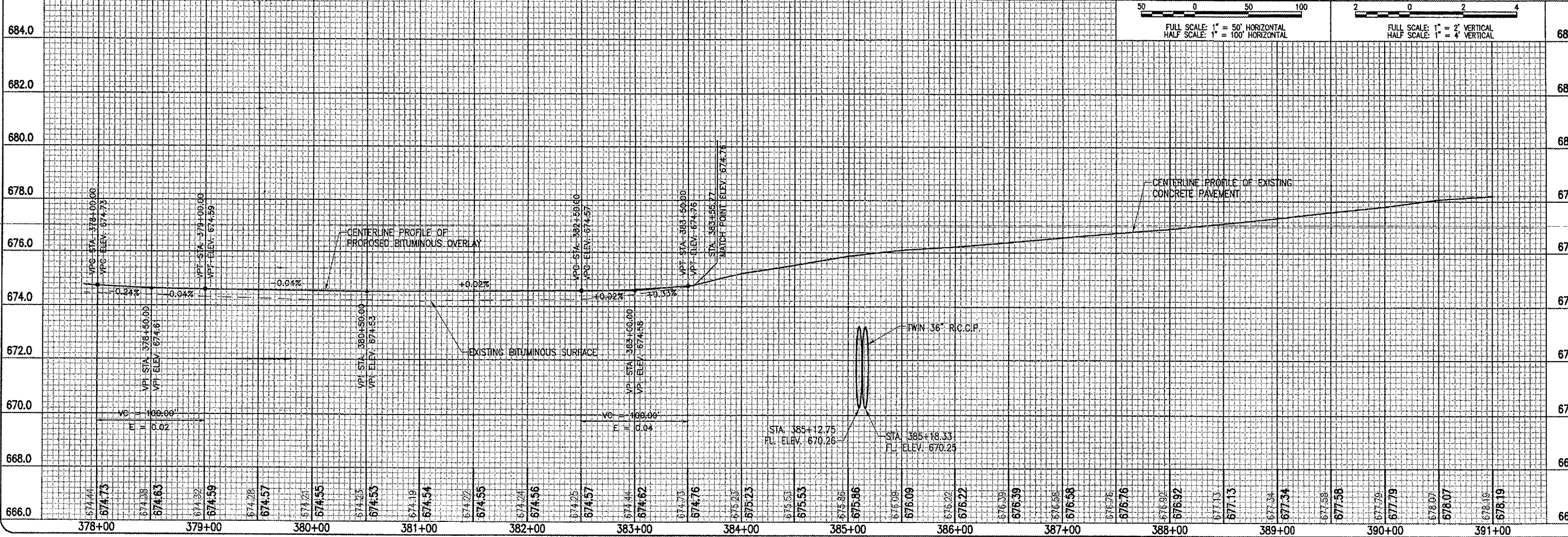
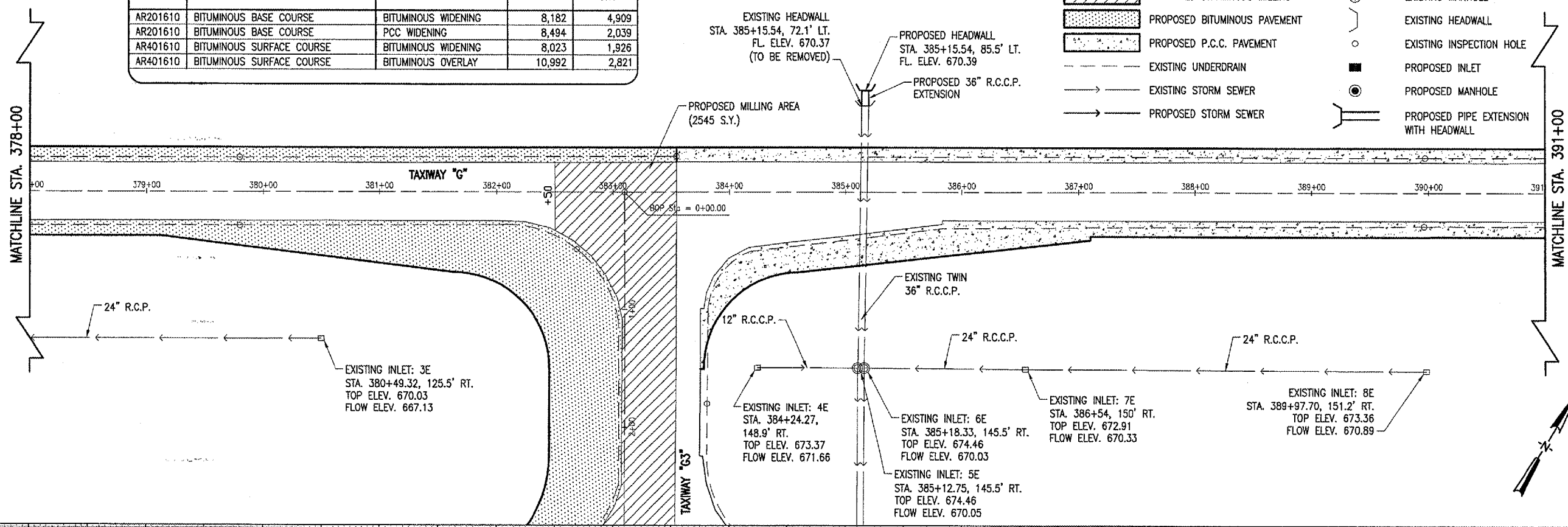

 <b>HANSON</b> <small>Engineers, Architects, Scientists 1925 South Sixth Street Springfield, Illinois 62703-2886 Offices Nationwide</small>	<b>TAXIWAY G WIDENING PHASE II</b> PROPOSED PLAN & PROFILE TAXIWAY "G" STA. 378+00 TO STA. 391+00	<div style="font-size: 2em; font-weight: bold;">13</div> <small>13 of 110 sheets</small>	<table border="1" style="width: 100%; border-collapse: collapse;"> <tr> <td style="font-size: 8px;">           I.D. Project No. 802-04TXVD            Element R-701P/NP.DWG            Scale 1"=50'H, 1"=2'V            Date 03/18/05         </td> <td style="font-size: 8px;">           LAYOUT            DRAWN CCC            REVIEWED WJM         </td> <td style="font-size: 8px;">           DATE            REVISION         </td> </tr> </table>	I.D. Project No. 802-04TXVD Element R-701P/NP.DWG Scale 1"=50'H, 1"=2'V Date 03/18/05	LAYOUT DRAWN CCC REVIEWED WJM	DATE REVISION
I.D. Project No. 802-04TXVD Element R-701P/NP.DWG Scale 1"=50'H, 1"=2'V Date 03/18/05	LAYOUT DRAWN CCC REVIEWED WJM	DATE REVISION				