

CONSTRUCTION PLANS

FOR

FLORA AIRPORT

FLORA, CLAY COUNTY, ILLINOIS

REMOVE AND REPLACE CLASS "E" FENCE

SCOPE OF WORK

THIS PROJECT CONSISTS OF REMOVAL AND REPLACEMENT OF 1195 LF OF 4-FT CHAIN LINK FENCE (CLASS E). ASSOCIATED WORK WILL INCLUDE INCIDENTAL CLEARING AND GRUBBING.

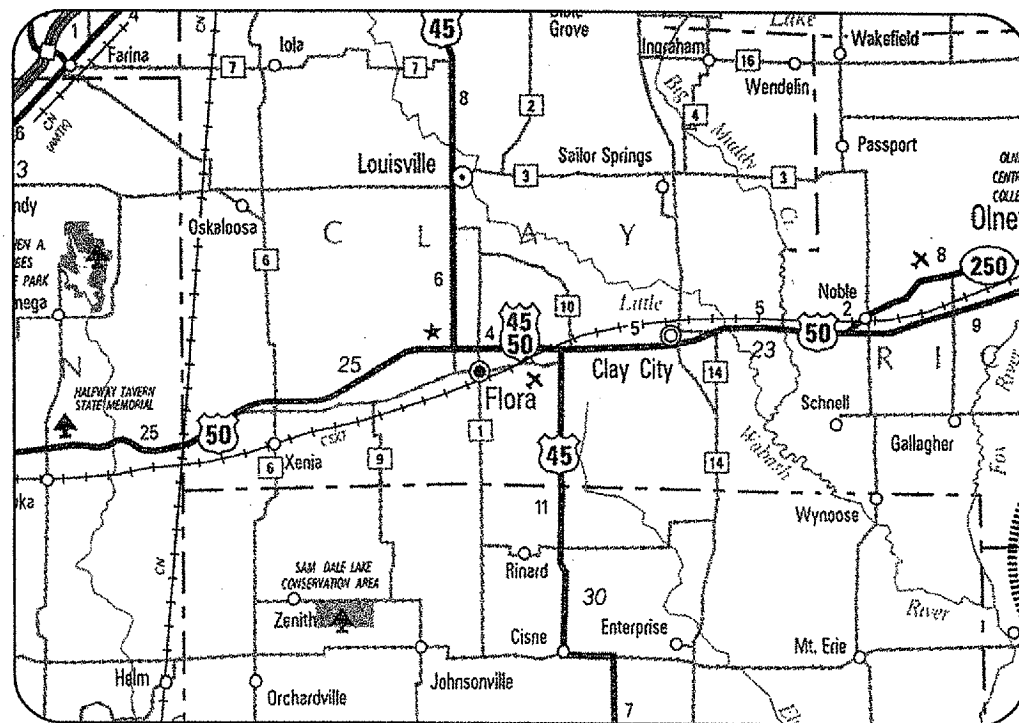

LOCATION

ILL. PROJ.: FOA-3506
 A.I.P. PROJ.: 3-17-0044-B11
 LATITUDE: 38° 39' 57"
 LONGITUDE: 88° 27' 09"
 ELEVATION: 472.0' M.S.L.
 DATE: MAY 31, 2004

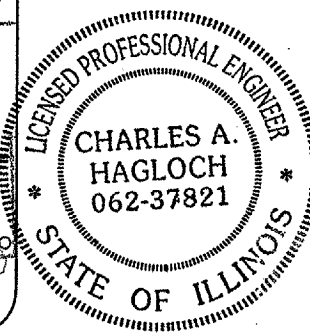

REVISED: 07/14/05

HANSON
 Hanson Professional Services Inc.

Submitted by: *Charles A. Hagloch* ENG'R
 Date Submitted: *July 14, 2005*
 Lic. Exp. Date: *Nov. 30, 2005*

AIRPORT AUTHORITY OF FLORA

Approved: *[Signature]* CHAIRMAN
 Date: *7/14/05*
 Approved: _____ SECRETARY
 Date: *6-14-05*

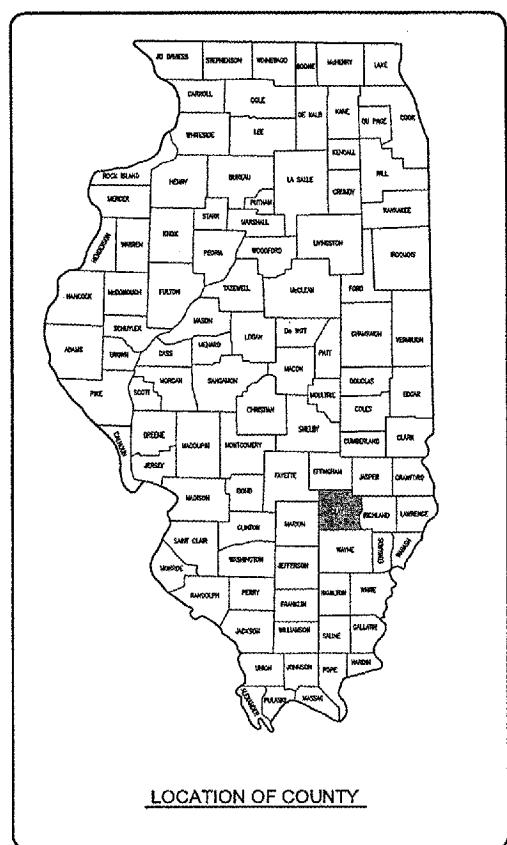

JUL 14, 2005 9:10 AM CAH
I:\AIRPORTS\FLORA\B06-05\FNC\AIRPORT\ SHEETS\R-001\CVR.DWG - COVER

| | | | | | | | | | |
|--|------------------|-----|-----|-----|-------------|--|--|--|--|
| BY | | | | | | | | | |
| REVISION | | | | | | | | | |
| DATE | | | | | | | | | |
| FLORA AIRPORT FLORA, ILLINOIS | | | | | | | | | |
| ILL. PROJ.: FOA-3506 A.I.P. PROJ.: 3-17-0044-B11 | | | | | | | | | |
| ILL. PROJ. No. | 806-05FNGCD.0800 | | | | | | | | |
| Filename | R-001\CVR.DWG | | | | | | | | |
| Scale | N/A | | | | | | | | |
| Date | 04/27/05 | | | | | | | | |
| LAYOUT | RAW | RAW | RAW | CAH | ? | | | | |
| DRAWN | RAW | RAW | RAW | CAH | ? | | | | |
| REVIEWED | | | | | | | | | |
| Hanson Professional Services Inc. 1525 South Sixth Street Springfield, Illinois 62705-2888 Offices Nationwide | | | | | | | | | |
| REMOVE AND REPLACE CLASS "E" FENCE | | | | | COVER SHEET | | | | |
| 1 | | | | | | | | | |
| 1 of 4 sheets | | | | | | | | | |

FL028

SUMMARY OF QUANTITIES

| ITEM NO. | DESCRIPTION | UNIT | TOTAL QUANTITIES | AS BUILT QUANTITIES |
|----------|----------------------|------|------------------|---------------------|
| AR162504 | CLASS E FENCE, 4' | L.F. | 1,195 | |
| AR162900 | REMOVE CLASS E FENCE | L.F. | 1,195 | |

INDEX TO SHEETS

| SHEET NO. | DESCRIPTION |
|-----------|--|
| 1 | COVER SHEET |
| 2 | SUMMARY OF QUANTITIES, INDEX TO SHEETS |
| 3 | PROPOSED SAFETY PLAN |
| 4 | PROPOSED FENCING PLAN |

| DATE | REVISION | BY |
|------|----------|----|
| | | |
| | | |
| | | |
| | | |
| | | |
| | | |
| | | |
| | | |
| | | |
| | | |

FLORA AIRPORT
 FLORA, ILLINOIS

IL PROJ.: FOA-3506 A.I.P. PROJ.: 3-17-0044-B11

| | | |
|--|-------------------------------------|---------------------------|
| HB Project No. 806-05FNC00 0800 Filename R-002FLP.DWG Scale N/A Date 04/27/05 | LAYOUT DRAWN RAW REVIEWED CAH | 04/27/05 04/27/05 ? |
|--|-------------------------------------|---------------------------|



Hanson Professional Services Inc.
 1525 South Sixth Street
 Springfield, Illinois 62703-2886
 Offices Nationwide

REMOVE AND REPLACE
 CLASS "E" FENCE

SUMMARY OF QUANTITIES
 INDEX TO SHEETS

2

SCOPE OF WORK

THIS PROJECT CONSISTS OF REMOVAL AND REPLACEMENT OF 1195 LF OF 4-FT CHAIN LINK FENCE (CLASS E). ASSOCIATED WORK WILL INCLUDE INCIDENTAL CLEARING AND GRUBBING.

UTILITY NOTE

THE CONTRACTOR SHALL CONTACT ALL UTILITY COMPANIES AND AGENCIES WHICH HAVE LINES OR CONDUITS IN THE PROPOSED WORK AREA. ALL LINES AND CONDUITS SHALL BE LOCATED AND IDENTIFIED FOR DEPTH BEFORE ANY EXCAVATION BEGINS. THE CONTRACTOR WILL CALL J.U.L.I.E. (1-800-892-0123) TO ACCOMPLISH THE ABOVE. IT IS THE CONTRACTOR'S RESPONSIBILITY TO IDENTIFY ALL UNDERGROUND NON-JULIE UTILITIES LOCATED WITHIN THE PROPOSED CONSTRUCTION LIMITS. THESE UNDERGROUND IMPROVEMENTS WILL BE LOCATED AT THE CONTRACTOR'S OWN EXPENSE PRIOR TO THE START OF CONSTRUCTION ACTIVITIES.

HEIGHT OF CONSTRUCTION EQUIPMENT

THE MAXIMUM ANTICIPATED HEIGHT OF THE CONSTRUCTION EQUIPMENT WILL BE 15 FEET. THE TALLEST EQUIPMENT IS EXPECTED TO BE A REDI-MIX CONCRETE TRUCK.

HAUL ROUTE AND VEHICLE PARKING

THE CONTRACTOR WILL USE THE DESIGNATED HAUL ROUTE AND PARKING AREA AS SHOWN ON THIS SHEET. THE PROPOSED PARKING AREA WILL BE 100' X 200'. THE CONTRACTOR WILL BE REQUIRED TO MAINTAIN THE PROPOSED HAUL ROUTE AND PARKING AREA THROUGHOUT THE COURSE OF THE PROJECT. ANY AREAS DAMAGED OUTSIDE OF THESE AREAS WILL BE REPAIRED BY THE CONTRACTOR AND AT THE CONTRACTOR'S OWN EXPENSE. AT THE CONCLUSION OF THE PROJECT THE CONTRACTOR WILL GRADE, FERTILIZE, SEED AND MULCH THE HAUL ROUTE AND PARKING AREA AS NEEDED TO RESTORE IT TO ITS ORIGINAL STATE. RESTORATION OF THE HAUL ROUTE AND PARKING AREA WILL BE CONSIDERED INCIDENTAL TO THE PROJECT AND NO ADDITIONAL COMPENSATION WILL BE ALLOWED.

CONTRACTOR RESPONSIBILITIES

THE CONTRACTOR'S EQUIPMENT PARKING AND STORAGE AREA WILL BE AS SHOWN ON THIS SHEET. THE CONTRACTOR'S EMPLOYEES WILL PARK THEIR VEHICLES IN THIS AREA. ONLY CONTRACTOR VEHICLES WILL BE ALLOWED OUTSIDE THIS AREA.

THE CONTRACTOR AND HIS EMPLOYEES WILL BE RESTRICTED TO THE WORK AREA AND ALL OTHER AREAS OF THE AIRPORT ARE "OFF LIMITS" TO THEM.

THE CONTRACTOR SHALL KEEP RUNWAY 3-21 OPEN AT ALL TIMES AND MAINTAIN CONTINUOUS AIRPORT ENTRANCE ACCESS.

ALL WORK PERFORMED SHALL BE DONE IN A ORDERLY AND EFFECTIVE MANNER TO MINIMIZE RUNWAY CLOSURE AND INCONVENIENCE TO THE AIRPORT VEHICULAR TRAFFIC.

NO TRENCHES OR HOLES WILL REMAIN OPEN OVERNIGHT.

NO RUNWAY SHALL BE CLOSED OVERNIGHT.

THE LOCATION, SIZE AND TYPE OF MATERIAL OF EXISTING UNDERGROUND UTILITIES INDICATED ON THE PLANS IS NOT REPRESENTED AS BEING ACCURATE, SUFFICIENT OR COMPLETE. IT SHALL BE THE CONTRACTOR'S RESPONSIBILITY TO DETERMINE THE ACTUAL LOCATION OF ALL SUCH FACILITIES, INCLUDING SERVICE CONNECTIONS TO UNDERGROUND UTILITIES. PRIOR TO CONSTRUCTION, THE CONTRACTOR SHALL NOTIFY THE UTILITY COMPANIES OF HIS OPERATIONAL PLANS AND SHALL OBTAIN FROM THE RESPECTIVE UTILITY COMPANIES DETAILED INFORMATION AND ASSISTANCE RELATIVE TO THE LOCATION OF THEIR FACILITIES AND THE WORKING SCHEDULE OF THE COMPANIES FOR REMOVAL OR ADJUSTMENT WHERE REQUIRED. IN THE EVENT AN UNEXPECTED UTILITY INTERFERENCE IS ENCOUNTERED DURING CONSTRUCTION, THE CONTRACTOR SHALL IMMEDIATELY NOTIFY THE UTILITY COMPANY OF JURISDICTION. THE ENGINEER SHALL ALSO BE IMMEDIATELY NOTIFIED. ANY SUCH MAINS AND SERVICES SHALL BE RESTORED TO SERVICE AT ONCE AND PAID FOR BY THE CONTRACTOR AT NO ADDITIONAL COST TO THE CONTRACT.

CALL J.U.L.I.E. FOR UTILITY INFORMATION AT 1-800-892-0123.

LEGEND

- EXISTING FENCE
- PROPOSED FENCE
- EXISTING BUILDINGS
- PROPOSED HAUL ROUTE AND EQUIPMENT PARKING AREA
- ① EXISTING CONTROL POINT

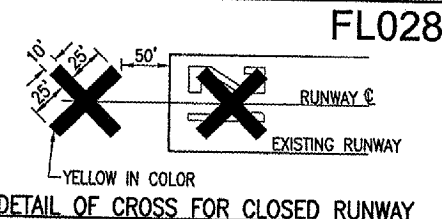
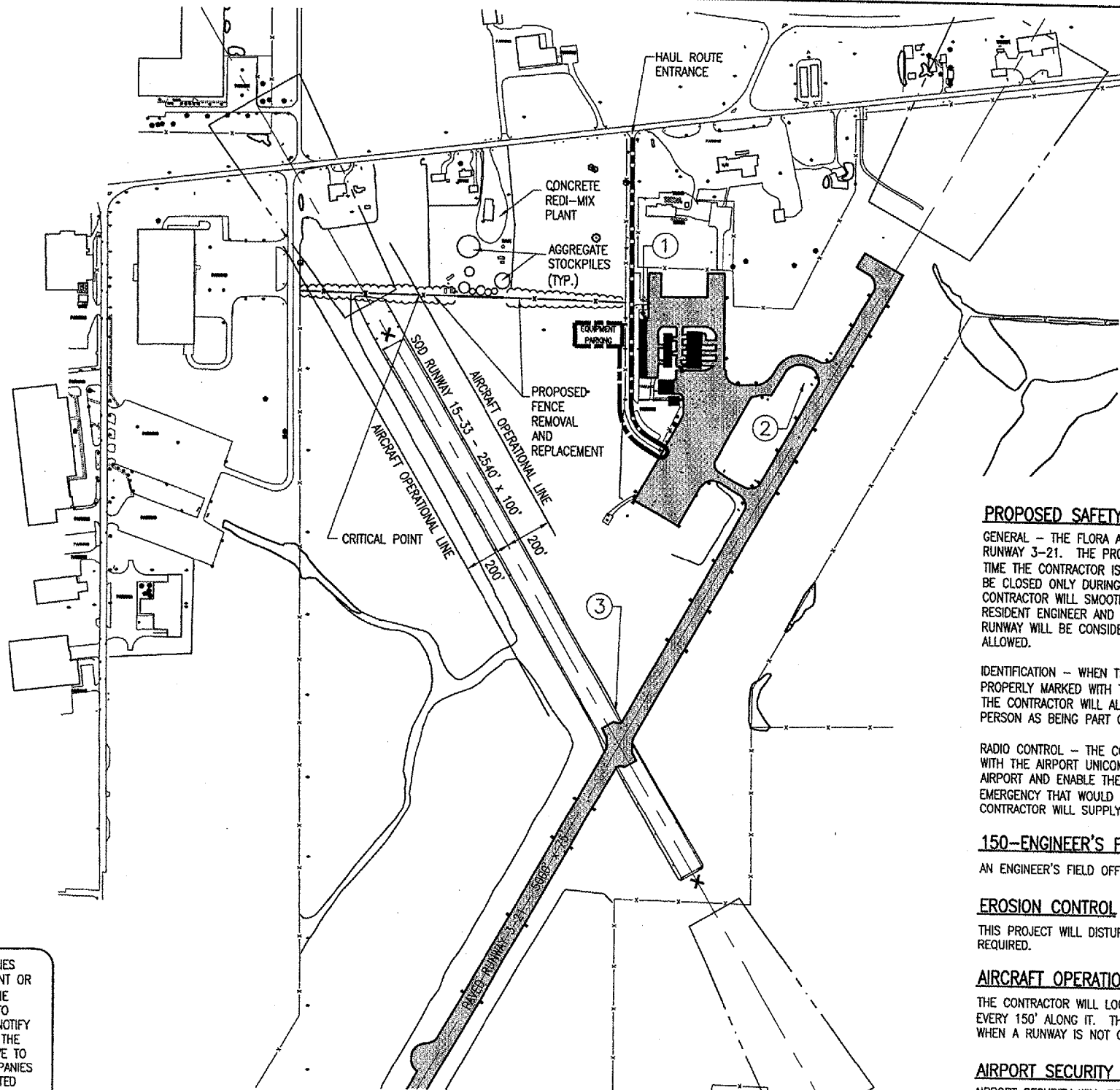

NOTE:
 COST OF CONSTRUCTING, PLACING, MAINTAINING AND REMOVING CROSSES WILL BE CONSIDERED INCIDENTAL TO THE CONTRACT AND NO ADDITIONAL COMPENSATION WILL BE ALLOWED. THE CROSSES WILL BE YELLOW IN COLOR AND SHALL BE MADE OF A SUITABLE MATERIAL AS APPROVED BY THE AIRPORT MANAGER. THE CROSSES WILL BE PLACED OVER THE NUMERALS AND SECURED IN A MANNER APPROVED BY THE MANAGER. THE PROPOSED CROSSES WILL BE PLACED EACH DAY THE RUNWAY IS CLOSED AND REMOVED WHEN THE RUNWAY IS RE-OPENED. THE CONTRACTOR WILL BE RESPONSIBLE FOR THE PLACEMENT AND REMOVAL OF THE CROSSES. NO ADDITIONAL COMPENSATION WILL BE ALLOWED.

J.U.L.I.E. INFORMATION
 COUNTY: CLAY
 CITY: FLORA
 TOWNSHIP: STANFORD
 SECTION NO.: 29
 ADDRESS: FLORA AIRPORT
 ONE AIRPORT ROAD
 FLORA, ILLINOIS 62839

PROPOSED SAFETY PLAN

GENERAL - THE FLORA AIRPORT IS COMPRISED OF TWO RUNWAYS: A SOD RUNWAY 15-33 AND A PAVED RUNWAY 3-21. THE PROPOSED CONSTRUCTION WILL NECESSITATE CLOSING RUNWAY 15-33 ANY TIME THE CONTRACTOR IS WORKING WITHIN 200' OF THE RUNWAY 15-33 CENTERLINE. THE RUNWAY WILL BE CLOSED ONLY DURING THE CONSTRUCTION DAY. AT THE END OF EACH CONSTRUCTION DAY THE CONTRACTOR WILL SMOOTH GRADE ALL AREAS WITHIN THE SAFETY AREA TO THE SATISFACTION OF THE RESIDENT ENGINEER AND RE-OPEN THE RUNWAY. ALL WORK INCLUDED IN OPENING AND CLOSING THE RUNWAY WILL BE CONSIDERED INCIDENTAL TO THE PROJECT AND NO ADDITIONAL COMPENSATION WILL BE ALLOWED.

IDENTIFICATION - WHEN THE CONTRACTORS VEHICLES AND EQUIPMENT ARE ON THE AIRPORT THEY SHALL BE PROPERLY MARKED WITH THREE (3') FOOT SQUARE CHECKERED FLAGS (INTERNATIONAL ORANGE AND WHITE). THE CONTRACTOR WILL ALSO PROVIDE WORKERS WITH SOME TYPE OF TAG OR GARMENT TO IDENTIFY THE PERSON AS BEING PART OF THE CONSTRUCTION CREW.

RADIO CONTROL - THE CONTRACTOR WILL BE REQUIRED TO BE IN TWO-WAY RADIO CONTACT (122.70 MHz.) WITH THE AIRPORT UNICOM. THIS WILL KEEP THE CONTRACTOR IN CONSTANT CONTACT WITH THE FLORA AIRPORT AND ENABLE THE AIRPORT TO IMMEDIATELY CONTACT THE CONTRACTOR IN CASE OF AN AERONAUTIC EMERGENCY THAT WOULD REQUIRE ACTION BY THE CONTRACTOR AND/OR HIS PERSONNEL. THE CONTRACTOR WILL SUPPLY HIS OWN TWO-WAY RADIO.

150-ENGINEER'S FIELD OFFICE NOTES

AN ENGINEER'S FIELD OFFICE WILL BE NOT BE REQUIRED FOR THIS PROJECT.

EROSION CONTROL

THIS PROJECT WILL DISTURB LESS THAN 1 ACRE OF LAND, THEREFORE NO N.P.D.E.S. PERMIT WILL BE REQUIRED.

AIRCRAFT OPERATION LINE

THE CONTRACTOR WILL LOCATE THIS LINE AT THE START OF CONSTRUCTION AND WILL PLACE FLAGGED LATHE EVERY 150' ALONG IT. THIS LINE WILL BE THE LIMITS THAT ALL CONTRACTOR PERSONNEL MAY VENTURE WHEN A RUNWAY IS NOT CLOSED. THE CONTRACTOR WILL MAINTAIN THE LATHE LINE FOR RUNWAYS.

AIRPORT SECURITY NOTE

AIRPORT SECURITY WILL BE MAINTAINED AT ALL TIMES. THE CONTRACTOR WILL CLOSE AND LOCK THE EXISTING GATE IN THE HAUL ROUTE AT THE END OF EACH WORKING DAY.

CRITICAL POINT DATA

INTERSECTION OF FENCE ALIGNMENT WITH RUNWAY 15-33
 AIRCRAFT OPERATION LINE
 LATITUDE: 38° 40' 11.340"
 LONGITUDE: 88° 27' 22.959"
 ELEVATION: 471' M.S.L.

| HORIZONTAL CONTROL DATA | | | | |
|-------------------------|------------------------------------|---------------------------------------|-------------|-------------|
| NO. | MARKER | DESCRIPTION | NORTHING | EASTING |
| 1 | NGS "AIRPORT BEACON FLORA AIRPORT" | CENTER OF REVOLVING GREEN/WHITE LIGHT | 729,379.985 | 950,313.014 |
| 2 | NGS "FLORAPORT AZ MK" | STAINLESS STEEL ROD IN SLEEVE | 729,090.802 | 951,008.393 |
| 3 | NGS "FLORAPORT" | STAINLESS STEEL ROD W/O SLEEVE | 727,684.417 | 950,215.012 |

JUL 13, 2005 9:19 AM BAK I:\AIRPORTS\FLORA\806-05FNCD\AIRPORT\SHEETS\R-003SFY.DWG - Safety Plan

FL028

| | | | | | | | | | |
|--|----------|-----|--|-----|--|-----|--|---|--|
| DATE | REVISION | | | | | | | | |
| FLORA AIRPORT FLORA, ILLINOIS | | | | | | | | | |
| A.I.P. PROJ.: 3-17-0044-811 I.L. PROJ.: FOA-3506 | | | | | | | | | |
| I/E Project No. 806-05FNCD 0800 Name R-003SFY.DWG Scale 1"=300' Date 04/27/05 | | | | | | | | | |
| LAYOUT | | RAW | | RAW | | CAH | | ? | |
| DRAWN | | RAW | | RAW | | CAH | | ? | |
| REVIEWED | | RAW | | RAW | | CAH | | ? | |

Hanson Professional Services Inc.
 1525 South Sixth Street
 Springfield, Illinois 62703-2886
 Offices Nationwide

REMOVE AND REPLACE CLASS "E" FENCE

PROPOSED SAFETY PLAN

3

3 of 4 sheets

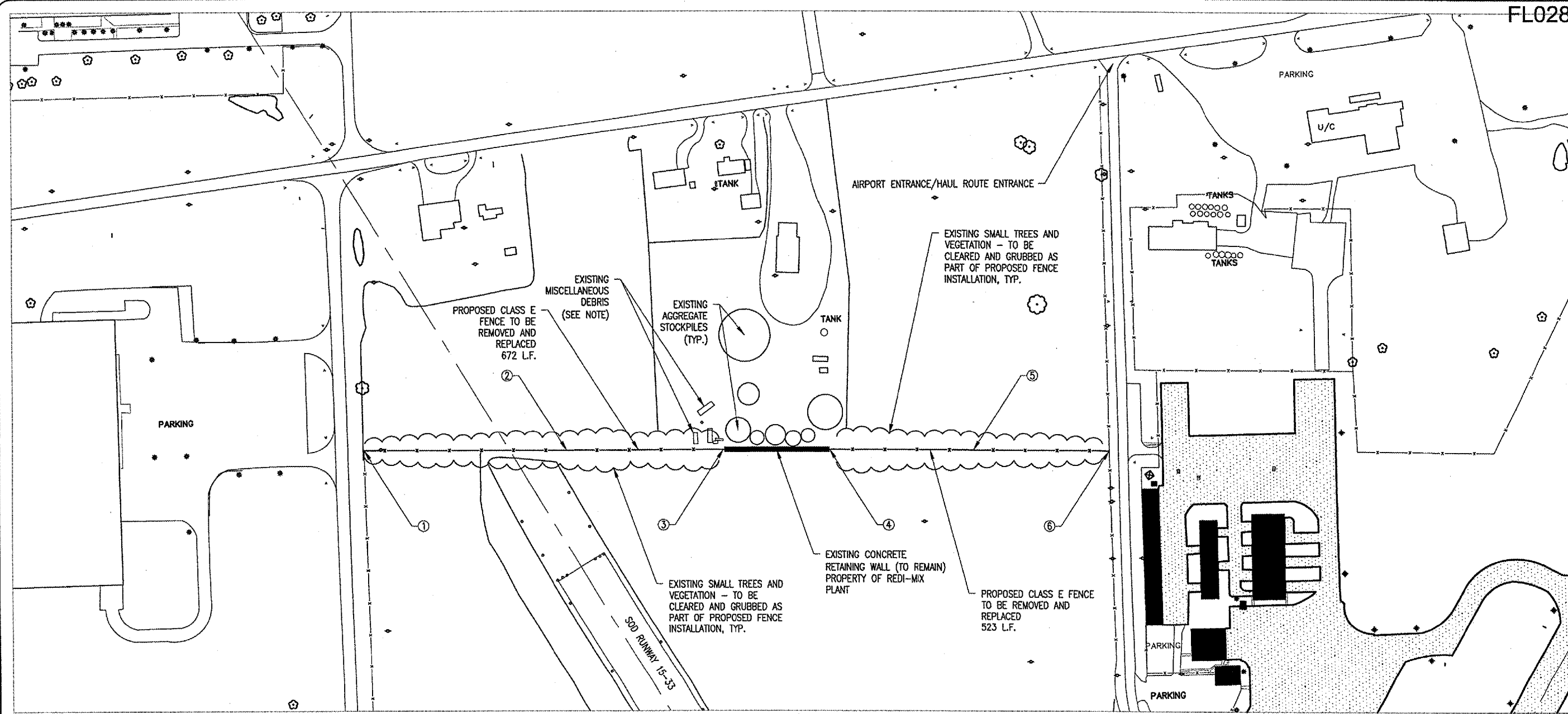

| DATE | REVISION | BY |
|----------|---------------------------|-----|
| 07/14/05 | REVISED AS PER IDA REVIEW | CAH |

FLORA AIRPORT
FLORA, ILLINOIS

IL PROJ.: FOA-3506 A.L.P. PROJ.: 3-17-0044-911

| DATE | REVISION | BY |
|----------|----------|----|
| 04/27/05 | RAW | ? |
| 04/27/05 | RAW | ? |
| 04/27/05 | CAH | ? |

U/I Project No. 806-05ENCO_0800
 Drawing: R-171FEN.DWG
 Scale: 1"=100'
 Date: 04/27/05



REMOVE AND REPLACE CLASS "E" FENCE

PROPOSED FENCING PLAN

162-FENCING NOTES:

THE PROPOSED FENCE WILL BE ERECTED ON THE SAME ALIGNMENT OF THE EXISTING 4'-FT CHAIN LINK FENCE (CLASS E), AS SHOWN. THE EXISTING FENCE FABRIC AND POSTS, INCLUDING ANY CONCRETE FOOTINGS AND OTHER ASSOCIATED ITEMS, WILL BE REMOVED PRIOR TO THE ERECTION OF THE PROPOSED CHAIN LINK (CLASS E) FENCE, AND PROPERLY DISPOSED OFF OF THE AIRPORT SITE AT THE EXPENSE OF THE CONTRACTOR. THE REMOVAL OF THE EXISTING FENCE WILL BE PAID FOR UNDER ITEM AR162900 - REMOVE CLASS E FENCE, PER L.F.

ALL FENCING PROPOSED WILL BE INSTALLED IN ACCORDANCE TO IDOT 664001-01 FOR CHAIN LINK FENCES, WITH THE EXCEPTION THAT A TOP RAIL WILL BE REQUIRED IN LIEU OF THE TOP TENSION WIRE, AND THE SUPPLEMENTAL SPECIFICATIONS AND RECURRING SPECIAL PROVISIONS, ADOPTED JULY 1, 2004. THE PROPOSED FENCE WILL BE PAID FOR UNDER ITEM AR162504 - CLASS E FENCE, 4', PER L.F.

THE CLASS E FENCE SHOWN WILL BE INSTALLED WITH THE FABRIC ON THE OUTSIDE OF THE FENCE POSTS. LIGHT CLEARING AND GRUBBING ON BOTH SIDES OF THE FENCE WILL BE REQUIRED TO ACCOMMODATE THE EQUIPMENT AND SPACE NECESSARY TO CONSTRUCT THE FENCE. ALL CLEARING AND GRUBBING NECESSARY TO COMPLETE THIS TASK WILL BE CONSIDERED INCIDENTAL TO THE ERECTION OF THE FENCE AND NO ADDITIONAL COMPENSATION WILL BE ALLOWED.

TEMPORARY REMOVAL OF THE MISCELLANEOUS DEBRIS (TRUCKS, TANKS, ETC.) NORTH OF THE EXISTING FENCE LINE AND PROPERTY OF THE ADJACENT REDI-MIX PLANT WILL BE THE RESPONSIBILITY OF THE PLANT OPERATOR. A PRIOR AGREEMENT WITH THE PLANT OPERATOR WILL BE MADE BY THE AIRPORT, HOWEVER THE CONTRACTOR WILL COORDINATE THE TEMPORARY REMOVAL OF THIS DEBRIS WITH THE PLANT OPERATOR PRIOR TO THE START OF THE PROJECT. THIS COORDINATION WILL BE CONSIDERED INCIDENTAL TO THE TASK OF CLEARING THE FENCE LINE FOR CONSTRUCTION OF THE PROPOSED FENCE AND NO ADDITIONAL COMPENSATION WILL BE ALLOWED.

ALL CONCRETE UTILIZED TO CONSTRUCT THE FENCE WILL CONFORM TO ITEM 610 - STRUCTURAL PORTLAND CEMENT CONCRETE.

| FENCING QUANTITIES | | | |
|--------------------|----------------------|------|----------|
| ITEM NO. | DESCRIPTION | UNIT | QUANTITY |
| AR162504 | CLASS E FENCE, 4' | L.F. | 1,195 |
| AR162900 | REMOVE CLASS E FENCE | L.F. | 1,195 |

| FENCE LOCATIONS | | | |
|-----------------|--------------|-------------|---------------|
| POINT | NORTHING (Y) | EASTING (X) | DESCRIPTION |
| 1 | 729,461.74 | 948,847.80 | END POST |
| 2 | 729,451.99 | 949,226.32 | POINT ON LINE |
| 3 | 729,445.88 | 949,519.67 | END POST |
| 4 | 729,441.15 | 949,716.73 | END POST |
| 5 | 729,443.60 | 949,984.07 | POINT ON LINE |
| 6 | 729,426.44 | 950,238.91 | END POST |

- EXISTING ROADWAY PAVEMENT
- EXISTING AIRFIELD PAVEMENT
- PROPOSED FENCE
- EXISTING FENCE
- EXISTING TREES AND LIGHT VEGETATION

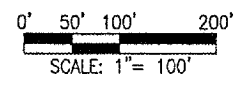
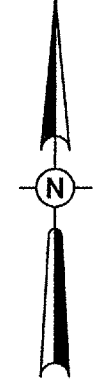

JUL 14, 2005 9:09 AM CAH
I:\AIRPORTS\FLORA 806-05FNC\AIRPORT\SHEETS\R-171FEN.DWG - Layout1