

HORIZONTAL/VERTICAL CONTROL					
NO.	STATION/OFFSET	ELEVATION	NORTHING	EASTING	DESCRIPTION
1	311+98.00 @ TAXIWAY G2	-	1775650.38	719616.74	INTERSECTION CENTERLINE TAXIWAY G2 AND CENTERLINE TAXIWAY G3
2	314+48.10 @ TAXIWAY G2	-	1775900.49	719615.00	INTERSECTION CENTERLINE TAXIWAY G2 AND CENTERLINE RUNWAY 9/27
3	316+98.10 @ TAXIWAY G2	-	1776150.48	719613.26	INTERSECTION CENTERLINE TAXIWAY G2 AND CENTERLINE TAXIWAY A
4	318+54.10 @ TAXIWAY G2	-	1776306.46	719612.18	INTERSECTION CENTERLINE TAXIWAY G2 AND APRON BASELINE
5	321+26.10 @ TAXIWAY G2	-	1776578.44	719610.29	INTERSECTION CENTERLINE TAXIWAY G2 AND ENTRANCE ROAD BASELINE
6	318+54.10, 300' RT, @ TAXIWAY G2	-	1776308.55	719912.17	EDGE OF APRON
7	502+28.16, @ ENTRANCE RD.	-	1776580.67	719938.43	ENTRANCE ROAD BASELINE
8	503+44.19, @ ENTRANCE RD.	-	1776696.69	719937.64	INTERSECTION ENTRANCE ROAD BASELINE AND BORROW SITE BASELINE
9	504+14.16, @ ENTRANCE RD.	-	1776766.67	719937.16	ENTRANCE ROAD BASELINE
10	507+66.32, @ ENTRANCE RD.	-	1776995.72	720057.12	INTERSECTION ENTRANCE ROAD BASELINE AND CENTERLINE GLENWOOD-LANSING ROAD
11	505+38.08, @ ENTRANCE RD.	-	1776767.51	720061.07	ENTRANCE ROAD BASELINE
12	18+50, @ BORROW SITE	-	1776703.11	720882.46	END OF BORROW SITE BASELINE
13	507+72.06, 99.53' LT, @ ENTRANCE RD.	-	1776999.75	719957.72	PK NAIL ON GLENWOOD-LANSING ROAD MEDIAN
14	325+30.13, 498.64 LT, @ TAXIWAY G2	-	1776979.01	719108.85	PK NAIL ON GLENWOOD-LANSING ROAD MEDIAN
BM1	3+10.61, 215.31' RT, @ RUNWAY 9/27	613.53	1776979.01	719108.85	AZ MARKER "LANSPORT" (ROD IN CAN)
BM2	23+37.02, 209.83' RT, @ RUNWAY 9/27	613.56	1776979.01	719108.85	MARKER "LANSPORT 1990" (ROD IN CAN)
BM3	37+49.70, 195.54' RT, @ RUNWAY 9/27	613.69	1776979.01	719108.85	GPS IGOA MONUMENT
BM4	146+22.30, 582.00' RT, @ RUNWAY 18/36	614.13	1776979.01	719108.85	CHISELED "X" ON CONCRETE BOX CULVERT

- LEGEND**
- NEW PAVEMENT
 - EXISTING BUILDING
 - EXISTING PAVEMENT
 - PROPOSED BORROW SITE
 - BENCHMARK/CONTROL POINT
 - AIRPORT PROPERTY LINE
 - FUTURE/PROPOSED HANGAR (BY OTHERS)

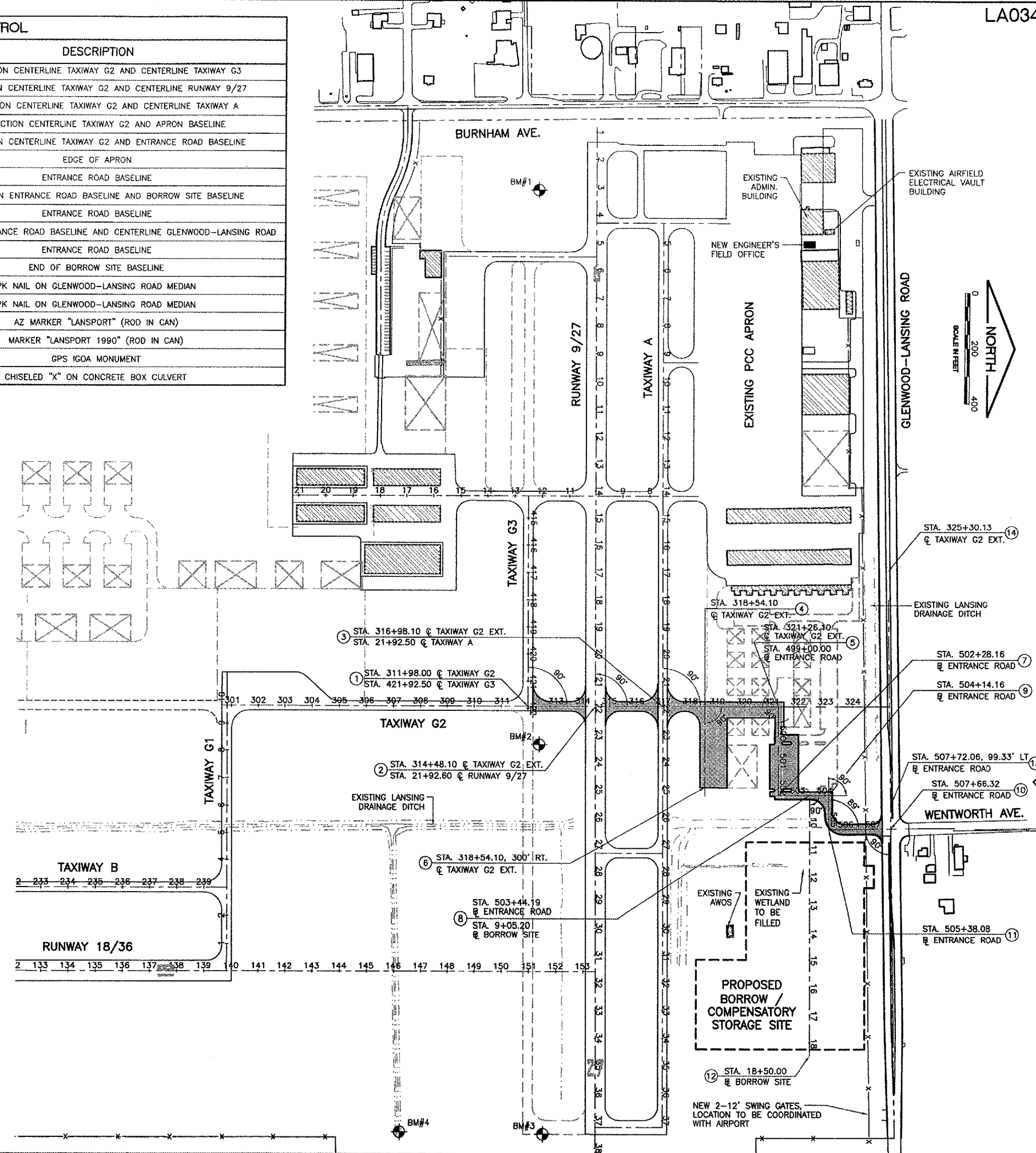

REVISIONS

NUMBER	BY	DATE

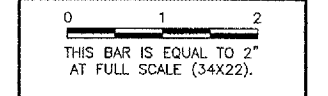

LANSING MUNICIPAL AIRPORT
LANSING, ILLINOIS
NORTH QUADRANT SITEWORK - PHASE 1
AND TAXIWAY G2 EXTENSION
SITE PLAN/HORIZONTAL AND VERTICAL CONTROL PLAN

© Copyright CMT, Inc.

CMT
 CRAWFORD, MURPHY & TILLY, INC.
 CONSULTING ENGINEERS
 License No. 84-000613

Lansing Municipal Airport

DESIGN BY:	ARM
DRAWN BY:	JRO
CHECKED BY:	ARM
APPROVED BY:	
DATE:	03/04/05
JOB No:	03297-02
IL PROJECT: IGQ-3329 A.I.P. PROJECT: 3-17-0121-B21	
SHEET 3 OF 50 SHEETS	