

07\14\2005, 11:04 AM Bak

I:\Airports\MtSterling\818-05TX\Airport\Sheets\R-110-ELEC.dgn

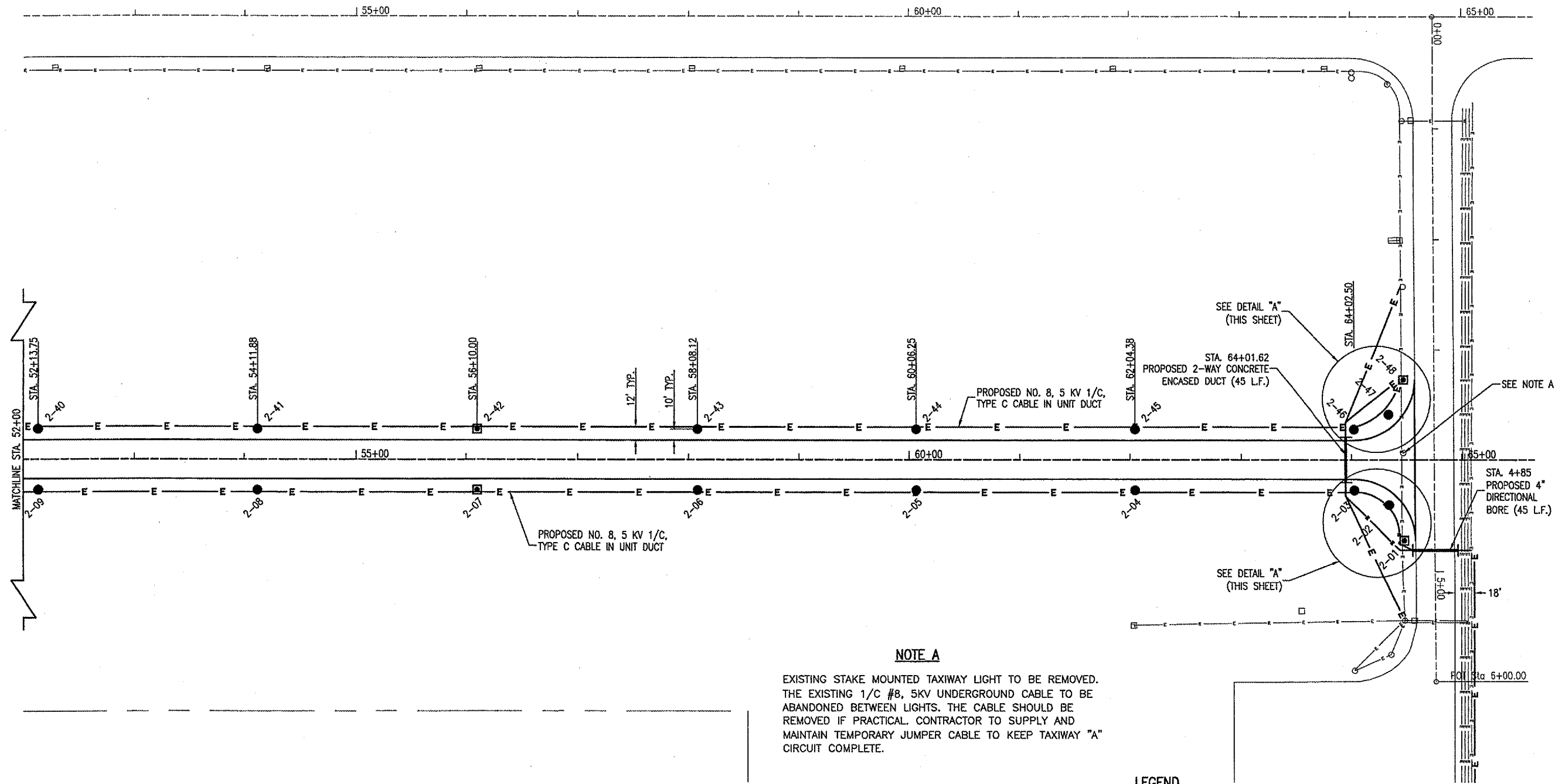

NOTE A
 EXISTING STAKE MOUNTED TAXIWAY LIGHT TO BE REMOVED. THE EXISTING 1/C #8, 5KV UNDERGROUND CABLE TO BE ABANDONED BETWEEN LIGHTS. THE CABLE SHOULD BE REMOVED IF PRACTICAL. CONTRACTOR TO SUPPLY AND MAINTAIN TEMPORARY JUMPER CABLE TO KEEP TAXIWAY "A" CIRCUIT COMPLETE.

LEGEND

- E — EXISTING NO. 8, 5 KV. 1/C., TYPE C CABLE IN UNIT DUCT
- E — PROPOSED NO. 8, 5 KV. 1/C., TYPE C CABLE IN UNIT DUCT
- ▬▬▬▬▬▬ PROPOSED 2-WAY CONCRETE ENCASED DUCT
- EXISTING STAKE MOUNTED TAXIWAY LIGHT
- EXISTING BASE MOUNTED TAXIWAY LIGHT
- PROPOSED STAKE MOUNTED TAXIWAY LIGHT
- ▣ PROPOSED BASE MOUNTED TAXIWAY LIGHT
- ▤ EXISTING TAXIWAY GUIDANCE SIGN

0' 25' 50' 100'
 HALF SIZE SCALE: 1"= 100'
 FULL SIZE SCALE: 1"= 50'

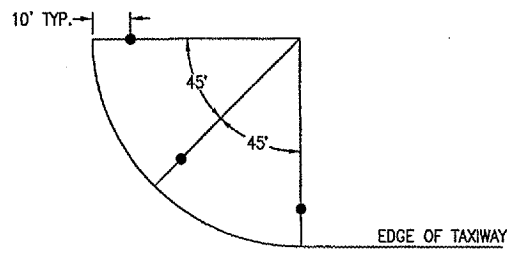
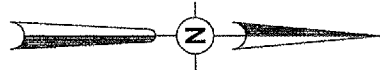

DETAIL "A"

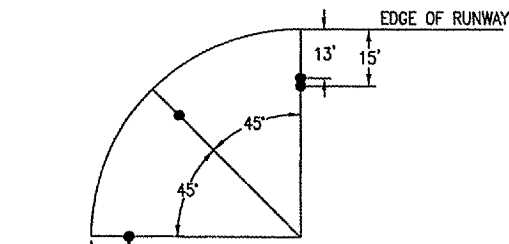

DETAIL "B"

BY	DATE	REVISION

MT. STERLING MUNICIPAL AIRPORT
 MT. STERLING, ILLINOIS
 A.I.P. PROJ.: 163-3431 A.I.P. PROJ.: 3-17-0417-B6

H&E Project No. 818-05TX	FILENAME: R-110-ELEC.dgn
SCALE	DATE: 07/14/2005, 11:04 AM
LAYOUT	JEO 03/14/05
DRAWN	JEO 03/21/05
REVIEWED	CAH 05/17/05

HANSON
 Hanson Professional Services Inc.
 1625 South Sixth Street
 Springfield, Illinois 62703-2886
 Offices Nationwide

PROPOSED
 PARALLEL TAXIWAY
 TAXIWAY "B"
 ELECTRICAL PLAN
 STA. 52+00 TO STA. 65+00