

PHASE 1 NOTES

PE083

REVISIONS

NUMBER	BY	DATE

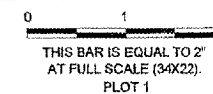

1. THE CONTRACTOR SHALL HAVE NO MORE THAN 23 CONSECUTIVE CALENDAR DAYS TO COMPLETE THE WORK IN THIS PHASE.
2. PRIOR TO THE INITIATION OF WORK IN PHASE 1, THE CONTRACTOR SHALL INSTALL ALL LIGHTED BARRICADES AS SHOWN ON THIS SHEET. THE CONTRACTOR SHALL MAINTAIN AND MODIFY THE LIGHTED BARRICADES AS NECESSARY TO ACCOMMODATE THE SPECIAL OPERATIONS AREA, AS SHOWN. THE CONTRACTOR SHALL REQUEST CLOSURE AT LEAST 48 HOURS PRIOR TO CLOSING THE TAXIWAYS.
3. PHASE 1 WORK SHALL INCLUDE THE WORK SHOWN ON THIS SHEET. THIS WORK SHALL NOT BE ACCOMPLISHED CONCURRENTLY WITH ANY OTHER PHASE.
4. NO WORK OR EQUIPMENT MAY BE WITHIN 115' OF AN ACTIVE TAXIWAY CENTERLINE OR 200' OF AN ACTIVE RUNWAY CENTERLINE, EXCEPT AS NOTED IN THE SPECIAL OPERATIONS AREA.
5. THE CONTRACTOR'S EMPLOYEES SHALL PARK IN THE PRIMARY STAGING AND STORAGE AREA SHOWN ON THIS SHEET.
6. THE CONTRACTOR MAY ONLY STORE SLOW-MOVING EQUIPMENT IN THE IN-FIELD STAGING AREA. THIS SHALL BE THE ONLY USE OF THE INFIELD STAGING AREA. ALL OTHER EQUIPMENT, MATERIALS, AND OTHER SUPPLIES MUST BE STORED IN THE PRIMARY STAGING AREA. THE PARKED EQUIPMENT SHALL NOT PENETRATE THE PART 77 SURFACES.
7. ALL CONTRACTOR PERSONNEL WILL BE REQUIRED TO BE FINGERPRINTED AND BADGED BY THE PUBLIC SAFETY OFFICE. ANY CONTRACTOR PERSONNEL THAT ARE NOT BADGED SHALL BE ESCORTED BY BADGED PERSONNEL EMPLOYED BY THE CONTRACTOR.
8. THE CONTRACTOR SHALL USE THE EXISTING GATE AS SHOWN FOR ACCESS. THE CONTRACTOR SHALL KEEP THE GATE CLOSED AT ALL TIMES. IF THE CONTRACTOR CHOOSES TO LEAVE THE GATE OPEN DURING WORKING HOURS, A SECURITY GUARD SHALL BE POSTED AT THE GATE OPENING. THE SECURITY GUARD SHALL ONLY ALLOW AUTHORIZED CONTRACTOR VEHICLES TO ENTER THE GATE. THE AIRPORT AUTHORITY RESERVES THE RIGHT, AT ALL TIMES, TO HAVE THE CONTRACTOR REPLACE THE SECURITY GUARD FOR ANY REASON. SEE THE SPECIAL PROVISIONS FOR ADDITIONAL SECURITY REQUIREMENTS.
9. THE CONTRACTOR SHALL CONSTRUCT AND MAINTAIN A SUITABLE HAUL ROUTE AT THE LOCATION SHOWN ON THIS SHEET. AFTER THE COMPLETION OF THE PROJECT, THE CONTRACTOR SHALL RESTORE THE AREA TO ITS ORIGINAL CONDITION, INCLUDING GRADING, SEEDING, AND MULCHING. THE COST TO CONSTRUCT, MAINTAIN, AND REMOVE THE HAUL ROUTE SHALL BE CONSIDERED INCIDENTAL TO THE CONTRACT.
10. THE CONDITION OF THE EXISTING PORTION OF THE HAUL ROUTE SHALL BE DOCUMENTED PRIOR TO THE START OF CONSTRUCTION. THE CONTRACTOR SHALL MAINTAIN THE EXISTING ROAD TO ITS EXISTING CONDITION AND RESTORE THE ROAD AFTER COMPLETION OF THE PROJECT. THE COST TO MAINTAIN AND RESTORE THE EXISTING ROAD SHALL BE INCIDENTAL TO THE CONTRACT.
11. THE CONTRACTOR SHALL CONSTRUCT, INSTALL AND MAINTAIN THE TEMPORARY SIGNS AS SHOWN ON THIS PLAN SHEET. THE COST TO CONSTRUCT, INSTALL AND MAINTAIN THE SIGNS SHALL BE INCIDENTAL TO THE CONTRACT.
12. THE CONTRACTOR SHALL USE FLAGPERSONS WHEN EQUIPMENT OR VEHICLES ARE CROSSING THE ACTIVE TAXIWAYS. THE FLAGPERSONS SHALL HAVE AIRPORT RADIOS AND SHALL BE IN CONTACT WITH THE AIR TRAFFIC CONTROL TOWER AT ALL TIMES. THE CONTRACTOR SHALL SUPPLY THEIR OWN AIRPORT RADIOS AND FLAG PERSONS.
13. THE CONTRACTOR SHALL HAVE A POWER BROOM AND OPERATOR ON-SITE WHEN ANY VEHICLES OR EQUIPMENT CROSS THE ACTIVE PAVEMENTS. THE ACTIVE PAVEMENTS SHALL BE KEPT CLEAN OF DEBRIS AT ALL TIMES.

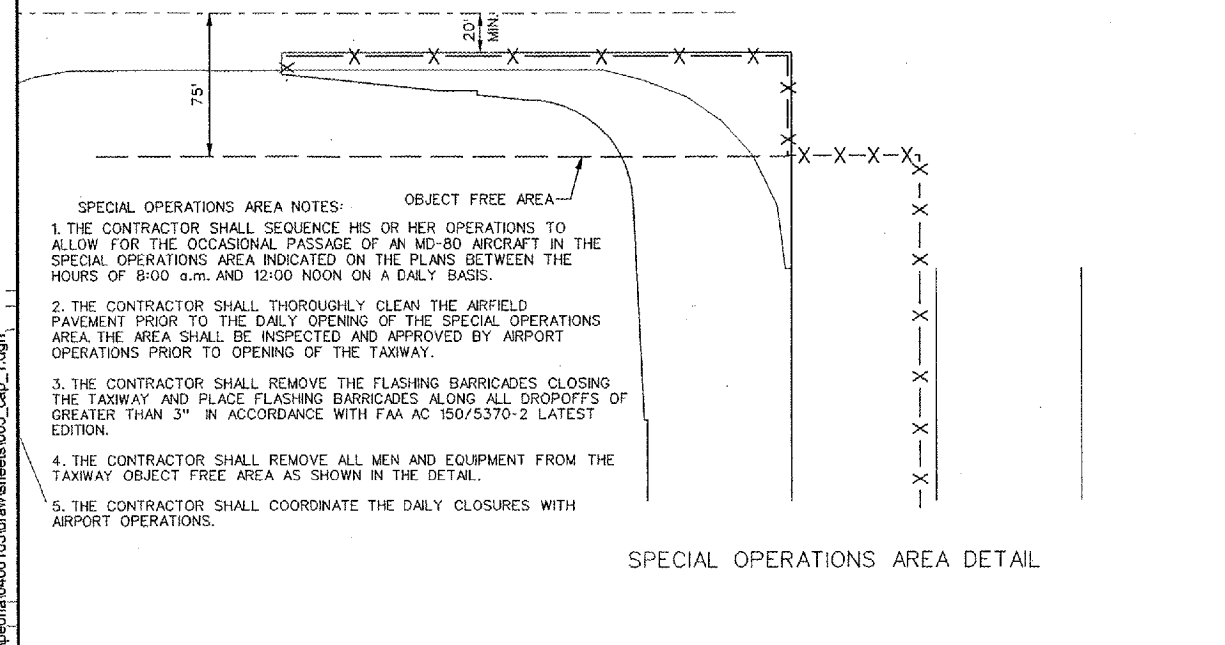
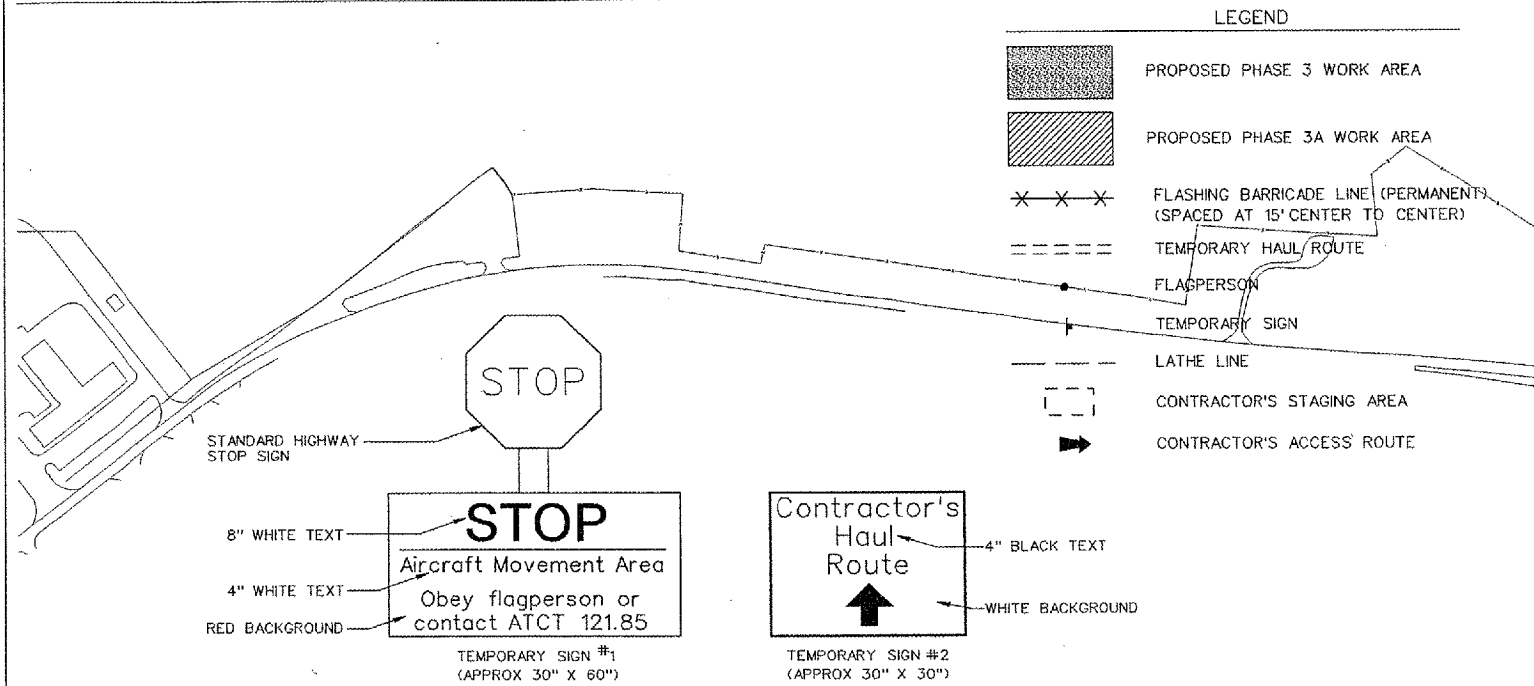
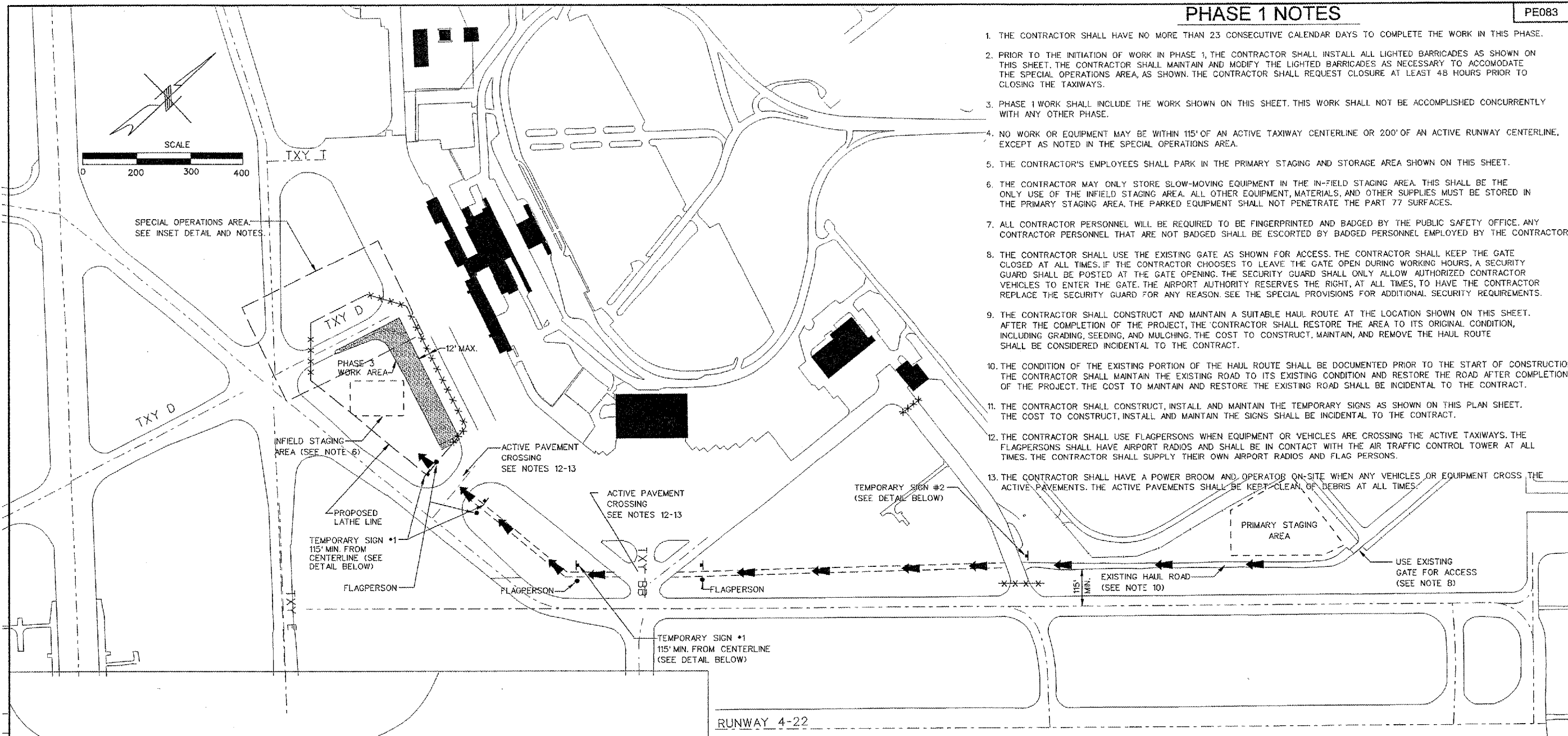

RELOCATE TAXIWAY A FROM MID-FIELD INTERSECTION

GREATER Peoria REGIONAL Airport

CMT CRAWFORD MURPHY & TILLY, INC. CONSULTING ENGINEERS

IL PROJECT: PIA-3343
AIP PROJ: 3-17-0080-XX

FILE: k:\peoria\0406103\drawsheets\005_cap_1.dgn

DESIGN BY: TCS
DRAWN BY: CAG
CHECKED BY: TCS
APPROVED BY: CET
DATE: JUNE 24, 2005
JOB No: 04061-03

CONSTRUCTION ACTIVITY PLAN PHASE 1

SHEET 5 OF 43 SHEETS

06/23/2005 K:\peoria\0406103\drawsheets\005_cap_1.dgn