

| DATE | REVISION | BY |
|------|----------|----|
|      |          |    |
|      |          |    |
|      |          |    |
|      |          |    |

VANDALIA MUNICIPAL AIRPORT  
VANDALIA, ILLINOIS

IL PROJ.: VLA-3432 A.I.P. PROJ.: 3-17-0102-B8

|                           |              |
|---------------------------|--------------|
| Proj. No. 830-05APRD-0800 |              |
| Filename: R-151MRK.DWG    |              |
| Scale: 1" = 30'           |              |
| Date: 03/23/05            |              |
| LAYOUT                    | BKB 03/23/05 |
| DRAWN                     | BAK 03/23/05 |
| REVIEWED                  | CAH 05/09/05 |

**HANSON**  
Hanson Professional Services Inc.  
1525 South State Street  
Springfield, Illinois 62703-2886  
Offices Nationwide

APRON AND TAXIWAYS  
RECONSTRUCTION

PROPOSED  
TAXIWAY "B" & TAXIWAY "C"  
MARKING PLAN

**LEGEND**

- EXISTING IMPROVEMENTS
- PROPOSED IMPROVEMENTS
- EXISTING MARKING
- PROPOSED MARKING

**620-PAVEMENT MARKING-WATERBORNE NOTES**

THE PAVEMENT MARKING-WATERBORNE (620) SHALL BE PLACED IN ACCORDANCE WITH ITEM 620 "PAVEMENT MARKING" AS STATED ON PAGE 77 OF THE SUPPLEMENTAL SPECIFICATIONS AND RECURRING SPECIAL PROVISIONS, ADOPTED JULY 1, 2004.

THIS ITEM SHALL CONSIST OF TAXIWAY CENTERLINE, HOLDING POSITION (BLACK AND YELLOW) AND TIE DOWN MARKING IN ACCORDANCE WITH THESE SPECIFICATIONS AND AT THE LOCATIONS SHOWN ON THE CONSTRUCTION PLANS. THE PROPOSED PAVEMENT MARKING WILL BE APPLIED IN TWO APPLICATIONS.

ANY MATERIAL DELIVERED THAT FAILS TO MEET THE SPECIFICATIONS SHALL BE DISPOSED OF BY THE VENDOR AND IMMEDIATELY REPLACED WITH ACCEPTABLE MATERIAL ENTIRELY AT THE VENDOR'S EXPENSE, INCLUDING HANDLING AND TRANSPORTATION CHARGES.

ALL PROPOSED MARKING WILL BE COMPLETED IN ACCORDANCE WITH THE DETAILS SHOWN ON THE CONSTRUCTION PLANS.

GLASS BEADS SHALL BE REQUIRED ONLY ON THE SECOND APPLICATION.

CUT-OFF SHEETS WILL BE REQUIRED TO INSURE STRAIGHT EDGES.

THE PROPOSED MARKING WILL BE PAID FOR UNDER ITEM:  
AR620520 PAVEMENT MARKING-WATERBORNE \_ 3,651 S.F.

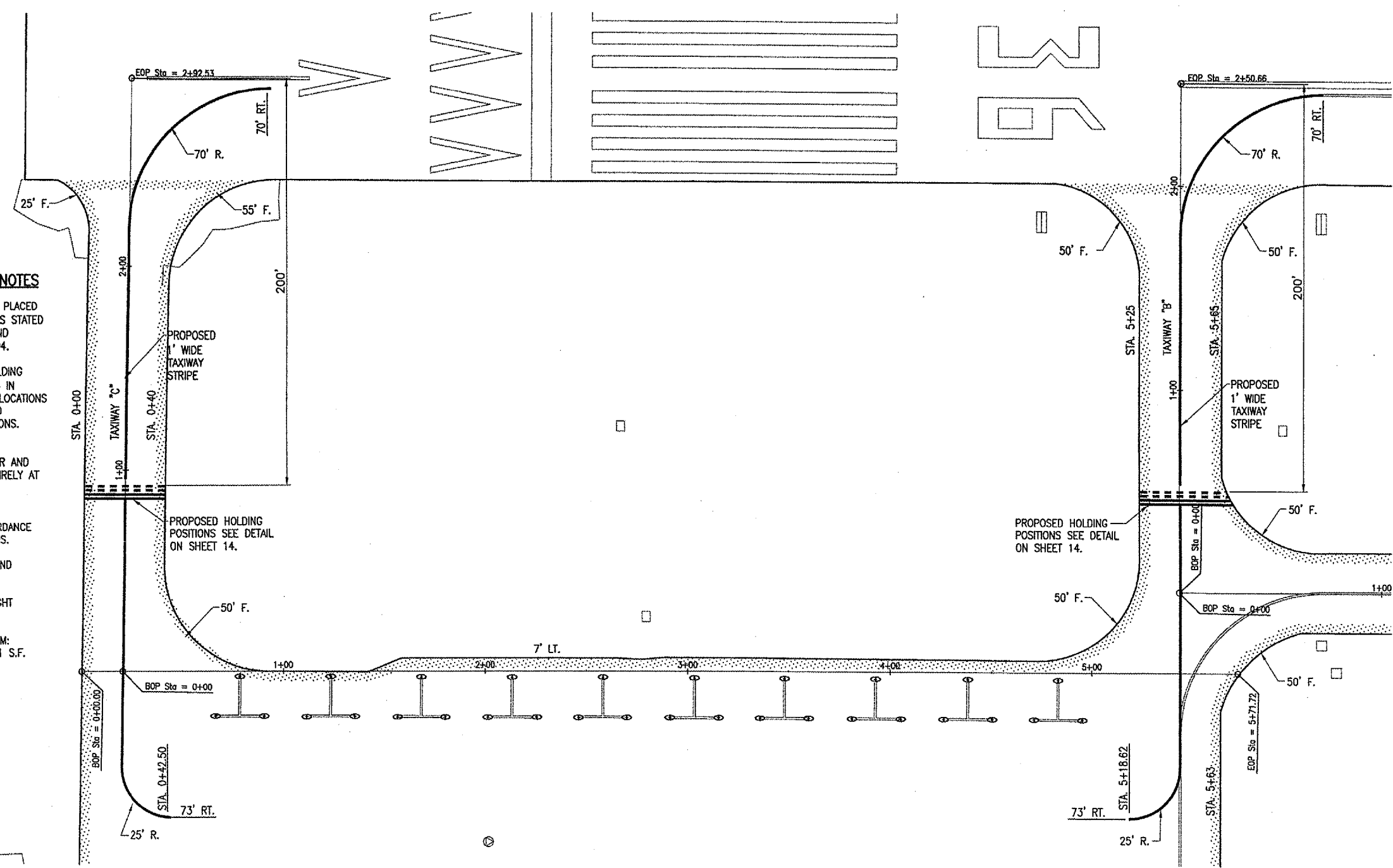

JUL 13, 2005 9:57 AM BAK  
I:\AIRPORTS\VANDALIA\830-05APN\AIRPORT\ SHEETS\R-151MRK.DWG - TAXIWAY B AND C