

F.A.P. RTE.	SECTION	COUNTY	TOTAL SHEETS	SHEET NO.
840	143 N	WILL	121	59
STA.		TO STA.		
FED. ROAD DIST. NO. 1		ILLINOIS FED. AID PROJECT		

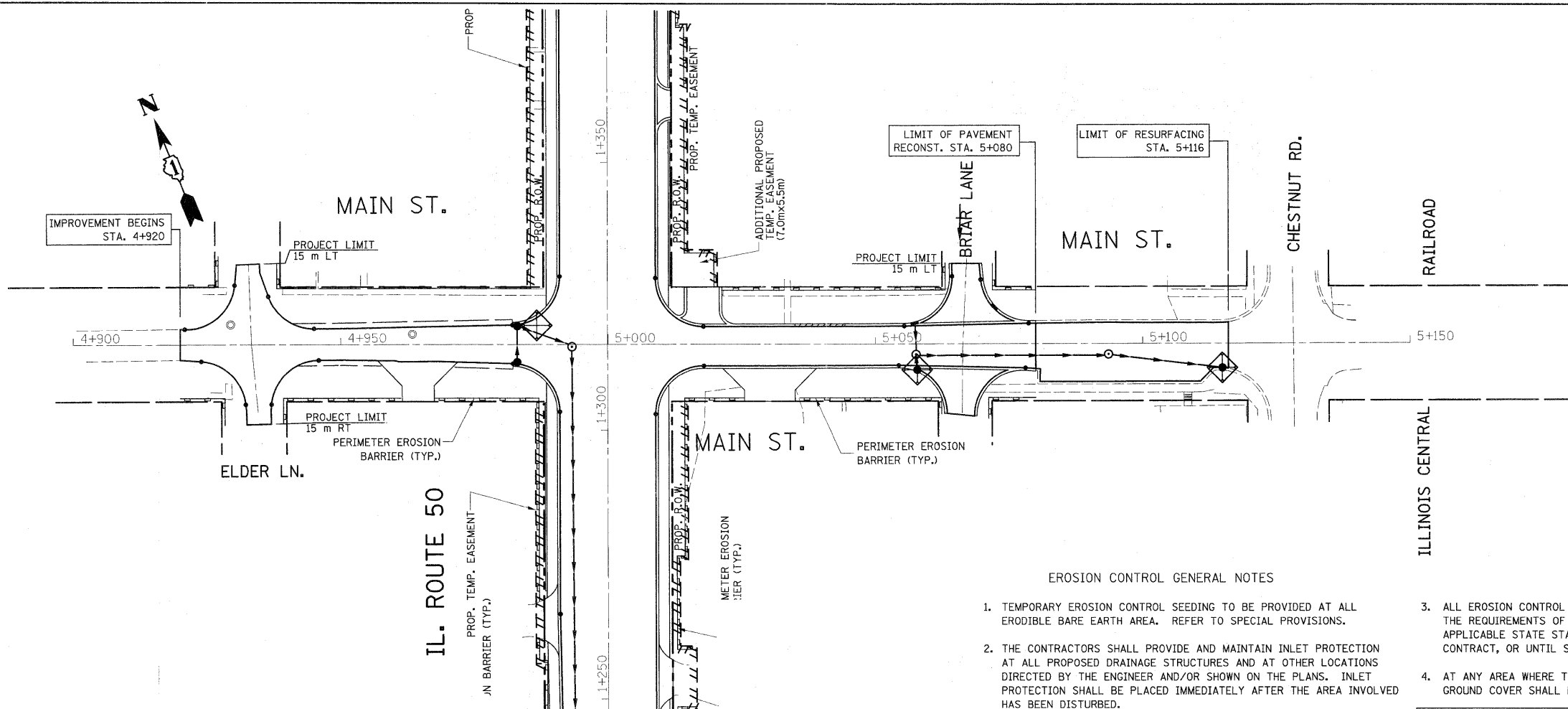

EROSION CONTROL GENERAL NOTES

1. TEMPORARY EROSION CONTROL SEEDING TO BE PROVIDED AT ALL ERODIBLE BARE EARTH AREA. REFER TO SPECIAL PROVISIONS.
2. THE CONTRACTORS SHALL PROVIDE AND MAINTAIN INLET PROTECTION AT ALL PROPOSED DRAINAGE STRUCTURES AND AT OTHER LOCATIONS DIRECTED BY THE ENGINEER AND/OR SHOWN ON THE PLANS. INLET PROTECTION SHALL BE PLACED IMMEDIATELY AFTER THE AREA INVOLVED HAS BEEN DISTURBED.
3. ALL EROSION CONTROL MEASURES SHALL BE IN ACCORDANCE WITH THE REQUIREMENTS OF THE STANDARD SPECIFICATIONS AND OF THE APPLICABLE STATE STANDARDS FOR THE ENTIRE DURATION OF THE CONTRACT, OR UNTIL SUCH A TIME AS DIRECTED BY THE ENGINEER.
4. AT ANY AREA WHERE THERE IS NO PROPOSED GRADING, THE EXISTING GROUND COVER SHALL REMAIN.
5. DURING CONSTRUCTION AND WHERE ERODIBLE SOILS ARE EXPOSED, ALL DRAINAGE STRUCTURES NOT PROTECTED WITH INLET OR PIPE PROTECTION SHALL BE KEPT SEALED TO PREVENT ACCESS FROM THE EROSION, THIS WORK SHALL BE CONSIDERED AS PART OF THE COST OF THE VARIOUS DRAINAGE STRUCTURES.

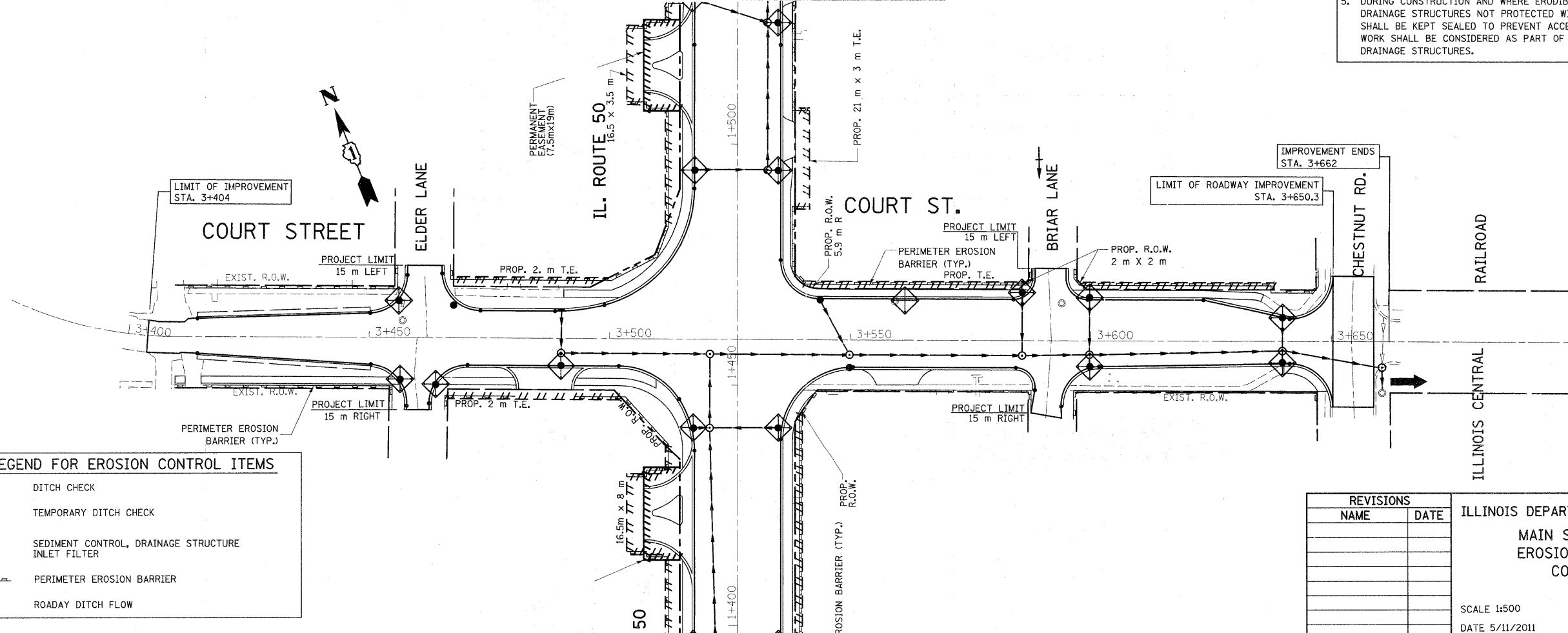

LEGEND FOR EROSION CONTROL ITEMS

	DITCH CHECK
	TEMPORARY DITCH CHECK
	SEDIMENT CONTROL, DRAINAGE STRUCTURE INLET FILTER
	PERIMETER EROSION BARRIER
	ROADWAY DITCH FLOW

REVISIONS

NAME	DATE

ILLINOIS DEPARTMENT OF TRANSPORTATION
**MAIN ST. & COURT ST.
 EROSION AND SEDIMENT
 CONTROL PLAN**

SCALE 1:500
 DATE 5/11/2011

DRAWN BY
 CHECKED BY