

KEDZIE AVE HORIZONTAL CURVE INFORMATION

P.O.T. STA 511+56.00
 N = 1,800,422.75
 E = 1,158,909.52

PROP. CURVE PRKEDZI-1
 PI STA. = 518+20.32
 N = 1,801,086.99
 E = 1,158,899.70
 $\Delta = 36^\circ 02' 20''$ (LT)
 $D = 3^\circ 57' 57''$
 R = 1,445.00'
 L = 470.05'
 T = 908.72'
 E = 74.53'
 DESIGN SPEED = 45 MPH
 $e = 5.0\%$
 T.R. = 67'
 S.E. RUN = 167'
 P.C. STA. = 513+50.27
 N = 1,800,616.99
 E = 1,158,906.65
 P.T. STA. = 522+58.99
 N = 1,801,462.96
 E = 1,158,617.57

NOTES:

- STATION, OFFSET, AND RADIUS CALLOUTS REFER TO TO EDGE OF PAVEMENT, UNLESS OTHERWISE NOTED.
- ADDITIONAL QUANTITIES FOR TYPE B PATCHES HAVE BEEN PROVIDED FOR AND SHALL BE CONSTRUCTED AS DIRECTED BY THE ENGINEER.
- BUS PAD AT STA. 512+23 SHALL BE 10' WIDE BY 25' LONG AND 5" DEEP.

* = MATCH EXISTING

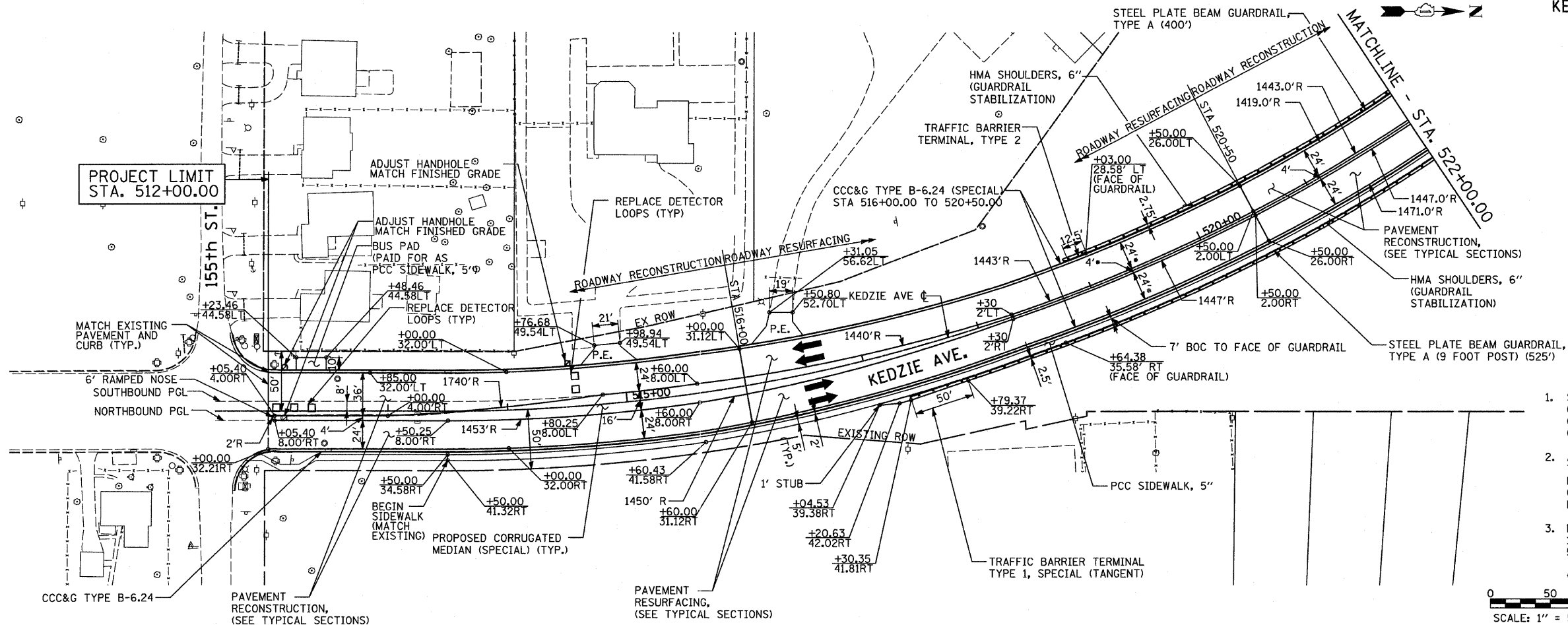
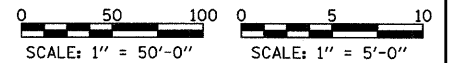

DATE	BY

DATE	BY

DATE	BY

DATE	BY

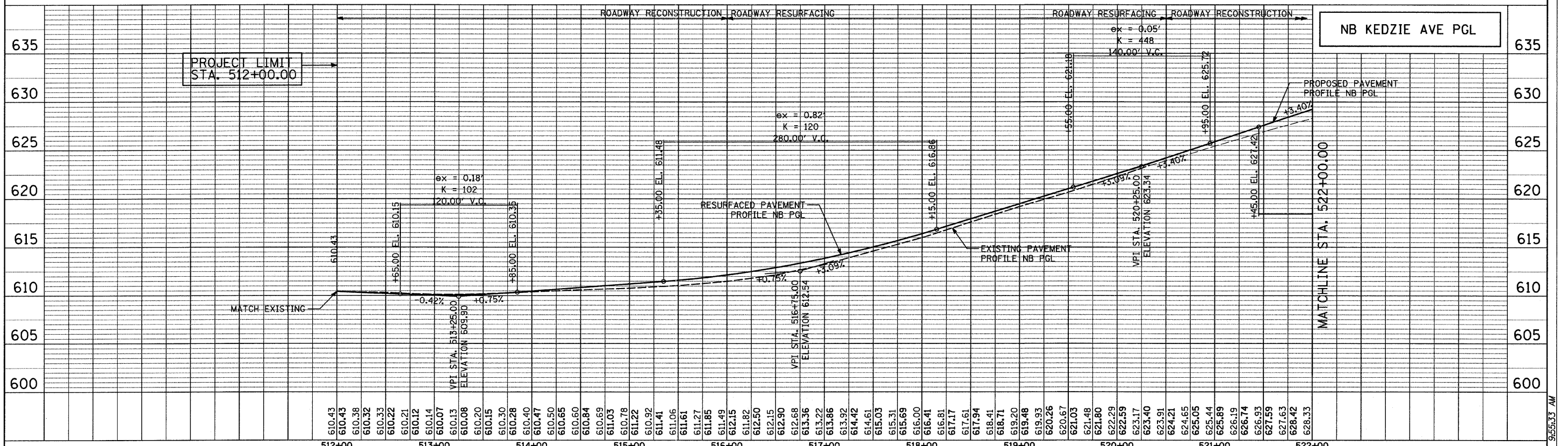

USER NAME = #USER#	DESIGNED -	JU	REVISED -	
	DRAWN -	EMK	REVISED -	
CHECKED -	SES	REVISED -		
DATE -	5/5/2011	REVISED -		

TYLIN INTERNATIONAL		STATE OF ILLINOIS DEPARTMENT OF TRANSPORTATION		KEDZIE AVENUE PROJECT		F.A.R.T.E.	SECTION	COUNTY	TOTAL SHEETS	SHEET NO.
PLOT SCALE = #SCALE#						57	1313.1B-1	COOK	162	26
PLOT DATE = 5/3/2011										

SCALE: 1"=50'	SHEET NO. 1 OF 3 SHEETS	STA. 512+00	TO STA. 522+00	FED. ROAD DIST. NO.	ILLINOIS FED. AID PROJECT

P:\602540(57-294)\Road\2-Kedzie\2-PP_SHT01.dgn 9:55:33 AM 5/3/2011