

ADVANCE SIGNING PER IDOT STANDARD 701606

NOTE:
ARTERIAL ROAD INFORMATION SIGN (PER TC-22) TO BE PLACED 100' IN ADVANCE OF THE LOCATION FOR THE 'ROAD CONSTRUCTION AHEAD SIGN'

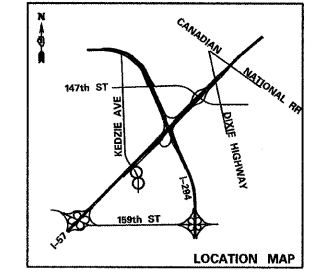
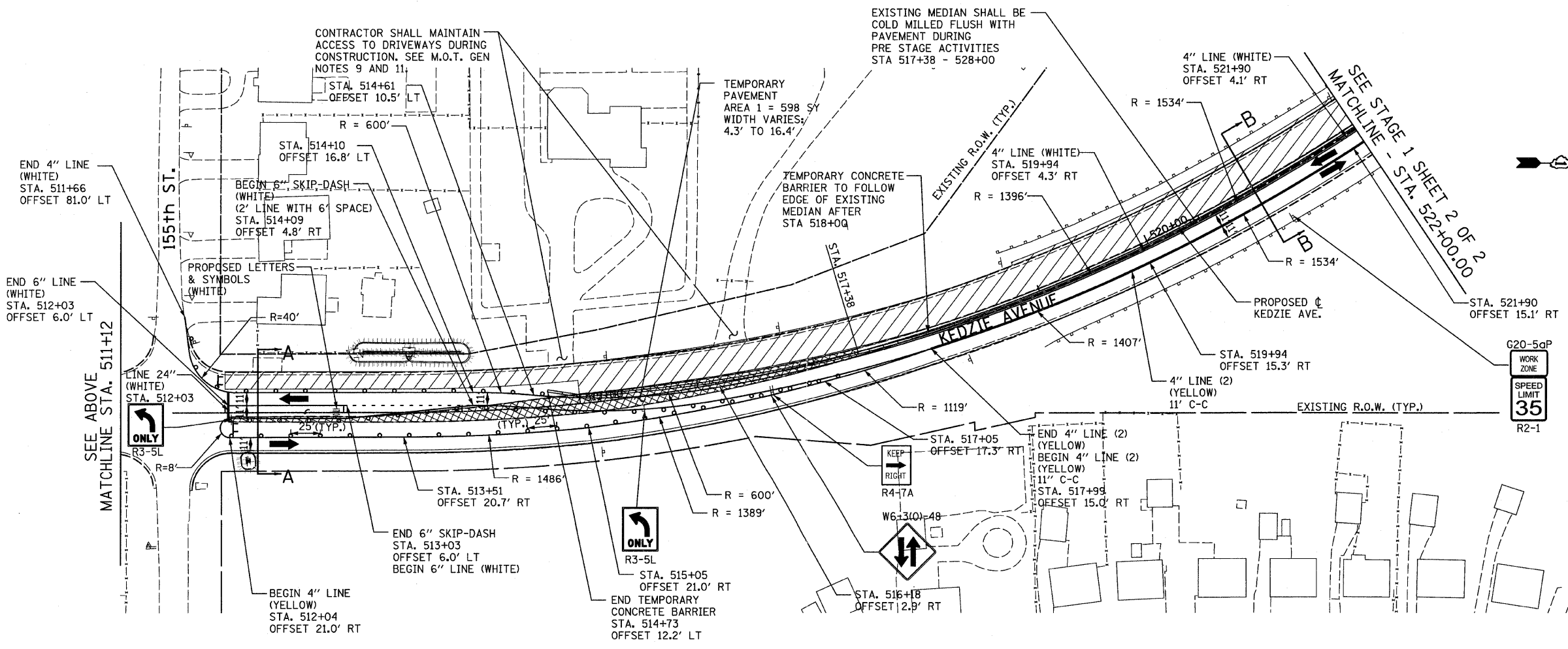
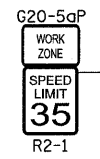
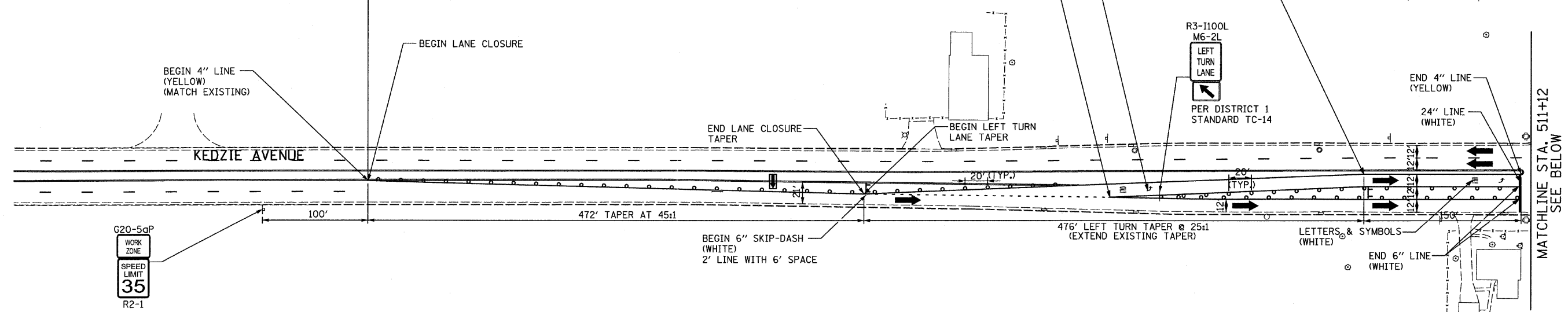

- LEGEND:**
- TEMPORARY CONCRETE BARRIER
 - TRAFFIC LANE
 - WORK ZONE
 - TEMPORARY PAVEMENT
 - BARRICADE, TYPE III
 - DRUM WITH MONO-DIRECTIONAL STEADY BURNING LIGHT
 - ARROW BOARD

TYLIN INTERNATIONAL

USER NAME = #USER#	DESIGNED - JDU	REVISED -
DRAWN - JDU	REVISED -	
CHECKED - SES	REVISED -	
DATE - 5/5/2011	REVISED -	

**STATE OF ILLINOIS
DEPARTMENT OF TRANSPORTATION**

**KEDZIE AVENUE PROJECT
MOT STAGE 1 - SHEET 1**

SCALE: 1"=50'	SHEET NO. 3 OF 11 SHEETS	STA. 512+00 TO STA. 522+00
---------------	--------------------------	----------------------------

F.A. RTE.	SECTION	COUNTY	TOTAL SHEETS	SHEET NO.
57	1313.1B-1	COOK	162	34
FED. ROAD DIST. NO.		ILLINOIS FED. AID PROJECT		CONTRACT NO. 60K14