

V:\089\09\0900\0901.DGN, V:\089\09\0900\0902.DGN, V:\089\09\0900\0903.DGN, V:\089\09\0900\0904.DGN, V:\089\09\0900\0905.DGN, V:\089\09\0900\0906.DGN, V:\089\09\0900\0907.DGN, V:\089\09\0900\0908.DGN, V:\089\09\0900\0909.DGN, V:\089\09\0900\0910.DGN, V:\089\09\0900\0911.DGN, V:\089\09\0900\0912.DGN, V:\089\09\0900\0913.DGN, V:\089\09\0900\0914.DGN, V:\089\09\0900\0915.DGN, V:\089\09\0900\0916.DGN, V:\089\09\0900\0917.DGN, V:\089\09\0900\0918.DGN, V:\089\09\0900\0919.DGN, V:\089\09\0900\0920.DGN, V:\089\09\0900\0921.DGN, V:\089\09\0900\0922.DGN, V:\089\09\0900\0923.DGN, V:\089\09\0900\0924.DGN, V:\089\09\0900\0925.DGN, V:\089\09\0900\0926.DGN, V:\089\09\0900\0927.DGN, V:\089\09\0900\0928.DGN, V:\089\09\0900\0929.DGN, V:\089\09\0900\0930.DGN, V:\089\09\0900\0931.DGN, V:\089\09\0900\0932.DGN, V:\089\09\0900\0933.DGN, V:\089\09\0900\0934.DGN, V:\089\09\0900\0935.DGN, V:\089\09\0900\0936.DGN, V:\089\09\0900\0937.DGN, V:\089\09\0900\0938.DGN, V:\089\09\0900\0939.DGN, V:\089\09\0900\0940.DGN, V:\089\09\0900\0941.DGN, V:\089\09\0900\0942.DGN, V:\089\09\0900\0943.DGN, V:\089\09\0900\0944.DGN, V:\089\09\0900\0945.DGN, V:\089\09\0900\0946.DGN, V:\089\09\0900\0947.DGN, V:\089\09\0900\0948.DGN, V:\089\09\0900\0949.DGN, V:\089\09\0900\0950.DGN, V:\089\09\0900\0951.DGN, V:\089\09\0900\0952.DGN, V:\089\09\0900\0953.DGN, V:\089\09\0900\0954.DGN, V:\089\09\0900\0955.DGN, V:\089\09\0900\0956.DGN, V:\089\09\0900\0957.DGN, V:\089\09\0900\0958.DGN, V:\089\09\0900\0959.DGN, V:\089\09\0900\0960.DGN, V:\089\09\0900\0961.DGN, V:\089\09\0900\0962.DGN, V:\089\09\0900\0963.DGN, V:\089\09\0900\0964.DGN, V:\089\09\0900\0965.DGN, V:\089\09\0900\0966.DGN, V:\089\09\0900\0967.DGN, V:\089\09\0900\0968.DGN, V:\089\09\0900\0969.DGN, V:\089\09\0900\0970.DGN, V:\089\09\0900\0971.DGN, V:\089\09\0900\0972.DGN, V:\089\09\0900\0973.DGN, V:\089\09\0900\0974.DGN, V:\089\09\0900\0975.DGN, V:\089\09\0900\0976.DGN, V:\089\09\0900\0977.DGN, V:\089\09\0900\0978.DGN, V:\089\09\0900\0979.DGN, V:\089\09\0900\0980.DGN, V:\089\09\0900\0981.DGN, V:\089\09\0900\0982.DGN, V:\089\09\0900\0983.DGN, V:\089\09\0900\0984.DGN, V:\089\09\0900\0985.DGN, V:\089\09\0900\0986.DGN, V:\089\09\0900\0987.DGN, V:\089\09\0900\0988.DGN, V:\089\09\0900\0989.DGN, V:\089\09\0900\0990.DGN, V:\089\09\0900\0991.DGN, V:\089\09\0900\0992.DGN, V:\089\09\0900\0993.DGN, V:\089\09\0900\0994.DGN, V:\089\09\0900\0995.DGN, V:\089\09\0900\0996.DGN, V:\089\09\0900\0997.DGN, V:\089\09\0900\0998.DGN, V:\089\09\0900\0999.DGN, V:\089\09\0900\1000.DGN

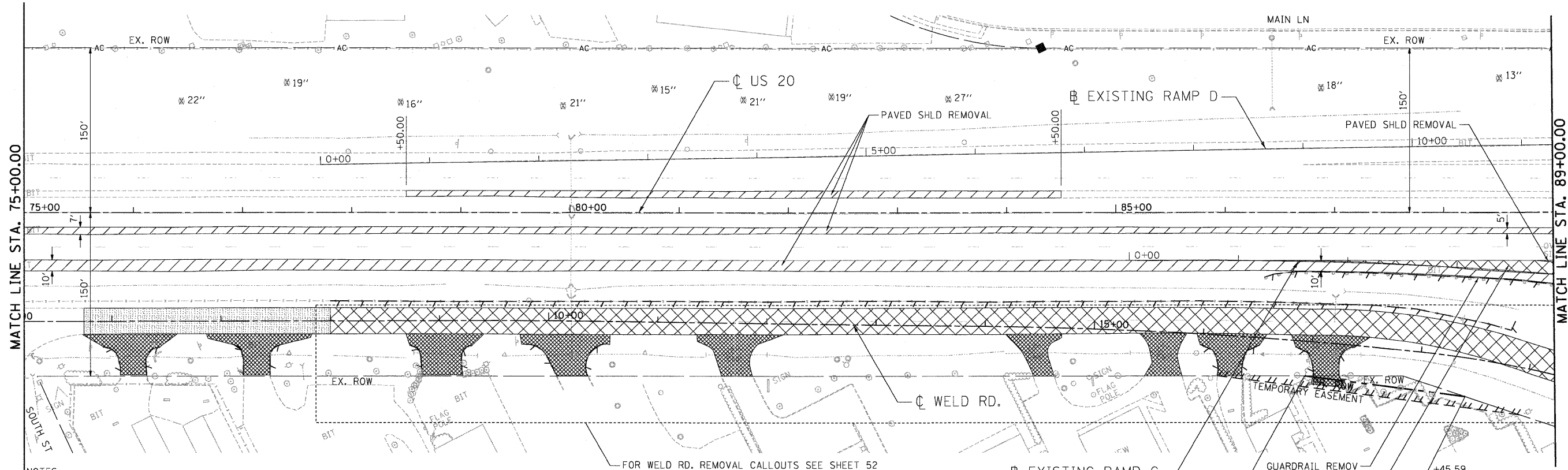

- NOTES:
1. SEE DRAINAGE AND UTILITY PLANS FOR REMOVAL OF DRAINAGE RELATED ITEMS.
  2. SEE GENERAL NOTES SHEET 3 FOR NOTE REGARDING LIMITS OF PAVED SHOULDER REMOVAL.

**EXISTING PLAN**

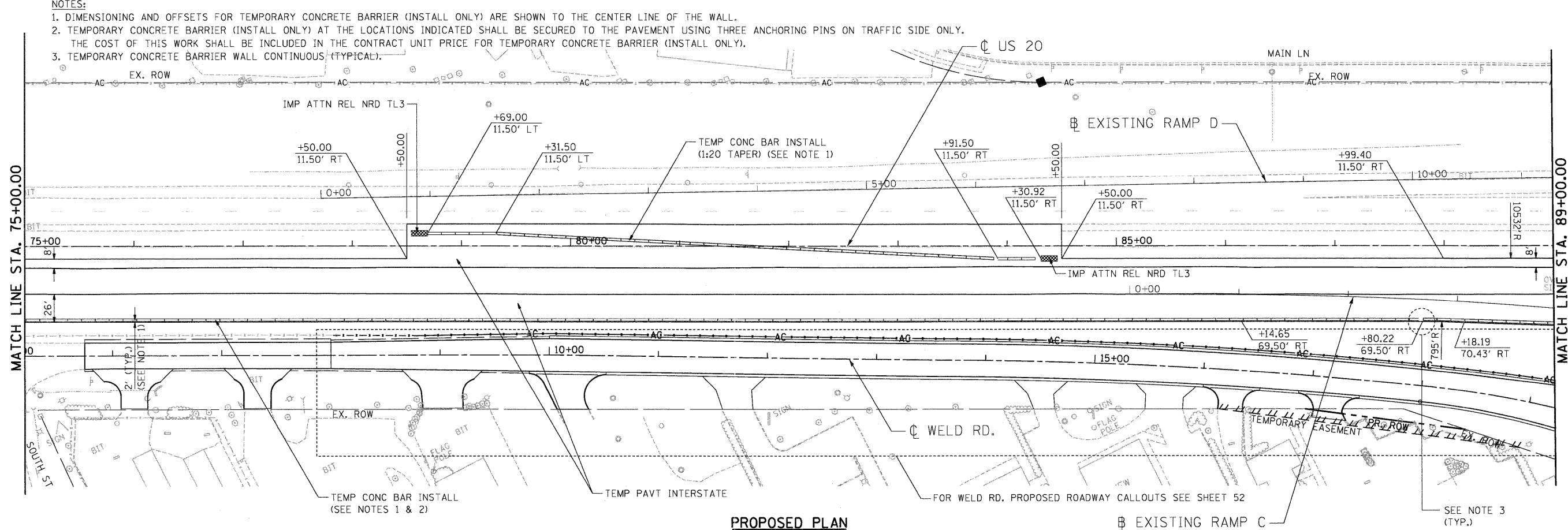

- NOTES:
1. DIMENSIONING AND OFFSETS FOR TEMPORARY CONCRETE BARRIER (INSTALL ONLY) ARE SHOWN TO THE CENTER LINE OF THE WALL.
  2. TEMPORARY CONCRETE BARRIER (INSTALL ONLY) AT THE LOCATIONS INDICATED SHALL BE SECURED TO THE PAVEMENT USING THREE ANCHORING PINS ON TRAFFIC SIDE ONLY. THE COST OF THIS WORK SHALL BE INCLUDED IN THE CONTRACT UNIT PRICE FOR TEMPORARY CONCRETE BARRIER (INSTALL ONLY).
  3. TEMPORARY CONCRETE BARRIER WALL CONTINUOUS (TYPICAL).

**PROPOSED PLAN**

FILE NAME = #FILE# 	USER NAME = #USER# PLOT SCALE = #SCALE# PLOT DATE = #DATE#	DESIGNED - JP DRAWN - MH CHECKED - DDH DATE - 05/18/11	REVISED - REVISED - REVISED - REVISED -	<b>STATE OF ILLINOIS</b> <b>DEPARTMENT OF TRANSPORTATION</b> FAP ROUTE 345 / US ROUTE 20	<b>ROADWAY PLAN</b> <b>U.S. ROUTE 20</b>	SCALE: 1"=50' SHEET NO. OF SHEETS STA. 75+00.00 TO STA. 89+00.00	F.A.P. RTE. 345 SECTION 8R-HB-2-BY-1 COUNTY KANE TOTAL SHEETS 434 SHEET NO. 39 CONTRACT NO. 60K90	FED. ROAD DIST. NO. ILLINOIS FED. AID PROJECT
		TENG & ASSOCIATES, INC. ENGINEERS/ARCHITECTS/PLANNERS CHICAGO, ILLINOIS						