

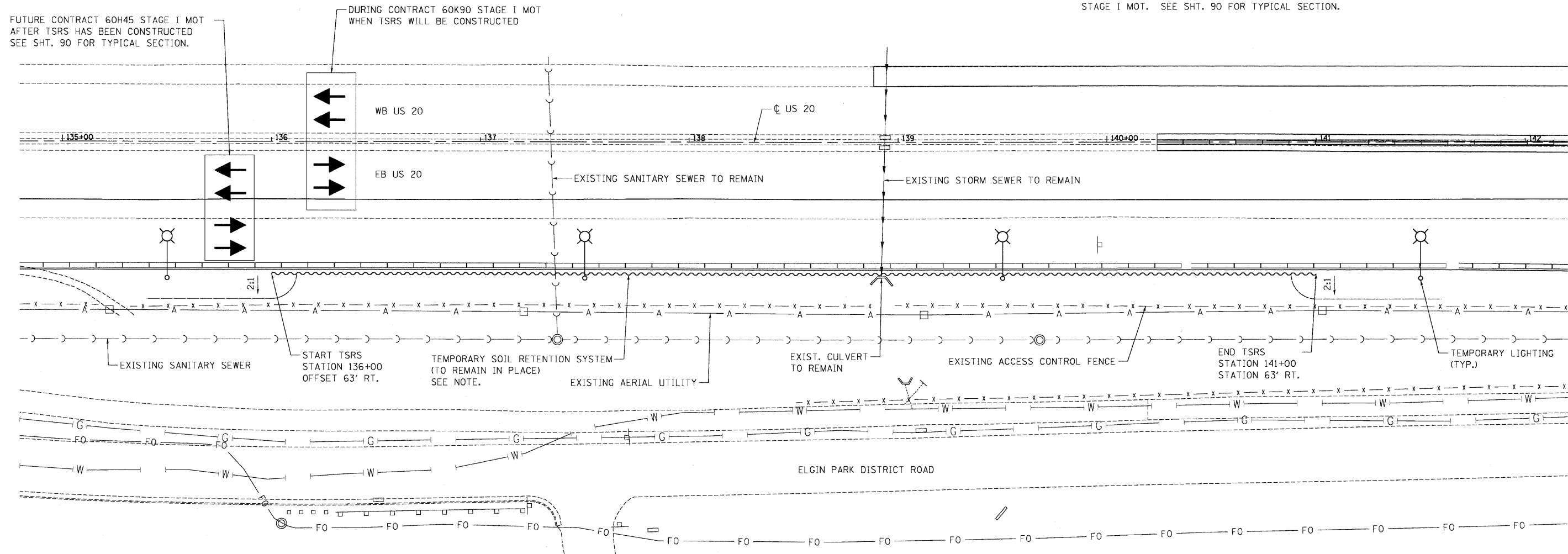

NOTE: TSRS = TEMPORARY SOIL RETENTION SYSTEM (TO REMAIN IN PLACE)
 TSRS TO BE DESIGNED TO ACCOMMODATE FUTURE CONTRACT 60H45
 STAGE I MOT. SEE SHT. 90 FOR TYPICAL SECTION.

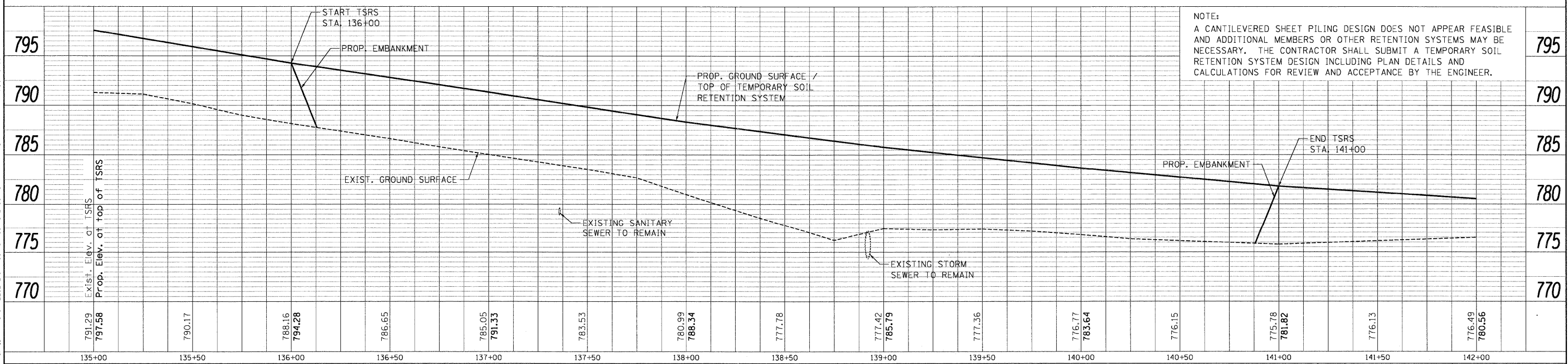

PLAN



DATE	
BY	
NO.	
DATE	
BY	
NO.	
DATE	
BY	
NO.	

DATE	
BY	
NO.	
DATE	
BY	
NO.	

5-12-2011 16:06:04 H:\WARMAZ \S\5-0044\WARMAZ.TD - TRANS.07_2202-21379-001\STRUCT\CD\60K90A\TEMP\MALL\SHEET\TEMP\MALL_60K90_001.RET\MALL_SHT.DGN

FILE NAME =	USER NAME = #USER#	DESIGNED - MDB	REVISED -	STATE OF ILLINOIS DEPARTMENT OF TRANSPORTATION FAP ROUTE 345 / US ROUTE 20	ROADWAY DETAILS TEMPORARY SOIL RETENTION SYSTEM (TO REMAIN IN PLACE)		F.A.P. RTE.	SECTION	COUNTY	TOTAL SHEETS	SHEET NO.
#FILE#		DRAWN - MDB	REVISED -		345	8R-HB-2-BY-1	KANE	434	59		
PLOT SCALE = #SCALE#		CHECKED - VCP	REVISED -		CONTRACT NO. 60K90						
PLOT DATE = #DATE#		DATE - 05/18/11	REVISED -		FED. ROAD DIST. NO. 7 ILLINOIS FED. AID PROJECT						