

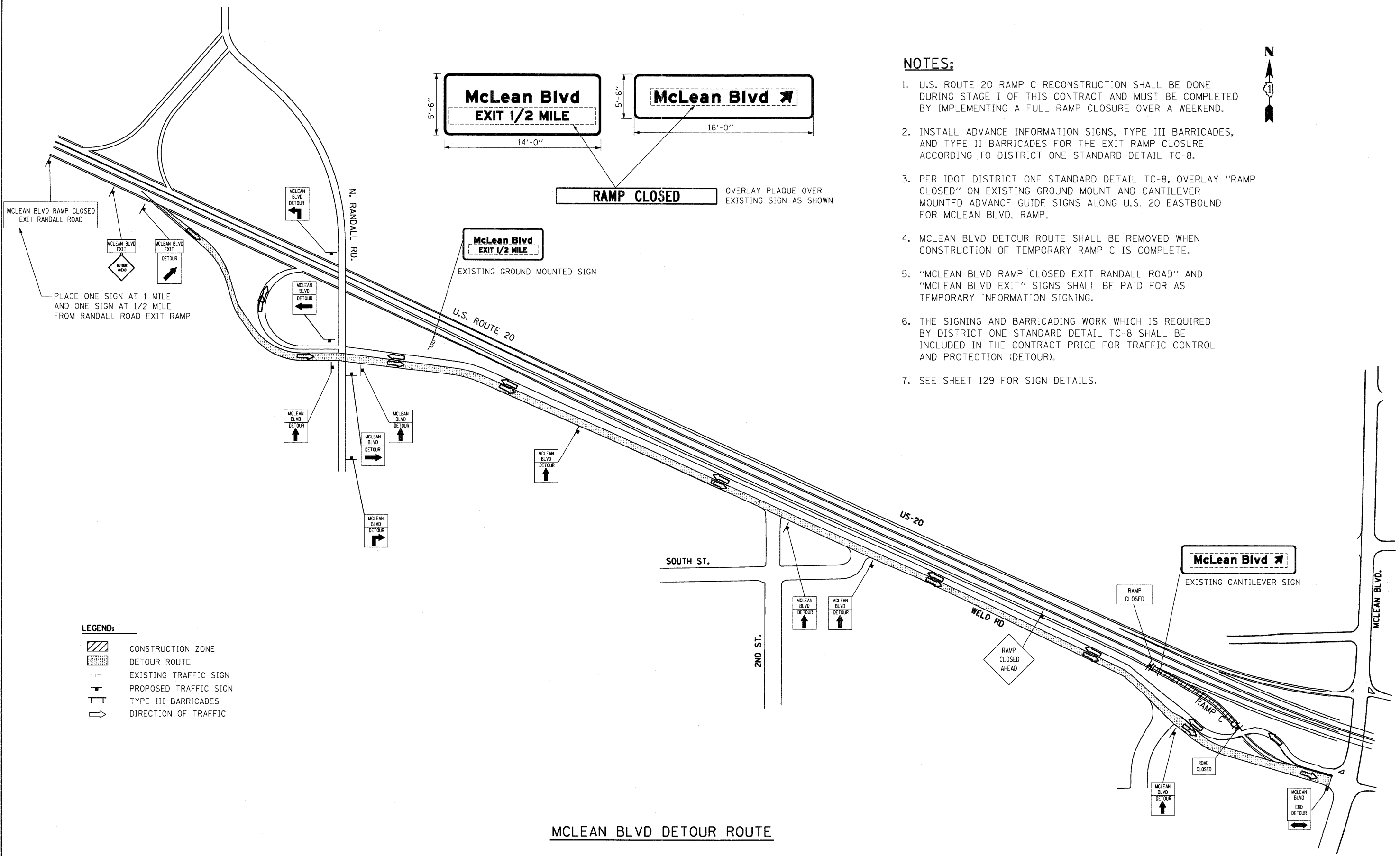

NOTES:

1. U.S. ROUTE 20 RAMP C RECONSTRUCTION SHALL BE DONE DURING STAGE I OF THIS CONTRACT AND MUST BE COMPLETED BY IMPLEMENTING A FULL RAMP CLOSURE OVER A WEEKEND.
2. INSTALL ADVANCE INFORMATION SIGNS, TYPE III BARRICADES, AND TYPE II BARRICADES FOR THE EXIT RAMP CLOSURE ACCORDING TO DISTRICT ONE STANDARD DETAIL TC-8.
3. PER IDOT DISTRICT ONE STANDARD DETAIL TC-8, OVERLAY "RAMP CLOSED" ON EXISTING GROUND MOUNT AND CANTILEVER MOUNTED ADVANCE GUIDE SIGNS ALONG U.S. 20 EASTBOUND FOR MCLEAN BLVD. RAMP.
4. MCLEAN BLVD DETOUR ROUTE SHALL BE REMOVED WHEN CONSTRUCTION OF TEMPORARY RAMP C IS COMPLETE.
5. "MCLEAN BLVD RAMP CLOSED EXIT RANDALL ROAD" AND "MCLEAN BLVD EXIT" SIGNS SHALL BE PAID FOR AS TEMPORARY INFORMATION SIGNING.
6. THE SIGNING AND BARRICADING WORK WHICH IS REQUIRED BY DISTRICT ONE STANDARD DETAIL TC-8 SHALL BE INCLUDED IN THE CONTRACT PRICE FOR TRAFFIC CONTROL AND PROTECTION (DETOUR).
7. SEE SHEET 129 FOR SIGN DETAILS.



MCLEAN BLVD DETOUR ROUTE

FILE NAME = USER NAME = #USER# DESIGNED - AMB REVISED - DRAWN - AMB REVISED - CHECKED - PB REVISED - DATE - 05/18/11 REVISED -
 TENG & ASSOCIATES, INC. ENGINEERS/ARCHITECTS/PLANNERS CHICAGO, ILLINOIS
 STATE OF ILLINOIS DEPARTMENT OF TRANSPORTATION FAP ROUTE 345 / US ROUTE 20 STAGING AND TRAFFIC CONTROL U.S. ROUTE 20 - RAMP C DETOUR PLAN - STAGE I
 SCALE: N.T.S. SHEET NO. OF SHEETS STA. TO STA. FED. ROAD DIST. NO. ILLINOIS FED. AID PROJECT

FILE NAME =	USER NAME = #USER#	DESIGNED - AMB	REVISED -	STATE OF ILLINOIS DEPARTMENT OF TRANSPORTATION FAP ROUTE 345 / US ROUTE 20				STAGING AND TRAFFIC CONTROL U.S. ROUTE 20 - RAMP C DETOUR PLAN - STAGE I				F.A.P. RTE. 345	SECTION 8R-HB-2-BY-1	COUNTY KANE	TOTAL SHEETS 434	SHEET NO. 97
#FILE#		DRAWN - AMB	REVISED -									CONTRACT NO. 60K90				
	PLOT SCALE = #SCALE#	CHECKED - PB	REVISED -													
	PLOT DATE = #DATE#	DATE - 05/18/11	REVISED -													