

PLAN SURVEYED ALIGNED CHECKED
 NOTE BOOK NO. OF WAY CHECKED
 NO. DATE

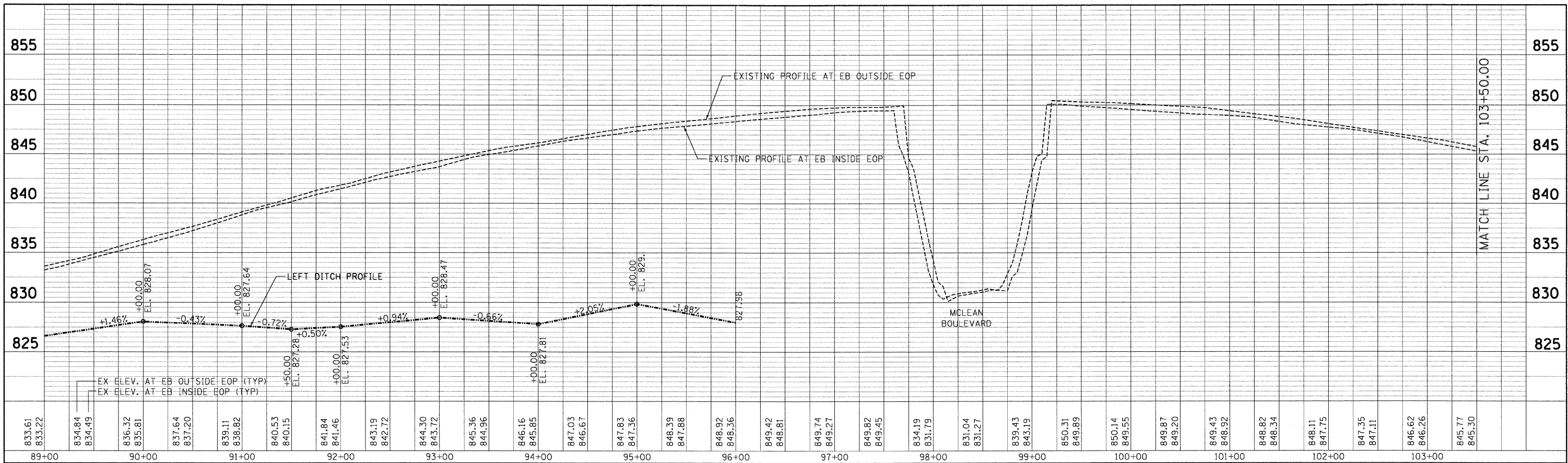

PROFILE SURVEYED GRADES CHECKED
 NOTE BOOK NO. NO. ED
 NO. STRUCTURE NOTATIONS CIPND
 NO. DATE

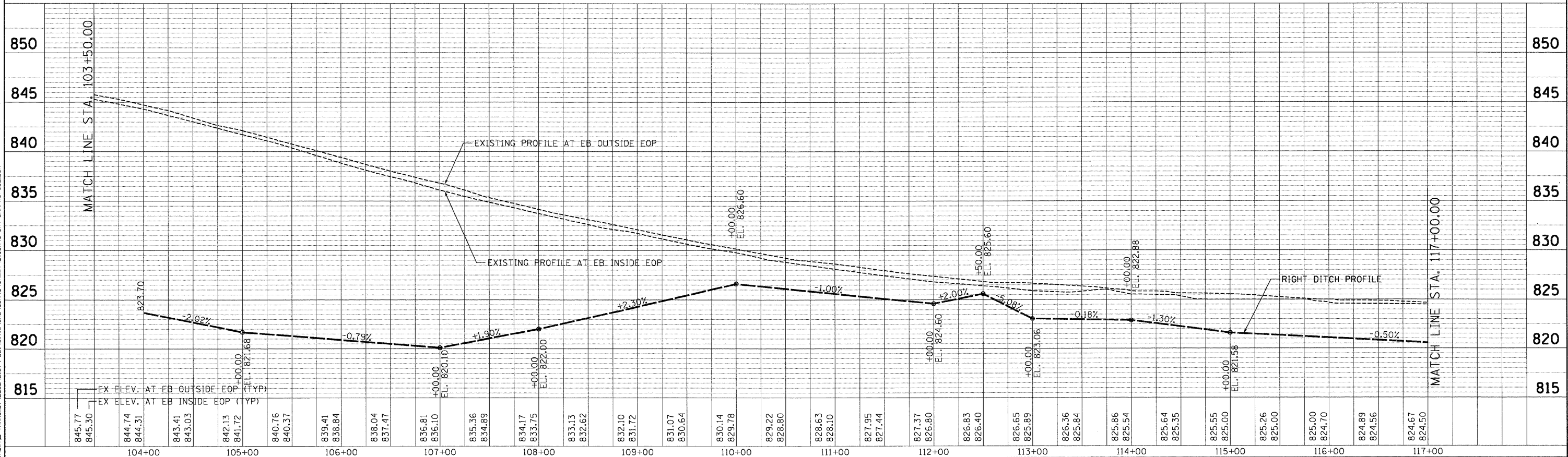

FILE NAME =	USER NAME = #USER#	DESIGNED - SH	REVISED -	STATE OF ILLINOIS DEPARTMENT OF TRANSPORTATION FAP ROUTE 345 / US ROUTE 20		DRAINAGE PROFILE U.S. ROUTE 20		F.A.P. RTE. 345	SECTION 8R-HB-2-BY-1	COUNTY KANE	TOTAL SHEETS 434	SHEET NO. 151
#FILE#		DRAWN - SH, FS	REVISED -			SCALE: HORIZ. 1"=50' VERT. 1"=5' STA. 89+00.00 TO STA. 117+00.00		FED. ROAD DIST. NO. ILLINOIS FED. AID PROJECT		CONTRACT NO. 60K90		

5-12-2011 16:14:29 HAYMARZ
 \\FS-0044\ARMVAU1\JOB-TRANS-07\2002\21379-001\CIVIL\CD\60K90\90\SHEET\016K90-SIT-DRAINPROF1002.DGN



TENC & ASSOCIATES, INC.
 ENGINEERS/ARCHITECTS/PLANNERS
 CHICAGO, ILLINOIS