

Benchmark: Top of hitch pin near N. edge of shoulder of W.B. US-20 and near W.B. entrance ramp from McLean Blvd. located 0.2' N. of the N. edge of shoulder and 4.2' S. of the center of 4x4 street sign post (±96.5' E. of the ramp gore). Elevation = 842.24 (NAVD 88)

Existing Structure: None.

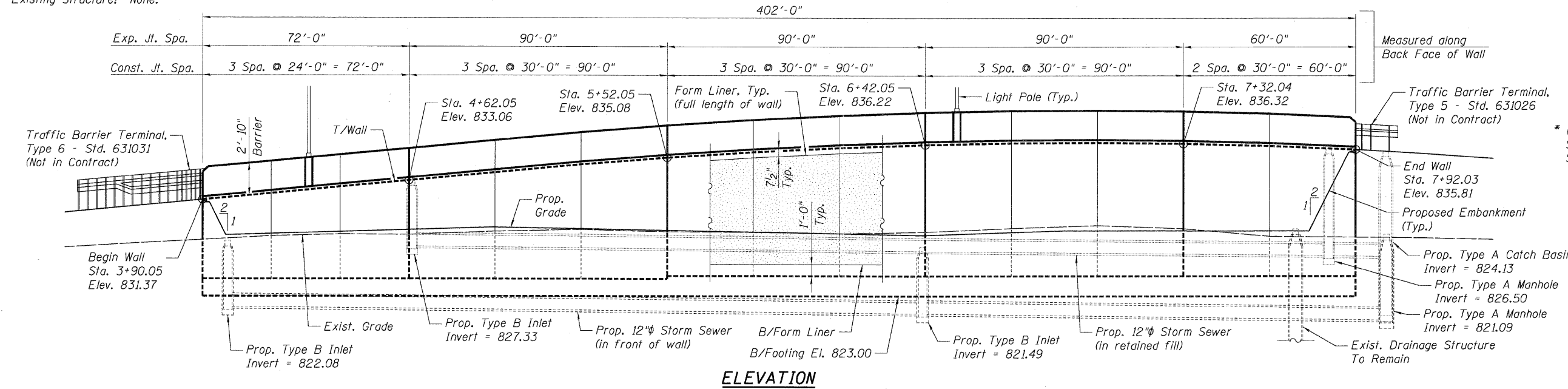

DESIGN SPECIFICATIONS

2002 AASHTO Standard Specifications for Highway Bridges, 17th Edition

DESIGN STRESSES

FIELD UNITS

f'c = 3.5 ksi
fy = 60 ksi (reinforcement)
Maximum Allowable Soil Bearing Pressure = 4 ksf *

* Maximum Applied and Equivalent Uniform Soil Bearing Pressures are provided on Sht. RW10-7.

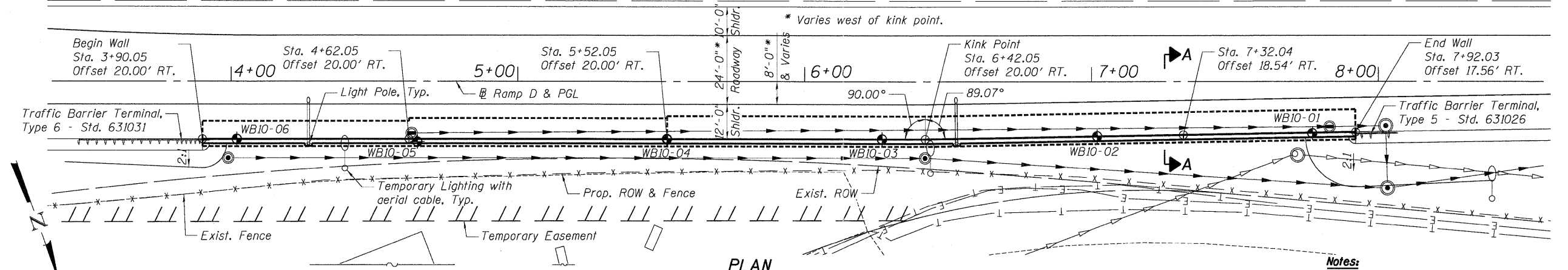
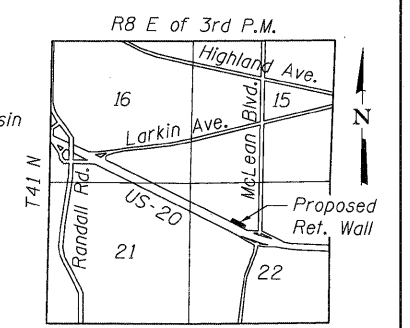

- LEGEND:**
- ⊕ Soil Boring Location
 - Existing Storm Sewer
 - Proposed Storm Sewer
 - ⊙ Existing Drainage Structure
 - ⊙ Proposed Drainage Structure
 - Proposed Temporary Lighting
 - Proposed Permanent Lighting
 - Existing Underground Telephone Line
 - Existing Underground Electric Line

- GENERAL NOTES:**
- Reinforcement bars shall conform to the requirements of ASTM A 706 Grade 60. See Special Provisions.
 - Reinforcement bars designated (E) shall be epoxy coated.
 - Slipforming of the barrier is NOT allowed.

TOTAL BILL OF MATERIAL

Item	Unit	Total
Structure Excavation	Cu Yd	946
Concrete Structures	Cu Yd	539.2
Form Liner Textured Surface	Sq Ft	3,529
Protective Coat	Sq Yd	177
Reinforcement Bars, Epoxy Coated	Pound	73,310
Geocomposite Wall Drain	Sq Yd	360
Porous Granular Embankment, Special	Cu Yd	442
Pipe Underdrains for Structures 4"	Foot	425

INDEX OF SHEETS

- RW10-1 General Plan and Elevation
- RW10-2 Wall Plan and Elevation, 1 of 5
- RW10-3 Wall Plan and Elevation, 2 of 5
- RW10-4 Wall Plan and Elevation, 3 of 5
- RW10-5 Wall Plan and Elevation, 4 of 5
- RW10-6 Wall Plan and Elevation, 5 of 5
- RW10-7 Details and Bar List
- RW10-8 Form Liner Details
- RW10-9 Soil Boring Logs, 1 of 2
- RW10-10 Soil Boring Logs, 2 of 2

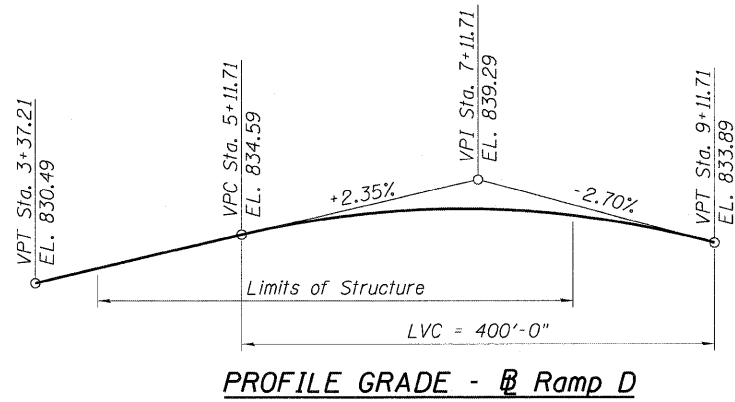

APPROVED
FOR STRUCTURAL ADEQUACY ONLY
D. Carl Papp
ENGINEER OF BRIDGES AND STRUCTURES

