

**NOTES:**

LIMITS OF RESURFACING ON SIDE-STREETS SHALL BE AS SHOWN ON THE PLANS OR AS DIRECTED BY THE ENGINEER.

ALL FINAL PAVEMENT MARKINGS SHALL BE THERMOPLASTIC (OF THE EXTRUDED TYPE) AND SHOULD BE PLACED IN ACCORDANCE WITH THE "DISTRICT ONE TYPICAL PAVEMENT MARKING" DETAIL (TC-13).

ALL RAISED REFLECTIVE PAVEMENT MARKINGS SHALL BE PLACED IN ACCORDANCE WITH THE DISTRICT ONE "TYPICAL APPLICATIONS RAISED REFLECTIVE PAVEMENT MARKER" DETAIL (TC-11).

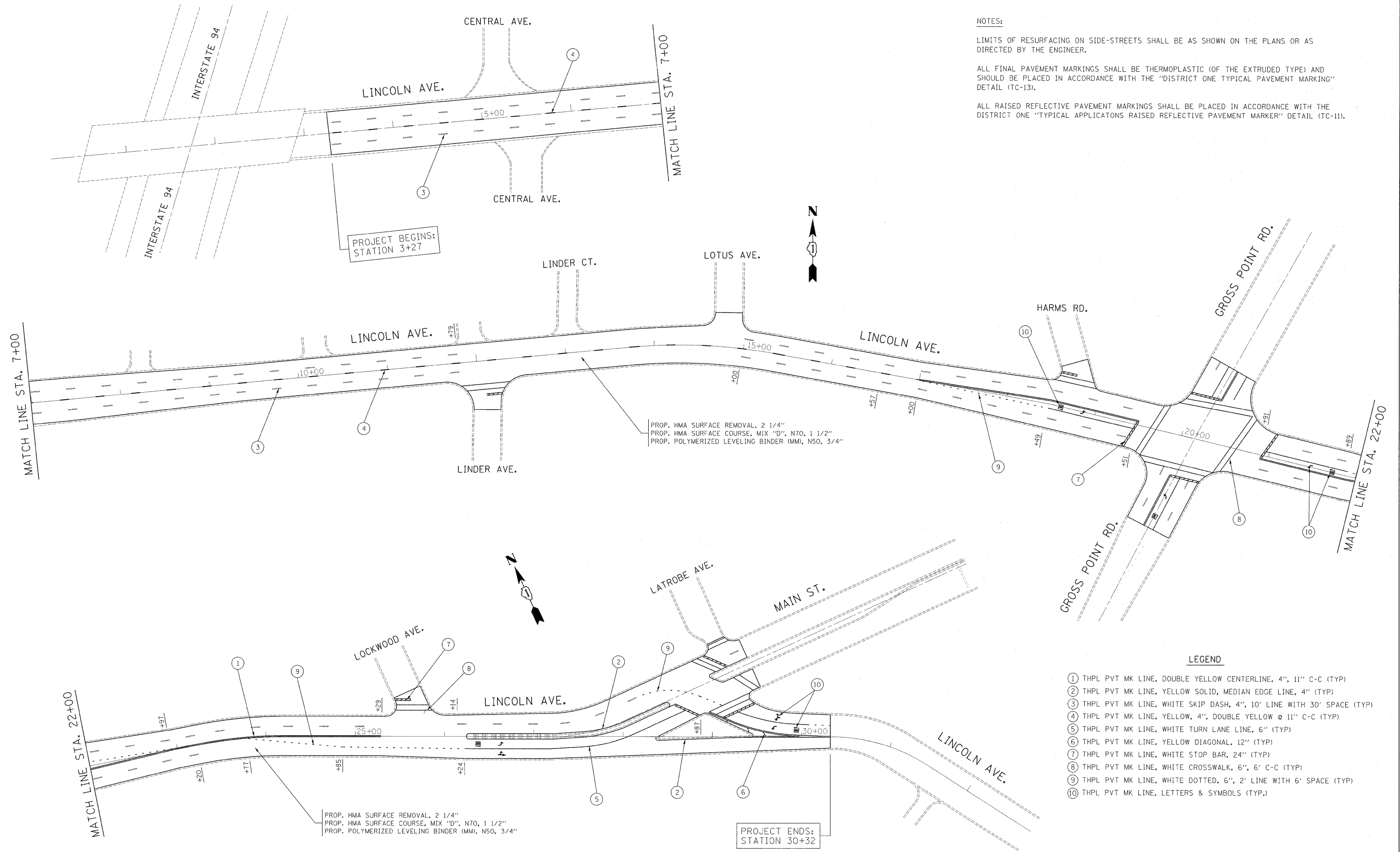

PROJECT BEGINS:  
STATION 3+27

PROP. HMA SURFACE REMOVAL, 2 1/4"  
PROP. HMA SURFACE COURSE, MIX "D", N70, 1 1/2"  
PROP. POLYMERIZED LEVELING BINDER (MM), N50, 3/4"

PROP. HMA SURFACE REMOVAL, 2 1/4"  
PROP. HMA SURFACE COURSE, MIX "D", N70, 1 1/2"  
PROP. POLYMERIZED LEVELING BINDER (MM), N50, 3/4"

PROJECT ENDS:  
STATION 30+32

**LEGEND**

- ① THPL PVT MK LINE, DOUBLE YELLOW CENTERLINE, 4", 11" C-C (TYP)
- ② THPL PVT MK LINE, YELLOW SOLID, MEDIAN EDGE LINE, 4" (TYP)
- ③ THPL PVT MK LINE, WHITE SKIP DASH, 4", 10' LINE WITH 30' SPACE (TYP)
- ④ THPL PVT MK LINE, YELLOW, 4", DOUBLE YELLOW @ 11" C-C (TYP)
- ⑤ THPL PVT MK LINE, WHITE TURN LANE LINE, 6" (TYP)
- ⑥ THPL PVT MK LINE, YELLOW DIAGONAL, 12" (TYP)
- ⑦ THPL PVT MK LINE, WHITE STOP BAR, 24" (TYP)
- ⑧ THPL PVT MK LINE, WHITE CROSSWALK, 6', 6' C-C (TYP)
- ⑨ THPL PVT MK LINE, WHITE DOTTED, 6', 2' LINE WITH 6' SPACE (TYP)
- ⑩ THPL PVT MK LINE, LETTERS & SYMBOLS (TYP.)

FILE NAME =	USER NAME = boskinm	DESIGNED -	REVISED -
ct:\pwork\pwidot\boskinm\48246706\0108611-shr-plan.dgn		DRAWN -	REVISED -
PLOT SCALE = 50.0000' / IN.		CHECKED -	REVISED -
PLOT DATE = 5/17/2011		DATE -	REVISED -

**STATE OF ILLINOIS  
DEPARTMENT OF TRANSPORTATION**

**LINCOLN AVE. (LINDER AVE. TO MAIN ST.)  
ROADWAY AND PAVEMENT MARKING PLANS**

SCALE: SHEET NO. OF SHEETS STA. TO STA.

F.A.U. RTE:	SECTION	COUNTY	TOTAL SHEETS	SHEET NO.
1328	0505.1-RS-2	COOK	17	5
CONTRACT NO. 60M19				
ILLINOIS FED. AID PROJECT				