

REVISION	BY	DATE
PLAN		
NO.		
NOTE BOOK		
NO.		
ALIGNED CHECKED		
PAID FILE NAME		

REVISION	BY	DATE
PROFILE		
NO.		
NOTE BOOK		
NO.		
GRADES CHECKED		
STRUCTURE NOTATIONS OK'D		

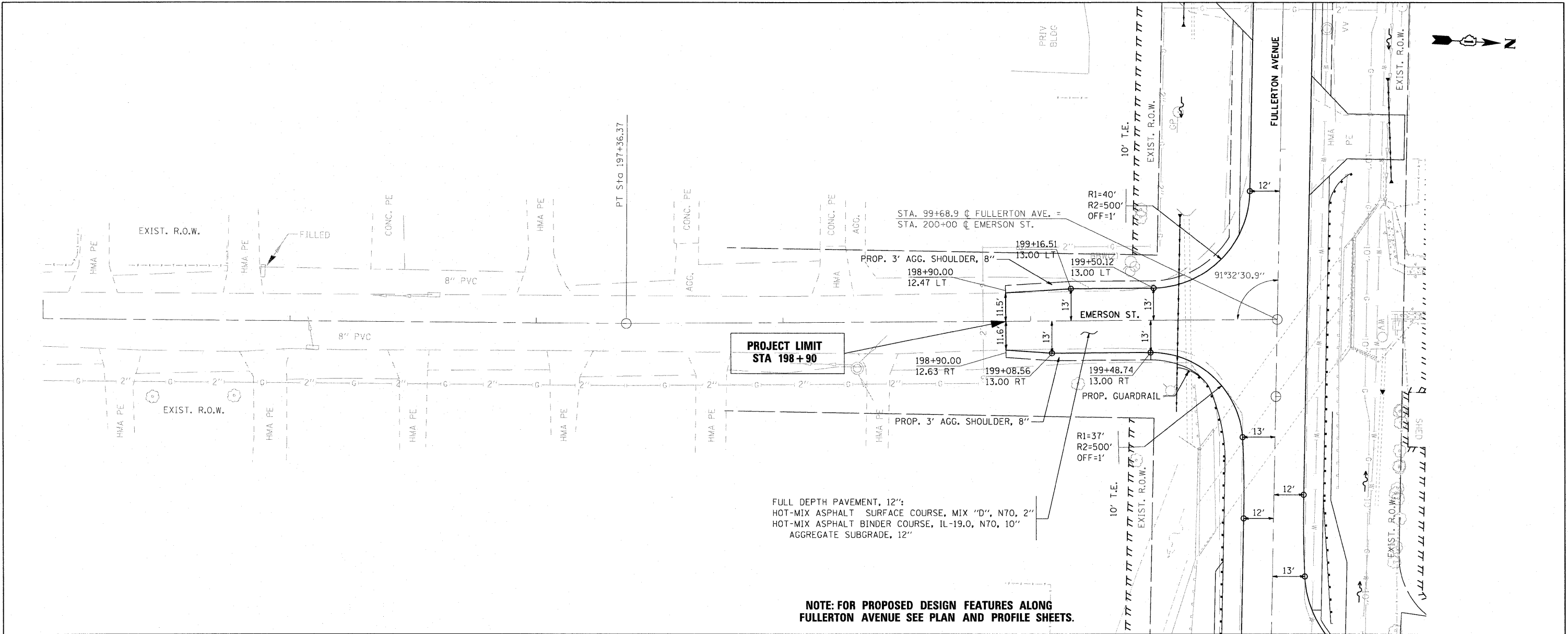

FULL DEPTH PAVEMENT, 12":
HOT-MIX ASPHALT SURFACE COURSE, MIX "D", N70, 2"
HOT-MIX ASPHALT BINDER COURSE, IL-19.0, N70, 10"
AGGREGATE SUBGRADE, 12"

NOTE: FOR PROPOSED DESIGN FEATURES ALONG FULLERTON AVENUE SEE PLAN AND PROFILE SHEETS.

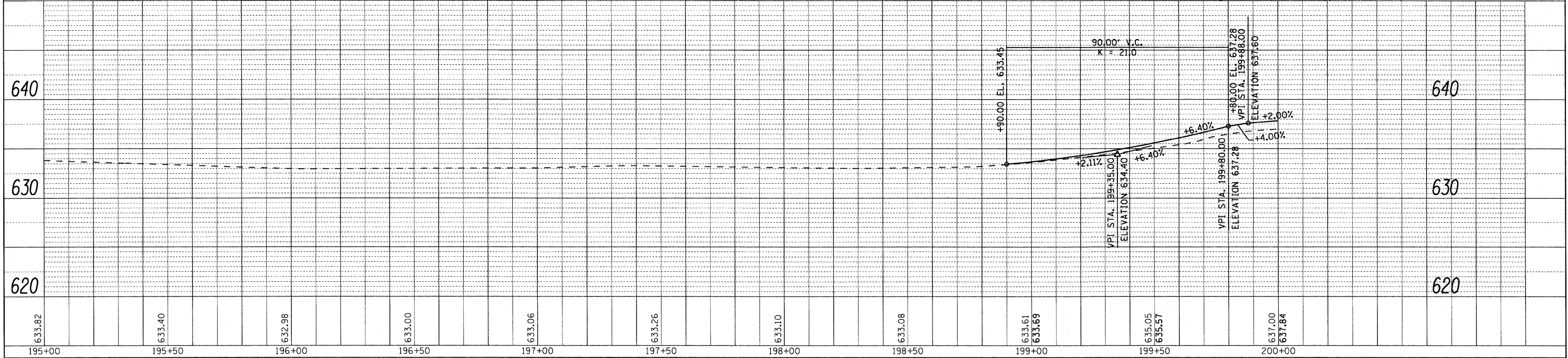

FILE NAME =	USER NAME = rge11	DESIGNED -	REVISED -	STATE OF ILLINOIS DEPARTMENT OF TRANSPORTATION	EMERSON ST. PLAN AND PROFILE	F.A.U. RTE.	SECTION	COUNTY	TOTAL SHEETS	SHEET NO.
#FILE#		DRAWN -	REVISED -			1381	0101.1-T	COOK	42	17
PLOT SCALE = 20.0000' / IN.		CHECKED -	REVISED -			CONTRACT NO. 60M82				
PLOT DATE = 5/26/2011		DATE -	REVISED -			FED. ROAD DIST. NO. 1 ILLINOIS FED. AID PROJECT				
				SCALE:	SHEET NO. OF SHEETS	STA. 198+90.00 TO STA. 200+00.00				