

**RESTORATION OF WORK AREA.** RESTORATION OF THE TRAFFIC SIGNAL WORK AREA SHALL BE INCIDENTAL TO THE RELATED PAY ITEMS SUCH AS FOUNDATION, HANDHOLE, TRENCH AND BACKFILL, ETC. AND NO ADDITIONAL COMPENSATION SHALL BE ALLOWED. ALL ROADWAYSURFACES SUCH AS SHOULDERS, MEDIANS, SIDEWALKS, PAVEMENT, ETC. SHALL BE REPLACED IN KIND. ALL DAMAGE TO MOVED LAWNS SHALL BE REPLACED WITH AN APPROVED SOD, AND ALL DAMAGE TO UNPLOWED FIELDS SHALL BE SEEDED IN ACCORDANCE WITH STANDARD SPECIFICATIONS 252 AND 250 RESPECTIVELY.

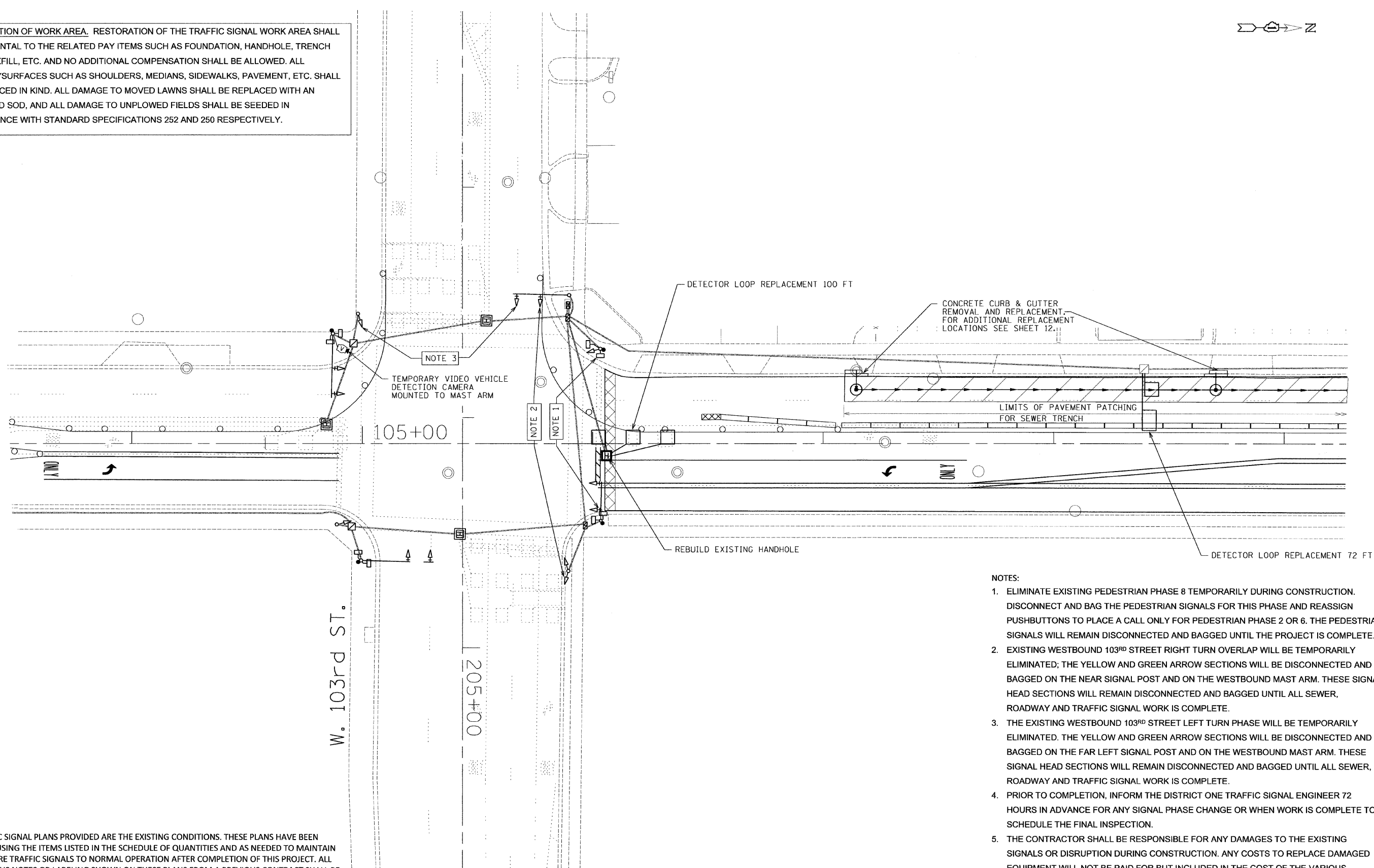

NOTE;  
THE TRAFFIC SIGNAL PLANS PROVIDED ARE THE EXISTING CONDITIONS. THESE PLANS HAVE BEEN MODIFIED USING THE ITEMS LISTED IN THE SCHEDULE OF QUANTITIES AND AS NEEDED TO MAINTAIN AND RESTORE TRAFFIC SIGNALS TO NORMAL OPERATION AFTER COMPLETION OF THIS PROJECT. ALL THE PREVIOUS NOTES OR LABELING SHOWN ON THESE PLANS FROM A PREVIOUS CONTRACT SHALL BE DISREGARDED.

STAGE 2 MAINTENANCE OF TRAFFIC AND CONSTRUCTION SHOWN

- NOTES:
1. ELIMINATE EXISTING PEDESTRIAN PHASE 8 TEMPORARILY DURING CONSTRUCTION. DISCONNECT AND BAG THE PEDESTRIAN SIGNALS FOR THIS PHASE AND REASSIGN PUSHBUTTONS TO PLACE A CALL ONLY FOR PEDESTRIAN PHASE 2 OR 6. THE PEDESTRIAN SIGNALS WILL REMAIN DISCONNECTED AND BAGGED UNTIL THE PROJECT IS COMPLETE.
  2. EXISTING WESTBOUND 103<sup>RD</sup> STREET RIGHT TURN OVERLAP WILL BE TEMPORARILY ELIMINATED; THE YELLOW AND GREEN ARROW SECTIONS WILL BE DISCONNECTED AND BAGGED ON THE NEAR SIGNAL POST AND ON THE WESTBOUND MAST ARM. THESE SIGNAL HEAD SECTIONS WILL REMAIN DISCONNECTED AND BAGGED UNTIL ALL SEWER, ROADWAY AND TRAFFIC SIGNAL WORK IS COMPLETE.
  3. THE EXISTING WESTBOUND 103<sup>RD</sup> STREET LEFT TURN PHASE WILL BE TEMPORARILY ELIMINATED. THE YELLOW AND GREEN ARROW SECTIONS WILL BE DISCONNECTED AND BAGGED ON THE FAR LEFT SIGNAL POST AND ON THE WESTBOUND MAST ARM. THESE SIGNAL HEAD SECTIONS WILL REMAIN DISCONNECTED AND BAGGED UNTIL ALL SEWER, ROADWAY AND TRAFFIC SIGNAL WORK IS COMPLETE.
  4. PRIOR TO COMPLETION, INFORM THE DISTRICT ONE TRAFFIC SIGNAL ENGINEER 72 HOURS IN ADVANCE FOR ANY SIGNAL PHASE CHANGE OR WHEN WORK IS COMPLETE TO SCHEDULE THE FINAL INSPECTION.
  5. THE CONTRACTOR SHALL BE RESPONSIBLE FOR ANY DAMAGES TO THE EXISTING SIGNALS OR DISRUPTION DURING CONSTRUCTION. ANY COSTS TO REPLACE DAMAGED EQUIPMENT WILL NOT BE PAID FOR BUT INCLUDED IN THE COST OF THE VARIOUS TRAFFIC SIGNAL PAY ITEMS.
  6. THE WORK WILL BE PAID FOR AT THE CONTRACT UNIT PRICE EACH FOR TEMPORARY TRAFFIC SIGNALS.

FILE NAME =	USER NAME = .USER_	DESIGNED - EF	REVISED -
#FILE#		DRAWN - EF	REVISED -
	PLOT SCALE = 20,0000' / IN.	CHECKED - RS	REVISED -
6-13-2011	PLOT DATE = 6/10/2011	DATE - 06-02-2011	REVISED -

**STATE OF ILLINOIS  
DEPARTMENT OF TRANSPORTATION**

**PULASKI ROAD AT 103<sup>RD</sup> STREET  
INSTALLATION PLAN TEMPORARY & PERMANENT TRAFFIC SIGNALS**

SCALE: NTS      SHEET NO. 1 OF 1 SHEETS      STA.      TO STA.

F.A.U. RTE.	SECTION	COUNTY	TOTAL SHEETS	SHEET NO.
3778	2011-022-T	COOK	34	13
CONTRACT NO. 60P21				
ILLINOIS FED. AID PROJECT				