

F.A.P. RTE.	SECTION	COUNTY	TOTAL SHEETS	SHEET NO.
330	128R-2-F	LAKE	28	1
FED. ROAD DIST. NO.	ILLINOIS	CONTRACT NO. 60P54		

D-91-199-00

STATE OF ILLINOIS
DEPARTMENT OF TRANSPORTATIONS
DIVISION OF HIGHWAYS

**PROPOSED
HIGHWAY PLANS**

F.A.P. ROUTE 330 (IL ROUTE 21 – MILWAUKEE AVENUE)
OVER BULL CREEK
(NORTH OF IL-137)
SECTION: 128R-2-F
BEAMS AND BEARINGS FABRICATION
LAKE COUNTY
C-91-574-11

PROJECT LOCATED IN LIBERTYVILLE
TOWNSHIP, LAKE COUNTY, IL

FOR INDEX OF SHEETS, SEE SHEET NO. 2

DESIGN DESIGNATION
ARTERIAL

ADT 28000 (2010)
POSTED SPEED LIMIT 45 MPH
DESIGN SPEED LIMIT 45 MPH

EXISTING SN 049-0027
PROPOSED SN 049-0199



IL 21 BRIDGE OVER BULL CREEK
0.5 MI NORTH OF IL ROUTE 137
PROPOSED BEAMS AND BEARINGS FABRICATION
EXISTING S.N. 049-0027
PROPOSED S.N. 049-0199
EXISTING BRIDGE LENGTH 32.83 FT
PROPOSED BRIDGE LENGTH 75.0 FT
STA. 248+40.34 TO STA. 249+15.35

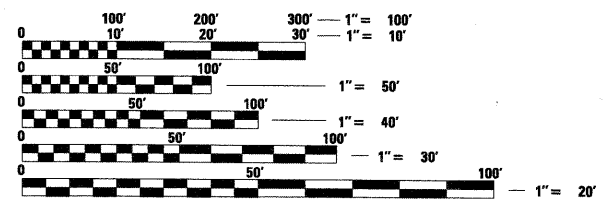
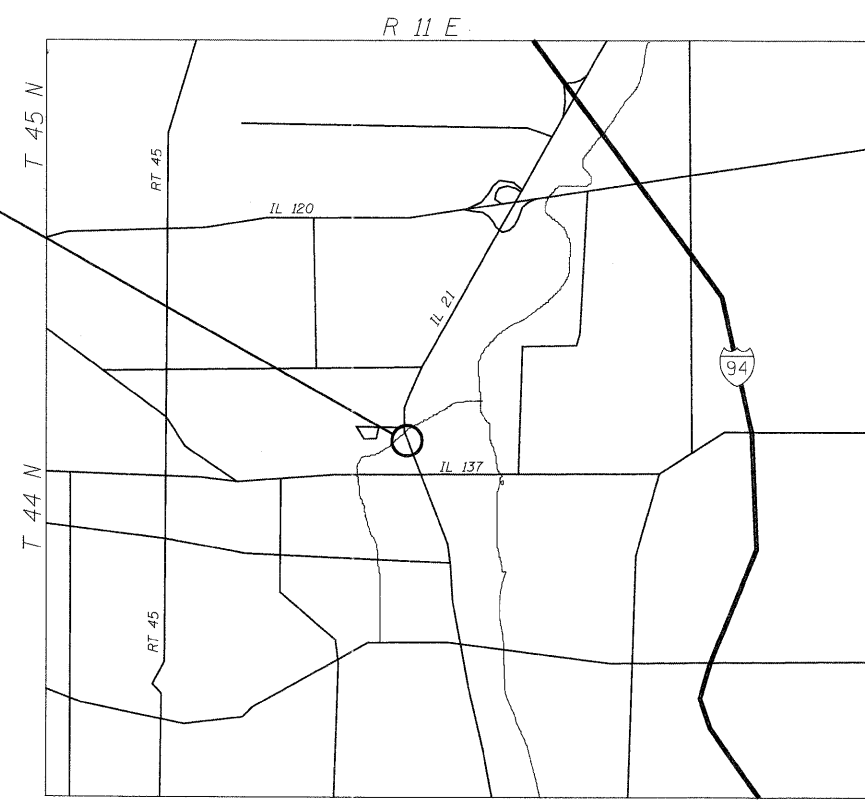

FULL SIZE PLANS HAVE BEEN PREPARED USING STANDARD
ENGINEERING SCALES. REDUCED SIZED PLANS WILL NOT
CONFORM TO STANDARD SCALES. IN MAKING MEASUREMENTS
ON REDUCED PLANS, THE ABOVE SCALES MAY BE USED.

J.U.L.I.E.
JOINT UTILITY LOCATION INFORMATION FOR EXCAVATION
1-800-892-0123
OR 811

PROJECT MANAGER: SERIN KELLER (847) 705-4556
PROJECT ENGINEER: TIMOTHY SCHMIDT (847) 705-4482

CONTRACT NO. 60P54

LIBERTYVILLE TOWNSHIP

LOCATION MAP

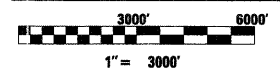

NET AND GROSS LENGTH OF PROJECT = 75.0' = 0.014 MI

STATE OF ILLINOIS
DEPARTMENT OF TRANSPORTATION
DIVISION OF HIGHWAYS

SUBMITTED MAY 18, 20 11

Dina M. O'Keefe DEPUTY DIRECTOR OF HIGHWAYS, REGION ENGINEER

July 1 20 11
Scott E. Stitt, P.E. acting ENGINEER OF DESIGN AND ENVIRONMENT

July 1 20 11
Christine M. Reed DIRECTOR OF HIGHWAYS, CHIEF ENGINEER

PRINTED BY THE AUTHORITY
OF THE STATE OF ILLINOIS

LONGO, INC.
CONSULTING ENGINEERS
1560 WALL ST, SUITE 222
NAPERVILLE, ILLINOIS 60563 PH: (630) 577-9100

WILLIAM H. REED
REGISTERED PROFESSIONAL ENGINEER
ILLINOIS
William H. Reed
Expires 11-30-11

MACTEC
Engineering and Consulting, Inc.
8745 W. Higgins Rd., Suite 300
Chicago, IL 60631

JIE YANG
REGISTERED PROFESSIONAL ENGINEER
ILLINOIS
Expires 11-30-2012