

**BASIS OF BEARINGS**

EAST-WEST CENTERLINE OF SECTION 34-41-9  
HAVING GRID BEARING OF S 88° 43' 03" W

**CURVE 1**  
PI = 123+35.70 R = 1,868.56  
PC = 118+91.17 T = 444.53'  
PT = 127+64.00 L = 872.83'  
Δ = 26° 45' 49"  
D = 03° 03' 58.7"

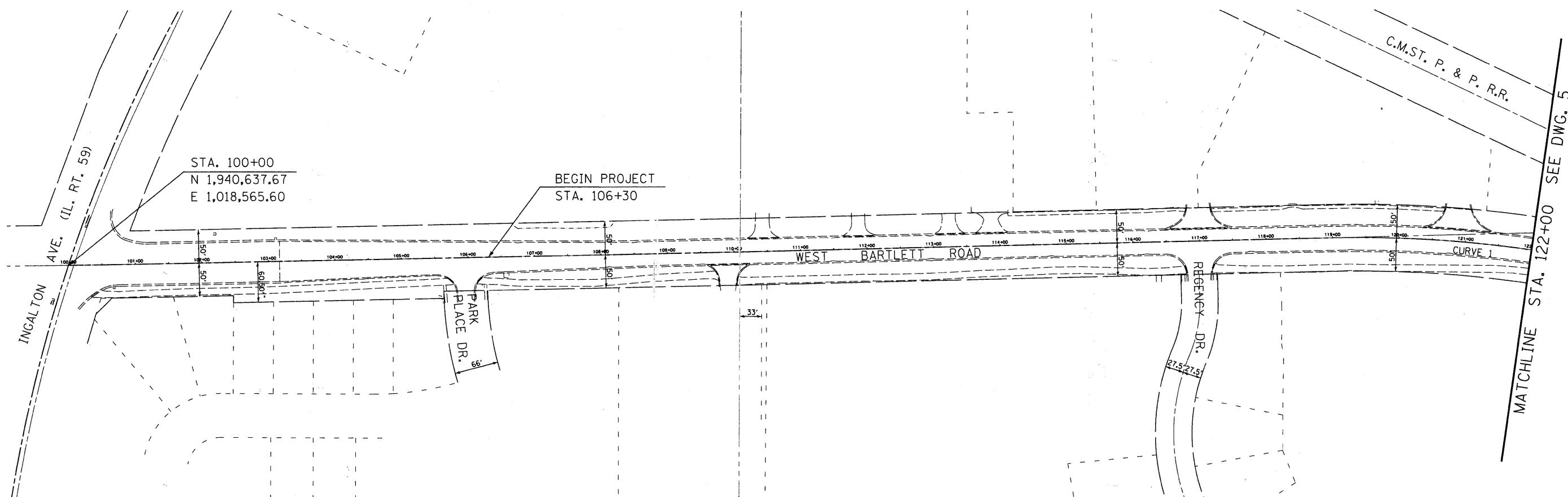

**BENCHMARK**

SOURCE: NATIONAL GEODETIC SURVEY BENCHMARKS		SITE:	
STATION DESIGNATION: DK3211	ESTABLISHED BY: PATRICK ENGINEERING	DATE: AUGUST, 2006	
ELEVATION: 794.44 (PUBLISHED AND HELD)	DATUM: NAVD88	DESCRIPTION: BRASS DISK ON THE SOUTH SIDE OF A CONCRETE TRAFFIC SIGNAL POST BASE AT THE NORTHEAST CORNER OF THE INTERSECTION OF BARTLETT ROAD AND ILLINOIS ROUTE 59.	
STATION DESIGNATION: DK3213	ESTABLISHED BY: PATRICK ENGINEERING	DATE: AUGUST 2006	
ELEVATION: 799.75 (PUBLISHED)	DATUM: NAVD88	DESCRIPTION: BRASS DISK ON THE NORTH END OF A CONCRETE RETAINING WALL ALONG THE WEST SIDE OF THE BUSINESS ACCESS ROAD. THE STATION IS LOCATED AT THE SOUTHWEST CORNER OF THE INTERSECTION OF STEARNS ROAD AND SAYER ROAD TO THE NORTH AND A BUSINESS ACCESS ROAD TO THE SOUTH.	
STATION DESIGNATION: SBM#1 (V3 CP 101)	ESTABLISHED BY: V3 COMPANIES	DATE: 11-06-2008	
ELEVATION: 798.054 (MEASURED)	DATUM: NAVD88	DESCRIPTION: FOUND CUT CROSS ON CURB SOUTH SIDE OF WEST BARTLETT ROAD WEST OF IL. RTE. 59.	
STATION DESIGNATION: SBM#2 (V3 CP 111)	ESTABLISHED BY: V3 COMPANIES	DATE: 11-06-2008	
ELEVATION: 806.108 (MEASURED)	DATUM: NAVD88	DESCRIPTION: SET CUT CROSS ON CONCRETE WALK AT SOUTHEAST CORNER OF WEST BARTLETT ROAD AND WESTERN AVENUE.	



USER NAME = *USER*	DESIGNED - HEV	REVISED -
PLOT SCALE = *SCALE*	DRAWN - DRP	REVISED -
PLOT DATE = 1/17/2011	CHECKED - MJR	REVISED -
	DATE - 12-22-10	REVISED -

**WEST BARTLETT ROAD  
STREETSCAPE**

**ALIGNMENT AND TIES PLAN**

SCALE: 1" = 80' SHEET NO. 1 OF 2 SHEETS STA. 100+00 TO STA. 122+00

F.A.U. RTE.	SECTION	COUNTY	TOTAL SHEETS	SHEET NO.
1344	10-00085-00-LT	COOK	30	4
CONTRACT NO. 63512			ILLINOIS FED. AID PROJECT	