

CABLE TABLE

- [A] UNIT DUCT, 600V, 2-1/C #6 & 1-1/C #6 GROUND (XLP-TYPE USE) IN 1" DIA. POLYETHYLENE CONDUIT
- [B] UNIT DUCT, 600V, 4-1/C #6 & 1-1/C #6 GROUND (XLP-TYPE USE) IN 1 1/4" DIA. POLYETHYLENE CONDUIT
- [C] UNIT DUCT, 600V, 2-1/C #4 & 1-1/C #4 GROUND (XLP-TYPE USE) IN 1" DIA. POLYETHYLENE CONDUIT
- [D] UNIT DUCT, 600V, 4-1/C #4 & 1-1/C #4 GROUND (XLP-TYPE USE) IN 1 1/2" DIA. POLYETHYLENE CONDUIT

LEGEND

- SERVICE LINE - ELECTRIC CABLE IN CONDUIT 600V (XLP-TYPE USE) 2-1/C #2 & 1-1/C #6 GROUND WIRE
- CONDUIT - POLYETHYLENE (SIZE AS NOTED)
- PROPOSED STREET LIGHT POLE WITH 2 LED LAMPS (SEE DETAIL SHEET 25)
- ⊠ PROPOSED STREET LIGHT POLE WITH 1 LED LAMP (SEE DETAIL SHEET 25)
- ▣ PROPOSED STREET LIGHT CONTROLLER CABINET
- PROPOSED HANDHOLE
- EXISTING LIGHT POLE TO REMAIN
- EXISTING LUMINAIRE AND MAST ARM TO BE REMOVED (BY COMED)
- ▬ PROPOSED 4" DIA GALVANIZED STEEL SLEEVE
- ⓧ PROPOSED STREET LIGHT POLE NUMBER

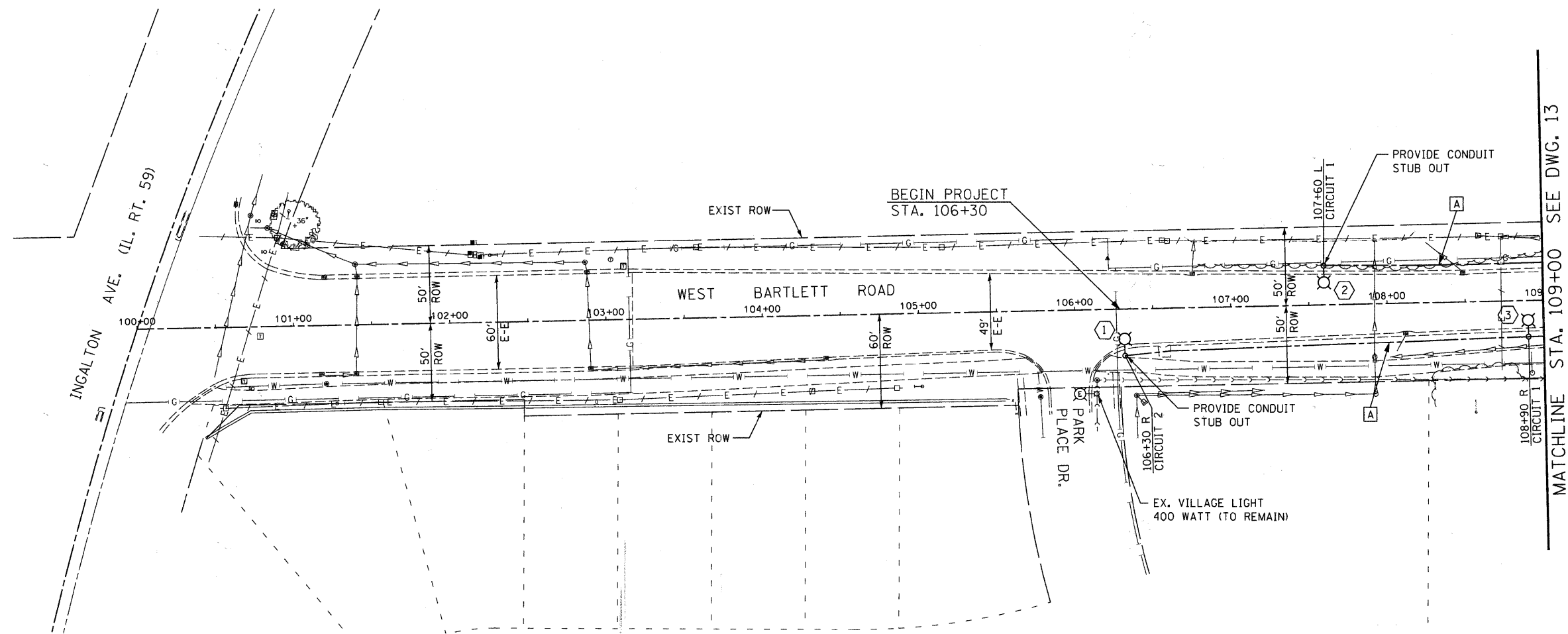
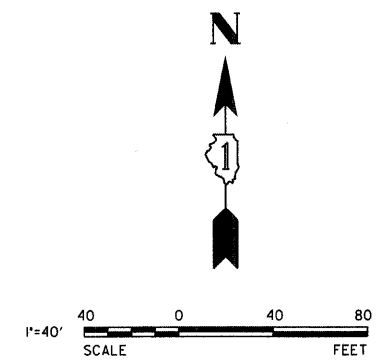

	USER NAME = #USER# DESIGNED - HEV DRAWN - DRP CHECKED - MJR DATE - 12-22-10	REVISED - REVISED - REVISED - REVISED -	WEST BARTLETT ROAD STREETSCAPE	LIGHTING AND ELECTRICAL PLANS		F.A.U. RTE. 1344 SECTION 10-00085-00-LT COUNTY COOK TOTAL SHEETS 30 SHEET NO. 12
	PLOT SCALE = #SCALE# PLOT DATE = 1/7/2011	SCALE: 1" = 40' SHEET NO. 1 OF 6 SHEETS STA. 100+00 TO STA. 109+00		CONTRACT NO. 63512 ILLINOIS FED. AID PROJECT		