

F.A.U. RTE.	SECTION	COUNTY	TOTAL SHEETS	SHEET NO.
0085	00-00246-02-FP	MCHENRY	292	029
STA. 40+00.00 TO STA. 72+00 (WALKUP ROAD)				
STA. 36+50.00 TO STA. 76+53.99 (IL 176)				
STA. 27+00.00 TO STA. 32+94.98 (GATES STREET)				
FED. ROAD DIST. NO. 11 ILLINOIS FED. AID PROJECT				
CONTRACT NO: 63522				



Christian H. Jorgensen
 ILLINOIS PROFESSIONAL LAND SURVEYOR NO. 35-2797
 LICENSE EXPIRATION DATE: NOVEMBER 30, 2010

Existing & Proposed Pavement Illinois Route 176 Curve #1

P.I.	= Sta. 47+25.35
Δ	= 2°14'07"
R	= 11500.00'
T	= 224.34'
L	= 448.63'
E	= 2.19'
P.C.	= Sta. 45+01.01
P.T.	= Sta. 49+49.64

Existing & Proposed Pavement Illinois Route 176 Curve #2

P.I.	= Sta. 62+24.87
Δ	= 2°19'09"
R	= 8000.00'
T	= 161.92'
L	= 323.80'
E	= 1.64'
P.C.	= Sta. 60+62.95
P.T.	= Sta. 63+86.75

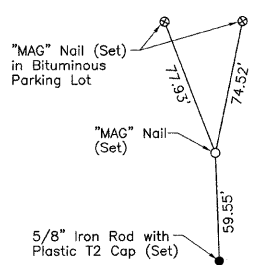
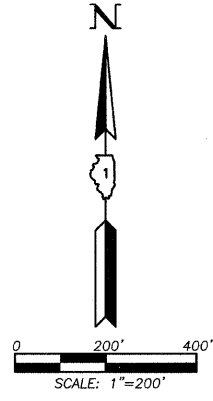

Existing P.O.T. Illinois Route 176
 Sta. 36+50.00
 N.2,033,023.753-E.986,273.629

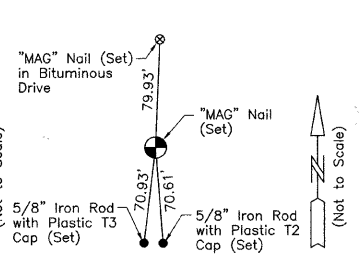

Existing & Proposed P.C. #1 Illinois Route 176
 Sta. 45+01.01
 N.2,033,035.877-E.987,124.554

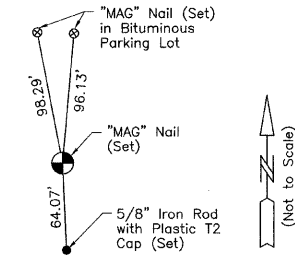

Existing & Proposed P.I. #1 Illinois Route 176
 Sta. 47+25.35
 N.2,033,039.073-E.987,348.876

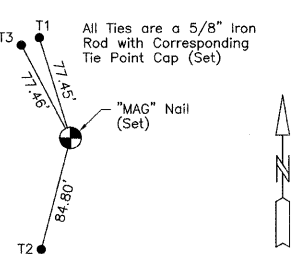

Existing & Proposed P.T. #1 Illinois Route 176
 Sta. 49+49.64
 N.2,033,051.016-E.987,572.902

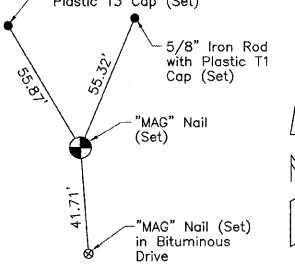

Existing & Proposed P.C. #2 Illinois Route 176
 Sta. 60+62.95
 N.2,033,110.282-E.988,684.630

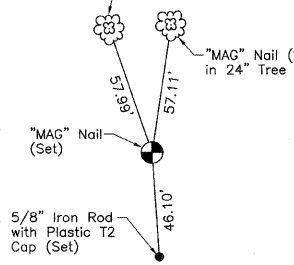

Existing & Proposed P.I. #2 Illinois Route 176
 Sta. 62+24.87
 N.2,033,118.901-E.988,846.322

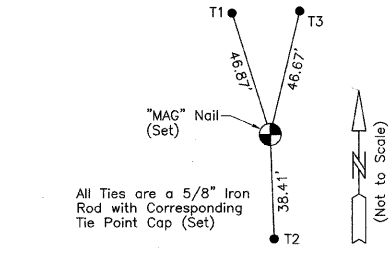

Existing & Proposed P.T. #2 Illinois Route 176
 Sta. 63+86.75
 N.2,033,120.971-E.989,008.231

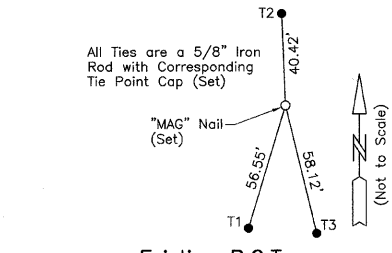

Existing P.O.T. Illinois Route 176
 Sta. 76+53.99
 N.2,033,137.171-E.990,275.372

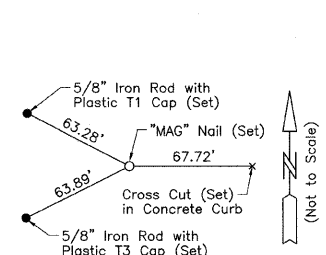

Existing P.O.T. Walkup Road
 Sta. 40+00.00
 N.2,032,054.005-E.987,615.428

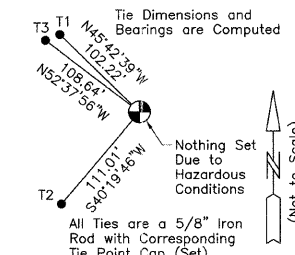

Existing & Proposed P.I. Walkup Road
 Sta. 49+99.66
 N.2,033,053.632-E.987,623.187

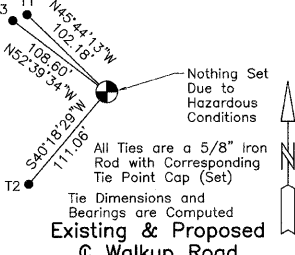

Existing & Proposed Walkup Road
 Sta. 55+88.44
 N.2,033,642.404-E.987,626.324

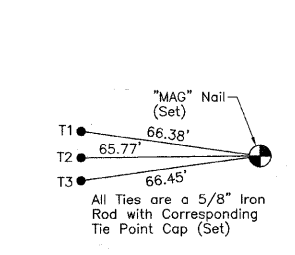

Existing & Proposed P.C. #1 Walkup Road
 Sta. 56+89.22
 N.2,033,743.181-E.987,626.861

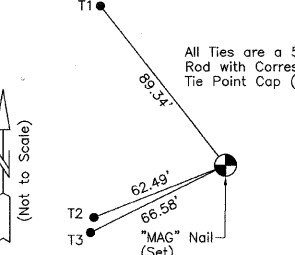

Existing & Proposed P.I. #1 Walkup Road
 Sta. 57+89.98
 N.2,033,843.916-E.987,623.897

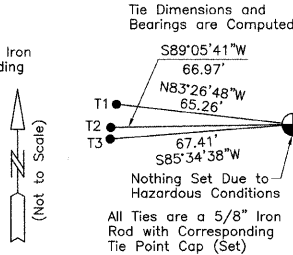

Existing & Proposed P.R.C. Walkup Road
 Sta. 57+89.98
 N.2,033,843.916-E.987,623.897

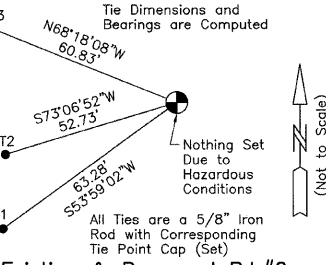
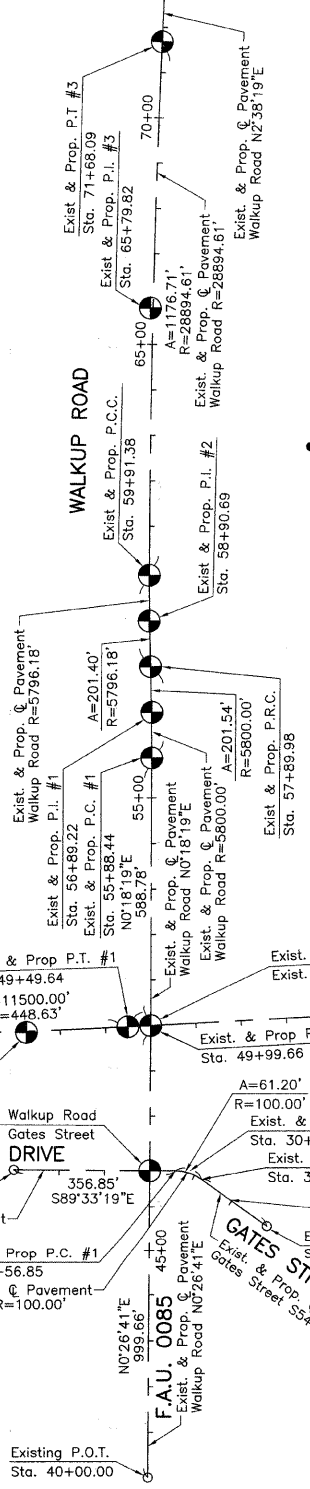

Existing & Proposed P.I. #2 Walkup Road
 Sta. 58+90.69
 N.2,033,944.586-E.987,620.935

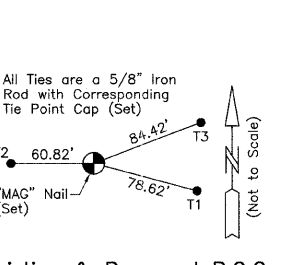

Existing & Proposed P.C.C. Walkup Road
 Sta. 59+91.38
 N.2,034,045.296-E.987,621.471

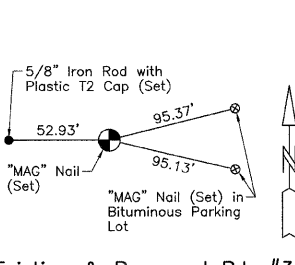

Existing & Proposed P.I. #3 Walkup Road
 Sta. 65+79.82
 N.2,034,633.727-E.987,624.607

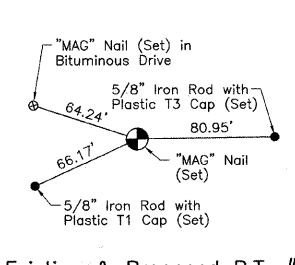

Existing & Proposed P.T. #3 Walkup Road
 Sta. 71+68.09
 N.2,035,221.542-E.987,651.697

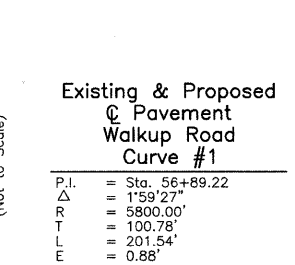

Existing & Proposed Walkup Road Curve #1
 P.I. = Sta. 56+89.22
 Δ = 1°59'27"
 R = 5800.00'
 T = 100.78'
 L = 201.54'
 E = 0.88'
 P.C. = Sta. 55+88.44
 P.R.C. = Sta. 57+89.98

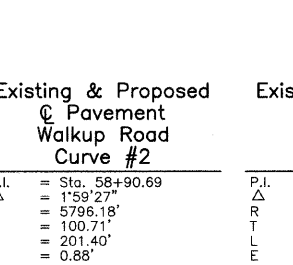

Existing & Proposed Walkup Road Curve #2
 P.I. = Sta. 58+90.69
 Δ = 1°59'27"
 R = 5796.18'
 T = 100.71'
 L = 201.40'
 E = 0.88'
 P.R.C. = Sta. 57+89.98
 P.C.C. = Sta. 59+91.38

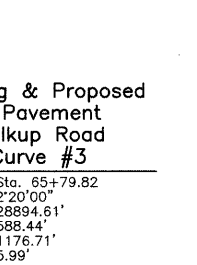

Existing & Proposed Walkup Road Curve #3
 P.I. = Sta. 65+79.82
 Δ = 2°20'00"
 R = 28894.61'
 T = 588.44'
 L = 1176.71'
 E = 5.99'
 P.C.C. = Sta. 59+91.38
 P.T. = Sta. 71+68.09

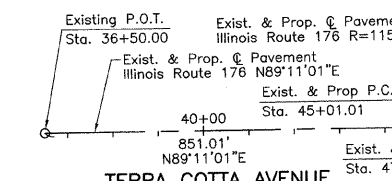

Existing P.O.T. Terra Cotta Avenue
 Sta. 36+50.00
 N.2,033,137.171-E.990,275.372

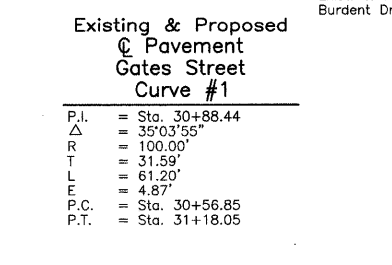

Existing & Proposed Gates Street Curve #1
 P.I. = Sta. 30+88.44
 Δ = 35°03'55"
 R = 100.00'
 T = 31.59'
 L = 61.20'
 E = 4.87'
 P.C. = Sta. 30+56.85
 P.T. = Sta. 31+18.05

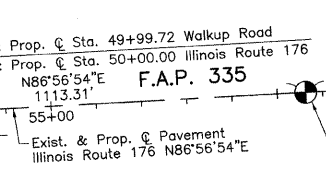

Existing & Proposed P.I. #1 Gates Street
 Sta. 30+88.44
 N.2,032,732.262-E.987,709.137

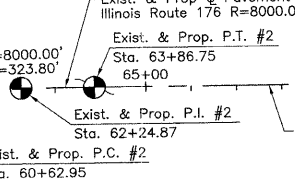

Existing & Proposed P.T. #1 Gates Street
 Sta. 31+18.05
 N.2,032,713.912-E.987,734.854

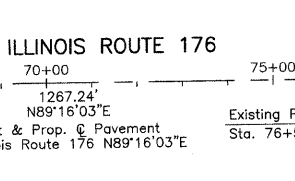

Existing P.O.T. Gates Street
 Sta. 32+94.98
 N.2,032,611.142-E.987,878.879

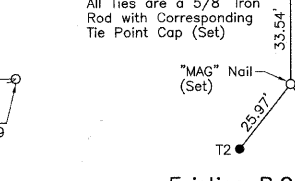

Existing & Proposed Burdent Drive
 Sta. 27+00.00
 N.2,032,735.278-E.987,320.708

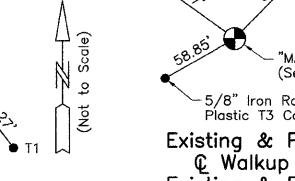

Existing & Proposed Walkup Road & Gates Street
 Sta. 46+78.96
 N.2,032,732.508-E.987,677.546

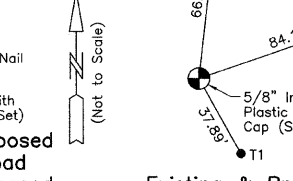

Existing & Proposed P.C. #1 Gates Street
 Sta. 30+56.85
 N.2,032,732.508-E.987,677.546

Note: Symbols are not shown on Curve #1 on Gates Street for Clarity Purposes

REVISIONS	
NAME	DATE
Added Burdent Dr. & Gates St.	4/13/11

MCHENRY COUNTY DIVISION OF TRANSPORTATION
 WALKUP ROAD F.A.U. 0085

ALIGNMENT AND TIES

SCALE: 1"=200'
 DATE: July 26, 2010
 DRAWN BY: KLK
 CHECKED BY: CHJ
 JORGENSEN & ASSOCIATES, INC. 120 PARK AVENUE LAKE VILLA, ILLINOIS 60046
 (847) 356-3371