

F.A.U. RTE.	SECTION	COUNTY	TOTAL SHEETS	SHEET NO.
0085	00-00246-02-FP	MCHENRY	292	037
STA.		TO STA.		
FED. ROAD DIST. NO. 1		ILLINOIS	FED. AID PROJECT	
CONTRACT NO: 63522				

NOTES:
 1. HOT-MIX ASPHALT SURFACE REMOVAL, VARIABLE DEPTH AREAS SHOWN ON THE PLANS INDICATE AREAS WHEN MILLING IS REQUIRED TO ACHIEVE A MINIMUM 2 1/2" BINDER AND 1 1/2" SURFACE LIFT OVER THE EXISTING PAVEMENT AREA. ACTUAL MILLING LOCATIONS TO BE DETERMINED IN THE FIELD AT THE TIME OF CONSTRUCTION BY THE ENGINEER.

REMOVAL LEGEND	
	PAVEMENT REMOVAL
	HOT-MIX ASPHALT SURFACE REMOVAL, VARIABLE DEPTH (SEE NOTE 1 SHEET 037)
	DRIVEWAY PAVEMENT REMOVAL
	SIDEWALK REMOVAL
	LINEAR REMOVALS
	TREE REMOVAL (WITH DIAMETER)

PROP. CURVE WALKPR-11
 PI STA. = 225+71.31
 $\Delta = 47^\circ 10' 00''$ (LT)
 $D = 3^\circ 23' 58''$
 $R = 1,685.42'$
 $T = 735.76'$
 $L = 1,387.46'$
 $E = 153.60'$
 P.C. STA. = 218+35.55
 P.T. STA. = 232+23.02

S.E. = 3.2%
 TRANSITION
 STA 218+66.00 TO STA 231+93.00 F.S.
 STA 231+93.00 TO STA 233+38.00 N.C.

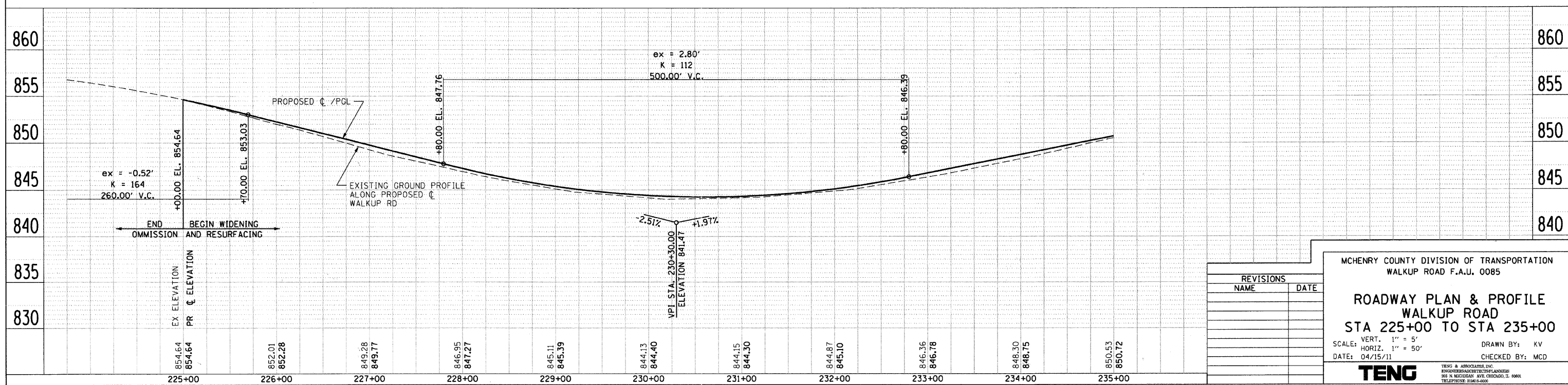
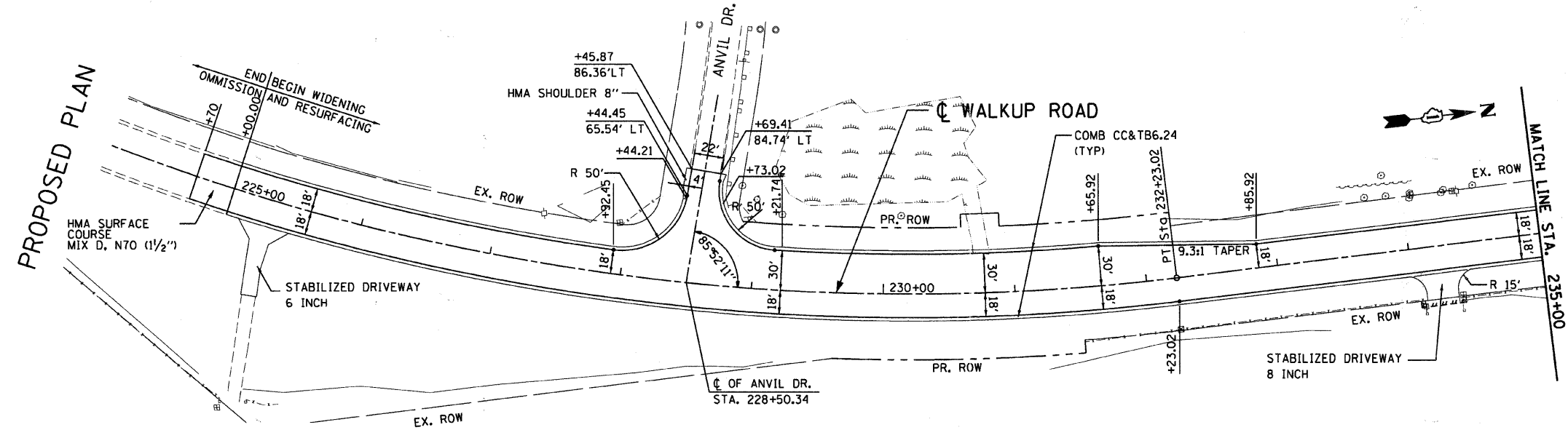
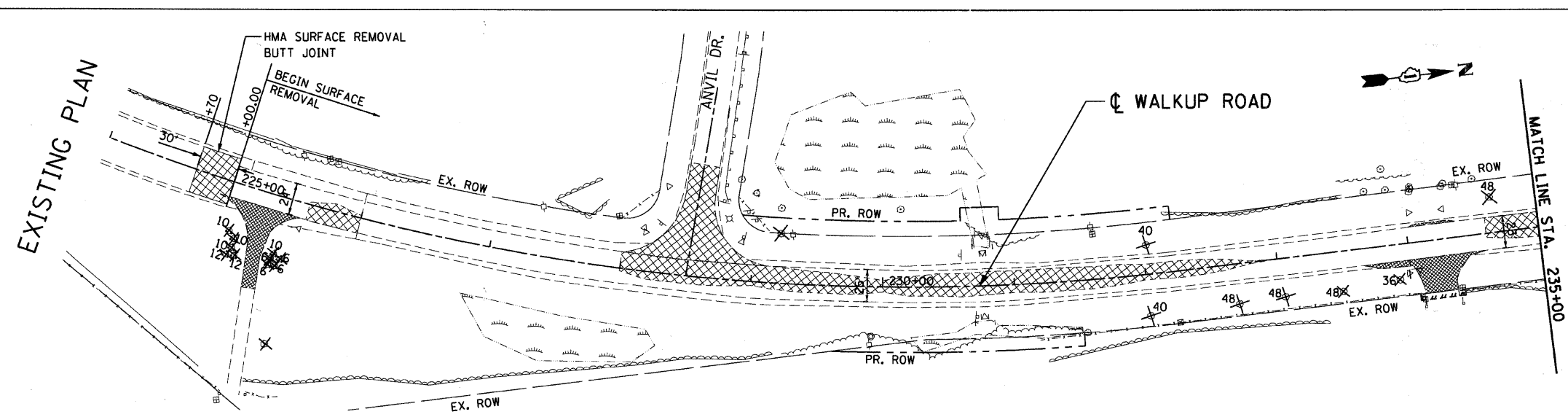

REVISIONS	
NAME	DATE

MCHENRY COUNTY DIVISION OF TRANSPORTATION
 WALKUP ROAD F.A.U. 0085

ROADWAY PLAN & PROFILE
WALKUP ROAD
STA 225+00 TO STA 235+00

SCALE: VERT. 1" = 5'
 HORIZ. 1" = 50'

DATE: 04/15/11

DRAWN BY: KV
 CHECKED BY: MCD

TENG

TENG & ASSOCIATES, INC.
 ENGINEERS/ARCHITECTS/PLANNERS
 302 N. MICHIGAN AVE. CHICAGO, IL 60601
 TELEPHONE: (312) 666-6666

PLAN: DESIGNED, CHECKED, PLOTTED, ALIGNED, CHECKED, E-GRID FILE NAME, NO., DATE
 PROFILE: DESIGNED, CHECKED, PLOTTED, STRIP, NOTATIONS, CHKD, NO., DATE
 \\\V02\A002.DGN, \\\V02\A004.DGN, \\\V02\A005.DGN, \\\V02\A006.DGN, \\\V02\A007.DGN, \\\V02\A008.DGN, \\\V02\A009.DGN, \\\V02\A010.DGN, \\\V02\A011.DGN, \\\V02\A012.DGN, \\\V02\A013.DGN, \\\V02\A014.DGN, \\\V02\A015.DGN, \\\V02\A016.DGN, \\\V02\A017.DGN, \\\V02\A018.DGN, \\\V02\A019.DGN, \\\V02\A020.DGN, \\\V02\A021.DGN, \\\V02\A022.DGN, \\\V02\A023.DGN, \\\V02\A024.DGN, \\\V02\A025.DGN, \\\V02\A026.DGN, \\\V02\A027.DGN, \\\V02\A028.DGN, \\\V02\A029.DGN, \\\V02\A030.DGN, \\\V02\A031.DGN, \\\V02\A032.DGN, \\\V02\A033.DGN, \\\V02\A034.DGN, \\\V02\A035.DGN, \\\V02\A036.DGN, \\\V02\A037.DGN, \\\V02\A038.DGN, \\\V02\A039.DGN, \\\V02\A040.DGN, \\\V02\A041.DGN, \\\V02\A042.DGN, \\\V02\A043.DGN, \\\V02\A044.DGN, \\\V02\A045.DGN, \\\V02\A046.DGN, \\\V02\A047.DGN, \\\V02\A048.DGN, \\\V02\A049.DGN, \\\V02\A050.DGN, \\\V02\A051.DGN, \\\V02\A052.DGN, \\\V02\A053.DGN, \\\V02\A054.DGN, \\\V02\A055.DGN, \\\V02\A056.DGN, \\\V02\A057.DGN, \\\V02\A058.DGN, \\\V02\A059.DGN, \\\V02\A060.DGN