

F.A.U. RTE.	SECTION	COUNTY	TOTAL SHEETS	SHEET NO.
0085 00-00246-02-FP	MCHENRY	ILLINOIS	292	038
STA.	TO STA.		CONTRACT NO. 63522	
FED. ROAD DIST. NO. 1		FED. AID PROJECT		

EXISTING PLAN

PROPOSED PLAN

REMOVAL LEGEND

- PAVEMENT REMOVAL
- HOT-MIX ASPHALT SURFACE REMOVAL, VARIABLE DEPTH (SEE NOTE 1 SHEET 037)
- DRIVEWAY PAVEMENT REMOVAL
- SIDEWALK REMOVAL
- LINEAR REMOVALS
- TREE REMOVAL (WITH DIAMETER)

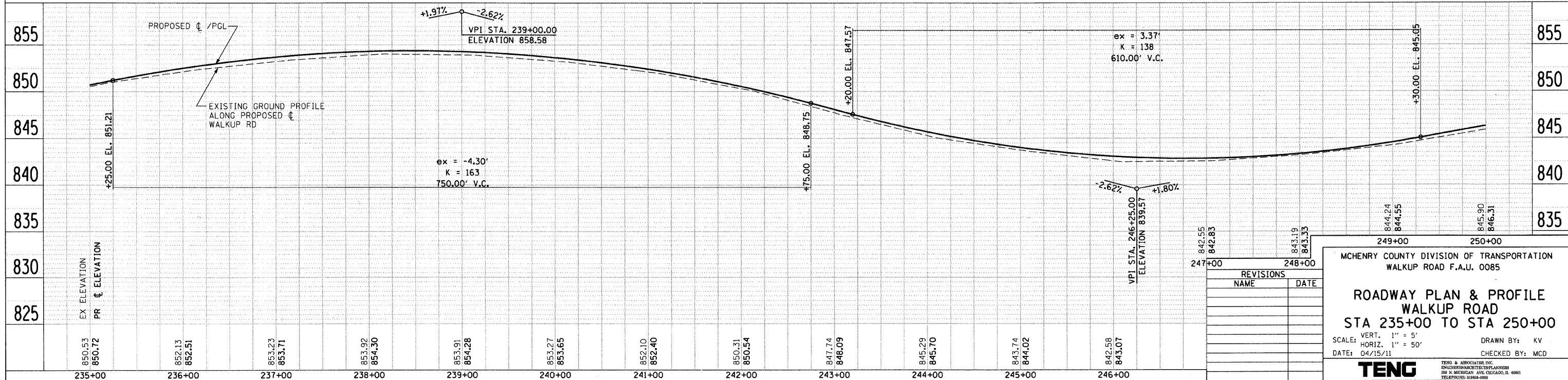

REVISIONS	
NAME	DATE

MCHENRY COUNTY DIVISION OF TRANSPORTATION
WALKUP ROAD F.A.U. 0085

ROADWAY PLAN & PROFILE
WALKUP ROAD
STA 235+00 TO STA 250+00

SCALE: VERT. 1" = 5'
HORIZ. 1" = 50'

DATE: 04/15/11

DRAWN BY: KV
CHECKED BY: MGD

TENG

TENG & ASSOCIATES, INC.
ENGINEERING ARCHITECTURE PLANNING
200 N. MICHIGAN AVE., CHICAGO, IL 60601
TELEPHONE 312-666-6000

PLAN: REVISIONS, PLOTTED, ALIGNED, CHECKED, DATE, FILE, NAME
 PROFILE: REVISIONS, PLOTTED, CHECKED, STRAIGHT, NOTATIONS, CITY, DATE, FILE, NAME
 PROJECT: \\P021A001.DGN, \\P021A002.DGN, \\P021A003.DGN, \\P021A004.DGN, \\P021A005.DGN, \\P021A006.DGN, \\P021A007.DGN, \\P021A008.DGN, \\P021A009.DGN, \\P021A010.DGN, \\P021A011.DGN, \\P021A012.DGN, \\P021A013.DGN, \\P021A014.DGN, \\P021A015.DGN, \\P021A016.DGN, \\P021A017.DGN, \\P021A018.DGN, \\P021A019.DGN, \\P021A020.DGN, \\P021A021.DGN, \\P021A022.DGN, \\P021A023.DGN, \\P021A024.DGN, \\P021A025.DGN, \\P021A026.DGN, \\P021A027.DGN, \\P021A028.DGN, \\P021A029.DGN, \\P021A030.DGN, \\P021A031.DGN, \\P021A032.DGN, \\P021A033.DGN, \\P021A034.DGN, \\P021A035.DGN, \\P021A036.DGN, \\P021A037.DGN, \\P021A038.DGN, \\P021A039.DGN, \\P021A040.DGN, \\P021A041.DGN, \\P021A042.DGN, \\P021A043.DGN, \\P021A044.DGN, \\P021A045.DGN, \\P021A046.DGN, \\P021A047.DGN, \\P021A048.DGN, \\P021A049.DGN, \\P021A050.DGN, \\P021A051.DGN, \\P021A052.DGN, \\P021A053.DGN, \\P021A054.DGN, \\P021A055.DGN, \\P021A056.DGN, \\P021A057.DGN, \\P021A058.DGN, \\P021A059.DGN, \\P021A060.DGN