

F.A.U. RTE.	SECTION	COUNTY	TOTAL SHEETS	SHEET NO.
0085 00-00246-02-FP	MCHENRY		292	049
STA.		TO STA.		
FED. ROAD DIST. NO. 1 ILLINOIS		FED. AID PROJECT		
CONTRACT NO: 63522				

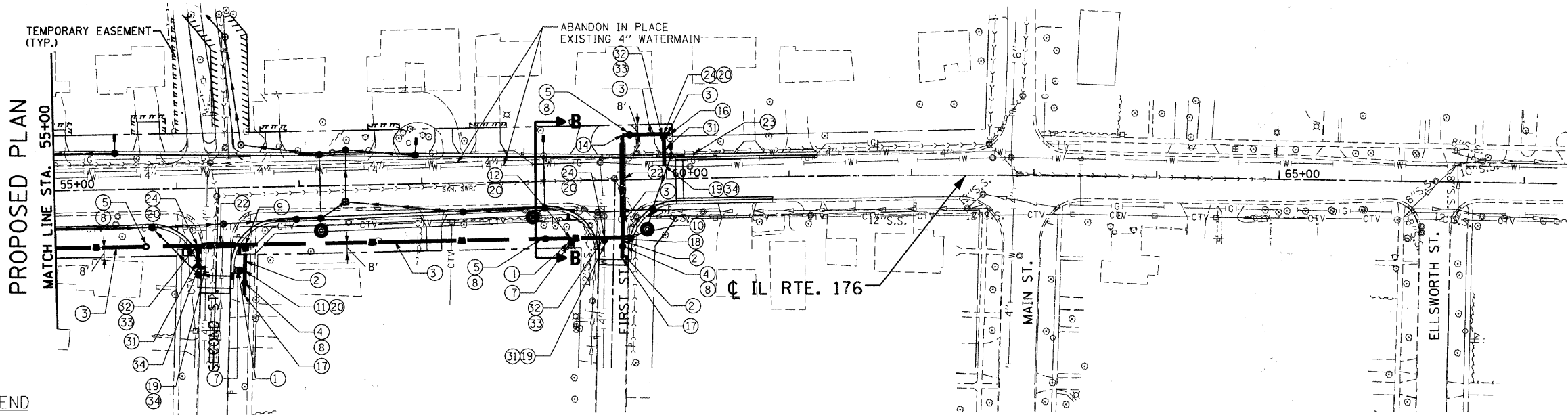

LEGEND

- | | | | |
|---------------------------------------------------------------|-------------------------------------------------------|---------------------------------------------------|------------------------------------------------------|
| ① DUCTILE IRON WATER MAIN 6" | ⑨ DUCTILE IRON WATER MAIN TEE, 12" X 8" | ⑰ DUCTILE IRON WATER MAIN FITTING - 8" PLUG (CAP) | ⑳ DUCTILE IRON WATER MAIN TEE, 4" X 4" |
| ② DUCTILE IRON WATER MAIN 8" | ⑩ DUCTILE IRON WATER MAIN TEE, 12" X 12" | ⑱ DUCTILE IRON WATER MAIN REDUCER 12" X 8" | ㉑ DUCTILE IRON WATER MAIN FITTINGS 6" 90 DEGREE BEND |
| ③ DUCTILE IRON WATER MAIN 12" | ⑪ DUCTILE IRON WATER MAIN TEE, 8" X 6" | ㉒ CONNECTION TO EXISTING WATER MAIN WITH FLANGE | ㉒ SEAL EXISTING 8" WATER MAIN (SEE NOTE 3 SHEET 050) |
| ④ WATER VALVES 8" | ⑫ DUCTILE IRON WATER MAIN TEE, 12" X 6" | ㉓ WATER MAINLINE STOP 8" | ㉓ ABANDON EXISTING WATER MAIN, FILL WITH CLSM |
| ⑤ WATER VALVES 12" | ⑬ DUCTILE IRON WATER MAIN FITTINGS 8" 90 DEGREE BEND | ㉔ STEEL CASING PIPE, AUGERED AND JACKED, 24" | ㉔ DUCTILE IRON WATER MAIN TEE, 8" X 8" |
| ⑥ FIRE HYDRANT EXTENSION | ⑭ DUCTILE IRON WATER MAIN FITTINGS 12" 90 DEGREE BEND | ㉕ CUT AND CAP EXISTING 4" WATER MAIN | ㉕ DUCTILE IRON WATER MAIN FITTINGS 8" 45 DEGREE BEND |
| ⑦ FIRE HYDRANT WITH AUXILIARY VALVE AND VALVE BOX | ⑮ DUCTILE IRON WATER MAIN FITTINGS 12" 45 DEGREE BEND | ㉖ DUCTILE IRON WATER MAIN FITTINGS 12" PLUG (CAP) | ㉖ DUCTILE IRON WATER MAIN 4" |
| ⑧ VALVE VAULTS, TYPE A, 5'-DIAMETER, TYPE 1 FRAME, CLOSED LID | | ㉗ DUCTILE IRON WATER MAIN FITTINGS 12" X 4" | ㉗ WATER VALVES 4" |
| | | | ㉘ CAST IRON VALVE BOXES, 4" |
| | | | ㉘ DUCTILE IRON WATER MAIN FITTINGS 4" 90 DEGREE BEND |
| | | | ㉘ DUCTILE IRON WATER MAIN TEE 8" X 4" |
| | | | ㉘ DUCTILE IRON WATER MAIN FITTINGS 4" 45 DEGREE BEND |

PLAN	DATE
BY	
CHECKED	
DATE	

PROF ILE	DATE
BY	
CHECKED	
DATE	

.\VAL02A002.DGN, .\P102A002.DGN, .\R02A002.DGN, .\S02A002.DGN, .\T02A002.DGN, .\U02A002.DGN, .\V02A002.DGN, .\W02A002.DGN, .\X02A002.DGN, .\Y02A002.DGN, .\Z02A002.DGN, .\000000.DGN, .\000001.DGN, .\000002.DGN, .\000003.DGN, .\000004.DGN, .\000005.DGN, .\000006.DGN, .\000007.DGN, .\000008.DGN, .\000009.DGN, .\000010.DGN, .\000011.DGN, .\000012.DGN, .\000013.DGN, .\000014.DGN, .\000015.DGN, .\000016.DGN, .\000017.DGN, .\000018.DGN, .\000019.DGN, .\000020.DGN, .\000021.DGN, .\000022.DGN, .\000023.DGN, .\000024.DGN, .\000025.DGN, .\000026.DGN, .\000027.DGN, .\000028.DGN, .\000029.DGN, .\000030.DGN, .\000031.DGN, .\000032.DGN, .\000033.DGN, .\000034.DGN, .\000035.DGN, .\000036.DGN, .\000037.DGN, .\000038.DGN, .\000039.DGN, .\000040.DGN, .\000041.DGN, .\000042.DGN, .\000043.DGN, .\000044.DGN, .\000045.DGN, .\000046.DGN, .\000047.DGN, .\000048.DGN, .\000049.DGN, .\000050.DGN, .\000051.DGN, .\000052.DGN, .\000053.DGN, .\000054.DGN, .\000055.DGN, .\000056.DGN, .\000057.DGN, .\000058.DGN, .\000059.DGN, .\000060.DGN

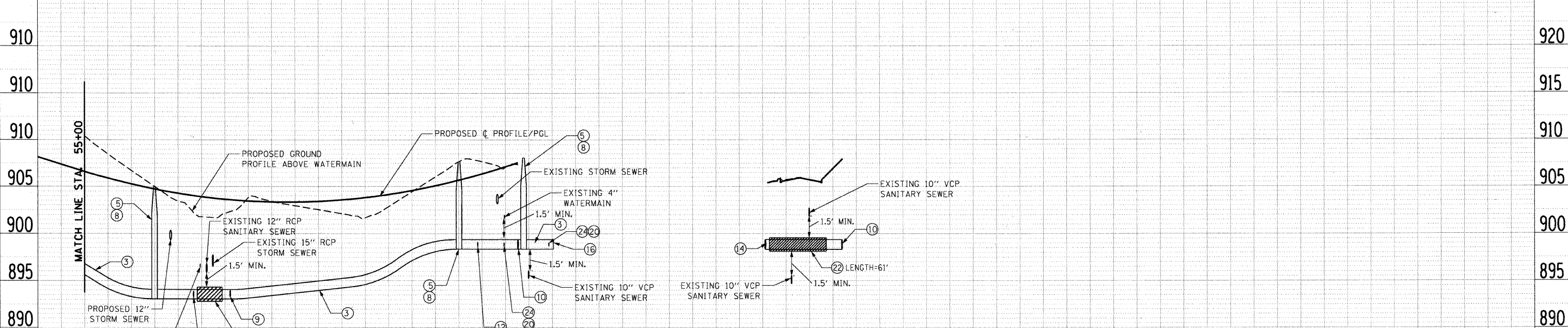

REVISIONS	
NAME	DATE

MCHENRY COUNTY DIVISION OF TRANSPORTATION
 WALKUP ROAD F.A.U. 0085
WATER MAIN RELOCATION
ILLINOIS ROUTE 176
STA 55+00 TO STA 70+00
 SCALE: VERT. 1"=5'
 HORIZ. 1" = 50'
 DATE: 06/10/11
 DRAWN BY: LK
 CHECKED BY: TL
TENG
TENG & ASSOCIATES, INC.
 ENGINEERS/ARCHITECTS/PLANNERS
 205 N. MICHIGAN AVE. CHICAGO, IL 60601
 TELEPHONE 312.644.2000