

F.A.U. RTE.	SECTION	COUNTY	TOTAL SHEETS	SHEET NO.
0085	00-00246-02-FF	MCHENRY	292	060
STA.		TO STA.		
FED. ROAD DIST. NO. 1 ILLINOIS FED. AID PROJECT				
CONTRACT NO: 63522				

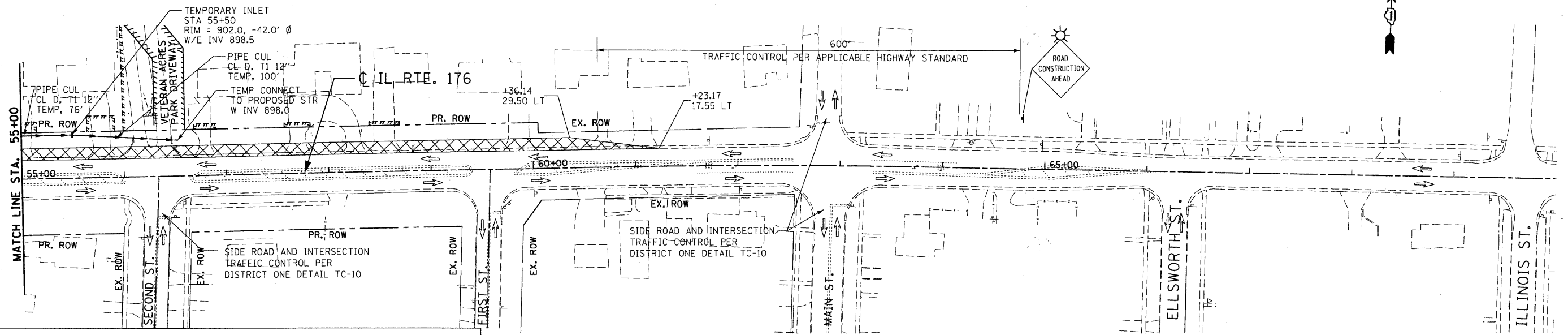
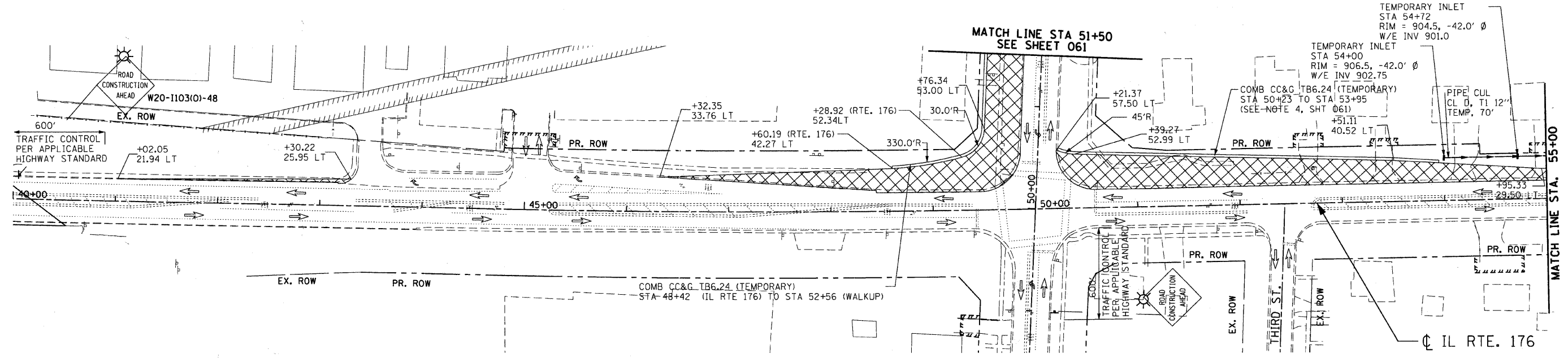

**LEGEND**

WORK AREA	SIGN
TEMPORARY PAVEMENT	VERTICAL PANEL W/ STEADY BURNING LIGHT
BARRICADE, TYPE III, W/ TY A FLASHER	DRUMS WITH STEADY BURNING LIGHT @ 50' C-C
PREVIOUS TRAFFIC PATTERN	TYPE B MONODIRECTIONAL FLASHING LIGHT
PR TRAFFIC PATTERN	

REVISIONS	
NAME	DATE

MCHENRY COUNTY DIVISION OF TRANSPORTATION  
WALKUP ROAD F.A.U. 0085

**MOT & PRESTAGE CONSTRUCTION**  
ILLINOIS ROUTE 176  
STA 40+00 TO STA 70+00

SCALE: 1" = 50'  
DATE: 04/15/11  
DRAWN BY: CC  
CHECKED BY: KA

**TENG**  
TENG & ASSOCIATES, INC.  
ENGINEERING ARCHITECTURE PLANNING  
100 N. HICKORY ST. CHICAGO, IL 60610  
TELEPHONE: 312-641-6000

\VAL021A002.DGN, \VPM021A001.DGN, \VMT021A004.DGN, \VMT021A005.DGN, \VMT021A006.DGN, \VMT021A007.DGN, \VMT021A008.DGN, \VMT021A009.DGN, \VMT021A010.DGN, \VMT021A011.DGN, \VMT021A012.DGN, \VMT021A013.DGN, \VMT021A014.DGN, \VMT021A015.DGN, \VMT021A016.DGN, \VMT021A017.DGN, \VMT021A018.DGN, \VMT021A019.DGN, \VMT021A020.DGN, \VMT021A021.DGN, \VMT021A022.DGN, \VMT021A023.DGN, \VMT021A024.DGN, \VMT021A025.DGN, \VMT021A026.DGN, \VMT021A027.DGN, \VMT021A028.DGN, \VMT021A029.DGN, \VMT021A030.DGN, \VMT021A031.DGN, \VMT021A032.DGN, \VMT021A033.DGN, \VMT021A034.DGN, \VMT021A035.DGN, \VMT021A036.DGN, \VMT021A037.DGN, \VMT021A038.DGN, \VMT021A039.DGN, \VMT021A040.DGN, \VMT021A041.DGN, \VMT021A042.DGN, \VMT021A043.DGN, \VMT021A044.DGN, \VMT021A045.DGN, \VMT021A046.DGN, \VMT021A047.DGN, \VMT021A048.DGN, \VMT021A049.DGN, \VMT021A050.DGN, \VMT021A051.DGN, \VMT021A052.DGN, \VMT021A053.DGN, \VMT021A054.DGN, \VMT021A055.DGN, \VMT021A056.DGN, \VMT021A057.DGN, \VMT021A058.DGN, \VMT021A059.DGN, \VMT021A060.DGN